

PROFILE SURVEYED BY _____ DATE _____
 GRADES CHECKED BY _____
 NOTE BOOK NO. _____
 FIELD NOTES NO. _____
 SURVEY STATUS CHRG. _____

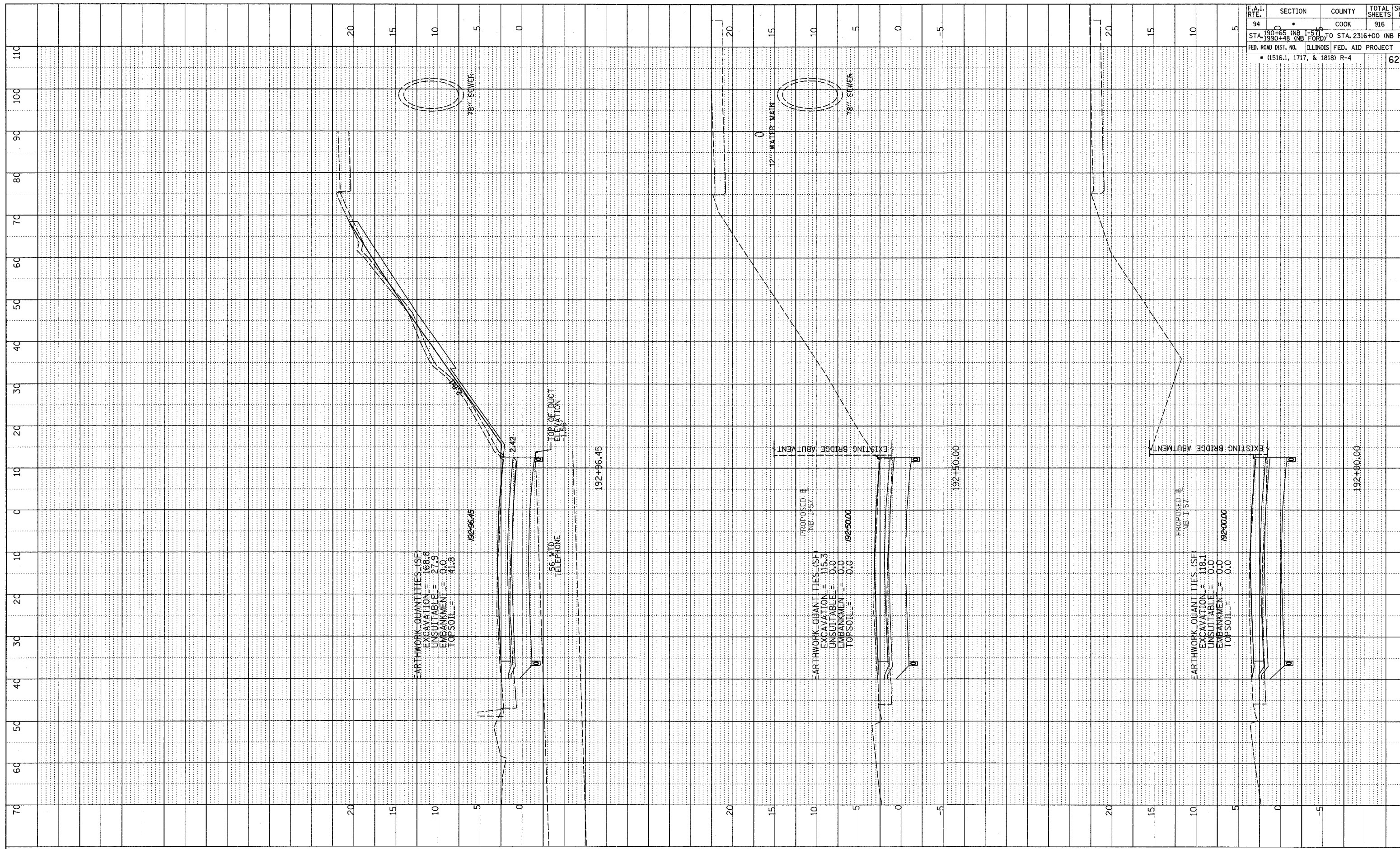

F.A.I. RTE.	SECTION	COUNTY	TOTAL SHEETS	SHEET NO.
94	190+00 (NB I-57) TO STA. 190+48 (NB FORD)	COOK	916	653
FED. ROAD DIST. NO. ILLINOIS FED. AID PROJECT				
• (1516.1, 1717, & 1818) R-4				

62304

TYLIN INTERNATIONAL

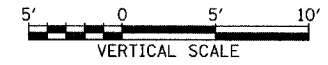
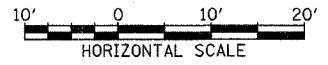

NORTHBOUND I-57
 STA. 192+00 TO STA. 192+96.45

03/03/2006 04:09 PM