

PROFILE SURVEYED _____ BY _____ DATE _____
 NOTE BOOK GRADES CHECKED _____
 NO. _____ E.M. NOTED _____
 _____ FIELD DATE NOTATIONS CHRO _____

F.A.I. RTE.	SECTION	COUNTY	TOTAL SHEETS	SHEET NO.
94	0	COOK	916	675
STA. 190+45 (NB I-57)	TO STA. 2316+00 (NB RYAN)			
STA. 1990+48 (NB FORD)				
FED. ROAD DIST. NO. ILLINOIS FED. AID PROJECT				62304
• (1516.1, 1717, & 1818) R-4				

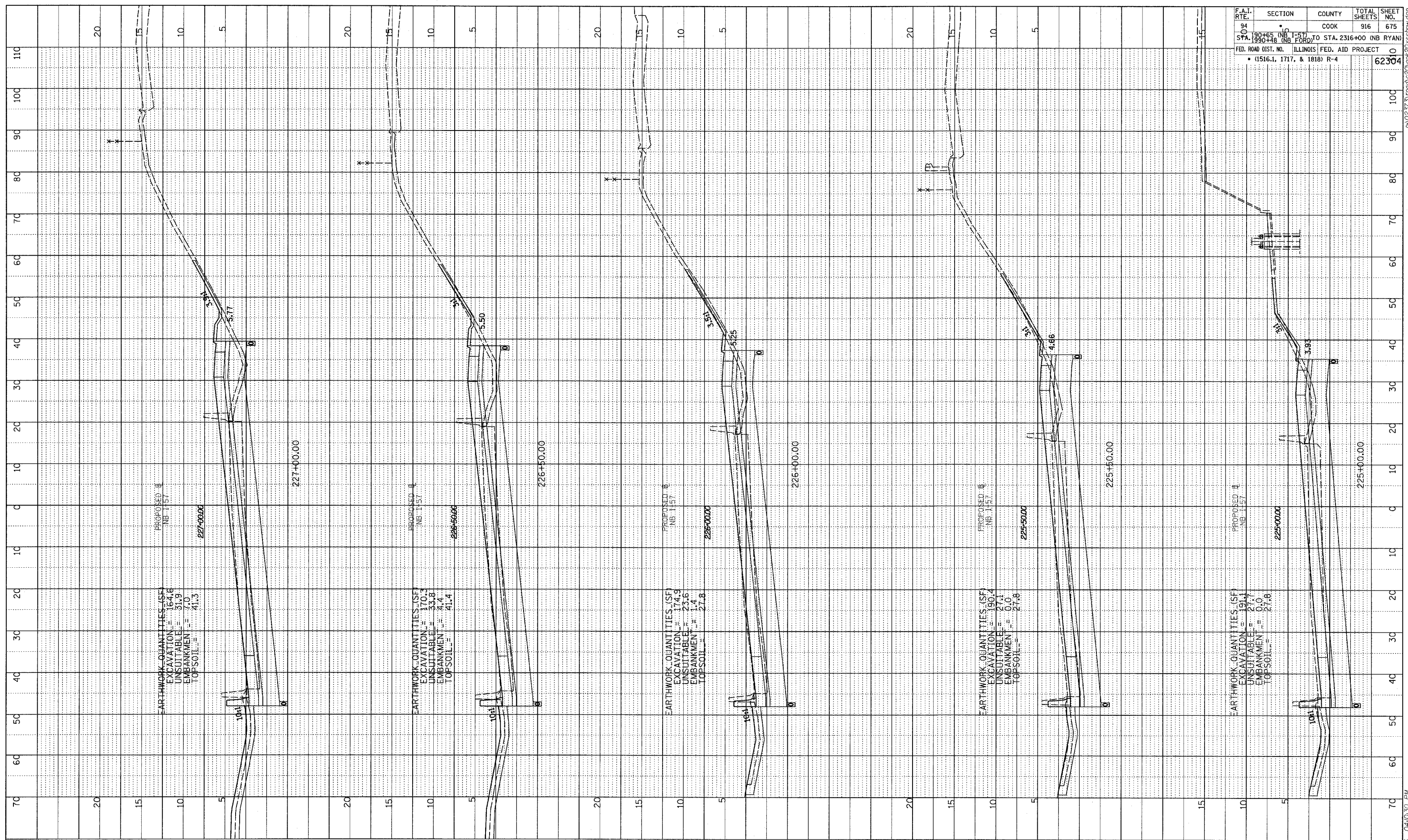

TYLIN INTERNATIONAL



NORTHBOUND I-57
 STA. 225+00 TO STA. 227+00

03/03/2006 04:00:30 PM