

PROFILE	SURVEYED	BY	DATE
NOTE BOOK	GRADES CHECKED		
NO.	S.M. NOTED		
	STRUCTURE NOTATIONS CHD		

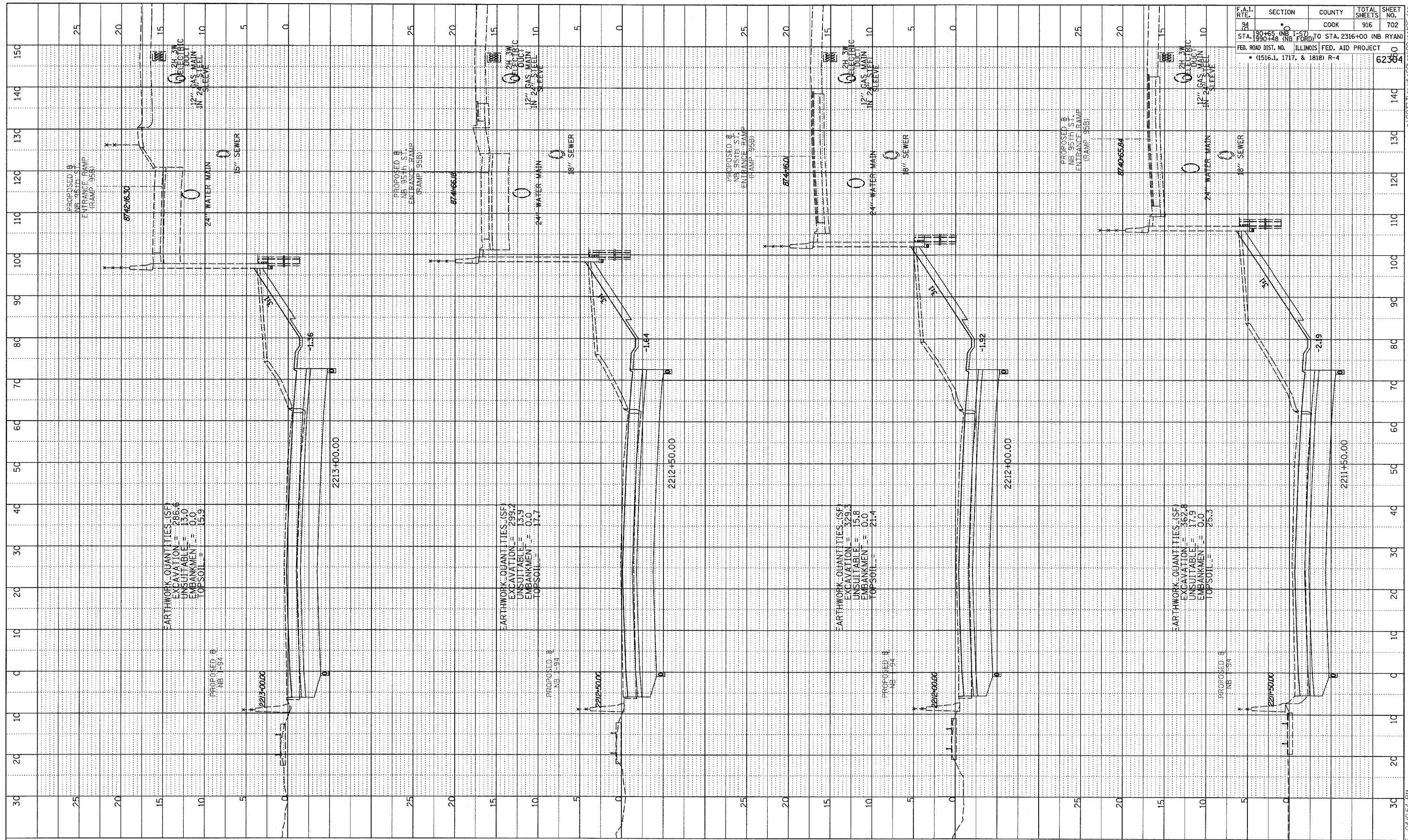

F.A.I. RTE.	SECTION	COUNTY	TOTAL SHEETS	SHEET NO.
94	0	COOK	916	702
STA. 190+48 (NB FORD) TO STA. 2316+00 (NB RYAN)				
FED. ROAD DIST. NO. ILLINOIS FED. AID PROJECT				
• (1516.1, 1717, & 1818) R-4				
				62384

TYLIN INTERNATIONAL



NORTHBOUND I-94 (DAN RYAN EXPWY)  
STA. 2211+50 TO STA. 2213+00

03/03/2006 04:05:41 PM R:\02373\road\0209020\020109195.dgn