

PROFILE SURVEYED  
 PLOTTED  
 GRADES CHECKED  
 STRUCTURE NOTATIONS OK'D  
 NO. \_\_\_\_\_  
 BY \_\_\_\_\_  
 DATE \_\_\_\_\_

F.A.I. RTE.	SECTION	COUNTY	TOTAL SHEETS	SHEET NO.
94	190+65 (NB I-57)	COOK	916	707
	STA. 1990+48 (NB FORD)			TO STA. 2316+00 (NB RYAN)
FED. ROAD DIST. NO. ILLINOIS FED. AID PROJECT				62384
• (1516.1, 1717, & 1818) R-4				

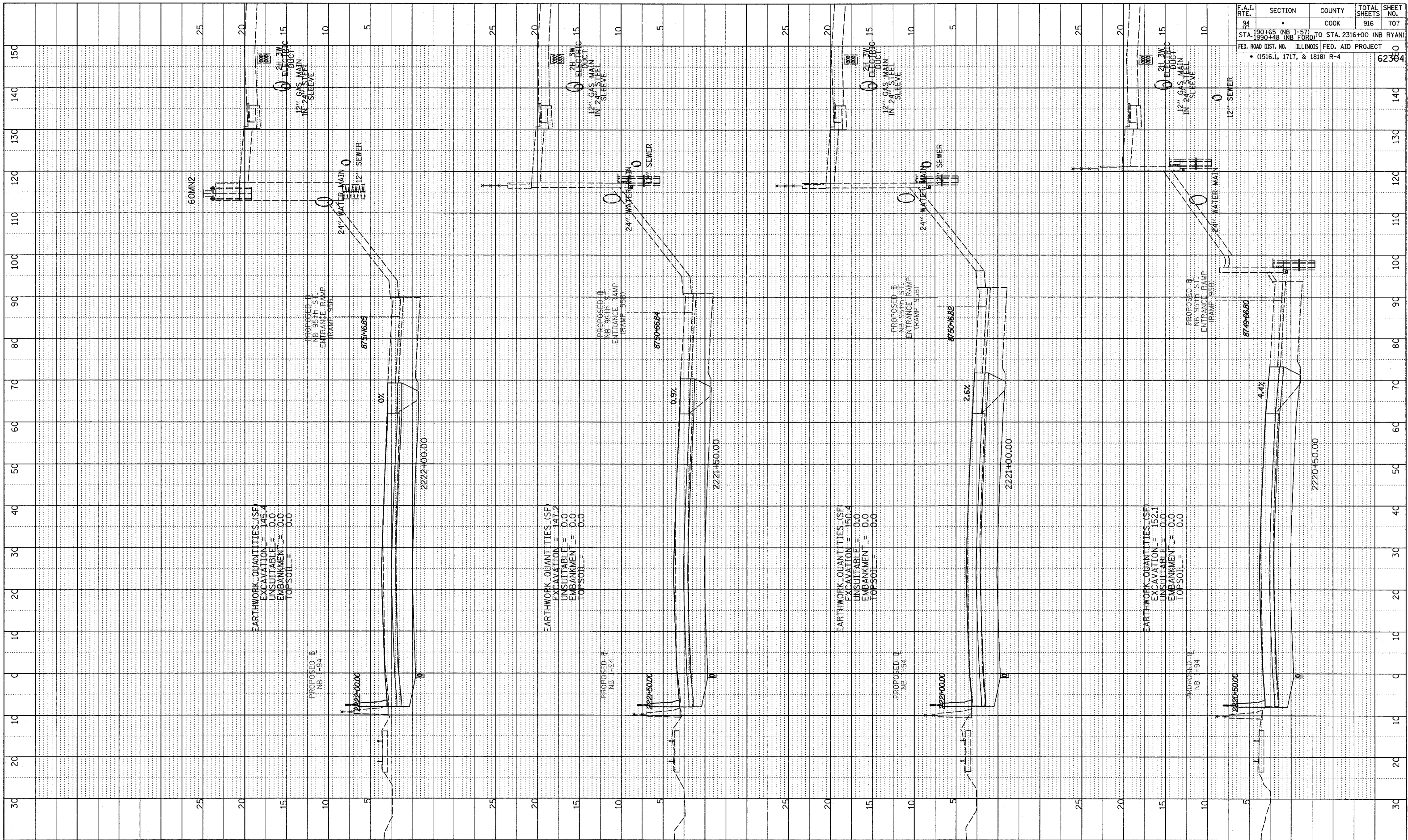

TYLIN INTERNATIONAL

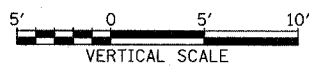
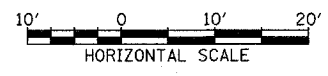

NORTHBOUND I-94 (DAN RYAN EXPWY)  
 STA. 2220+50 TO STA. 2222+00

03/03/2006 04:10:57 PM  
 P:\0237\3\road\20\94\20\2220+50.dgn