

PROFILE	SURVEYED	DATE
	GRADES CHECKED	
	BLM NOTED	
	STRUCTURE NOTATIONS CHECKED	
	NO.	

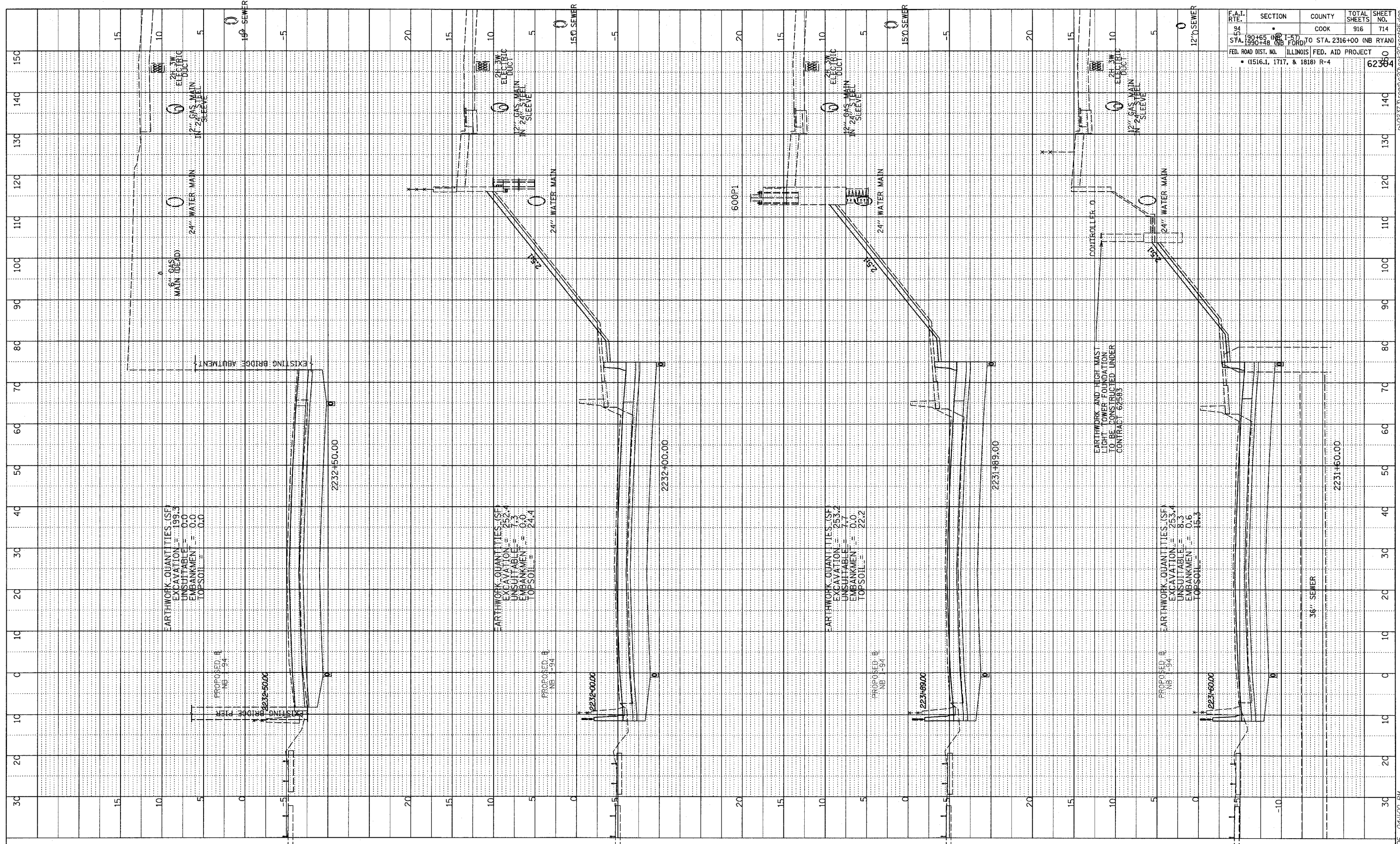

F.A.I. RTE.	SECTION	COUNTY	TOTAL SHEETS	SHEET NO.
54	190+65 (NB I-57) STA. 190+48 (NB FORD) TO STA. 2316+00 (NB RYAN)	COOK	916	714
FED. ROAD DIST. NO. ILLINOIS FED. AID PROJECT			62364	
• (1516.1, 1717, & 1818) R-4				

TYLIN INTERNATIONAL



NORTHBOUND I-94 (DAN RYAN EXPWY)
STA. 2231+60 TO STA. 2232+50

03/03/2006 04:40:00 PM