

PROFILE SURVEYED	DATE
GRADES CHECKED	BY
DATE NOTED	
STRUCTURE NOTATIONS CHECKED	
NO.	

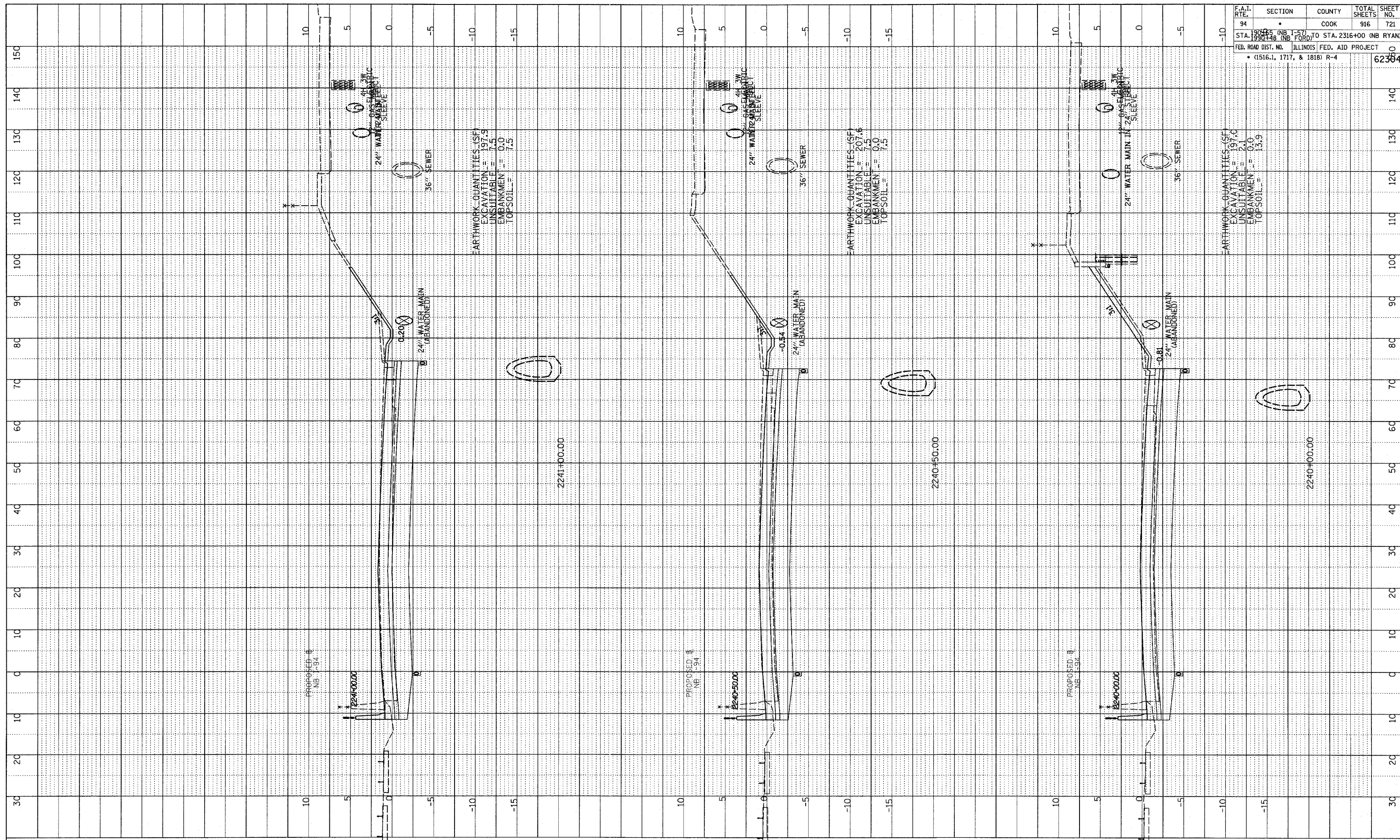

F.A.I. RTE.	SECTION	COUNTY	TOTAL SHEETS	SHEET NO.
94	190445 (NB I-57) TO STA. 2316+00 (NB RYAN)	COOK	916	721
STA. 190448 (NB I-57) TO STA. 2316+00 (NB RYAN)				
FED. ROAD DIST. NO. ILLINOIS FED. AID PROJECT				
• (1516.1, 1717, & 1818) R-4				
				62384

TYLIN INTERNATIONAL

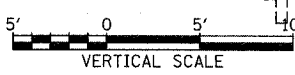
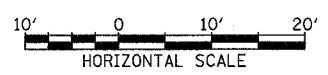

NORTHBOUND I-94 (DAN RYAN EXPWY)
STA. 2240+00 TO STA. 2241+00

03/03/2006 04:05 PM