

DATE	BY
PROFILE SURVEYED _____ NOTE BOOK _____ GRADES CHECKED _____ B.M. NOTED _____ NO. _____ STRUCTURE NOTATIONS CHFD	

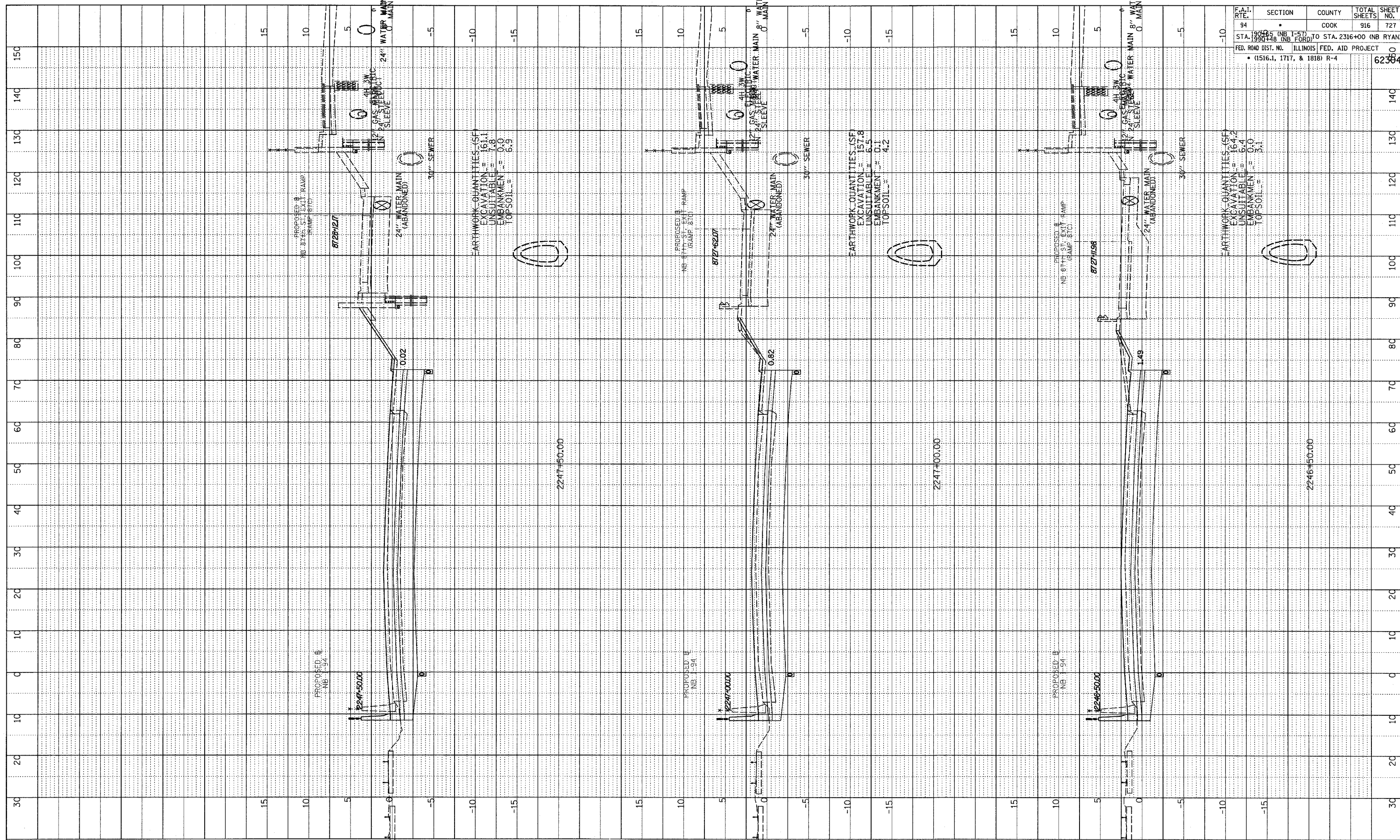

F.A.T. RTE.	SECTION	COUNTY	TOTAL SHEETS	SHEET NO.
94		COOK	916	727
STA. 1991+50 (NB I-57) TO STA. 2316+00 (NB RYAN)				
FED. ROAD DIST. NO. ILLINOIS		FED. AID PROJECT		
(1516.1, 1717, & 1818) R-4				

TYLIN INTERNATIONAL

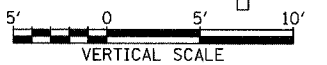

NORTHBOUND I-94 (DAN RYAN EXPWY)  
 STA. 2246+50 TO STA. 2247+50

03/03/2006 04:40:08 PM