

PROFILE SURVEYED: _____ DATE: _____
 GRADES CHECKED: _____
 NOTE BOOK NO. _____
 SURVEYOR'S NAME: _____
 NO. _____
 BY: _____

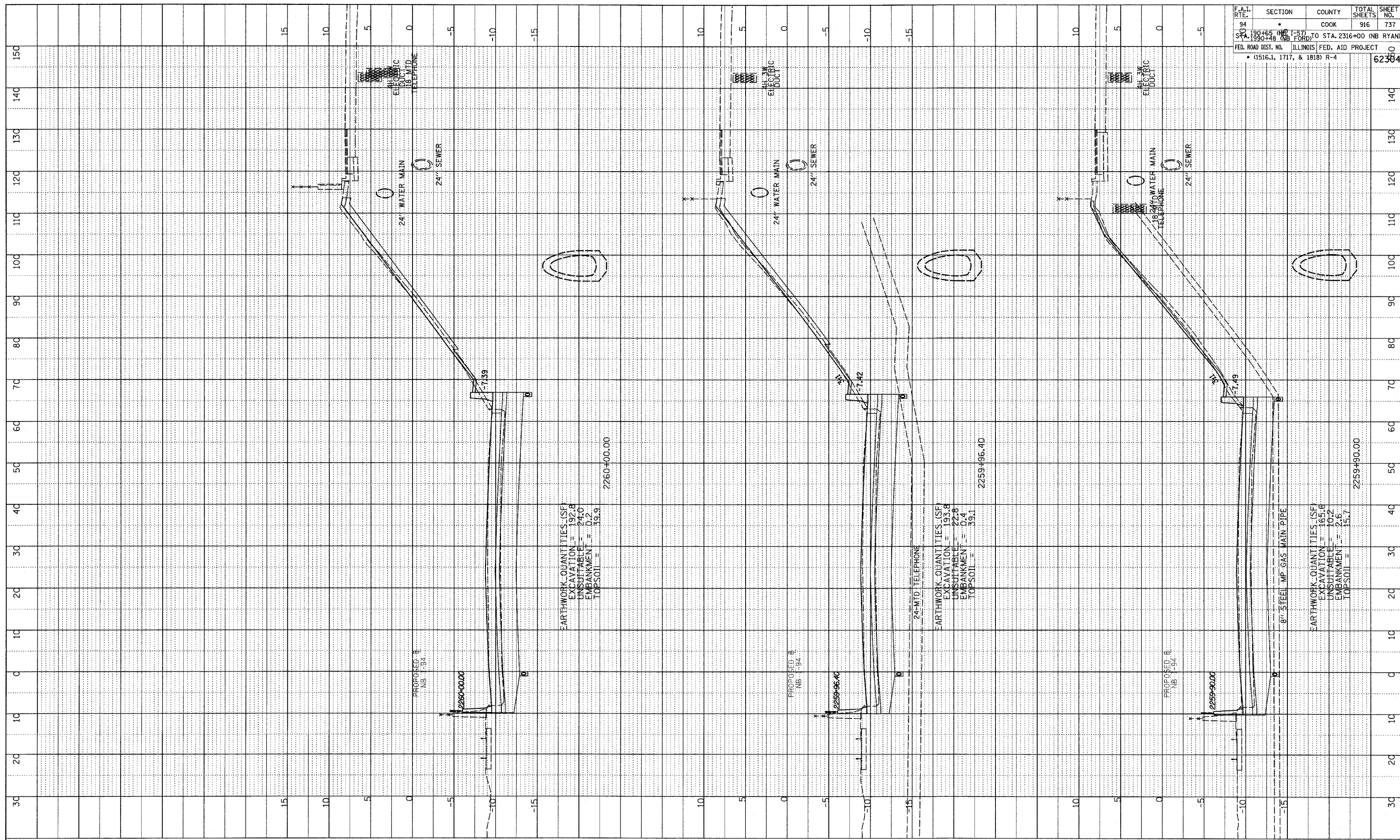

F.A.I. RTE.	SECTION	COUNTY	TOTAL SHEETS	SHEET NO.
94	•	COOK	916	737
STA. 190+65 (NB I-57)	TO STA. 2316+00 (NB RYAN)			
STA. 1990+48 (NB I-57)	ILLINOIS FED. AID PROJECT			
FED. ROAD DIST. NO. (1516.1, 1717, & 1818) R-4			62384	

TYLIN INTERNATIONAL

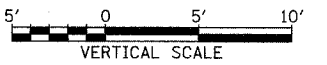

NORTHBOUND I-94 (DAN RYAN EXPWY)
 STA. 2259+90 TO STA. 2260+00

03/03/2005 04:48:27 PM