

DATE	BY
PROFILE SURVEYED GRADES CHECKED E.M. NOTED STRUCTURE NOTATIONS CHECKED	
NO.	

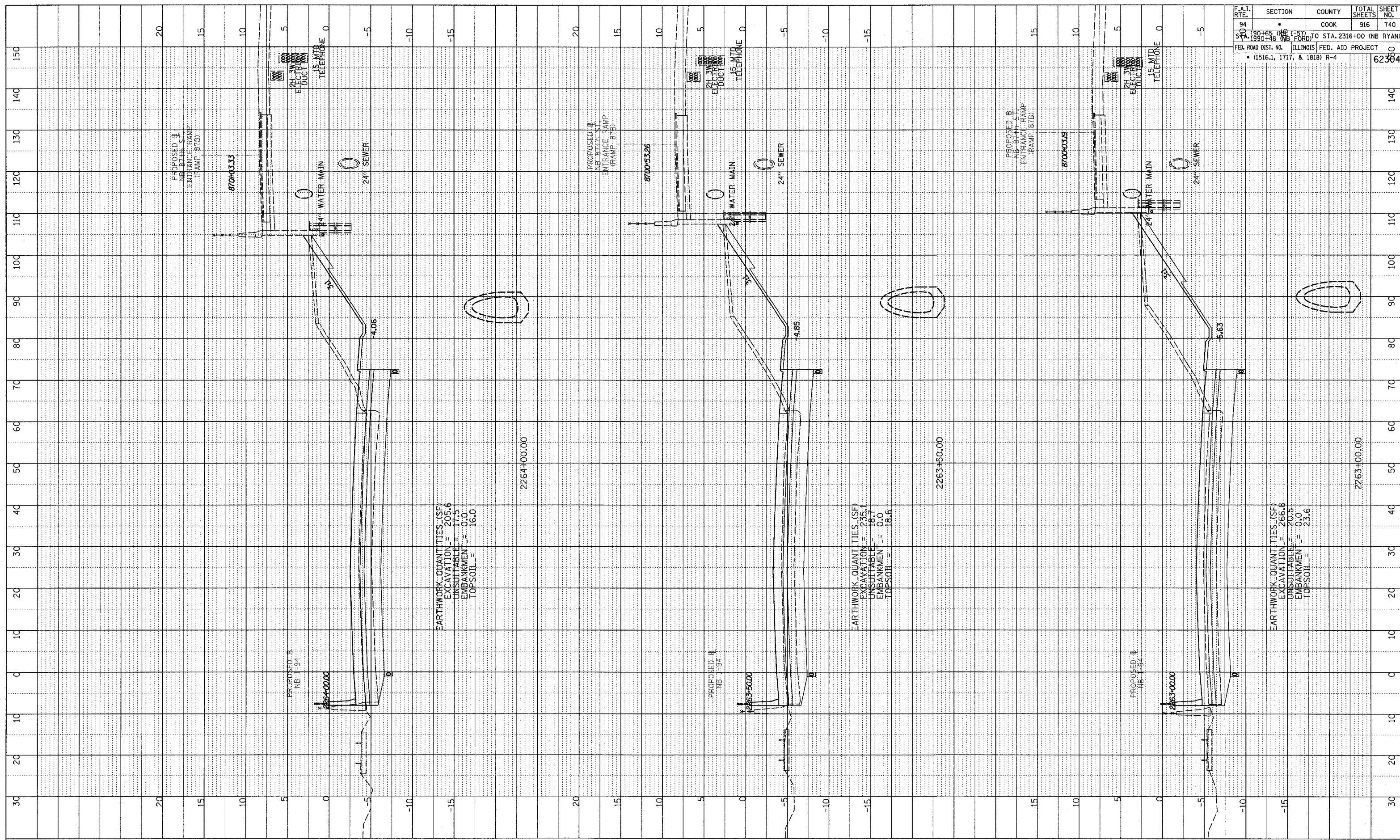

F.A.I. RTE.	SECTION	COUNTY	TOTAL SHEETS	SHEET NO.
94	•	COOK	916	740
STA. 190+65 (NB I-94) TO STA. 2316+00 (NB RYAN)				
STA. 190+65 (NB I-94) TO STA. 2316+00 (NB RYAN)				
FED. ROAD DIST. NO.	ILLINOIS	FED. AID PROJECT		
(1516.1, 1717, & 1818)	R-4			
			62	384

TYLIN INTERNATIONAL

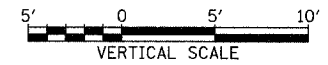
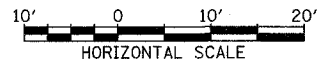

NORTHBOUND I-94 (DAN RYAN EXPWY)
 STA. 2263+00 TO STA. 2264+00

03/03/2006 04:48:29 PM