

DATE	
BY	
PROFILE SURVEYED	
GRADES CHECKED	
E.M. NOTED	
NO. PROPOSED	
NO. DATE NOTATIONS	

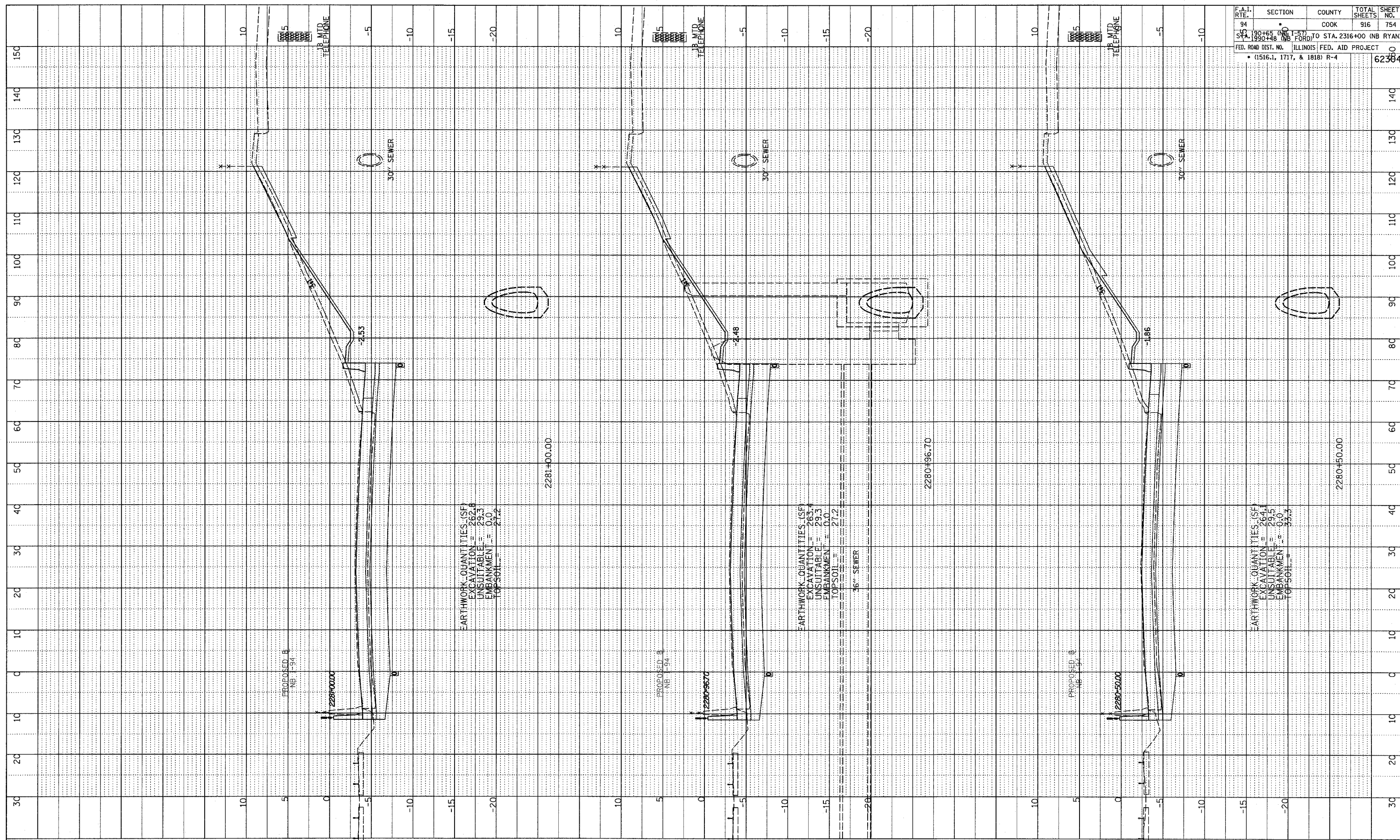

F.A.I. RTE.	SECTION	COUNTY	TOTAL SHEETS	SHEET NO.
94	190+65 (NB I-57) TO STA. 2316+00 (NB RYAN)	COOK	916	754
	STA. 190+38 (NB FORD)			
ILLINOIS FED. AID PROJECT				
• (1516.1, 1717, & 1818) R-4				
				62384

TYLIN INTERNATIONAL

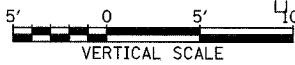

NORTHBOUND I-94 (DAN RYAN EXPWY)  
STA. 2280+50 TO STA. 2281+00

03/03/2006 04:48:36 PM