

PROFILE SURVEYED  
 GRADES CHECKED  
 NOTE BOOK  
 E.M. NOTED  
 STRUCTURE NOTATIONS CHECKED  
 NO. \_\_\_\_\_  
 DATE \_\_\_\_\_  
 BY \_\_\_\_\_

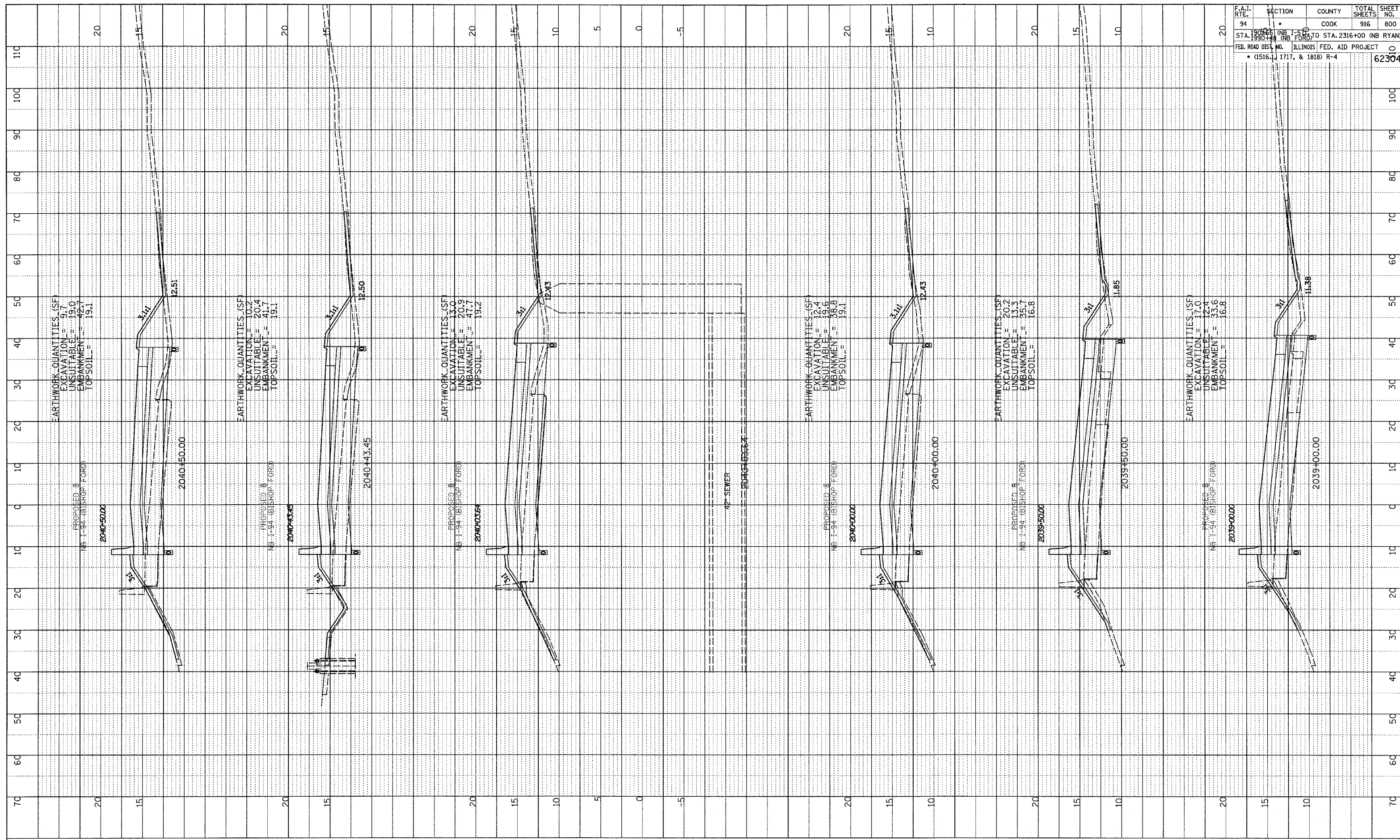

F.A.I. RTE.	SECTION	COUNTY	TOTAL SHEETS	SHEET NO.
94	190+00 TO STA. 2316+00 (NB RYAN)	COOK	916	800
STA. 190+00 (NB FORD) TO STA. 2316+00 (NB RYAN) ILLINOIS FED. AID PROJECT (1516, 1717, & 1818) R-4				

TYLIN INTERNATIONAL

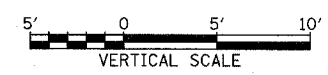
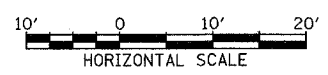

NORTHBOUND I-94 (BISHOP FORD EXPWY)  
 STA. 2039+00 TO STA. 2040+50

03/03/2006 04:49:17 PM