

SIGNS ON THIS SHEET SHALL BE PAID FOR AS "TRAFFIC CONTROL AND PROTECTION FOR DETOUR ROUTE". 1 LUMP SUM.

LEGEND

- M4-5 (30" X 15")
- M3-2 (24" X 12")
- M4-8 (24" X 12")
- M1-1 (24" X 24")
- M20-2 (36" X 36")
- M4-9L (30" X 24")
- M4-9R (30" X 24")
- M6-2 (21" X 15")
- M6-3 (21" X 15")
- M5-1R (21" X 15")
- M5-1L (21" X 15")
- DETOUR ROUTE
- CLOSED TO TRAFFIC
- M4-8a (24" X 18")
- PERSON DIRECTING TRAFFIC

PORTABLE CHANGEABLE MESSAGE SIGNS SHALL BE PLACED IN ADVANCE OF THE DETOUR AS DETAILED IN THE SPECIAL PROVISIONS.

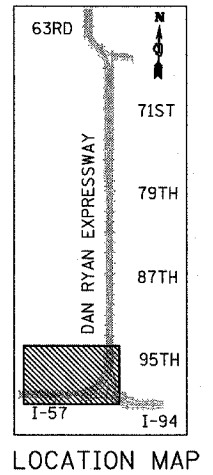
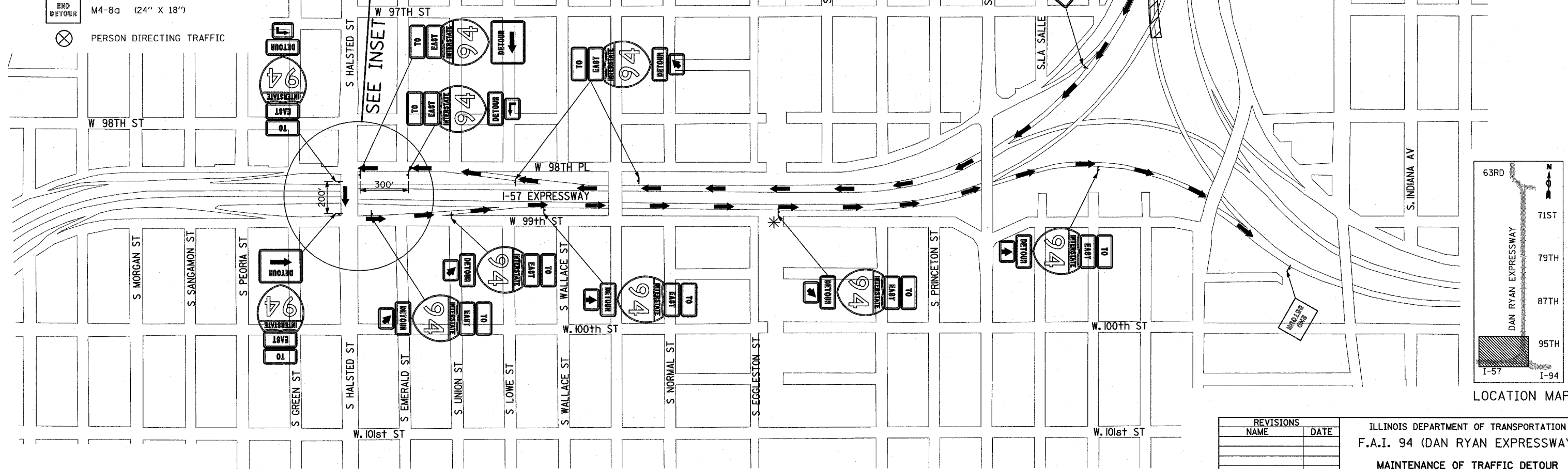
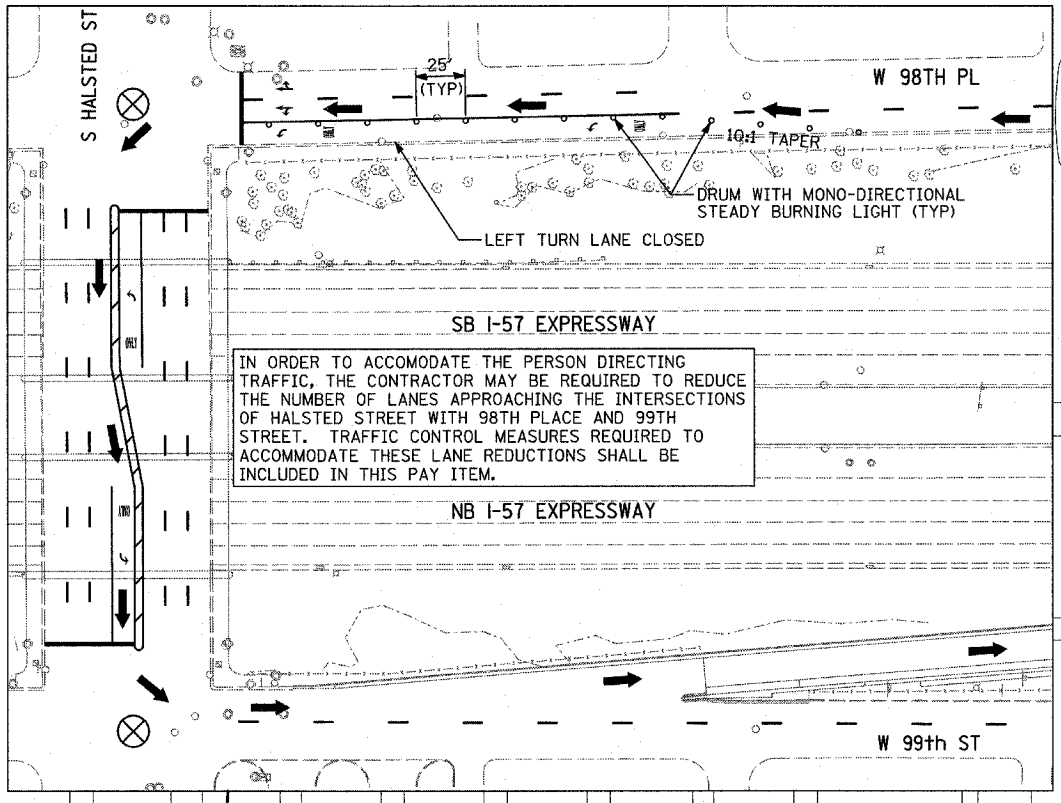

TYLIN INTERNATIONAL

FOR INFORMATION ONLY

* LOCATION OF THESE SIGNS WILL VARY TO REFLECT THE CURRENT MAINTENANCE OF TRAFFIC CONFIGURATION. DETOUR TRAILBLAZER SIGNS ARE TO BE PLACED ADJACENT TO THE START OF THE GORE.

REVISIONS	
NAME	DATE

ILLINOIS DEPARTMENT OF TRANSPORTATION
 F.A.I. 94 (DAN RYAN EXPRESSWAY)
 MAINTENANCE OF TRAFFIC DETOUR
 SOUTHBOUND I-94 (BISHOP FORD FREEWAY)
 CLOSURE FOR BOX BEAMS REPLACEMENT

SCALE: NO SCALE
 DATE: MAY 8, 2006

DRAWN BY: JJS
 CHECKED BY: TGB

NEW SHEET 05/08/06