

F.A.I. RTE.	SECTION	COUNTY	TOTAL SHEETS	SHEET NO.
94		COOK	764	100
STA. 88+60 (SB I-57) TO STA. 1313+00 (SB RYAN)				
FED. ROAD DIST. NO. ILLINOIS FED. AID PROJECT				
• (1516.1, 1717, & 1818) R-5 62593				

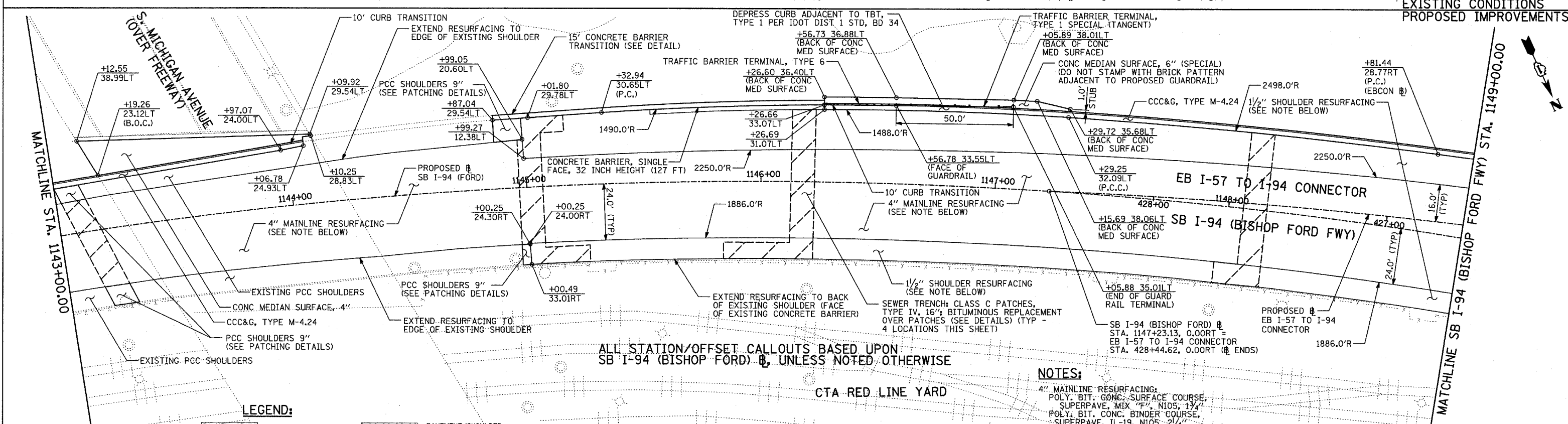
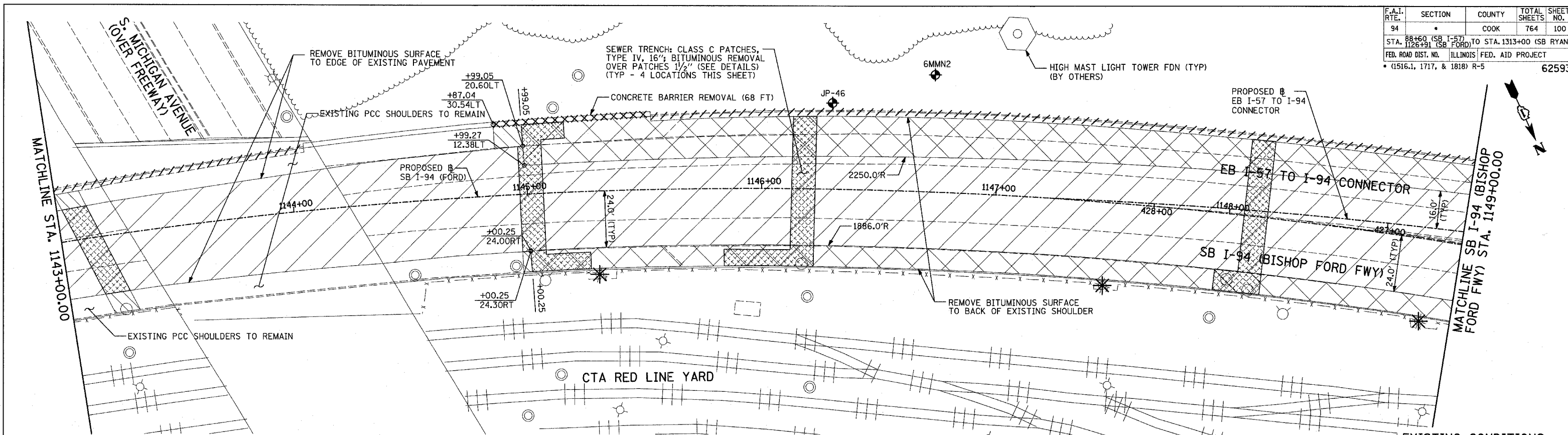

**TYLIN INTERNATIONAL**

**LEGEND:**

	PAVEMENT REMOVAL		PAVEMENT/SHOULDER REMOVAL (SPECIAL) OVER EXISTING UTILITIES
	PAVED SHOULDER REMOVAL		COMB CONC CURB & GUTTER REMOVAL
	BITUMINOUS SURFACE REMOVAL, 4\"/>		CHAIN LINK FENCE REMOVAL
	BITUMINOUS SURFACE REMOVAL, 1 1/2\"/>		CONCRETE BARRIER/GUARDRAIL REMOVAL
	BITUMINOUS SURFACE REMOVAL, 1 3/4\"/>		SOIL BORING LOCATIONS
			LIGHT POLE FOUNDATION REMOVAL (SEE ROADWAY LIGHTING & SURVEILLANCE PLANS)

**PLAN NOTES:**

- ALL STATION/OFFSET/RADIUS CALLOUTS MEASURED TO EDGE OF PAVEMENT UNLESS OTHERWISE NOTED.
- EXACT LOCATIONS OF EXISTING PIERS/ABUTMENTS TO BE FIELD VERIFIED

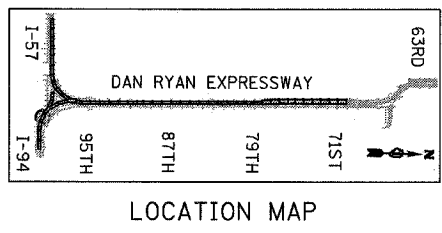

**NOTES:**

4\"/>

1 1/2\"/>

SCALE: 1" = 20'-0"

REVISIONS	
NAME	DATE

ILLINOIS DEPARTMENT OF TRANSPORTATION  
**F.A.I. 94 (DAN RYAN EXPRESSWAY)**  
**EXISTING AND PROPOSED PLAN**  
**SB I-94 (BISHOP FORD FREEWAY)**  
**BISHOP FORD STA. 1143+00.00 TO 1149+00.00**

SCALE: 1"=20'  
DATE: MARCH 1, 2006  
DRAWN BY: MPG  
CHECKED BY: RTM