

SUGGESTED ACCESS FROM EXPRESS LANES

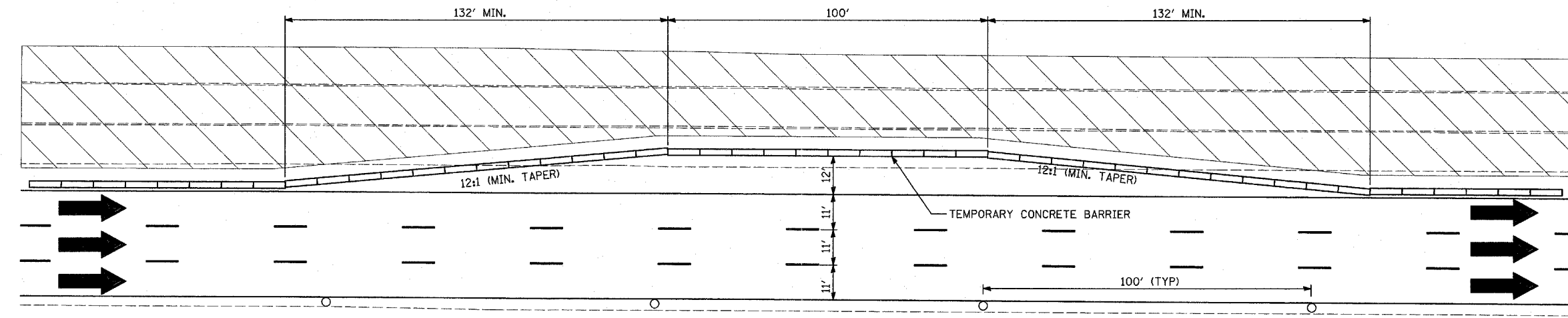

MAINTENANCE OF TRAFFIC EMERGENCY TURNOUT DETAIL
EMERGENCY TURNOUTS WILL BE LOCATED APPROXIMATELY EVERY HALF MILE.

- LEGEND:**
- TEMPORARY CONCRETE BARRIER
 - TRAFFIC LANE
 - CONSTRUCTION TRAFFIC
 - WORK ZONE
 - DRUM WITH MONO-DIRECTIONAL STEADY BURNING LIGHT
 - ARROW BOARD

NOTES:

1. THERE CAN BE NO MORE THAN TWO (2) WORK ZONE ACCESS/EGRESS COMBINATIONS AND THE CONTRACTOR MUST MAINTAIN AT LEAST ONE (1) EXPRESS LANE ACCESS DURING STAGE 2 CONSTRUCTION.
2. THE CONTRACTOR SHALL NOT ENTER OR EXIT THE HAUL ROAD WITHIN THE 100' BARREL-SPACING AREA. WORK ZONE ACCESS AND EGRESS WILL ONLY BE PERMITTED AT THE DESIGNATED LOCATIONS.
3. FOR EXPRESS LANE WORK ZONE EGRESS, TAPER LENGTHS SHALL FOLLOW DISTRICT 1 STANDARD TC-18.
4. THE CONTRACTOR SHALL CLOSE OPENINGS WITH BARRELS WHEN NOT BEING USED FOR ACCESS.
5. TEMPORARY PAVEMENT MARKINGS SHALL BE CARRIED THRU THE OPENING.

TYLIN INTERNATIONAL

| REVISIONS | |
|-----------|------|
| NAME | DATE |
| | |
| | |
| | |
| | |
| | |
| | |
| | |
| | |
| | |
| | |

ILLINOIS DEPARTMENT OF TRANSPORTATION
F.A.I. 94 (DAN RYAN EXPRESSWAY)
GENERAL NOTES
CONSTRUCTION STAGING NOTES
MAINTENANCE OF TRAFFIC DETAILS
SHEET 12 OF 12

SCALE: NO SCALE DRAWN BY: RTM
DATE: MARCH 1, 2006 CHECKED BY: TGB