

NOTES:

1. PROPOSED DETOUR TRAILBLAZER TO BE REMOVED AFTER APPROPRIATE ENTRANCE RAMP HAS BEEN OPENED. COST SHALL BE INCLUDED IN TEMPORARY INFORMATION SIGNING. SEE SHEET 1 OF STAGE 1 CONSTRUCTION SIGNING PLANS FOR TRAILBLAZER SIZE.
2. REMOVED SIGN PANEL SHALL BECOME THE PROPERTY OF CONTRACTOR AND BE DISPOSED OFFSITE.
3. RELOCATION OF SIGNS SHALL BE INCLUDED IN THE COST OF TEMPORARY INFORMATION SIGNING.
4. SEE DETOUR SHEET FOR SIGNING REQUIRED WHEN 87TH ST. ENTRANCE RAMP IS CLOSED.
5. REMOVAL & STORAGE OF PERMANENTS SIGNS ON TRUSS SHALL BE PAID FOR AS "REMOVE, STORE AND RE-ERECT SIGN PANEL".

F.A.I. RTE.	SECTION	COUNTY	TOTAL SHEETS	SHEET NO.
94		COOK	764	236
STA. 88+60 (SB I-57) TO STA. 1313+00 (SB RYAN)				
FED. ROAD DIST. NO. ILLINOIS FED. AID PROJECT				
• (1516.1, 1717, & 1818) R-5 62593				

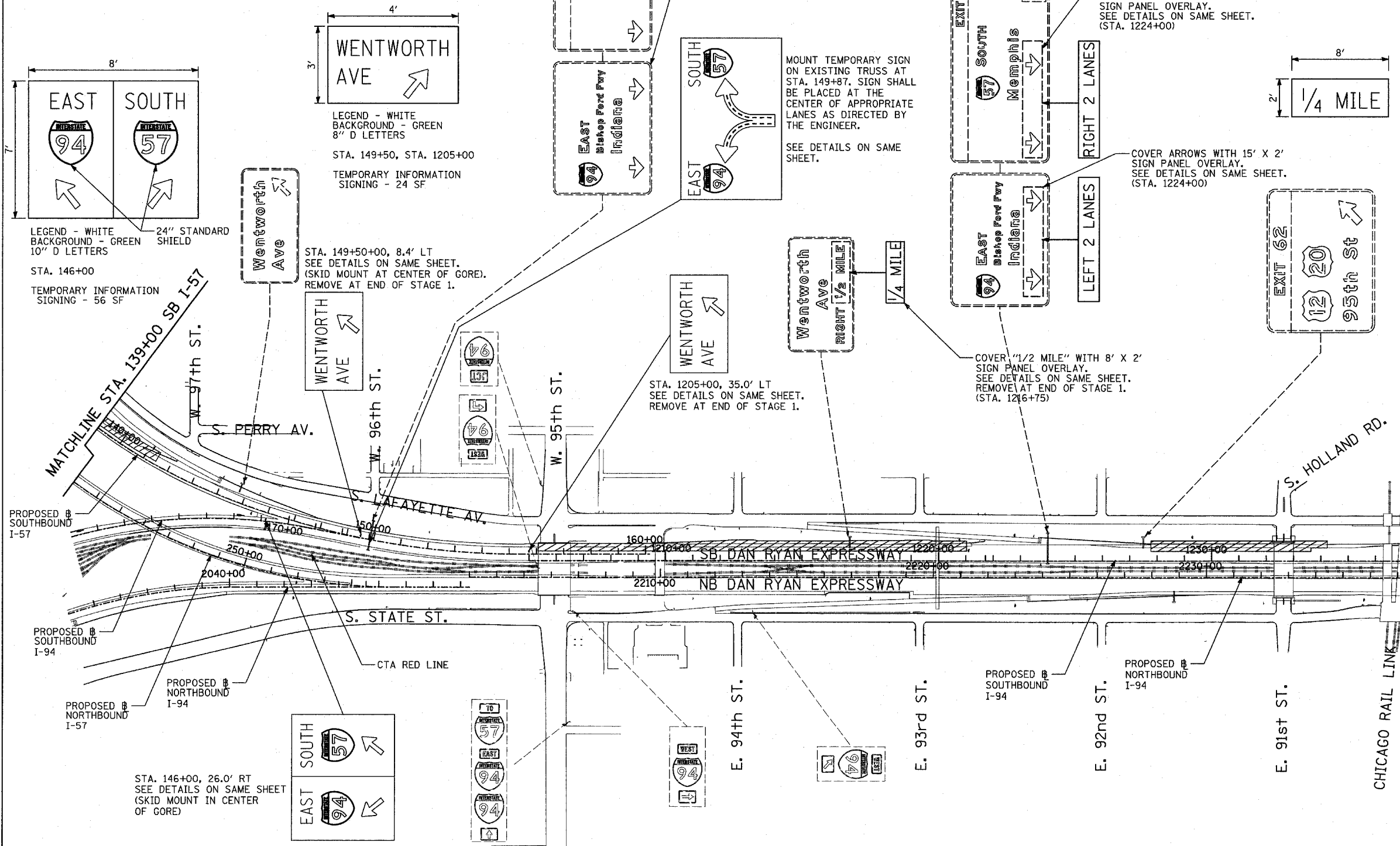

LEGEND - WHITE BACKGROUND - GREEN 10" E LETTERS
 STA. 1224+00
 TEMPORARY INFORMATION SIGNING - 30 SF

LEGEND - WHITE BACKGROUND - GREEN 10" E LETTERS
 STA. 1224+00
 TEMPORARY INFORMATION SIGNING - 30 SF

LEGEND - BLACK BACKGROUND - ORANGE 10" E LETTERS
 STA. 1216+75
 TEMPORARY INFORMATION SIGNING - 16 SF

LEGEND - BLACK BACKGROUND - ORANGE 10" E LETTERS
 STA. 1216+75
 TEMPORARY INFORMATION SIGNING - 16 SF

SIGNING LEGEND:

- EXISTING GROUND MOUNTED SIGN
- EXISTING OVERHEAD TRUSS MOUNTED SIGN
- EXISTING OVERHEAD SIGN STRUCTURE-BRIDGE MOUNTED
- EXISTING OVERHEAD CANTILEVER MOUNTED SIGN
- PROPOSED GROUND MOUNTED SIGN
- PROPOSED OVERHEAD SIGN STRUCTURE - TRUSS
- CONSTRUCTION ZONE
- EXISTING SIGN
- EXISTING SIGN TO BE REMOVED
- PROPOSED SIGN

24" STANDARD SHIELD (TYP)

LEGEND - WHITE BACKGROUND - GREEN 10" E LETTERS
 STA. 149+87
 TEMPORARY INFORMATION SIGNING - 80.5 SF

LOCATION MAP

TYLIN INTERNATIONAL

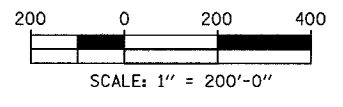

REVISIONS	
NAME	DATE

ILLINOIS DEPARTMENT OF TRANSPORTATION
 F.A.I. 94 (DAN RYAN EXPRESSWAY)
 CONSTRUCTION SIGNING-STAGE 1 & 1A
 STA. 139+00 TO STA. 1237+00
 SHEET 2 OF 4

SCALE: 1" = 200' DRAWN BY: AMB
 DATE: MARCH 1, 2006 CHECKED BY: TGB