

EXISTING CONDITIONS  
PROPOSED IMPROVEMENTS

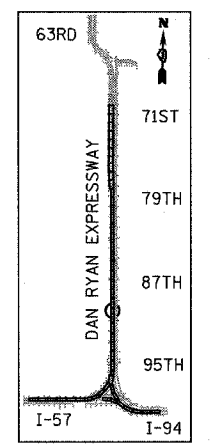

LOCATION MAP

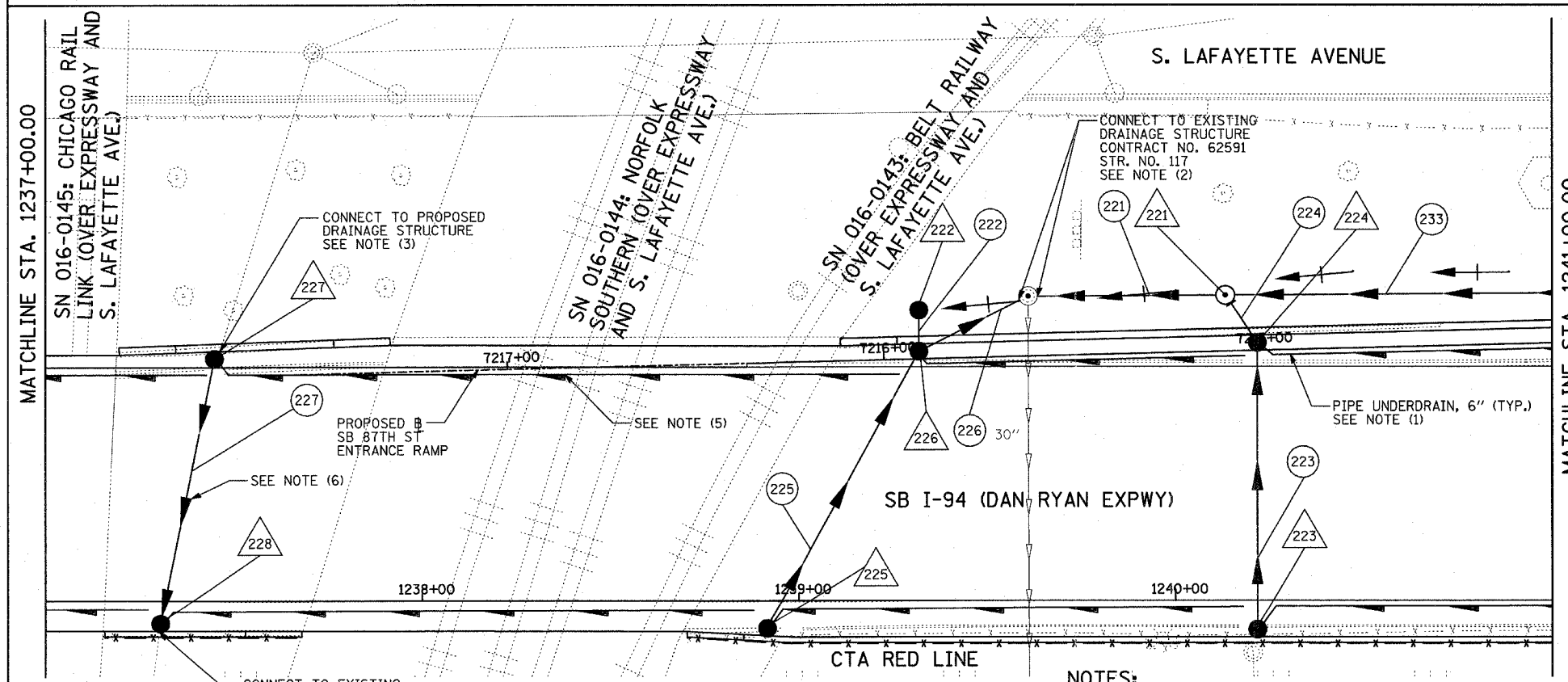
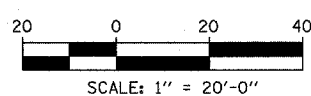

TYLIN INTERNATIONAL

**LEGEND:**

	EXISTING COMBINED SEWER		SEWER PLUG
	PROPOSED STORM SEWER NUMBER (X=SHEET NO., Y=PIPE NO.)		FIELD VERIFY
	PROPOSED STRUCTURE NUMBER (X=SHEET NO., Y=STRUCTURE NO.)		UTILITY REMOVAL
	PIPE STUBOUT TO BE PLUGGED		PROPOSED CATCH BASIN CONSTRUCTED IN CONCURRENT CONTRACT 62304
			PROPOSED STORM SEWER CONSTRUCTED IN CONCURRENT CONTRACT 62304

- NOTES:**
- FOR CLARITY, PIPE UNDERDRAINS ARE SHOWN OFFSET FROM THEIR PROPOSED LOCATIONS. FOR DETAILED PLACEMENT, SEE SHEET "PIPE UNDERDRAINS DETAIL."
  - CORE DRILL AND CONNECT TO EXISTING DRAINAGE STRUCTURE. CONNECTION COST SHALL BE INCLUDED IN THE COST TO CONSTRUCT THE STORM SEWER.
  - COST SHALL NOT BE PAID FOR SEPARATELY BUT INCLUDED IN COST OF SEWER INSTALLATION.
  - ALL CONNECTIONS TO EXISTING SEWER OR STRUCTURE ALONG CTA SHALL BE FIELD VERIFIED PRIOR TO INSTALLATION AND COORDINATED WITH CTA CONSTRUCTION. COST SHALL BE INCLUDED IN THE COST TO CONSTRUCT THE DRAINAGE STRUCTURE.
  - PROPOSED PIPE UNDERDRAIN SYSTEM LOCATION SHALL BE COORDINATED WITH PROPOSED ELECTRICAL DUCT BANK AND EXISTING FOOTING. SEE TYPICAL SECTIONS AND DETAILS FOR OVERPASS FOOTINGS.
  - REMOVE EXISTING 18" SEWER AND REPLACE IN KIND (I.E., SAME SIZE AND SLOPE). THE CONTRACTOR SHALL VERIFY FIELD CONDITIONS PRIOR TO ORDER OF MATERIAL.

SHEET 22 OF 65

REVISIONS	
NAME	DATE

ILLINOIS DEPARTMENT OF TRANSPORTATION  
F.A.I. 94 (DAN RYAN EXPRESSWAY)  
DRAINAGE AND UTILITY PLAN  
SB I-94 (DAN RYAN EXPRESSWAY)  
SB I-94 STA. 1237+00.00 TO 1241+00.00

SCALE: 1"=20'  
DATE: MARCH 1, 2006

DRAWN BY: NSB  
CHECKED BY: DA