

PROFILE SHEET
 DATE: _____
 PLOTTED: _____
 NO. _____
 STRUCTURE: _____
 STATUS: _____
 CHD: _____

F.A.I. RTE.	SECTION	COUNTY	TOTAL SHEETS	SHEET NO.
94	88+60 (SB I-57) TO STA. 1126+31 (SB FORD)	COOK	764	551
	TO STA. 1313+00 (SB RYAN)			
	FED. ROAD DIST. NO. ILLINOIS FED. AID PROJECT			0
	• (1516.1, 1717, & 1818) R-5			62593

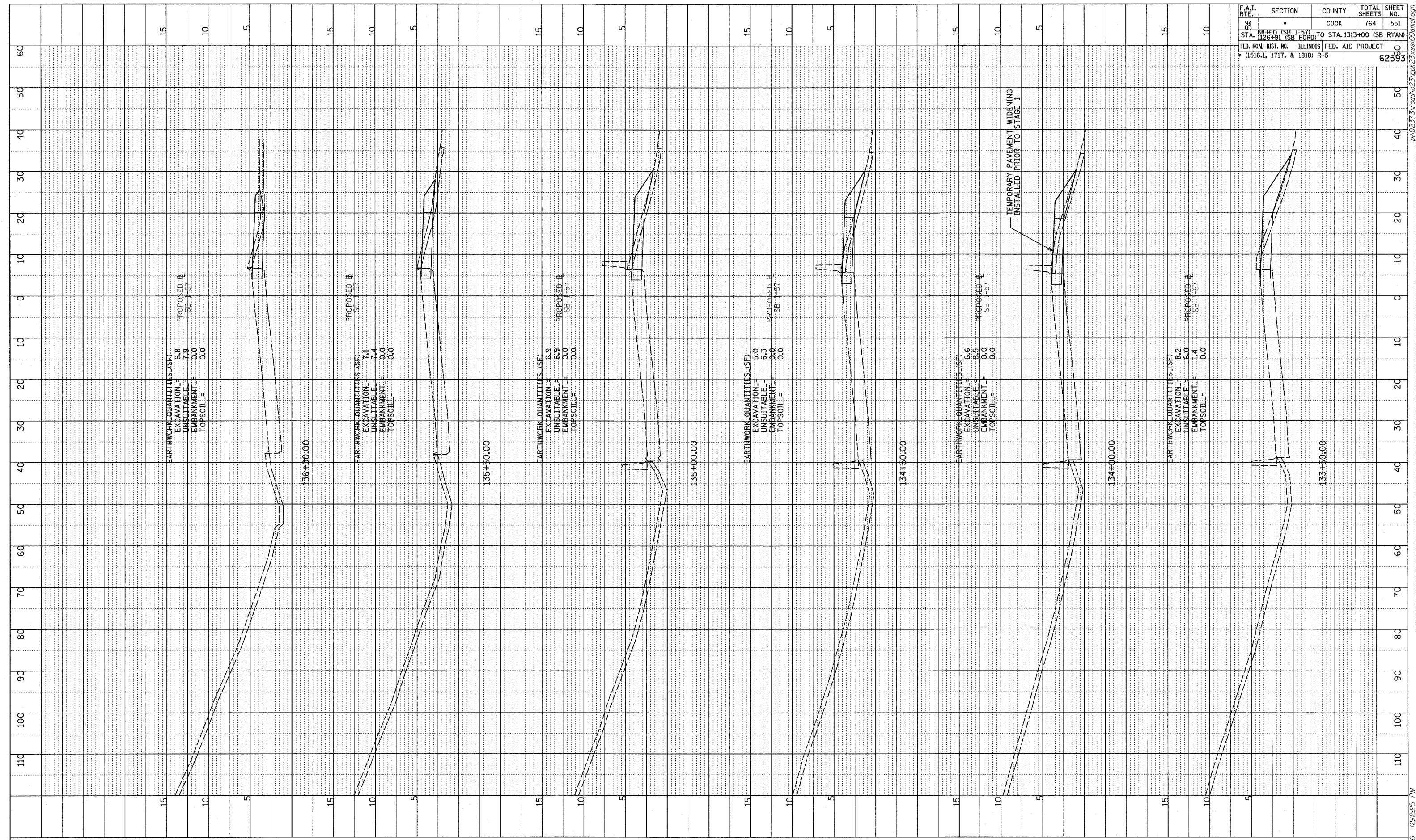

TEMPORARY PAVEMENT WIDENING
 INSTALLED PRIOR TO STAGE 1

TYLIN INTERNATIONAL

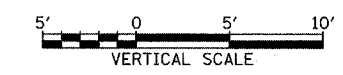
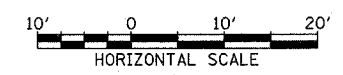

PRE STAGE 1 TEMP PAVEMENT FOR MOT I-57 SOUTHBOUND STA. 133+50 TO STA. 136+00

02/27/2006 12:25 PM