

PROFILE SHEET
 DATE
 ST
 PROFILE SHEET
 DATE
 ST
 PROFILE SHEET
 DATE
 ST

F.A.I. RTE.	SECTION	COUNTY	TOTAL SHEETS	SHEET NO.
94	88+60 (SB) TO STA. 1126+91 (SB FORD)	COOK	764	553
	STA. 1126+91 (SB FORD) TO STA. 1313+00 (SB RYAN)			
FED. ROAD DIST. NO. ILLINOIS FED. AID PROJECT				62593
(1516.1, 1717, & 1818) R-5				

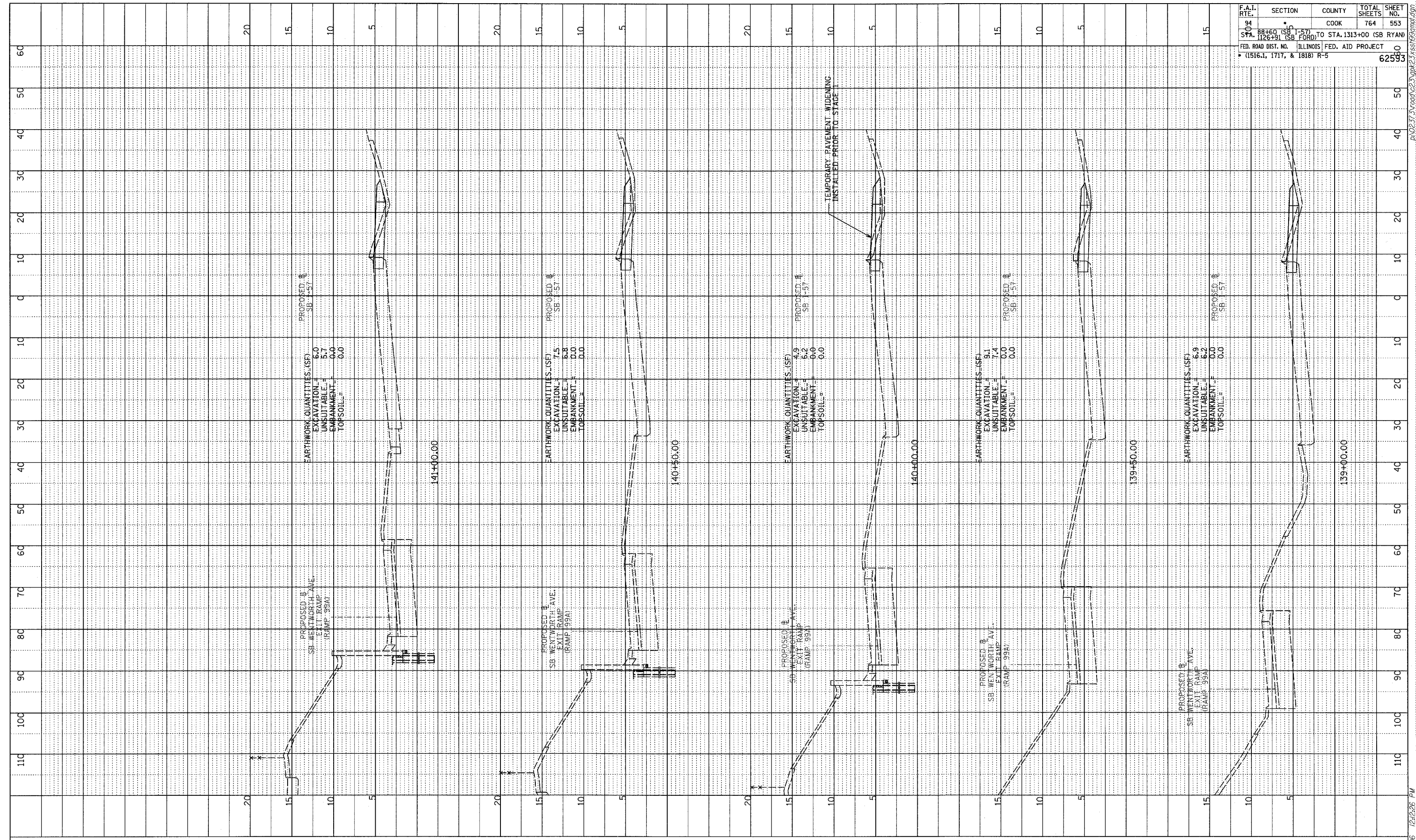

TYLIN INTERNATIONAL

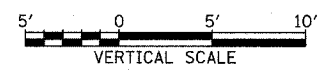
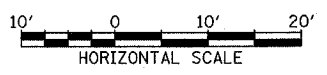

PRE STAGE 1 TEMP PAVEMENT FOR MOT I-57 SOUTHBOUND STA. 139+00 TO STA. 141+00

02/27/2006 12:26 PM