

SURVEYED \_\_\_\_\_  
 CHECKED \_\_\_\_\_  
 GRADES \_\_\_\_\_  
 E.M. NOTED \_\_\_\_\_  
 NO. \_\_\_\_\_  
 STRUCTURE NOTATIONS CHRD

F.A.I. RTE.	SECTION	COUNTY	TOTAL SHEETS	SHEET NO.
94	88+60 (SB) TO STA. 1313+00 (SB RYAN)	COOK	764	588
	1126+91 (SB FORD)			
FED. ROAD DIST. NO. ILLINOIS FED. AID PROJECT				62593
(1516.1, 1717, & 1818) R-5				

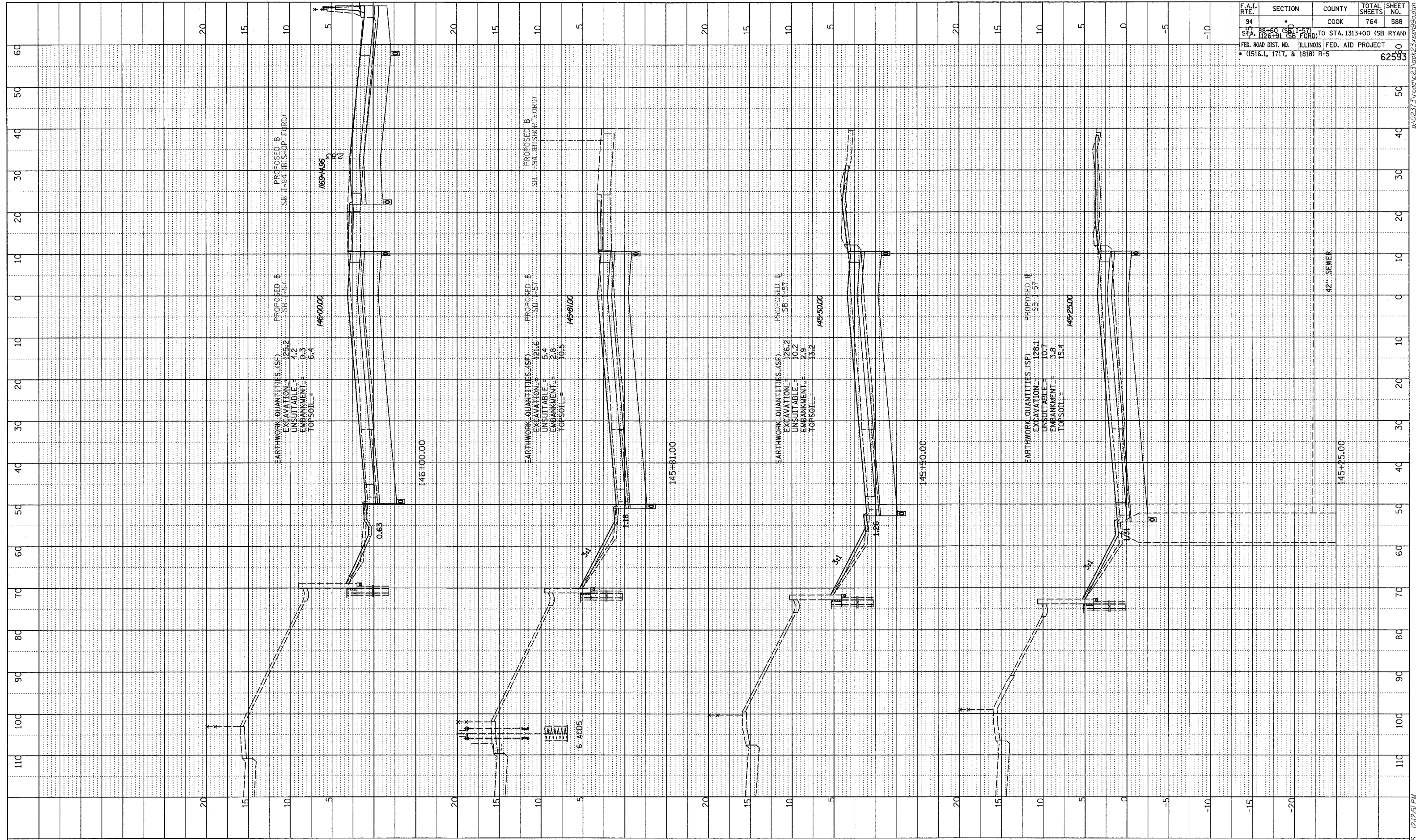

TYLIN INTERNATIONAL

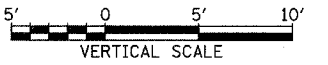

I-57 SOUTHBOUND  
 STA. 145+25 TO STA. 146+00

02/27/2006 12:25 PM