

F.A.I. RTE.	SECTION	COUNTY	TOTAL SHEETS	SHEET NO.
94		COOK	764	591
STA. 88+60 (SB I-57) TO STA. 1313+00 (SB RYAN)				
FED. ROAD DIST. NO. ILLINOIS FED. AID PROJECT				
• (1516.1, 1717, & 1818) R-5				
				62593

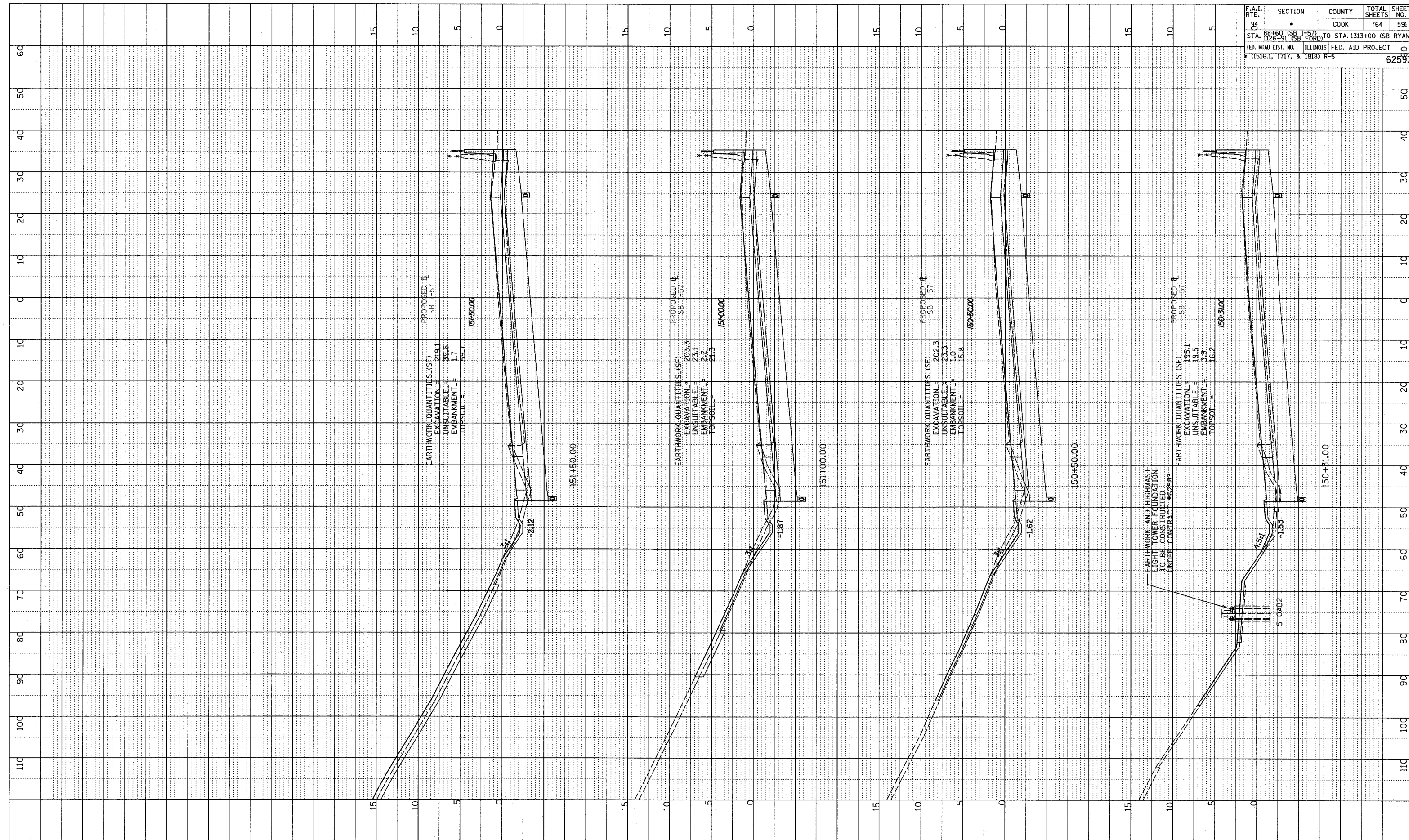

DATE: _____
 PROFILE SURVEYED _____
 PLOTTED/RECHECKED _____
 NOTE BOOK _____
 NO. _____
 STRUCTURE NOTATIONS CHFD _____

TYLIN INTERNATIONAL

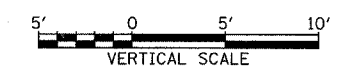
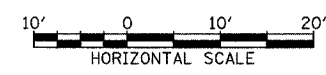

I-57 SOUTHBOUND
 STA. 150+31 TO STA. 151+50

02/27/2006 12:25:2 PM P:\0231\000\02\2\0231\000.dgn