

PROFILE
 DATE
 DRAWN BY
 CHECKED BY
 NO.

F.A.I. RTE.	SECTION	COUNTY	TOTAL SHEETS	SHEET NO.
94	88+00 (SB I-57) TO STA. 1313+00 (SB RYAN)	COOK	764	598
STA. 1210+00 (SB I-57) TO STA. 1313+00 (SB RYAN) FED. ROAD DIST. NO. ILLINOIS FED. AID PROJECT (1516.1, 1717, & 1818) R-5				
				62593

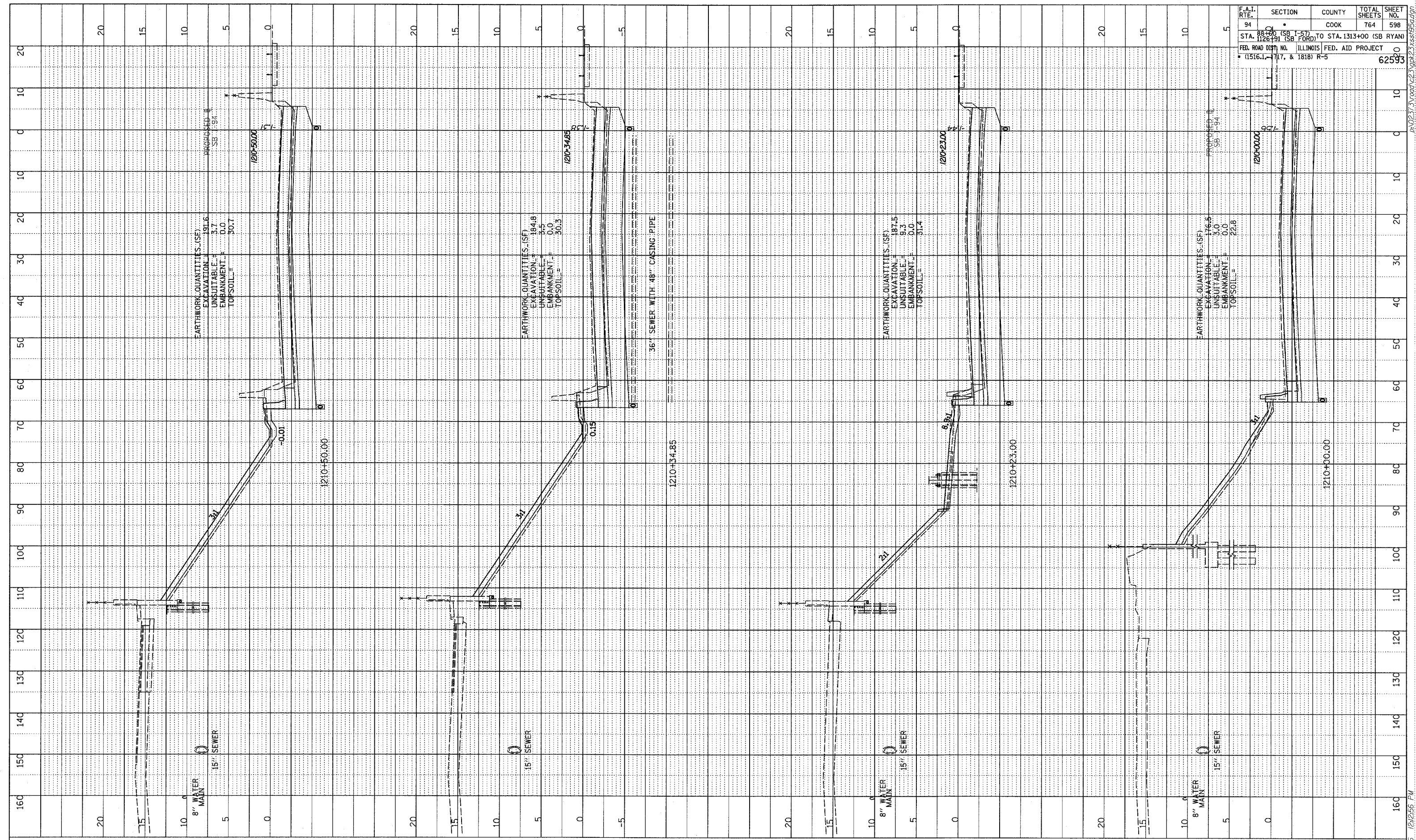

TYLIN INTERNATIONAL

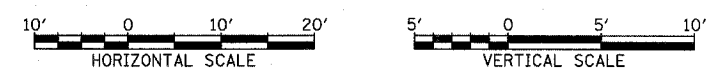

I-94 SOUTHBOUND (DAN RYAN EXPWY)
 STA. 1210+00 TO STA. 1210+50

02/27/2006 12:25:56 PM P:\02\3\road\c23\gk23\ss195a.dgn