

PROFILE SURVEYED
 PLOTTED
 CHECKED
 NOTE BOOK
 NO. _____
 STRUCTURE NOTATIONS OTHER

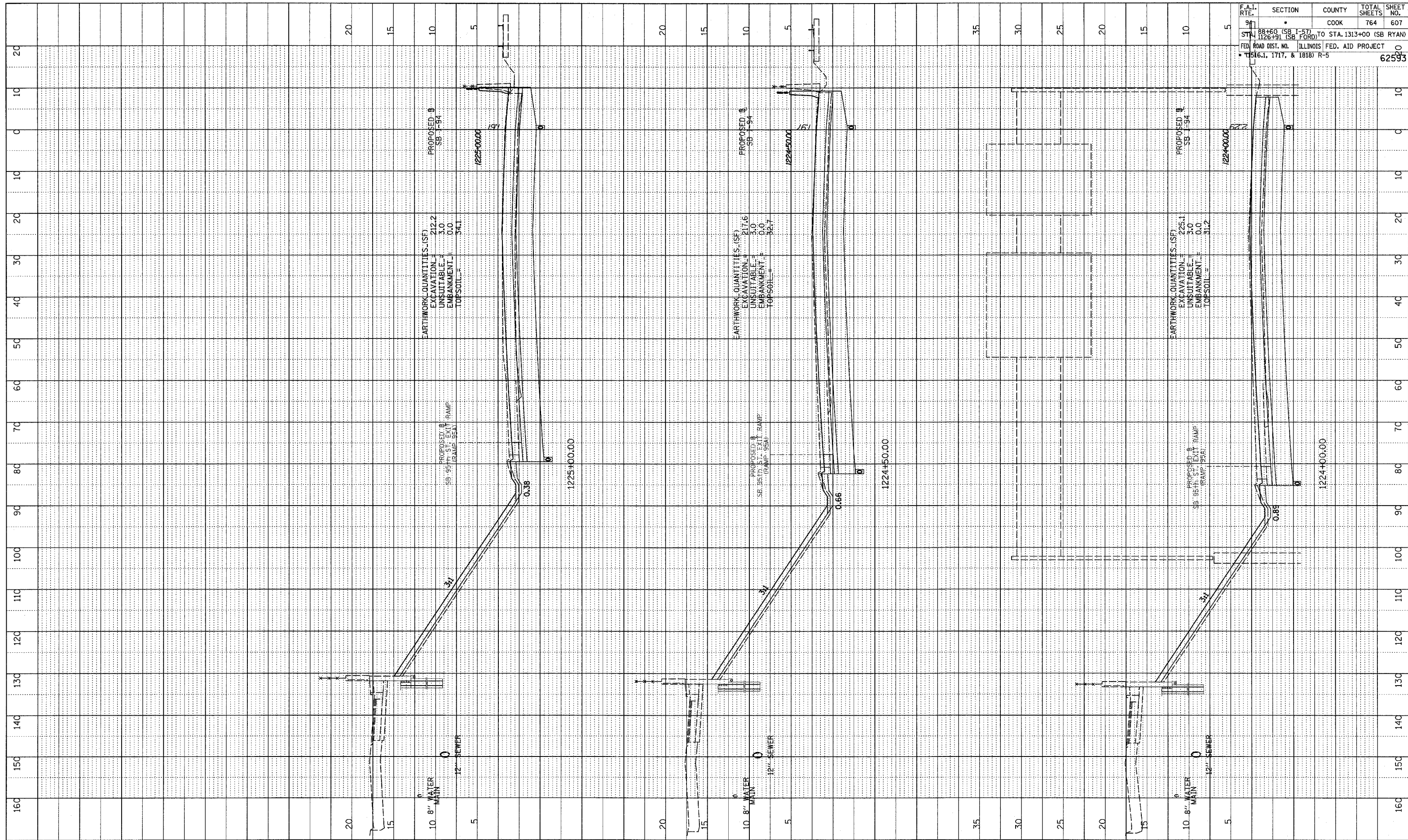

F.A.I. RTE.	SECTION	COUNTY	TOTAL SHEETS	SHEET NO.
94	SB 1-57 SB 1-51 SB FORD	COOK	764	607
STA. 1224+00 (SB FORD) TO STA. 1313+00 (SB RYAN)				
FED. ROAD DIST. NO. ILLINOIS FED. AID PROJECT				
1516.1, 1717, & 1818) R-5				
				62593

TYLIN INTERNATIONAL

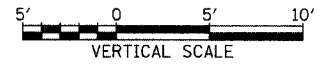
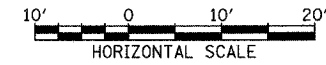

I-94 SOUTHBOUND (DAN RYAN EXPWY)
 STA. 1224+00 TO STA. 1225+00

P:\0231\3\road\c23\pk23\ss\95a.dgn 02/27/2006 12:35:05 PM