

PROFILE SURVEYED
 PLOTTED/CHECKED
 NOTE BOOK
 NO. _____
 STRUCTURE NOTATIONS CHECKED

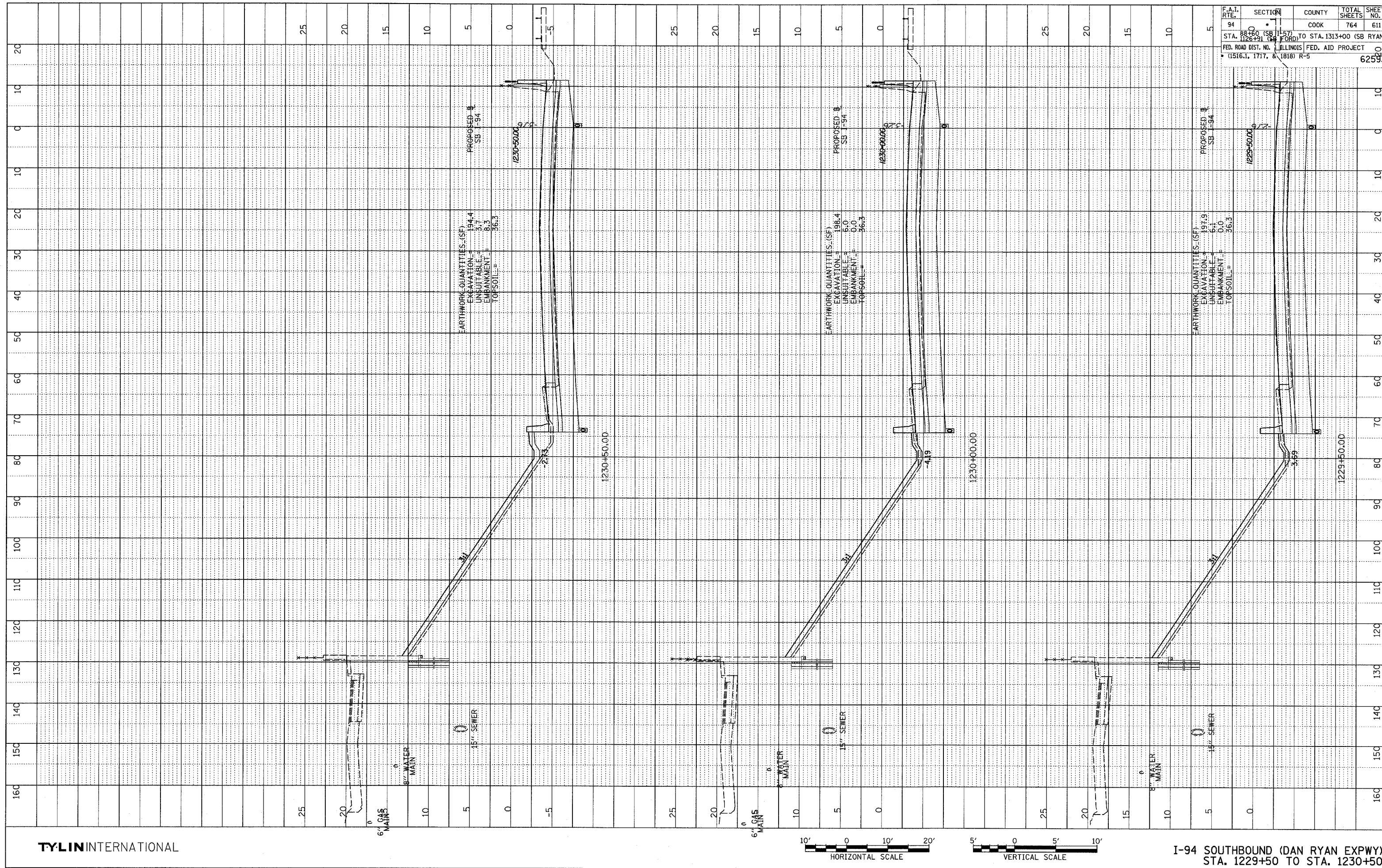

F.A.T. RTE. 94	SECTION 10	COUNTY COOK	TOTAL SHEETS 764	SHEET NO. 611
STA. 88+60 (SB I-57) TO STA. 1313+00 (SB RYAN)		ILLINOIS FED. AID PROJECT		
FED. ROAD DIST. NO. 1516.1, 1717, & 1818 R-5		62593		

TYLINTERNATIONAL

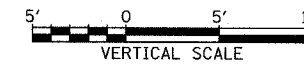
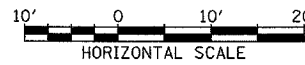

I-94 SOUTHBOUND (DAN RYAN EXPWY)
 STA. 1229+50 TO STA. 1230+50

02/27/2006 12:53:07 PM P:\02\31\5\road\c23\pk23\ss195a.dgn