

PROF FILE SURVEYED
 B.M. NOTED
 GRADES CHECKED
 STRUCTURE NOTATION C/P/R/D

F.A.I. RTE.	SECTION	COUNTY	TOTAL SHEETS	SHEET NO.
94	SB I-57 (SB I-94)	COOK	764	612
STA. 1126+91 (SB I-57) TO STA. 1313+00 (SB I-94)				
FED. ROAD DIST. NO. ILLINOIS FED. AID PROJECT				
• (1516.1, 1717, & 1818) R-5				
				62593

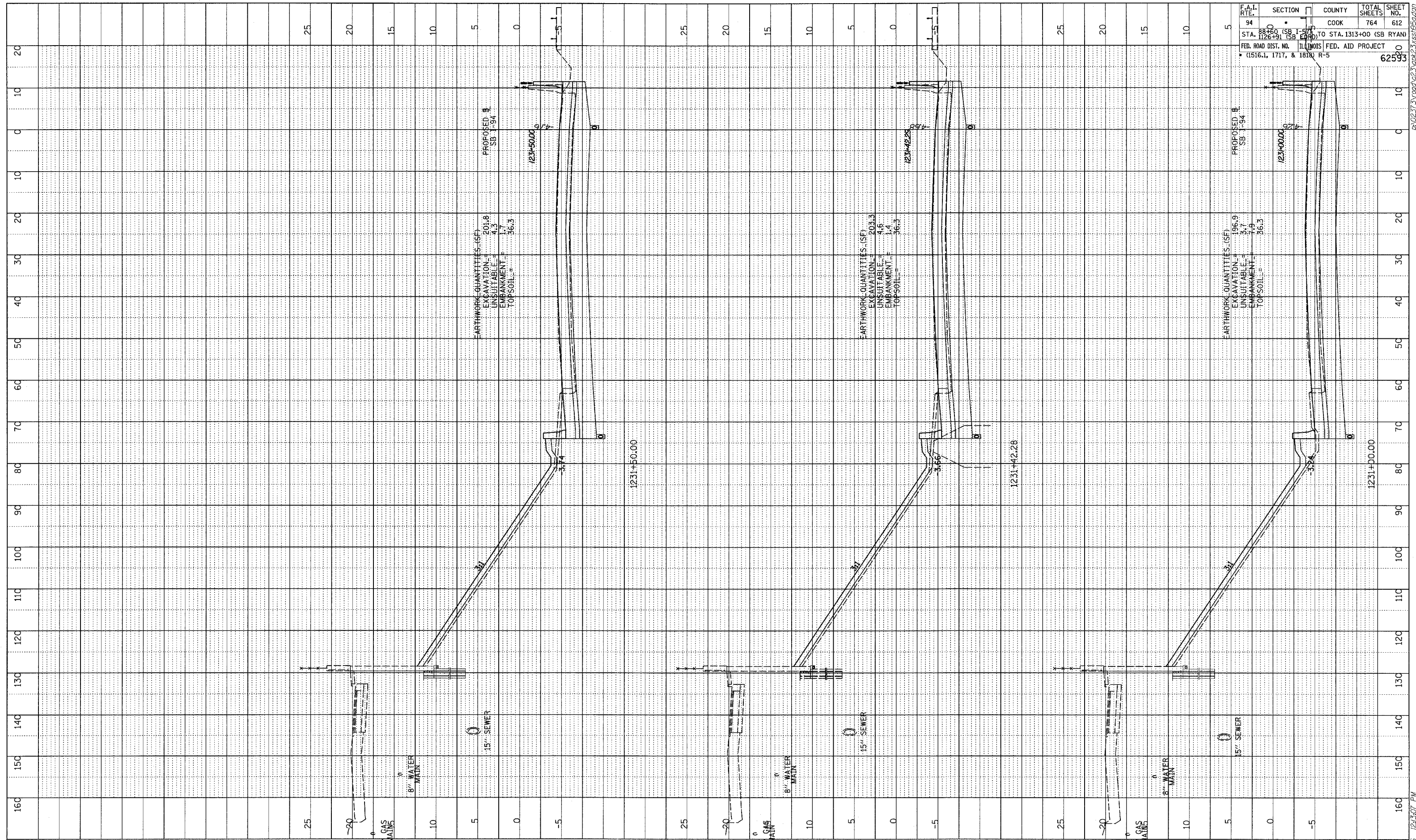

TYLIN INTERNATIONAL

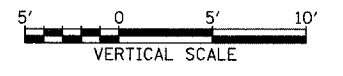
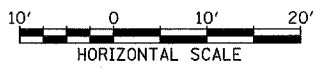

I-94 SOUTHBOUND (DAN RYAN EXPWY)
 STA. 1231+00 TO STA. 1231+50

02/27/2006 12:43:07 PM