

DATE: _____
 PROFILE SUBMITTED: _____
 PLOTTED: _____
 CHECKED: _____
 NO. _____
 STRUCTURE: 107ATMS 0140

F.A.I. RTE.	SECTION	COUNTY	TOTAL SHEETS	SHEET NO.
94	1243+50 (SB) TO STA. 1245+50 (SB)	COOK	764	621
	1244+50 (SB) TO STA. 1246+50 (SB)			
FED. ROAD DIST. NO. ILLINOIS FED. AID PROJECT				62593
* (1516.1, 1717, & 1816) R-5				

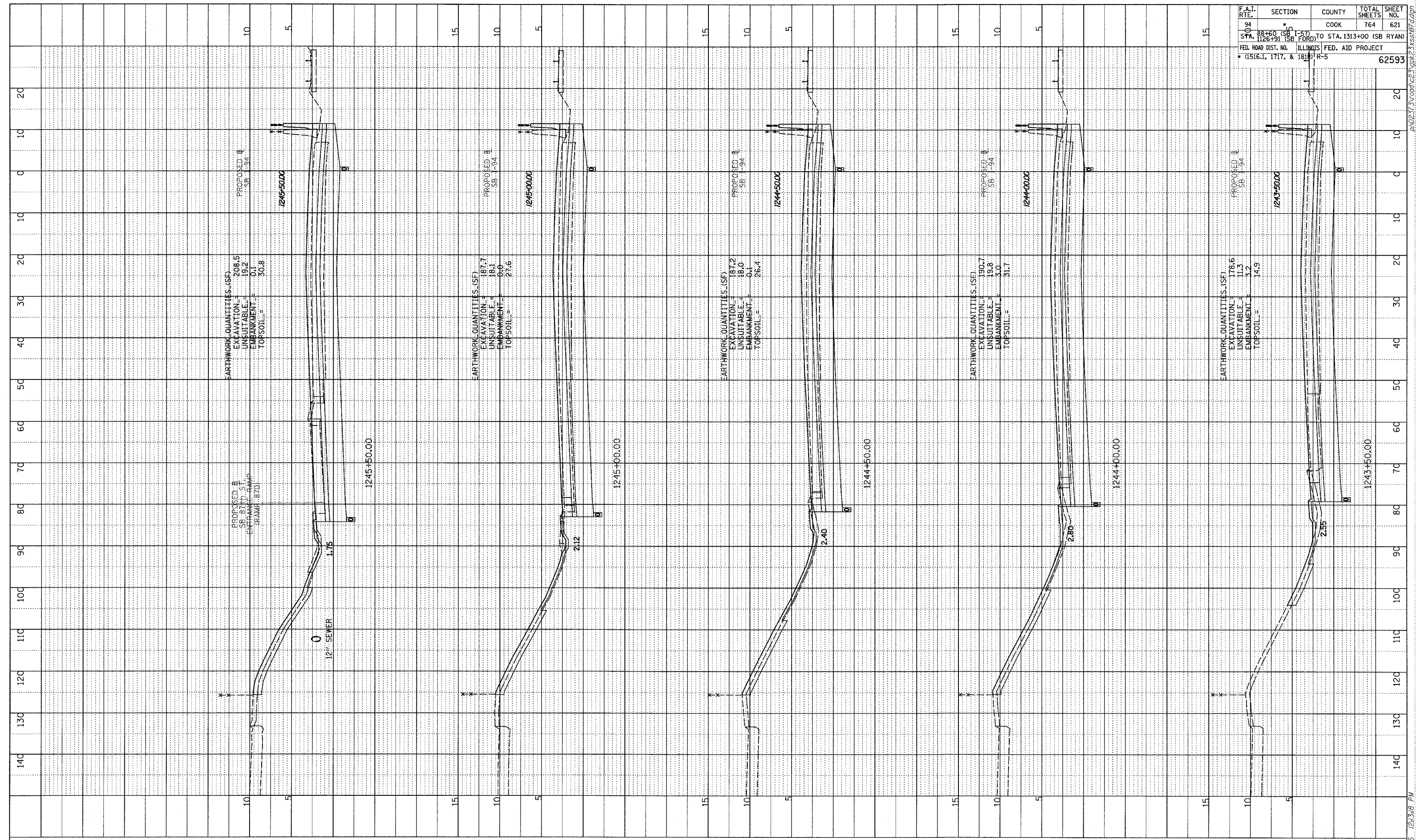

TYLIN INTERNATIONAL

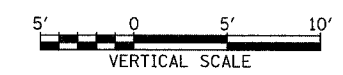
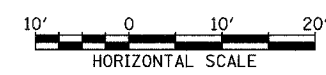

I-94 SOUTHBOUND (DAN RYAN EXPWY)
 STA. 1243+50 TO STA. 1245+50

02/27/2006 12:38 PM