

PROFILE SURVEYED
 PLOTTED
 NOTE BOOK
 NO. _____
 STRUCTURE NOTATIONS CHFD

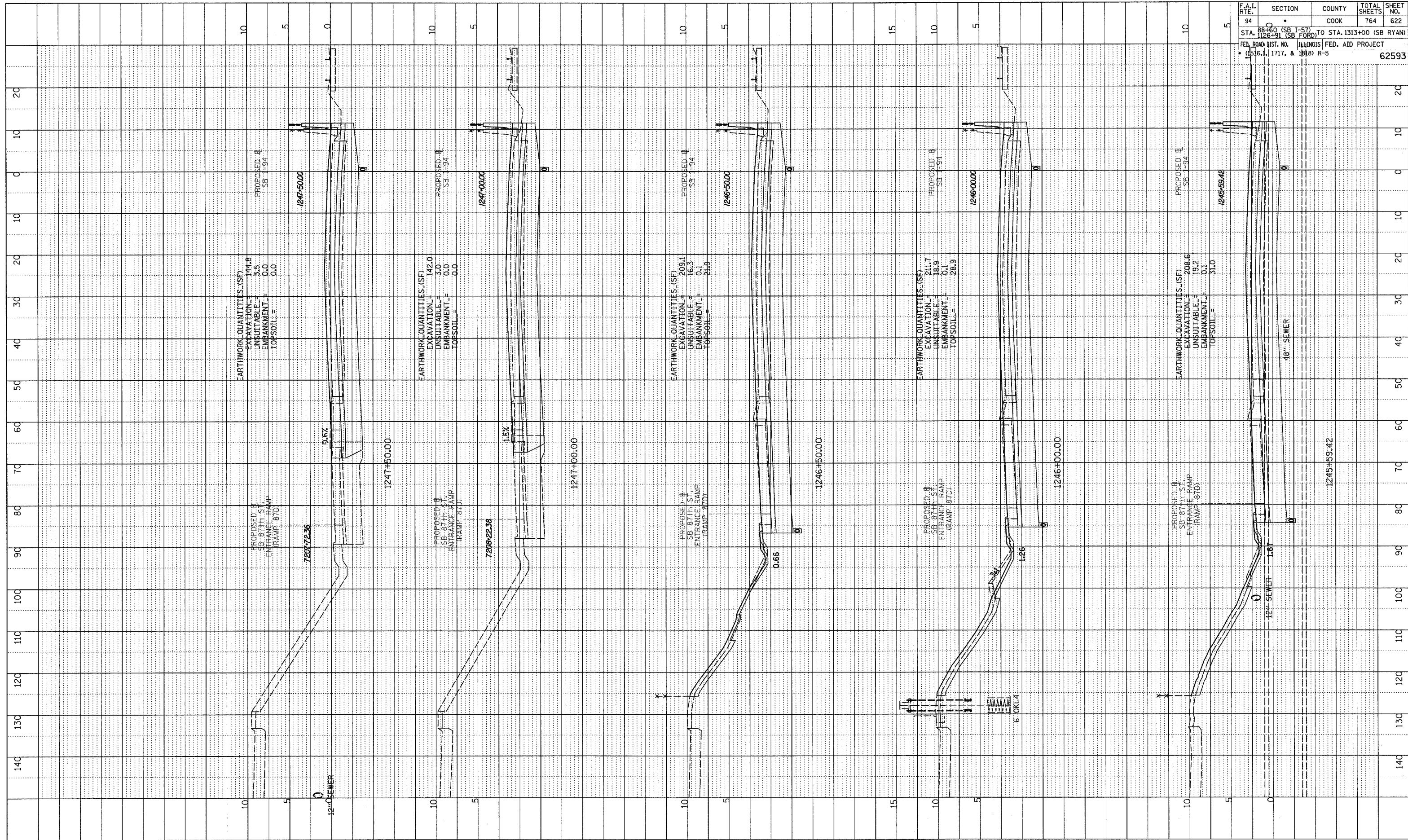

F.A.I. RTE.	SECTION	COUNTY	TOTAL SHEETS	SHEET NO.
94	SB 1-57 TO STA. 1313+00 (SB RYAN)	COOK	764	622
STA. 126+91 (SB FORD) TO STA. 1313+00 (SB RYAN)				
FED. ROAD DIST. NO. ILLINOIS FED. AID PROJECT				
0516.1, 1717, & 1818 R-5				
				62593

TYLIN INTERNATIONAL

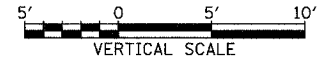

I-94 SOUTHBOUND (DAN RYAN EXPWY)
 STA. 1245+59.42 TO STA. 1247+50

02/27/2006 12:13:18 PM p:\02373\road\23\gpk23\sheet7.dwg