

PROFILE SURVEYED
 PLOTTED
 CHECKED
 NOTE BOOK
 NO. _____
 STRUCTURE NO. STATUS CHRD

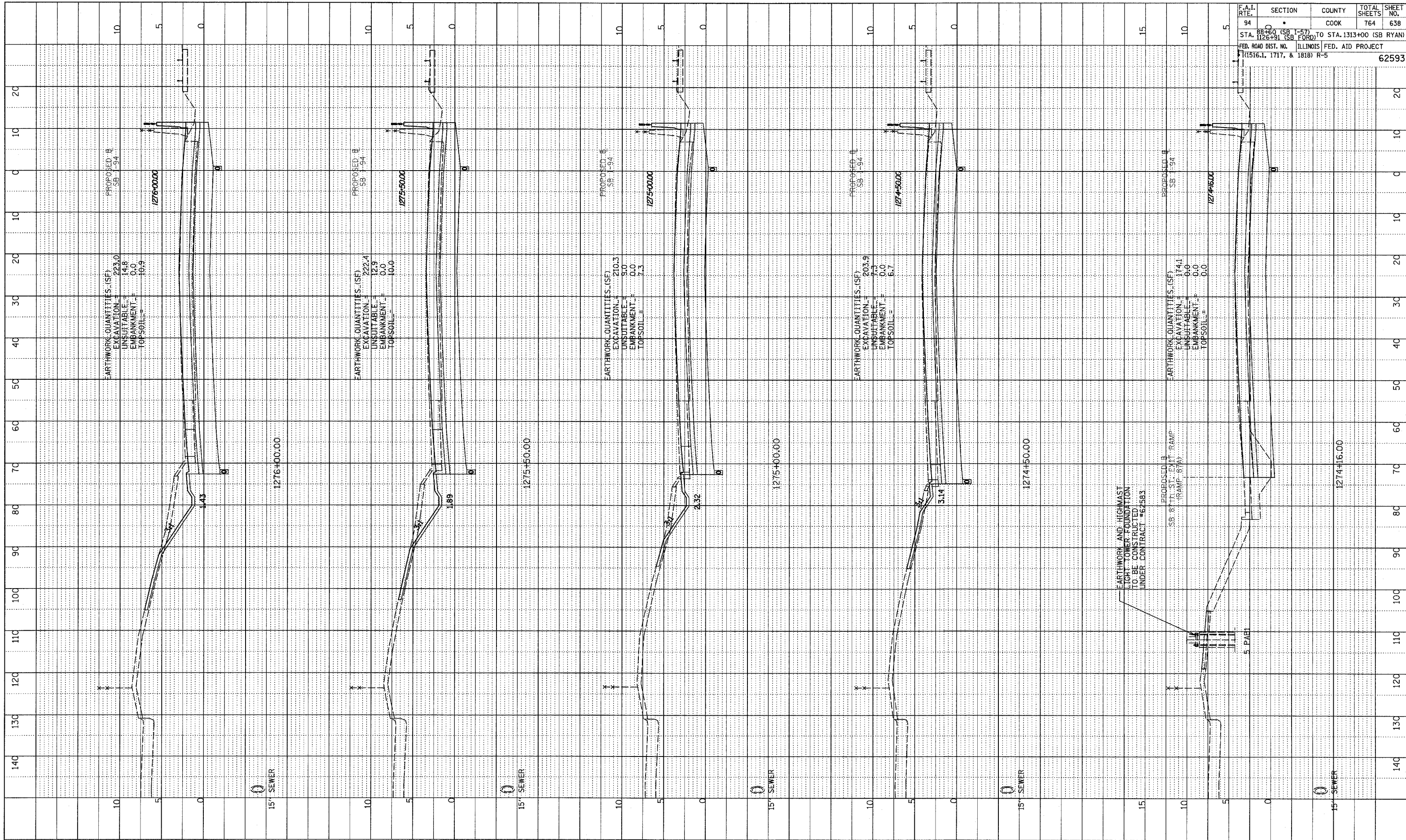

F.A.I. RTE.	SECTION	COUNTY	TOTAL SHEETS	SHEET NO.
94	100	COOK	764	638

STA. 1274+00 (SB 1-57) TO STA. 1313+00 (SB RYAN)
 STA. 1274+00 (SB 1-57) TO STA. 1274+16 (SB FORD)
 FED. ROAD DIST. NO. ILLINOIS FED. AID PROJECT
 (1516.1, 1717, & 1818) R-5

02/27/2006 12:52:26 PM
 P:\02\31\road\62583\pk2\ss1817.dgn

TYLIN INTERNATIONAL

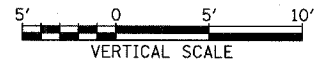

I-94 SOUTHBOUND (DAN RYAN EXPWY)
 STA. 1274+16 TO STA. 1276+00