

PROFILE SURVIVED
 PLOTTED / CHECKED
 NOTE BOOK / DRAWN
 NO. / DATE
 STRUCTURE NOTATIONS CHRD

F.A.I. RTE.:	SECTION	COUNTY	TOTAL SHEETS	SHEET NO.
54		COOK	764	644
STA. 88+60 (SB I-57)	TO STA. 1313+00 (SB RYAN)			
STA. 1126+91 (SB FORD)				
FED. ROAD DIST. NO. ILLINOIS			FED. AID PROJECT	
(1516.1, 1717 & 1818) R-5			62593	

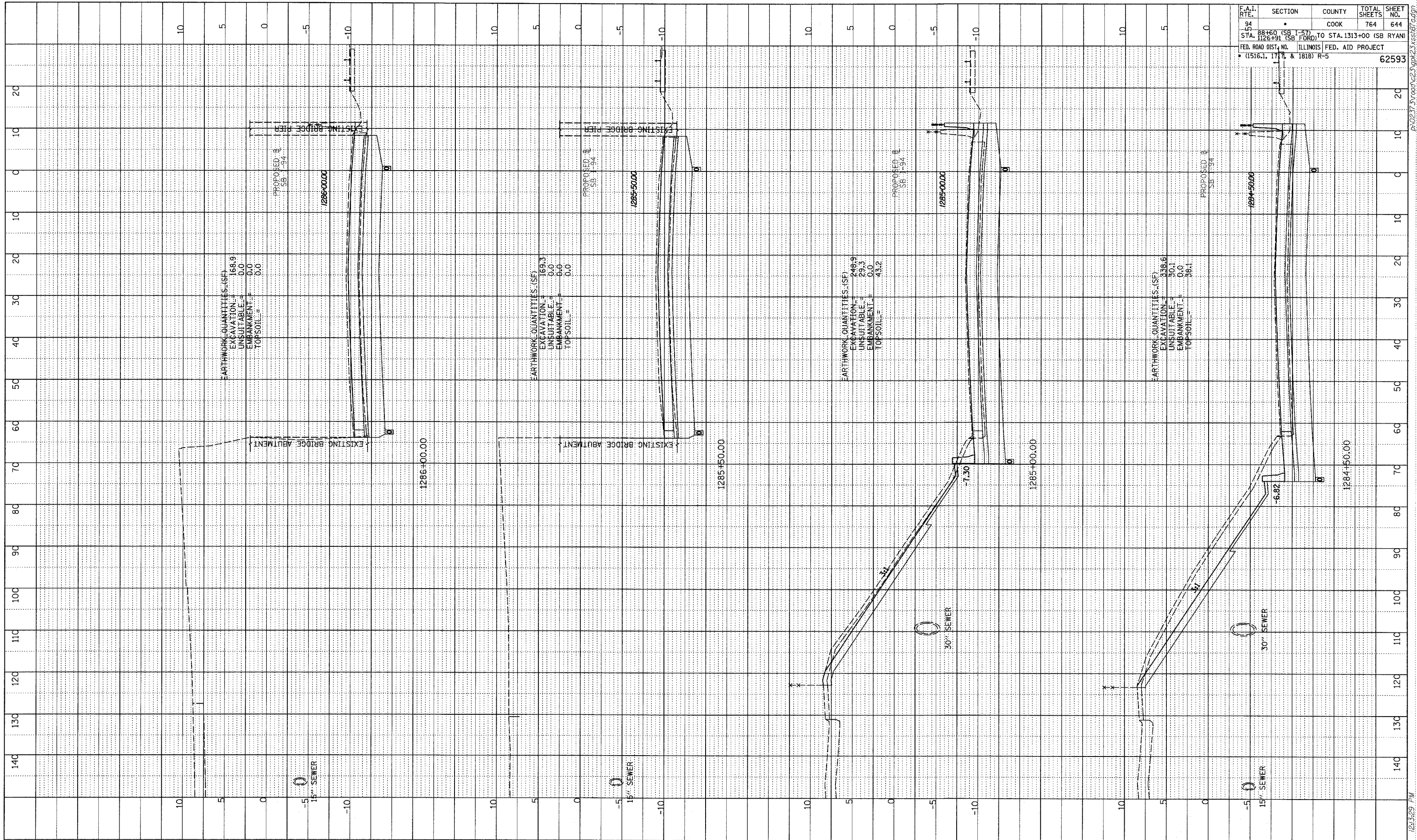

TYLIN INTERNATIONAL

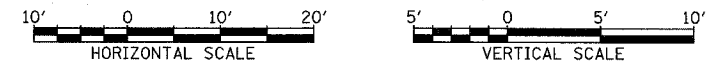

I-94 SOUTHBOUND (DAN RYAN EXPWY)
 STA. 1284+50 TO STA. 1286+00

02/27/2006 12:52:29 PM