

PROFILE SURVEYED  
 PLOTTED CHECKED  
 NOTE BOOK BAK NOTED  
 NO. \_\_\_\_\_ STRUCTURE NOTATION CHRD

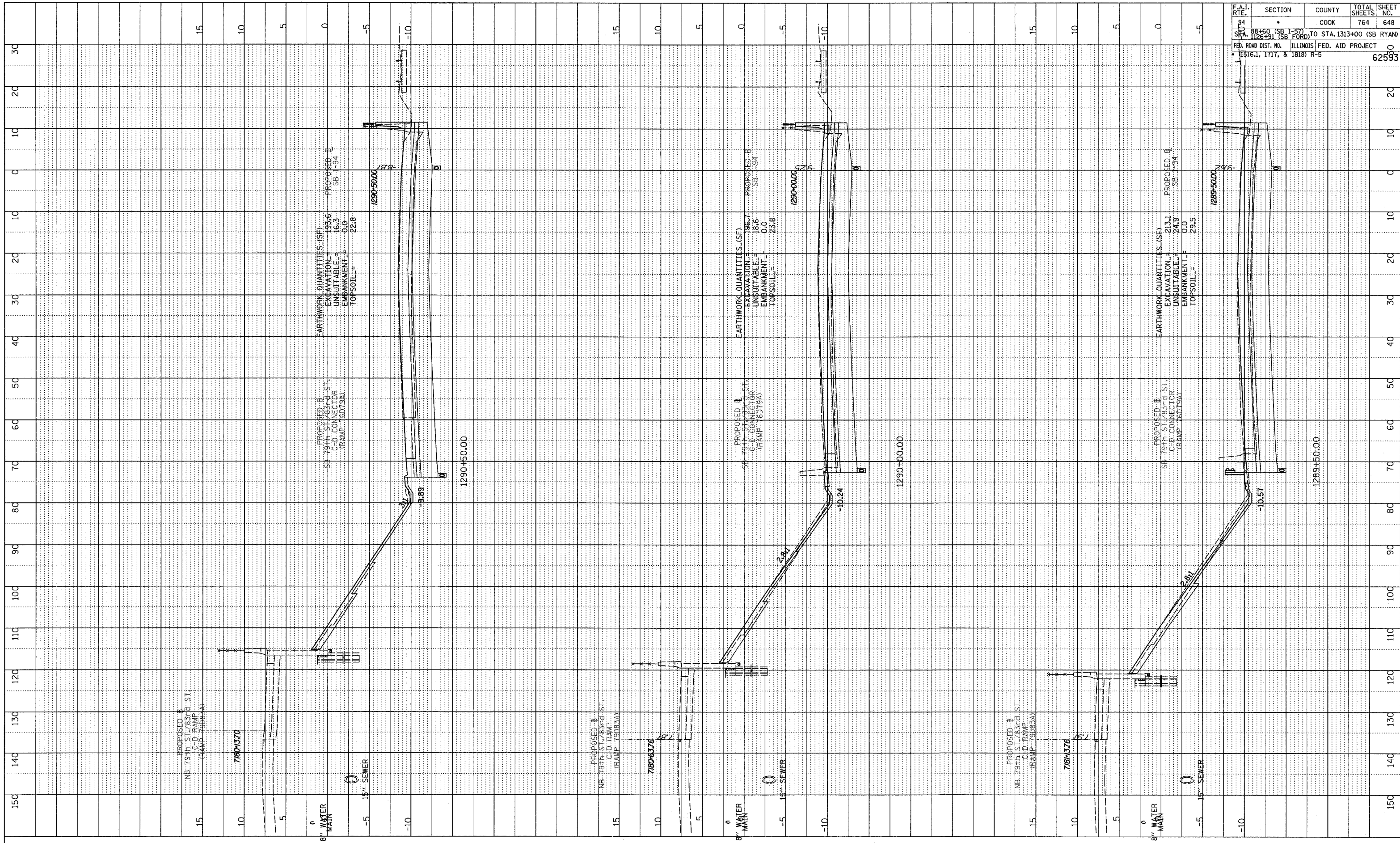

F.A.I. RTE.	SECTION	COUNTY	TOTAL SHEETS	SHEET NO.
94	88+60 (SB I-57) TO STA. 1313+00 (SB RYAN)	COOK	764	648
SFA 1126+91 (SB FORD) TO STA. 1313+00 (SB RYAN)				
FED. ROAD DIST. NO. ILLINOIS FED. AID PROJECT				
1316.1, 1717, & 1818) R-5				
				62593

TYLIN INTERNATIONAL

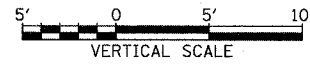
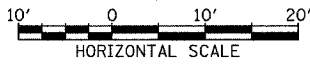

I-94 SOUTHBOUND (DAN RYAN EXPWY)  
 STA. 1289+50 TO STA. 1290+50

02/27/2006 12:13:31 PM P:\02375V\000\02375\02375.dgn