

DATE: \_\_\_\_\_  
 BT  
 SURVEYED \_\_\_\_\_  
 PLOTTED \_\_\_\_\_  
 CHECKED \_\_\_\_\_  
 NOTE BOOK \_\_\_\_\_  
 NO. \_\_\_\_\_  
 STRUCTURE NOTATION CHRD

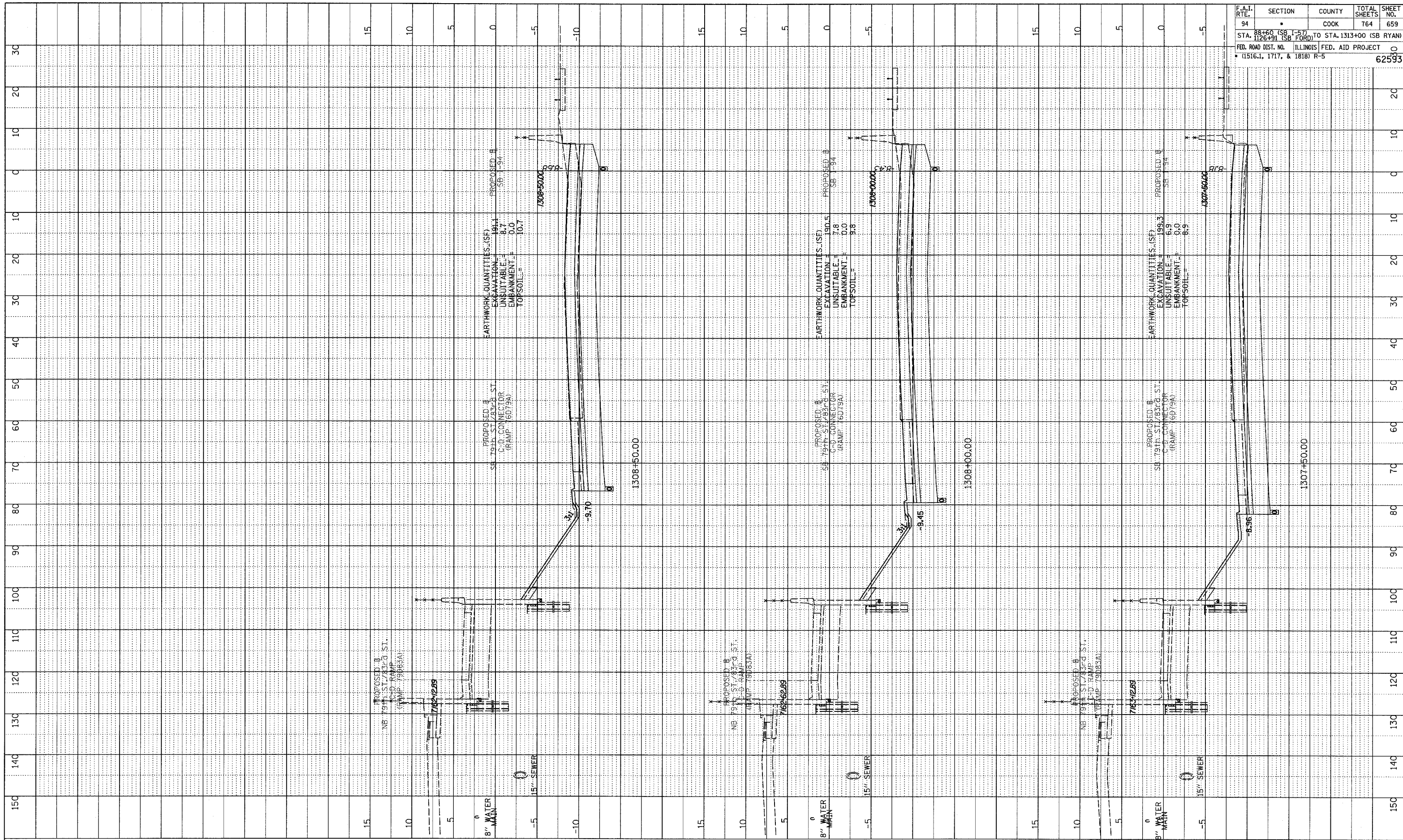

F.A.I. RTE.	SECTION	COUNTY	TOTAL SHEETS	SHEET NO.
94		COOK	764	659

STA. 88+60 (SB T-57) TO STA. 1313+00 (SB RYAN)  
 STA. 1126+91 (SB FORD) TO STA. 1313+00 (SB RYAN)  
 FED. ROAD DIST. NO. ILLINOIS FED. AID PROJECT  
 \* (1516.1, 1717, & 1818) R-5

62593

TYLIN INTERNATIONAL

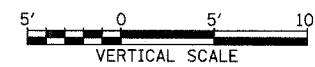
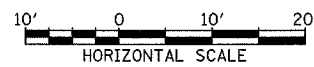

I-94 SOUTHBOUND (DAN RYAN EXPWY)  
 STA. 1307+50 TO STA. 1308+50

02/27/2006 12:34:42 PM P:\0227\3\road\023\gpk23\ssb7993.dgn