

DATE: \_\_\_\_\_  
 PROFILE SURVEYED \_\_\_\_\_  
 PLOTTED / RECORDED \_\_\_\_\_  
 NOTE BOOK \_\_\_\_\_  
 NO. \_\_\_\_\_  
 STRUCTURE NOTATIONS CRPD

F.A.I. RTE.	SECTION	COUNTY	TOTAL SHEETS	SHEET NO.
94	88+60 (SB) TO STA. 1313+00 (SB RYAN)	COOK	764	668
FED. ROAD DIST. NO. ILLINOIS FED. AID PROJECT				
* (1516.1, 1717, & 1818) R-5				

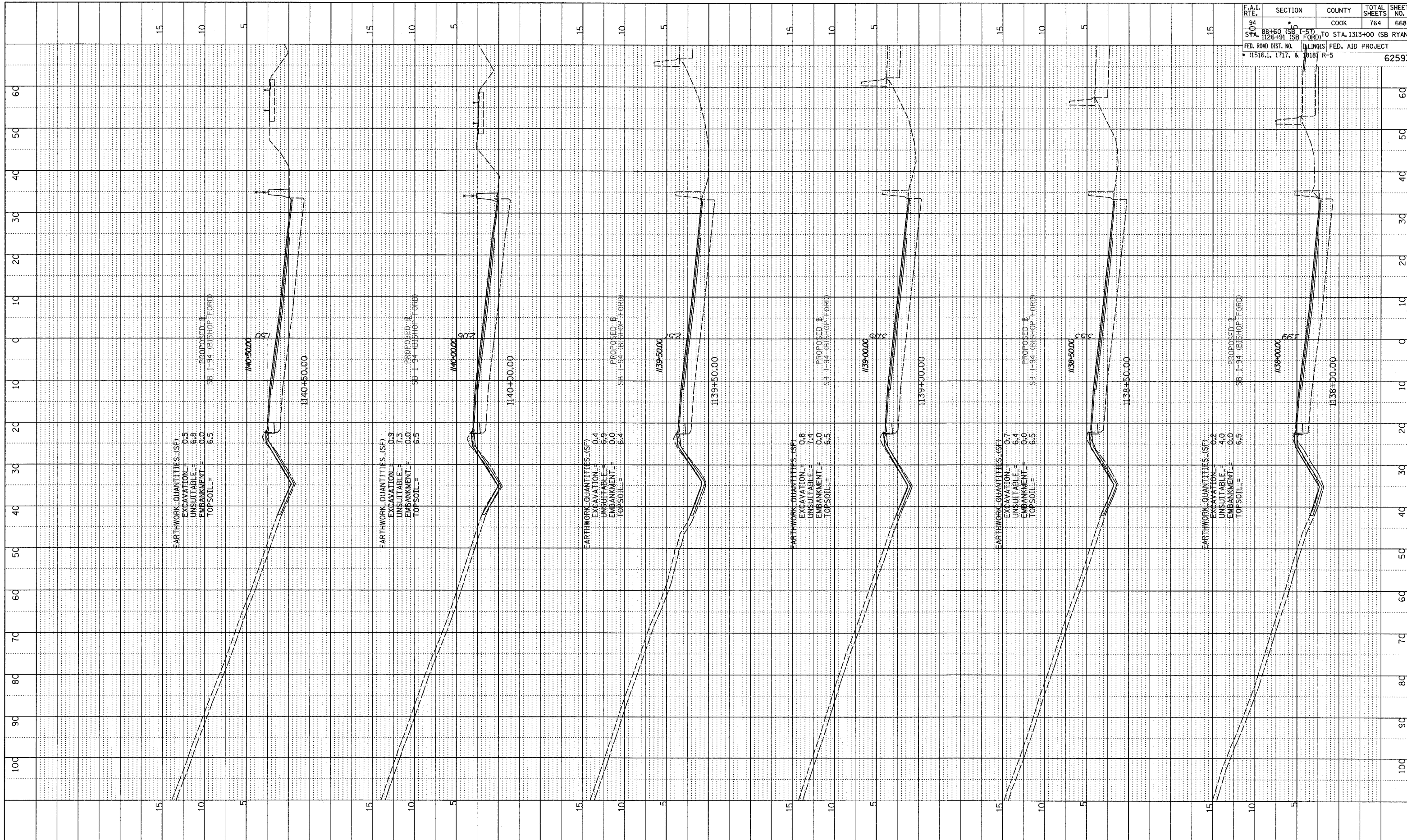

TYLIN INTERNATIONAL

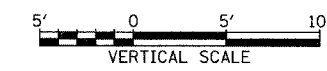
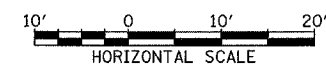

I-94 SOUTHBOUND (BISHOP FORD FWY)  
 STA. 1138+00 TO STA. 1140+50

02/27/2006 12:53:33 PM P:\0227\_3\road\23\pk23\ssb1140.dgn