

PROFILE SURVEYED _____
 PLOTTED _____
 NOTE BOOK _____
 NO. _____
 STRUCTURE NOTATION CHRD

F.A.I. RTE.	SECTION	COUNTY	TOTAL SHEETS	SHEET NO.
94	88+60 (SB I-57) TO STA. 132+91 (SB FORD)	COOK	764	670
STA. 1142+56 (SB FORD) TO STA. 1313+00 (SB RYAN) FED. ROAD DIST. NO. ILLINOIS FED. AID PROJECT * (1516.1, 1717, & 1818) R-5				
				62593

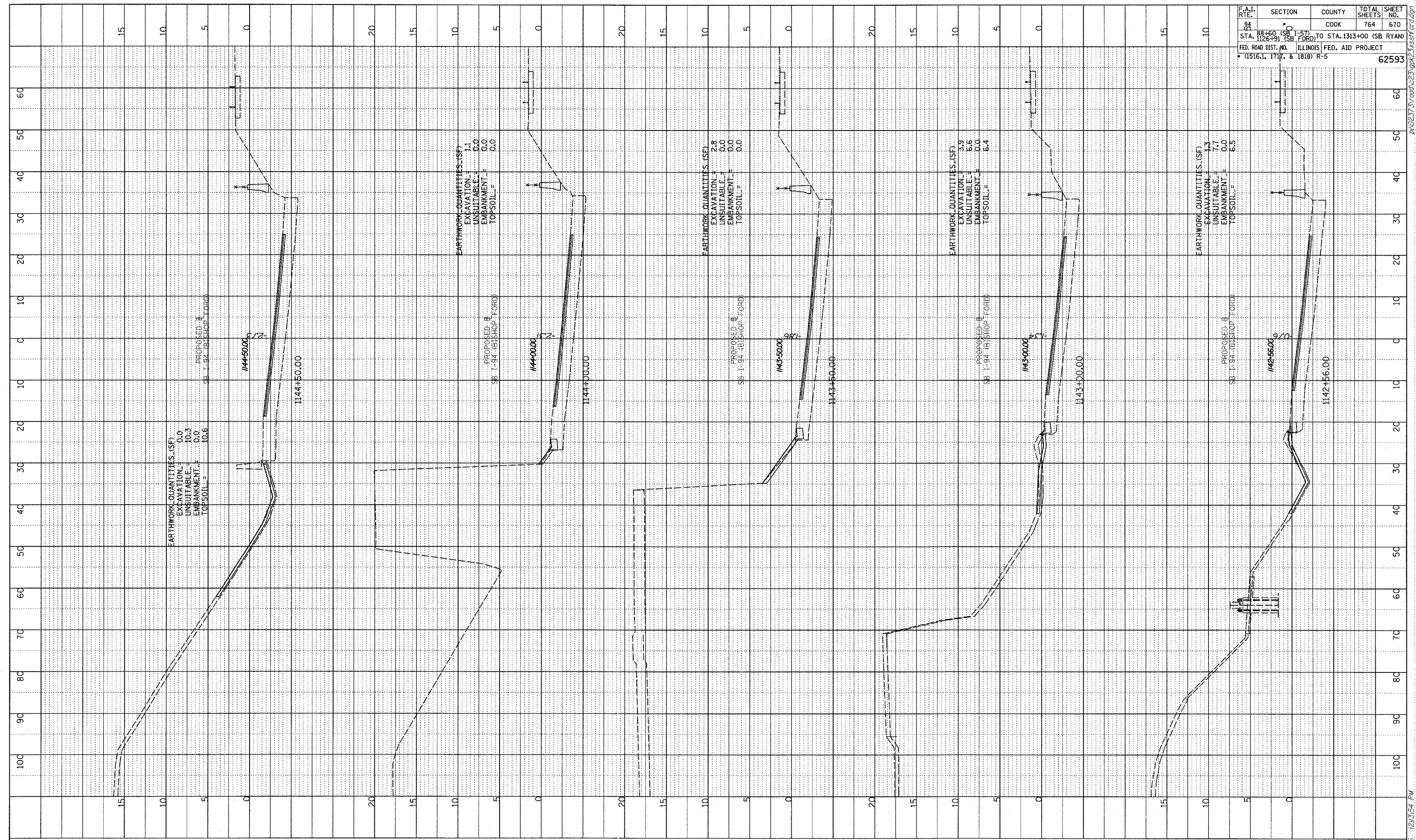

TYLIN INTERNATIONAL

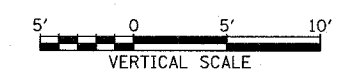
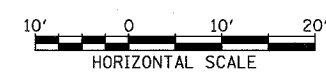

I-94 SOUTHBOUND (BISHOP FORD FWY)
 STA. 1142+56 TO STA. 1144+50

02/27/2006 12:35:54 PM P:\0227\3\road\025\gk\23\asht\ord.dgn