

PROFILE	DESIGNED	DATE
	PLOTTED	
	CHECKED	
	BY	
	NO.	
	STRUCTURE NOTATIONS	

F.A.I. RTE.	SECTION	COUNTY	TOTAL SHEETS	SHEET NO.
94	1147+00	COOK	764	672
STA. 1147+00 (SB FORD) TO STA. 1313+00 (SB RYAN)				
FED. ROAD DIST. NO. ILLINOIS FED. AID PROJECT				
• (1516, 1717, & 1818) R-5				
				62593

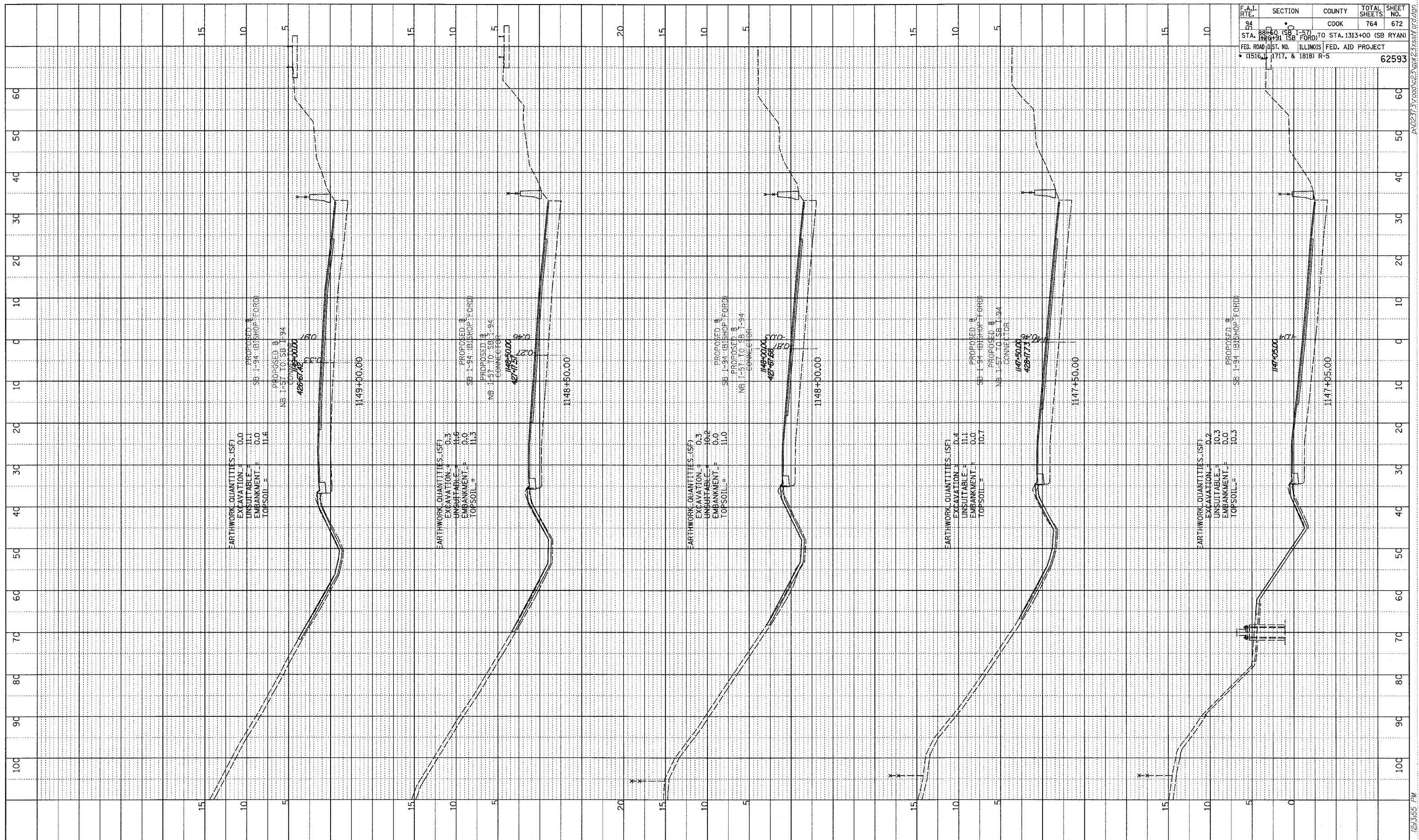

TYLIN INTERNATIONAL

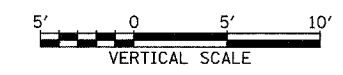
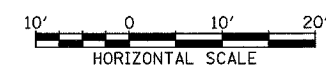

I-94 SOUTHBOUND (BISHOP FORD FWY)  
STA. 1147+05 TO STA. 1149+00

02/27/2006 12:55 PM PA02373.vwd\c23\proj23\sheet.dwg