

PROFILE SURVEYED _____
 PLOTTED _____
 CHECKED _____
 DATE _____
 NOTE BOOK _____
 NO. _____
 STRUCTURE NOTATIONS CRPD

F.A.I. RTE.	SECTION	COUNTY	TOTAL SHEETS	SHEET NO.
94	88+60 (SB) TO STA. 131+00 (SB RYAN)	COOK	764	675
FED. ROAD DIST. NO. ILLINOIS FED. AID PROJECT				
• (1516.1, 1717, & 1818) R-5				
				62593

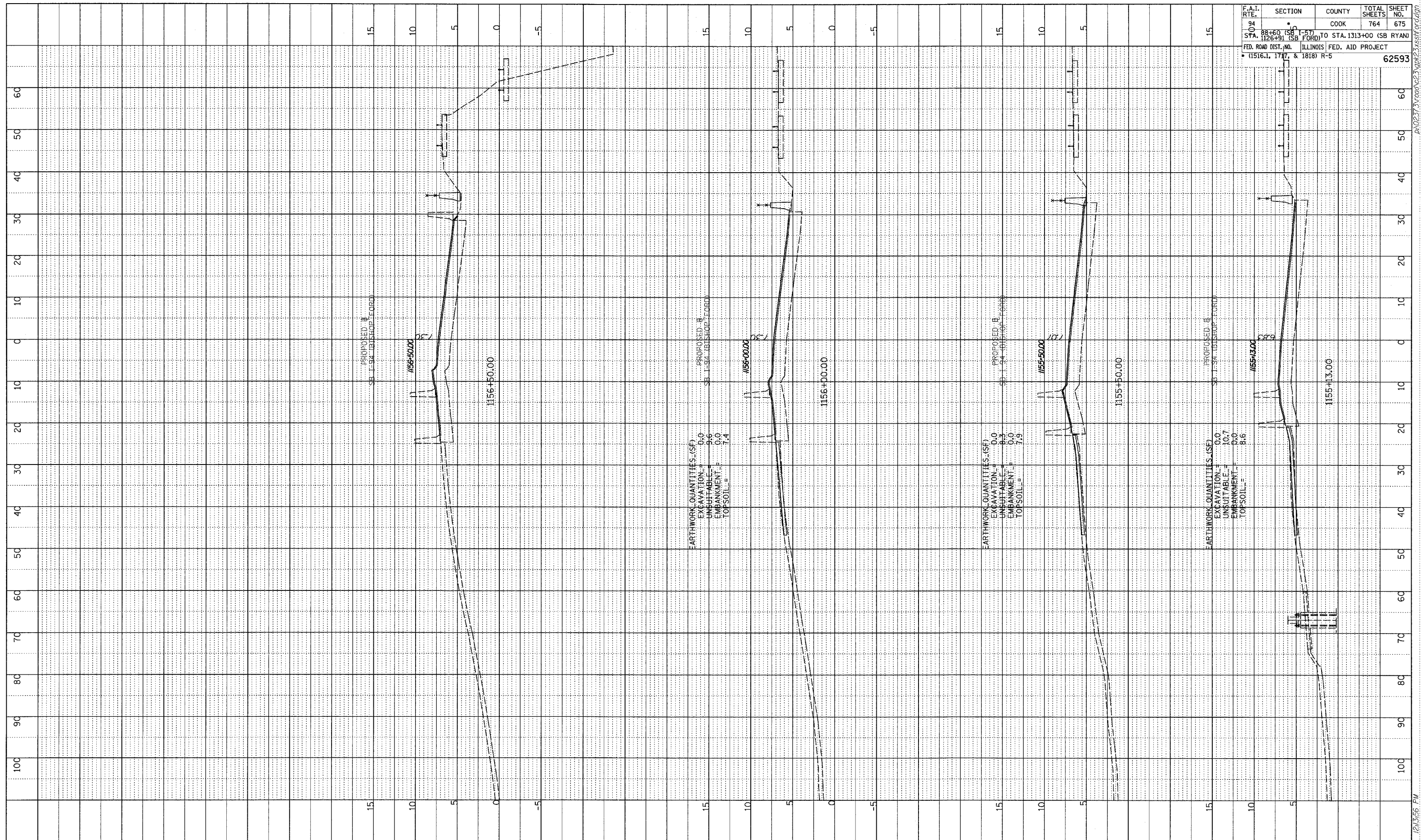

TYLIN INTERNATIONAL

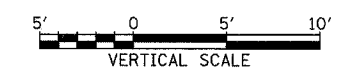
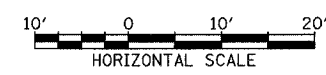

I-94 SOUTHBOUND (BISHOP FORD FWY)
 STA. 1155+13 TO STA. 1156+50

02/27/2006 12:13:56 PM
 P:\0227\3\road\023\gk\23\asst\rd.dgn