

PROFILE
 DRAWN BY: []
 CHECKED BY: []
 DATE: []

F.A.I. RTE.	SECTION	COUNTY	TOTAL SHEETS	SHEET NO.
94	SB 1-94 (BISHOP FORD)	COOK	764	682
STA. 1126+91 (SB FORD) TO STA. 1313+00 (SB RYAN)				
FED. ROAD DIST. NO. ILLINOIS FED. AID PROJECT				
* (1516.1, 1717, & 1818) R-5				
				62593

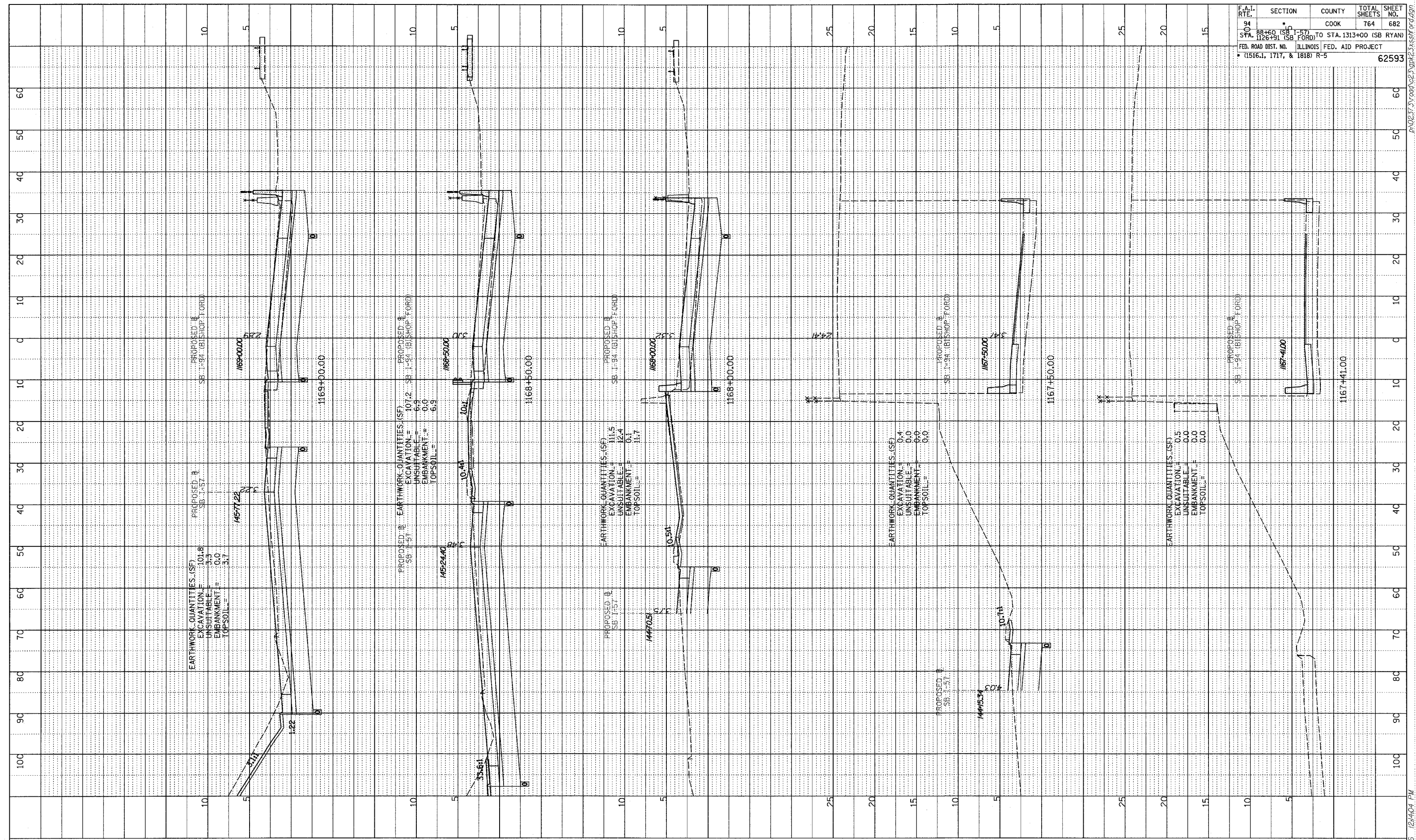

TYLIN INTERNATIONAL

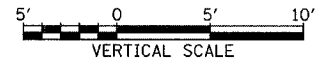
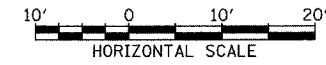

I-94 SOUTHBOUND (BISHOP FORD FWY)
 STA. 1167+41 TO STA. 1169+00

02/27/2006 12:40:04 PM