

PROPOSED HIGHWAY PLANS

FAP ROUTE 623 (US 6)

SECTION (31,34) RS

PROJECT: ACNHPP-0623 (035)

3P MILLING & RESURFACING
LASALLE COUNTY

C-93-057-14

F.A.P. RTE.	SECTION	COUNTY	TOTAL SHEETS	SHEET NO.
623	(31,34) RS	LASALLE	29	1
ILLINOIS			CONTRACT NO. 66D50	

- 1 COVER SHEET
- 2 GENERAL NOTES
- 3 - 7 SUMMARY OF QUANTITIES
- 8 - 10 TYPICAL SECTIONS
- 11 - 15 SCHEDULE OF QUANTITIES
- 16 - 25 PLAN VIEWS
- 26 - 29 DETAILS

LIST OF ILLINOIS DOT HIGHWAY STANDARDS

- 000001-06 STANDARD SYMBOLS, ABBREVIATIONS AND PATTERNS
- 001006 DECIMAL OF AN INCH AND OF A FOOT
- 406201-01 MAILBOX TURNOUT
- 442101-07 CLASS B PATCHES
- 642001-02 SHOULDER RUMBLE STRIPS, 16 IN
- 642006 SHOULDER RUMBLE STRIPS, 8 IN
- 667101-02 PERMANENT SURVEY MARKERS
- 701001-02 OFF-ROAD OPERATIONS 2L, 2W, MORE THAN 15' (4.5 m) AWAY
- 701006-05 OFF-ROAD OPERATIONS 2L, 2W, 15' (4.5 m) TO 24" (600 mm) FROM PAVEMENT EDGE
- 701011-04 OFF-ROAD MOVING OPERATIONS 2L, 2W, DAY ONLY
- 701301-04 LANE CLOSURE, 2L, 2W, SHORT TIME OPERATIONS
- 701306-03 LANE CLOSURE, 2L, 2W, SLOW MOVING OPERATIONS DAY ONLY, FOR SPEEDS ≥ 45 MPH
- 701311-03 LANE CLOSURE, 2L, 2W, MOVING OPERATIONS - DAY ONLY
- 701451-03 RAMP CLOSURE FREEWAY/EXPRESSWAY
- 701501-08 URBAN LANE CLOSURE, 2L, 2W, UNDIVIDED
- 701901-05 TRAFFIC CONTROL DEVICES
- 780001-05 TYPICAL PAVEMENT MARKINGS
- 781001-04 TYPICAL APPLICATIONS RAISED REFLECTIVE PAVEMENT MARKERS
- 782001-01 CURB REFLECTORS
- 782006 GUARDRAIL AND BARRIER WALL REFLECTOR MOUNTING DETAILS

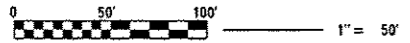
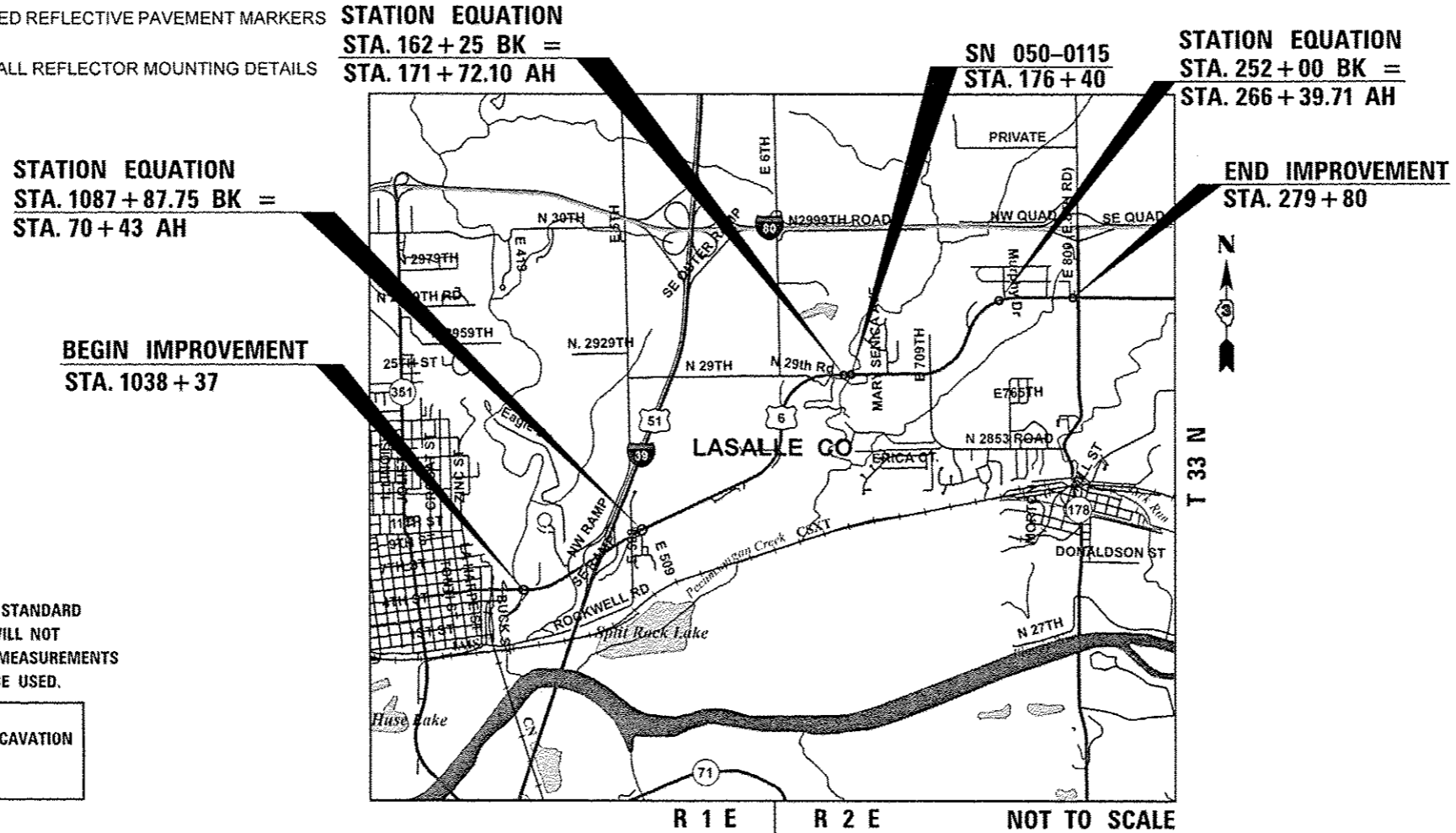
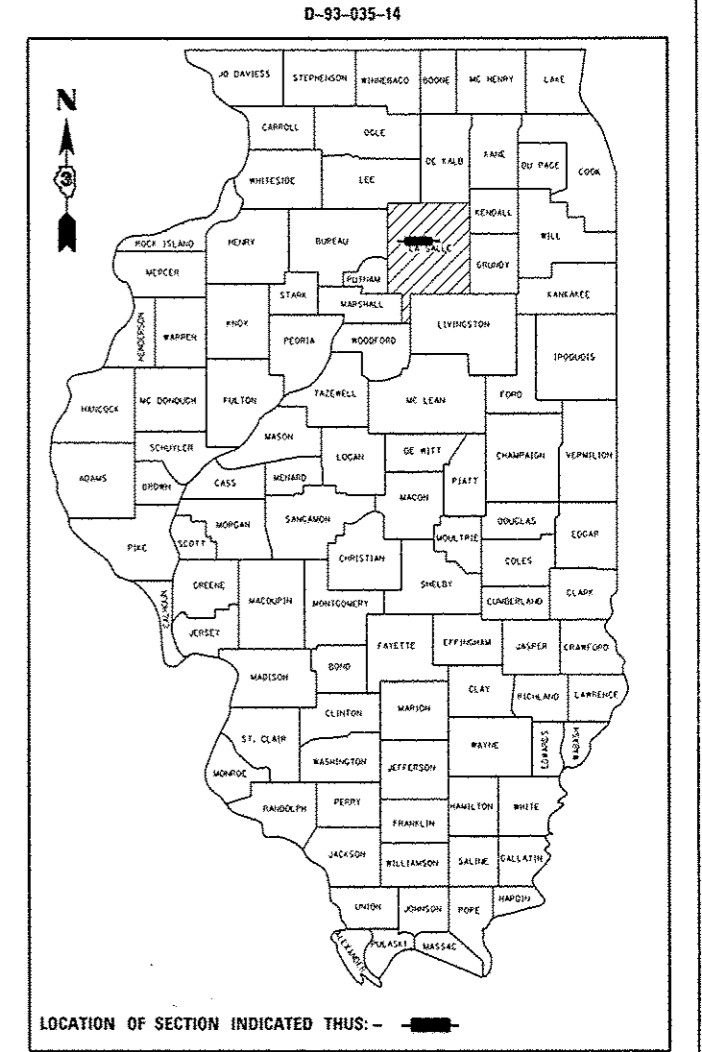

FULL SIZE PLANS HAVE BEEN PREPARED USING STANDARD ENGINEERING SCALES. REDUCED SIZED PLANS WILL NOT CONFORM TO STANDARD SCALES. IN MAKING MEASUREMENTS ON REDUCED PLANS, THE ABOVE SCALES MAY BE USED.

J.U.L.I.E.
JOINT UTILITY LOCATION INFORMATION FOR EXCAVATION
1-800-892-0123
OR 811

PROJECT ENGINEER: DAVE ALEXANDER, P.E.
UNIT CHIEF: BRAD DUNCAN, P.E.
DISTRICT 3 NO. (815) 434-6131
CONTRACT NO. 66D50

GROSS LENGTH = 23,760 FT. = 4.50 MILE
NET LENGTH = 23,760 FT. = 4.50 MILE

FUNCTIONAL CLASSIFICATION
OTHER ARTERIAL
2015 ADT = 6250 VPD
PV = 86.68 % SU = 6.52% MU = 6.8%

STATE OF ILLINOIS
DEPARTMENT OF TRANSPORTATION

SUBMITTED *March 16, 2016*
Paul Coetzee P.E.
REGIONAL ENGINEER

May 6, 2016
Maureen M. Addison, P.E.
ENGINEER OF DESIGN AND ENVIRONMENT

May 6, 2016
Anneke [Signature]
DIRECTOR OF PROGRAM DEVELOPMENT

PRINTED BY THE AUTHORITY
OF THE STATE OF ILLINOIS

GENERAL NOTES

THE THICKNESS OF HMA SHOWN ON THE PLANS IS THE NOMINAL THICKNESS. DEVIATIONS FROM THE NOMINAL THICKNESS WILL BE PERMITTED WHEN SUCH DEVIATIONS OCCUR DUE TO IRREGULARITIES IN THE EXISTING SURFACE OR BASE ON WHICH THE HMA IS PLACED.

THE HMA SURFACE OF ALL MAILBOX TURNOUTS, PRIVATE ENTRANCES, COMMERCIAL ENTRANCES, AND SIDE ROADS SHALL BE MADE NEATLY, IN A WORKMANLIKE MANNER, AND SHALL ACCURATELY CONFORM TO THE SHAPES AND DIMENSIONS SHOWN ON THE PLAN DETAILS. IF REQUIRED BY THE ENGINEER, THE CONTRACTOR SHALL SAW CUT THE HMA SURFACE TO CONFORM TO THE SHAPES AND DIMENSIONS SHOWN ON THE PLAN DETAILS. THIS WORK WILL BE INCLUDED IN THE COST OF THE HMA SURFACE.

EXCEPT AS NOTED ON THE PLANS, PAVEMENT GRADES SHOWN ARE AT THE TOP OF PAVEMENT SURFACES.

THE ENGINEER WILL BE THE SOLE JUDGE CONCERNING CURING TIME FOR THE VARIOUS HMA LIFTS.

FOR STABILIZATION, ALL TYPE III BARRICADES WILL REQUIRE A MINIMUM OF FOUR SAND BAGS PER BARRICADE.

SEEDING WILL NOT BE PERMITTED AT ANY TIME WHEN THE GROUND IS FROZEN, WET, OR IN AN UNTILLABLE CONDITION. LOCATIONS TO BE SEEDED WILL BE DETERMINED BY THE ENGINEER.

THE FINISHED EARTHWORK SHALL HAVE A VEGETATION SUSTAINING SOIL COVERING THE TOP FOUR INCHES (100 MILLIMETERS) IN AREAS TO BE SEEDED OR SODDED. THE VEGETATION SUSTAINING SOIL REQUIRED WILL NOT BE PAID FOR SEPARATELY BUT WILL BE INCLUDED IN THE COST OF FURNISHED EXCAVATION.

ON EXISTING PAVEMENT WHICH MAY BE SUPERELEVATED, THE NEW HMA PAVEMENT SHALL BE BUILT WITH THE SAME SUPERELEVATION UNLESS NEW SUPERELEVATION RATES ARE GIVEN ON THE PLANS.

ALL ELEVATIONS REFERRING TO U.S.G.S. MEAN SEA LEVEL DATUM.

ANY REFERENCE TO A STANDARD IN THESE PLANS SHALL BE INTERPRETED TO MEAN THE EDITION AS INDICATED BY THE SUBNUMBER SHOWN IN THE LIST OF STANDARDS OR THE COPY INCLUDED IN THESE PLANS.

THE FOLLOWING RATES OF APPLICATION HAVE BEEN USED IN CALCULATING PLAN QUANTITIES:

GRANULAR MATERIALS	2.05	TONS / CU YD
HMA RESURFACING	112	LBS / SQ YD / IN
SHORT TERM PAVEMENT MARKING	10	FT /100 FT OF APPLICATION
MIX FOR CRACKS, JTS & FLGWYS	0.0003	TONS / SQ YD
LEVEL BINDER (HAND METHOD)	0.0005	TONS / SQ YD

THE CONTRACTOR SHALL CONTACT JULIE AT LEAST 48 HOURS PRIOR TO EXCAVATION TO DETERMINE WHICH UTILITIES ARE IN THE AREA.

QUANTITY FOR PAVEMENT MARKING REMOVAL IS INCLUDED IN THE PLANS ASSUMING THE EXISTING MARKINGS NEED TO BE REMOVED IN THE CONCRETE SECTION AT THE BEGINNING OF THE PROJECT TO ALLOW FOR RESTRIPIPING.

QUANTITY IS INCLUDED IN THE PLANS TO REPLACE MISSING/BROKEN PRISMATIC CURB REFLECTORS & GUARDRAIL REFLECTORS AT LOCATIONS DETERMINED BY THE ENGINEER.

ADDITIONAL FLAGGERS WILL BE NEEDED AT THE RAMPS AT THE I-39 INTERCHANGE DURING THE CLASS B PATCHING OPERATION. SEE HIGHWAY STANDARD 701501.

STATE OF ILLINOIS
DEPARTMENT OF TRANSPORTATION
DISTRICT THREE
AS BUILT INFORMATION

SUPERVISING CONSTRUCTION FIELD ENGINEER

RESIDENT ENGINEER / TECHNICIAN

START & END DATES
OF CONSTRUCTION:

INSPECTORS:

STATE OF ILLINOIS
DEPARTMENT OF TRANSPORTATION
DISTRICT THREE

PREPARED BY: Don Beaulieu
DISTRICT STUDIES & PLANS ENGINEER

DATE: March 16, 2016

EXAMINED BY: Wayne L. Phillips
DISTRICT CONSTRUCTION ENGINEER

Wayne L. Phillips
DISTRICT MATERIALS ENGINEER

Samuel A. Kueber
DISTRICT OPERATIONS ENGINEER

**STATE OF ILLINOIS
DEPARTMENT OF TRANSPORTATION**

GENERAL NOTES

F.A.P. RTE.	SECTION	COUNTY	TOTAL SHEETS	SHEET NO.
623	(31.34)RS	LASALLE	29	2
CONTRACT NO. 66D50			ILLINOIS FED. AID PROJECT	

SCALE: SHEET OF SHEETS STA. TO STA.

FILE NAME :	USER NAME :	DESIGNED :	REVISED :
c:\pwork\work\dot\duncanb\0375657\0375657-0375657-0375657.dgn	duncanb	DRAWN :	REVISED :
		CHECKED :	REVISED :
		DATE :	REVISED :

CONSTR. CODE

FEDERAL=80%

STATE=20%

ROADWAY

.0005

URBAN

CODE NO.	ITEM	UNIT	TOTAL QUANTITY	
20400800	FURNISHED EXCAVATION	CU YD	10	10
25000200	SEEDING, CLASS 2	ACRE	0.1	0.1
25000400	NITROGEN FERTILIZER NUTRIENT	POUND	7	7
25000500	PHOSPHORUS FERTILIZER NUTRIENT	POUND	7	7
25000600	POTASSIUM FERTILIZER NUTRIENT	POUND	7	7
25100630	EROSION CONTROL BLANKET	50 YD	218	218
40200800	AGGREGATE SURFACE COURSE, TYPE B	TON	50	50
40600290	BITUMINOUS MATERIALS (TACK COAT)	POUND	50737	50737
40600400	MIXTURE FOR CRACKS, JOINTS, AND FLANGEWAYS	TON	20	20
40600537	LEVELING BINDER (HAND METHOD), IL-9.5FG, N70	TON	33	33
40600637	LEVELING BINDER (MACHINE METHOD), IL-9.5FG, N70	TON	2755	2755
40600982	HOT-MIX ASPHALT SURFACE REMOVAL - BUTT JOINT	50 YD	480	480
40600985	PORTLAND CEMENT CONCRETE SURFACE REMOVAL - BUTT JOINT	50 YD	450	450
40600990	TEMPORARY RAMP	50 YD	223	223

14

△ SPECIALTY ITEMS

FILE NAME :	USER NAME : dunoanbd	DESIGNED -	REVISED -	STATE OF ILLINOIS DEPARTMENT OF TRANSPORTATION	SUMMARY OF QUANTITIES				F.A.P. RTE.	SECTION	COUNTY	TOTAL SHEETS	SHEET NO.
p:\11084EBI\INTEG.illinois.gov\PI001\Documents\DOT Offices\District 3\Projects\03603\0360301\0366050\ht-500.dgn		REVISOR -	REVISIONS -		SCALE:	SHEET NO. 1 OF 5 SHEETS	STA.	TO STA.	623	(3),34RS	LASALLE	29	3
		CHECKED -	REVISIONS -		CONTRACT NO. 66D50								
		DATE -	REVISIONS -		ILLINOIS FED. AID PROJECT								

CODE NO.	ITEM	UNIT	TOTAL QUANTITY	CONSTR. CODE	
				ROADWAY	
				FEDERAL = 80%	STATE = 20%
				0005	URBAN
40603340	HOT-MIX ASPHALT SURFACE COURSE, MIX "D", N70	TON	5510		5510
40800050	INCIDENTAL HOT-MIX ASPHALT SURFACING	TON	474		474
44000152	HOT-MIX ASPHALT SURFACE REMOVAL, 3/4"	SO YD	9581		9581
44000155	HOT-MIX ASPHALT SURFACE REMOVAL, 1 1/2"	SO YD	65426		65426
44000158	HOT-MIX ASPHALT SURFACE REMOVAL, 2 1/4"	SO YD	2475		2475
44200966	CLASS B PATCHES, TYPE I, 10 INCH	SO YD	6		6
44200970	CLASS B PATCHES, TYPE II, 10 INCH	SO YD	1338		1338
44200974	CLASS B PATCHES, TYPE III, 10 INCH	SO YD	89		89
44200976	CLASS B PATCHES, TYPE IV, 10 INCH	SO YD	204		204
44201299	DOWEL BARS 1 1/2"	EACH	3654		3654
44213200	SAW CUTS	FOOT	9687		9687
44213204	TIE BARS 3/4"	EACH	24		24
48102100	AGGREGATE WEDGE SHOULDER, TYPE B	TON	887		887
48203100	HOT-MIX ASPHALT SHOULDERS	TON	805		805

14

△ SPECIALTY ITEMS

FILE NAME :	USER NAME : duncanbd	DESIGNED -	REVISED -	STATE OF ILLINOIS DEPARTMENT OF TRANSPORTATION	SUMMARY OF QUANTITIES			F.A.P. RTE.	SECTION	COUNTY	TOTAL SHEETS	SHEET NO.
p:\1108468\INTEG.illinois.gov\PI\DOT\Documents\DOT Offices\District 3\Projects\03660000\03660050-ent-500.dgn	PLT SCALE = 100.0000' / in.	CHECKED -	REVISED -					623	(31,34)RS	LASALLE	29	4
PLT DATE = 3/16/2016	DATE -	REVISED -			SCALE:	SHEET 2 OF 5 SHEETS	STA.	TO STA.	CONTRACT NO. 66050			
									[ILLINOIS] FED. AID PROJECT			

CONSTR. CODE
 FEDERAL = 80%
 STATE = 20%
 ROADWAY
 0005
 URBAN

CODE NO.	ITEM	UNIT	TOTAL QUANTITY	
64200108	SHOULDER RUMBLE STRIPS, 8 INCH	FOOT	29333	29333
64200116	SHOULDER RUMBLE STRIPS, 16 INCH	FOOT	8463	8463
66700205	PERMANENT SURVEY MARKERS, TYPE I	EACH	1	1
67000400	ENGINEER'S FIELD OFFICE, TYPE A	CAL MO	3	3
67100100	MOBILIZATION	LSUM	1	1
70100460	TRAFFIC CONTROL AND PROTECTION, STANDARD 701306	LSUM	1	1
70100820	TRAFFIC CONTROL AND PROTECTION, STANDARD 701451	LSUM	1	1
70102620	TRAFFIC CONTROL AND PROTECTION, STANDARD 701501	LSUM	1	1
70106800	CHANGEABLE MESSAGE SIGN	CAL MO	4	4
70300100	SHORT TERM PAVEMENT MARKING	FOOT	10310	10310
70300150	SHORT TERM PAVEMENT MARKING REMOVAL	SO FT	1098	1098
70300210	TEMPORARY PAVEMENT MARKING LETTERS AND SYMBOLS	SO FT	624	624
70300220	TEMPORARY PAVEMENT MARKING - LINE 4"	FOOT	42106	42106
70300240	TEMPORARY PAVEMENT MARKING - LINE 6"	FOOT	6740	6740

14
 △ SPECIALTY ITEMS

CODE NO.	ITEM	UNIT	TOTAL QUANTITY	CONSTR. CODE	
				FEDERAL = 80%	STATE = 20%
				ROADWAY	
				0005	
				URBAN	
70300250	TEMPORARY PAVEMENT MARKING - LINE 8"	FOOT	3404	3404	
70300260	TEMPORARY PAVEMENT MARKING - LINE 12"	FOOT	1564	1564	
△ 78000100	THERMOPLASTIC PAVEMENT MARKING - LETTERS AND SYMBOLS	SQ FT	280.8	280.8	
△ 78000200	THERMOPLASTIC PAVEMENT MARKING - LINE 4"	FOOT	15769	15769	
△ 78000400	THERMOPLASTIC PAVEMENT MARKING - LINE 6"	FOOT	410	410	
△ 78000500	THERMOPLASTIC PAVEMENT MARKING - LINE 8"	FOOT	1669	1669	
△ 78000600	THERMOPLASTIC PAVEMENT MARKING - LINE 12"	FOOT	772	772	
△ 78003100	PREFORMED PLASTIC PAVEMENT MARKING, TYPE B - LETTERS AND SYMBOLS	SQ FT	202.8	202.8	
△ 78008210	POLYUREA PAVEMENT MARKING TYPE I - LINE 4"	FOOT	58241	58241	
△ 78008230	POLYUREA PAVEMENT MARKING TYPE I - LINE 6"	FOOT	3040	3040	
△ 78008240	POLYUREA PAVEMENT MARKING TYPE I - LINE 8"	FOOT	1549	1549	
△ 78008270	POLYUREA PAVEMENT MARKING TYPE I - LINE 24"	FOOT	23	23	
△ 78100100	RAISED REFLECTIVE PAVEMENT MARKER	EACH	393	393	
△ 78200005	GUARDRAIL REFLECTORS, TYPE A	EACH	15	15	

△ SPECIALTY ITEMS

FILE NAME :	USER NAME :	DESIGNED :	REVISED :	STATE OF ILLINOIS DEPARTMENT OF TRANSPORTATION	SUMMARY OF QUANTITIES	F.A.P. RTE.	SECTION	COUNTY	TOTAL SHEETS	SHEET NO.	
pm\11884EBIDHTEG\Illinois.gov\1100T\Documents\1100T\Office\District 3\Projects\036\CD\1100T\036\050\shc-500.dgn	duncanbd	-	-			623	(31,34)RS	LASALLE	29	6	
PLOT SCALE :	CHECKED :	REVISED :	REVISED :			CONTRACT NO. 66050					
PLOT DATE :	DATE :	REVISED :	REVISED :			ILLINOIS FED. AID PROJECT					

SCALE: SHEET 4 OF 5 SHEETS STA. TO STA.

CODE NO.	ITEM	UNIT	TOTAL QUANTITY	CONSTR. CODE	
				FEDERAL = 80%	STATE = 20%
				ROADWAY	
				0005	URBAN
78200020	CURB REFLECTORS	EACH	10	10	
78300100	PAVEMENT MARKING REMOVAL	SO FT	6313	6313	
78300200	RAISED REFLECTIVE PAVEMENT MARKER REMOVAL	EACH	393	393	
X4401198	HOT-MIX ASPHALT SURFACE REMOVAL, VARIABLE DEPTH	SO YD	1139	1139	
△ X7830060	GROOVING FOR RECESSED PAVEMENT MARKING, LETTERS AND SYMBOLS	SO FT	203	203	
△ X7830076	GROOVING FOR RECESSED PAVEMENT MARKING 9"	FOOT	5144	5144	
Z0030850	TEMPORARY INFORMATION SIGNING	SO FT	42	42	
② Z0034105	MATERIAL TRANSFER DEVICE	TON	8265	8265	

△ SPECIALTY ITEMS

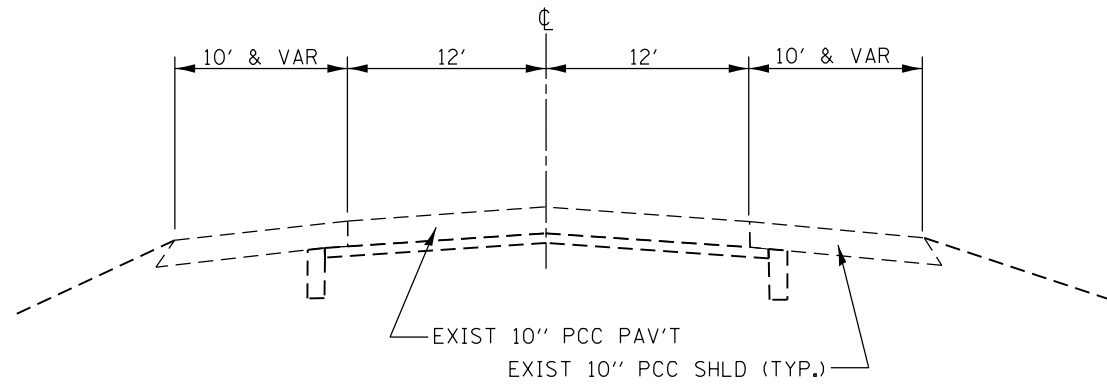

TYPICAL SECTION

STA. 1038+37 TO STA. 1039+27.24

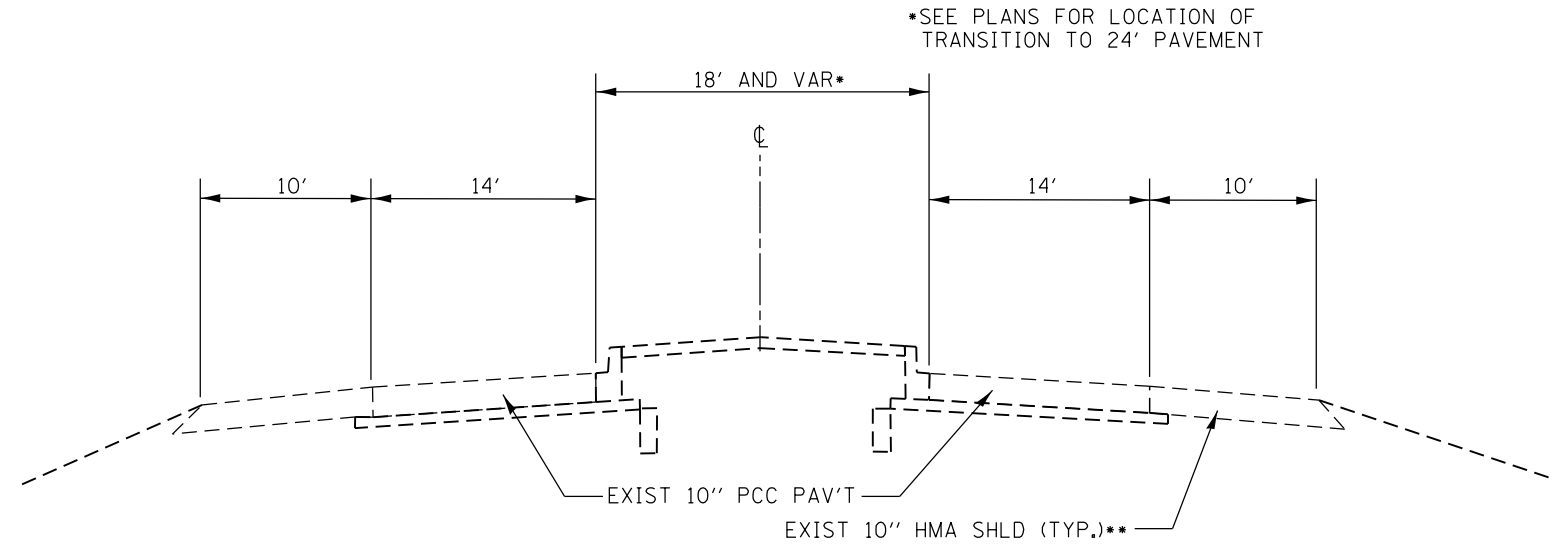

TYPICAL SECTION

STA. 1039+27.24 TO STA. 1051+35.72
 STA. 1056+54.46 TO STA. 1061+40.72
 STA. 1073+62.72 TO STA. 1084+43.30

**PCC SHLD FROM STA. 1039+27.24 TO STA. 1051+35.72

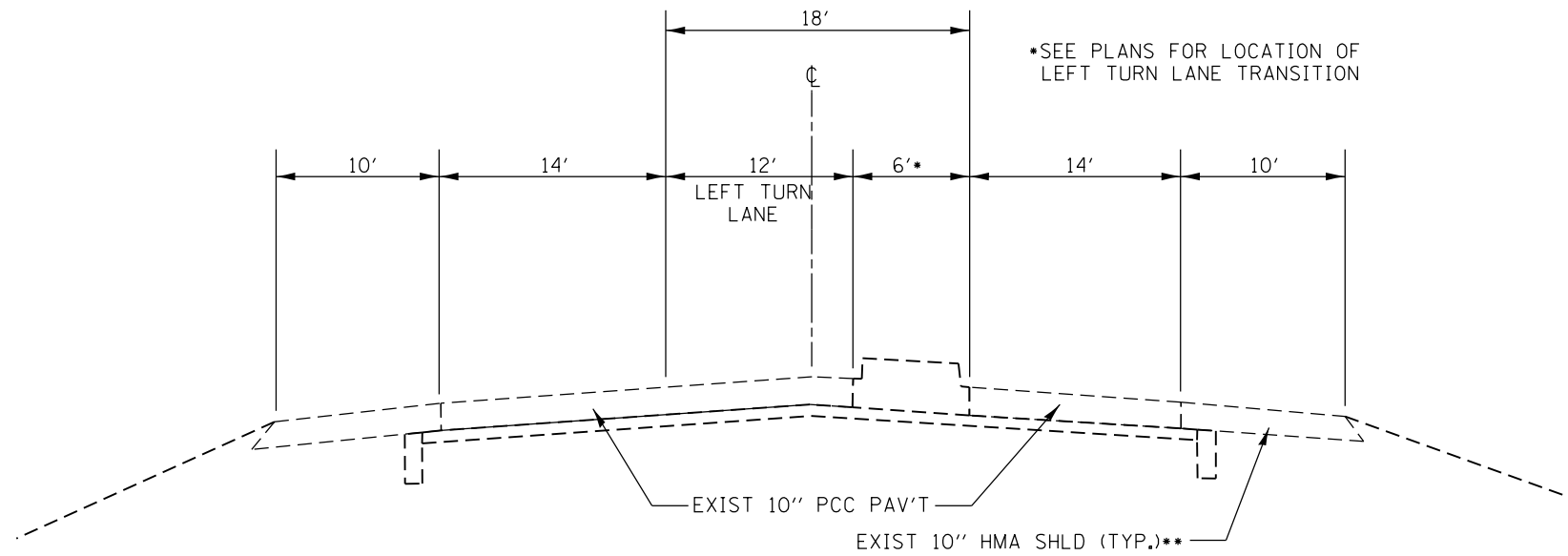

TYPICAL SECTION

STA. 1051+35.72 TO STA. 1056+54.46
 STA. 1061+40.72 TO STA. 1073+62.72

**PCC SHLD FROM STA. 1051+35.72 TO STA. 1053±17

FILE NAME =	USER NAME = duncanbd	DESIGNED -	REVISED -
p:\11\084EBIDINTEG.illinois.gov\PWIDOT\Documents\DOT Offices\District 3\Projects\0366\DRAWING\B366050-shd-typical.dgn		CHECKED -	REVISED -
		DATE -	REVISED -

**STATE OF ILLINOIS
 DEPARTMENT OF TRANSPORTATION**

TYPICAL SECTIONS

SCALE: SHEET 1 OF 3 SHEETS STA. TO STA.

F.A.P. RTE.	SECTION	COUNTY	TOTAL SHEETS	SHEET NO.
623	(31,34)RS	LASALLE	29	8
CONTRACT NO. 66D50			ILLINOIS FED. AID PROJECT	

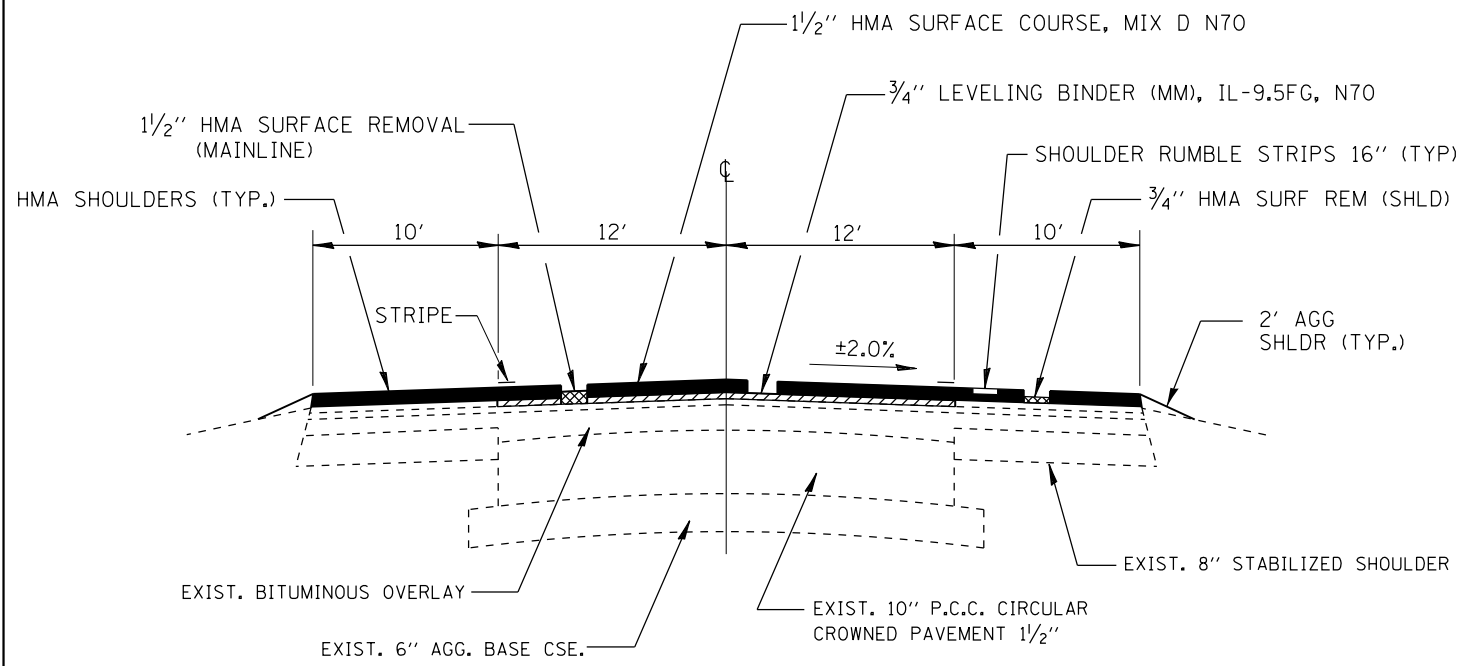

TYPICAL SECTION

STA. 1084+43.3 TO STA. 1087+87.75
 (STA. EQUATION: STA. 1087+87.75 BK = STA. 70+43 AH)
 STA. 70+43 TO STA. 71+77

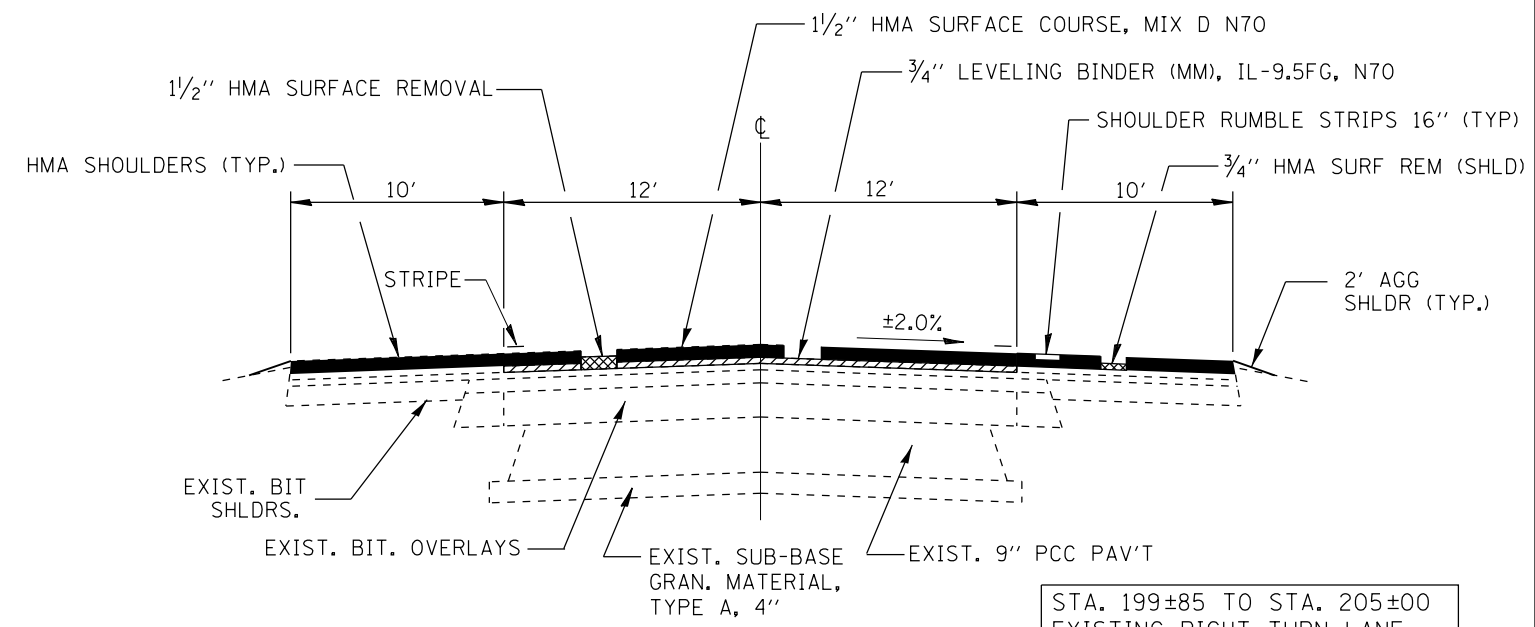

TYPICAL SECTION

STA. 158+00 TO STA. 162+25
 (STA. EQUATION: 162+25 BK = 171+72.10 AH)
 STA. 171+72.10 TO STA. 205+00

STA. 199±85 TO STA. 205±00
 EXISTING RIGHT TURN LANE
 & VARIABLE SHOULDER WIDTHS

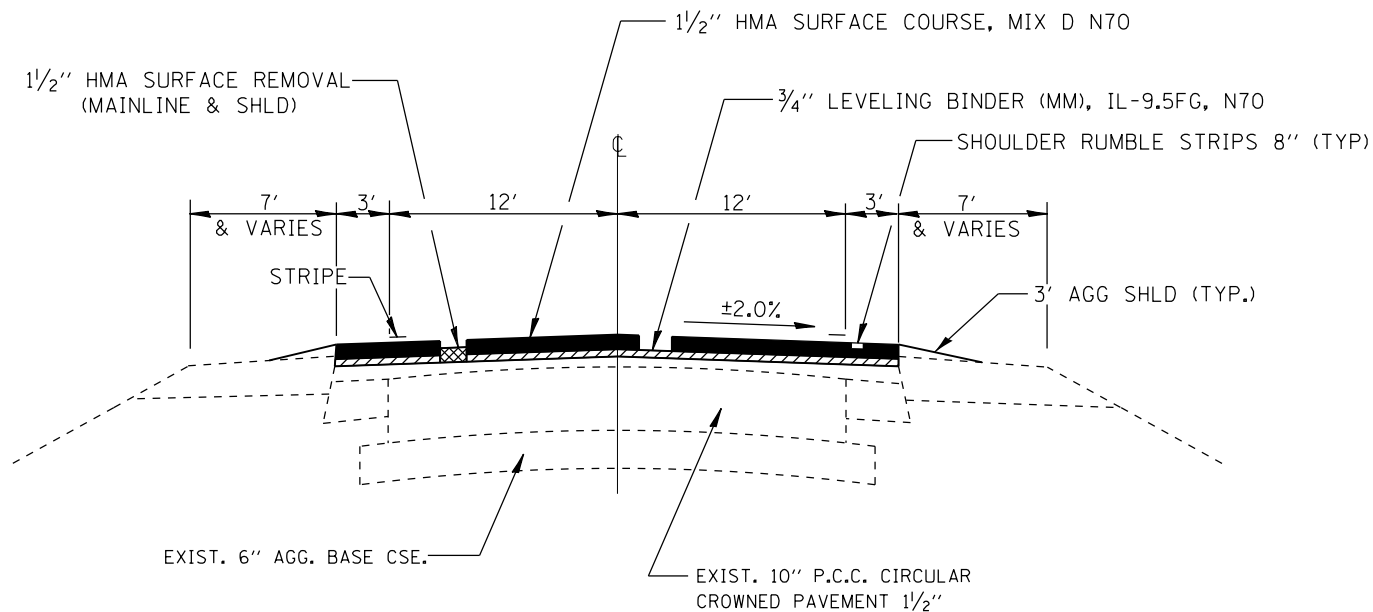

TYPICAL SECTION

STA. 71+77 TO STA. 158+00
 STA. 205±00 TO STA. 223+66.5
 STA. 249+40 TO STA. 252+00
 (STA. EQUATION: 252+00 BK = 266+39.71 AH)
 STA. 266+39.71 TO STA. 279+80
 WIDTH TRANSITION: STA. 278+83 TO STA. 279+80

MIXTURES TABLE				
	HMA LEVEL BINDER	HMA SURFACE	INCIDENTAL HMA	HMA SHOULDER
PG GRADE	PG64-22	PG64-22	PG64-22	PG64-22
DESIGN AIR VOIDS	4.0% @ N70	4.0% @ N70	4.0% @ N50	4.0% @ N50
MIXTURE COMPOSITION	IL 9.5 FG	IL 9.5	IL 9.5	IL 9.5
FRICTION AGGREGATE		MIXTURE D	MIXTURE C	MIXTURE C
DENSITY TEST METHOD	GROWTH CURVE	CORES	CORES	GROWTH CURVE
MIXTURE WEIGHT	112 lb/ Sq. Yd./ In.	112 lb/ Sq. Yd./ In.	112 lb/ Sq. Yd./ In.	112 lb/ Sq. Yd./ In.
QUALITY MANAGEMENT PROGRAM	QCP	QCP	QC/QA	QC/QA
SUBLOT SIZE	700 TONS	1000 TONS	N/A	N/A
LOCATION(S)	ENTIRE PROJECT	ENTIRE PROJECT	VARIOUS	VARIOUS

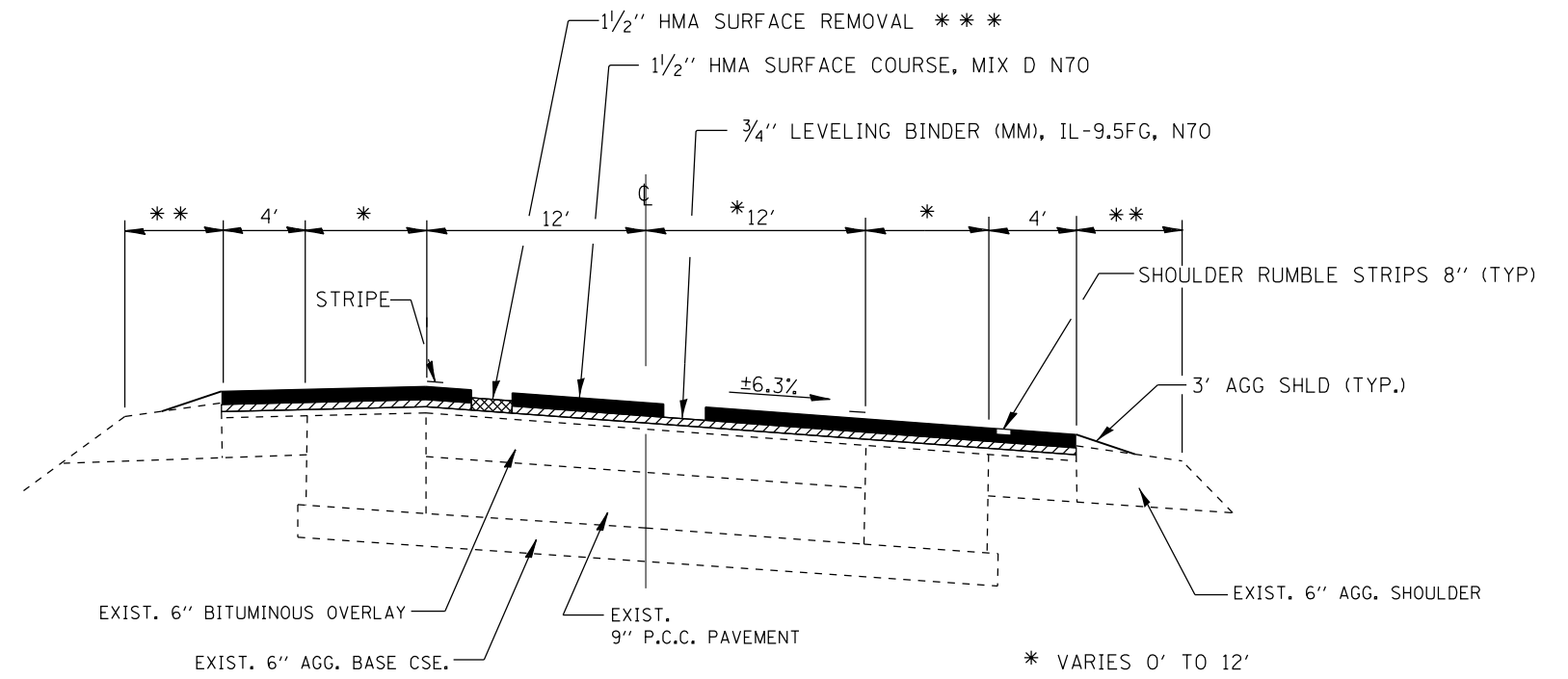

TYPICAL SECTION

STA. 223+66.5 TO STA. 249+40

- * VARIES 0' TO 12'
- ** VARIES 0' TO 6'-0"
- *** FROM STA. 240+00 TO STA. 244+00
2 1/4" HMA SURFACE REMOVAL
SEE MILLING DETAIL

FILE NAME =	USER NAME = duncanbd	DESIGNED -	REVISED -	STATE OF ILLINOIS DEPARTMENT OF TRANSPORTATION	TYPICAL SECTIONS			F.A.P. RTE.	SECTION	COUNTY	TOTAL SHEETS	SHEET NO.
p:\11\084EBIDINTEG.illinois.gov\PIWIDOT\Documents\DOT Offices\District 3\Projects\0366050\Drawings\0366050-sh-typical.dgn		CHECKED -	REVISED -		623	(31,34)RS	LASALLE	29	10			
PLOT SCALE = 100.0000' / in.		CHECKED -	REVISED -		CONTRACT NO. 66D50							
PLOT DATE = 3/16/2016		DATE -	REVISED -		SCALE:	SHEET 3 OF 3 SHEETS	STA.	TO STA.	ILLINOIS FED. AID PROJECT			

MAINLINE SCHEDULE

LOCATION STA. TO STA.	LENGTH FEET	WIDTH FEET	SHLD WIDTH FEET	HMA	HMA	HMA	HMA	HMA	LEVEL	BIT	MIX FOR	LEVEL	HMA	SHLD RUMBLE STRIPS		TEMP	AGG WEDGE
				SURF REM	SURF REM	SURF REM	SURF REM	SURF CSE	BINDER	CRACKS, JTS	BINDER	SHLD	8"	16"	RAMP	SHLDR	
				3/4"	1 1/2"	2 1/4"	VAR DPTH	MIX	(MM)	& FLGWYS	(HM)	TON	TON	TON	TON	TON	TON
1084+43 TO 1087+87.75	344.75	24	20	766.1	919.3			77.2	38.6	965.3	0.3	0.5	64.4		690	13.33	19.6
STATION EQUATION 1087+87.75 BK = 70+43 AH																	
70+43 AH TO 71+77	134	24	20	297.8	357.3			30.0	15.0	375.2	0.1	0.2	25.0		268		7.6
71+77 TO 158+00	8623	24	6		28743.3			2414.4	1207.2	19401.7	8.6	14.4		17246			491.0
158+00 TO 162+25 BK	425	24	20	944.4	1133.3			95.2	47.6	1190.0	0.3	0.6	79.3		850		24.2
STATION EQUATION 162+25 BK = 171+72.10 AH																	
171+72.10 AH TO 205+00	3327.9	24	20	7395.3	8874.4			745.4	372.7	9318.1	2.7	4.4	621.2		6656		
205+00 TO 223+66.5	1866.5	24	6		6221.7			522.6	261.3	4199.6	1.9	3.1		3733			106.3
223+66.50 TO 228+66.50	500	35.75	8		2430.6			204.2	102.1	1640.7	0.7	1.2		1000			28.5
228+66.50 TO 229+75.25	108.75	41.75	8		601.1			50.5	25.2	405.7	0.2	0.3		218			6.2
229+75.25 TO 230+57.80	82.55	36	14		458.6			38.5	19.3	309.6	0.1	0.2		165			4.7
230+57.80 TO 231+94	136.2	42	8		756.7			63.6	31.8	510.8	0.2	0.4		272			7.8
231+94 TO 235+57.80	363.8	48	8		2263.6			190.1	95.1	1527.9	0.7	1.1		728			20.7
235+57.80 TO 236+59	101.2	42	4		517.2			43.4	21.7	349.1	0.2	0.3		202			5.8
236+59 TO 237+59	100	36	8		488.9			41.1	20.5	330.0	0.1	0.2		200			5.7
237+59 TO 238+59	100	37.5	8		505.6			42.5	21.2	341.3	0.2	0.3		200			5.7
238+59 TO 239+00	41	39	8		214.1			18.0	9.0	144.5	0.1	0.1		82			2.3
239+00 TO 240+00	100	39	8					43.9	21.9	352.5	0.2	0.3		200			5.7
240+00 TO 244+00	400	VAR	VAR				2475.1	207.9	104.0	1670.7	0.7	1.2		800		37.0	22.8
244+00 TO 245+00	100	47.5	8					51.8	25.9	416.3	0.2	0.3		200			5.7
245+00 TO 246+71.78	171.78	44.75	8		1006.8			84.6	42.3	679.6	0.3	0.5		344			9.8
246+71.78 TO 249+40	268.22	32.75	8		1214.4			102.0	51.0	819.7	0.4	0.6		536			15.3
249+40 TO 252+00 BK	260	24	6		866.7			72.8	36.4	585.0	0.3	0.4		520			14.8
STATION EQUATION 252+00 BK = 266+39.71 AH																	
266+39.71 AH TO 278+83	1243.29	24	6		4144.3			348.1	174.1	2797.4	1.2	2.1		2487			70.8
278+83 TO 279+83	100	24	16		177.8			22.4	11.2	260.0	0.1	0.1	14.9	200		13.33	5.7
TOTAL				9581	61985	2475	1139	5510	2755	48591	20	33	805	29333	8463	64	887

SIDEROAD SCHEDULE

STATION	SIDE	DESCRIPTION	MATERIAL	WIDTH FOOT	AREA SQ FT	HMA	HMA	INCIDENTAL HMA SURFACING TON	BIT TACK COAT POUND	EROSION CONTROL BLANKET SQ YD	FURN EXC CU YD	SEED CL 2 ACRE	FERTILIZER NUTRIENT			TEMP RAMPS SQ YD
						SURFACE REMOVAL 1 1/2"	SURFACE REMOVAL BUTT JT.						NIT	PHOS	POT	
						SQ YD	SQ YD						POUND	POUND	POUND	
123+15	LT.	ENTERPRISE RD.	CONC	26	1860	206.7		26	93	49	2.7	0.01	1	1	1	45.6
138+70	LT.	E 6TH RD	HMA	26	2162	240.2		25.6	108.1	28.3	1.2	0.01	1	1	1	19.4
152+82	LT.	N. 29TH RD.	HMA	25	2145	238.3		25.4	107.3	30	1.3	0.01	1	1	1	13.9
189+20	LT.	MARY SENICA DR.	HMA	34	1580		175.6	18.7	79	21.7	0.9	0.01	1	1	1	18.9
203+88	LT.	E. 709TH RD.	HMA	23	1338	148.7		15.8	66.9	25	1.04	0.01	1	1	1	12.8
204+05	RT.	C.H. 28 (UTICA RD)	HMA	43	3000	333.3		35.5	150	36.7	1.53	0.01	1	1	1	33.9
225+90	LT.	E. 729TH RD.	HMA	26	1784	198.2		21.1	89.2	27	1.13	0.01	1	1	1	14.4
242+77	LT.	MURPHY DR.	CONC	NO WORK												
TOTALS						1365	176	168	694	218	10	0.1	7	7	7	159

PATCHING SCHEDULE - US 6 EASTBOUND LANES

LOCATION BY STATION	LENGTH		WIDTH		LEFT TURN LANE				MAINLINE				
	TURN LANE (FT)	MAIN LINE (FT)	TURN LANE (FT)	MAIN LINE (FT)	CLASS B PATCHING		DOWEL BARS EACH	SAW CUTS FOOT	CLASS B PATCHING			DOWEL BARS EACH	SAW CUTS FOOT
					TYPE I SQ YD	TYPE II SQ YD			TYPE II SQ YD	TYPE III SQ YD	TYPE IV SQ YD		
1039+28		6		12					8			20	54
1039+67		6		12					8			20	54
1042+63		20		16						36		28	108
1042+88		8		16					14			28	72
1043+43		6		15					10			26	63
1043+98		6		15					10			26	63
1045+22		6		16					11			28	66
1046+00		20		16						36		28	108
1046+84		6		15					10			26	63
1047+63		6		15					10			26	63
1048+47		6		14					9			24	60
1048+92		7		15					12			26	66
1049+31		6		17					11			30	69
1049+62	6	6	6	14	4		8	36	9			24	60
1050+23	6		9			6	14	45					
1050+46		6		14					9			24	60
1050+62	6		9			6	14	45					
1050+85	6	6	10	14		7	16	48	9			24	60
1051+02	6	6	10	14		7	16	48	9			24	60
1051+42	6		12			8	20	54					
1051+67	6	6	12	14		8	20	54	9			24	60
1052+23	6	6	12	14		8	20	54	9			24	60
1053+61	6	10	12	14		8	20	54		16		24	72
1055+45	6	6	12	14		8	20	54	9			24	60
1056+12		6		14					9			24	60
1059+02		6		14					9			24	60
1059+78		6		14					9			24	60
1060+11		6		14					9			24	60
1060+79		6		14					9			24	60
1061+43		6		14					9			24	60
1062+13		6		14					9			24	60
1062+54		6		14					9			24	60
1063+17		6		14					9			24	60
1063+58		6		14					9			24	60
1063+85		6		14					9			24	60
1070+58		6		14					9			24	60
1070+74		6		14					9			24	60
1071+15		6		14					9			24	60
1071+55		6		14					9			24	60
1071+95		6		14					9			24	60
1072+22	6	6	12	14		8	20	54	9			24	60
1072+57	10	6	12	14		13	20	66	9			24	60
1072+99	6	6	12	14		8	20	54	9			24	60
1073+21		6		14					9			24	60
1073+36		6		14					9			24	60
1073+56	6	6	12	14		8	20	54	9			24	60
1074+00		6		14					9			24	60
1074+18		6		14					9			24	60
1074+40		6		14					9			24	60
1074+80		8		14				12	24			66	
1075+19		6		14					9			24	60
1075+74		10		14						16		24	72
1076+79		6		14					9			24	60
1077+37		6		14					9			24	60
1078+39		6		14					9			24	60
1078+79		6		14					9			24	60
1078+96		6		14					9			24	60
1079+61		6		14					9			24	60
1079+81		6		14					9			24	60
1080+02		6		14					9			24	60
1080+28		6		14					9			24	60
1080+43		6		14					9			24	60
1080+82		6		14					9			24	60
1080+99		6		14					9			24	60
1081+21		6		14					9			24	60
1081+49		6		14					9			24	60
1081+89		6		14					9			24	60
1082+09		6		14					9			24	60
1082+47		6		14					9			24	60
1082+95		6		14					9			24	60
1083+44		6		14					9			24	60
1083+78		6		14					9			24	60
1084+13		6		14					9			24	60
1084+26		6		14					9			24	60
EASTBOUND TOTALS					4	103	248	720	637	32	72	1728	4419

PATCHING SCHEDULE - US 6 WESTBOUND LANES

LOCATION BY STATION	LENGTH		WIDTH		LEFT TURN LANE				MAINLINE					
	TURN LANE (FT)	MAIN LINE (FT)	TURN LANE (FT)	MAIN LINE (FT)	CLASS B PATCHING		DOWEL BARS EACH	SAW CUTS FOOT	CLASS B PATCHING			TIE BARS EACH	DOWEL BARS EACH	SAW CUTS FOOT
					TYPE I SQ YD	TYPE II SQ YD			TYPE II SQ YD	TYPE III SQ YD	TYPE IV SQ YD			
1039+05		6		12					8				20	54
1039+28		6		12					8				20	54
1039+67		6		12					8				20	54
1040+06		6		12					8				20	54
1040+24		6		12					8				20	54
1040+45		6		12					8				20	54
1040+86		6		12					8				20	54
1041+83		6		12					8				20	54
1043+43		6		15					10				26	63
1043+98		6		15					10				26	63
1045+10		6		14					9				24	60
1045+49		6		14					9				24	60
1047+23		6		14					9				24	60
1047+98		20		14							31		24	102
1049+44		6		15									26	63
1050+01		6		14					9				24	60
1050+62		6		14					9				24	60
1053+61		6		14					9				24	60
1054+45		6		14					9				24	60
1054+76		6		14					9				24	60
1056+12	6	6	12	14			8	20	54				24	60
1056+30	6		12				8	20	54					
1056+72		20		14							31		24	102
1057+16	6	6	9	14			6	14	45	9			24	60
1057+83	6	16	3	14			2	2	27		25		24	90
1059+17		6		14					9				24	60
1059+78		6		14					9				24	60
1060+33		6		14					9				24	60
1060+55		25		14							39	24	24	117
1061+43		20		14							31		24	102
1061+56	6		12				8	20	54					
1061+80		6		14					9				24	60
1062+13	6	6	12	14			8	20	54	9			24	60
1062+35	6	6	12	14			8	20	54	9			24	60
1062+54		10		14							16		24	72
1062+77	6	6	12	14			8	20	54	9			24	60
1063+17	6	6	12	14			8	20	54	9			24	60
1063+39		6		14					9				24	60
1063+58	6	6	12	14			8	20	54	9			24	60
1063+85		6		14					9				24	60
1064+00		6		14					9				24	60
1064+22	11		12				15	20	69					
1064+41	6	6	12	14			8	20	54	9			24	60
1070+74		6		14					9				24	60
1070+92		6		14					9				24	60
1071+39		6		14					9				24	60
1071+69		6		14					9				24	60
1072+22		6		14					9				24	60
1072+57		6		14					9				24	60
1072+99		6		14					9				24	60
1073+68		10		14							16		24	72
1074+11		7		14							11		24	63
1075+00		6		14					9				24	60
1075+43		6		14					9				24	60
1077+03		6		14					9				24	60
1078+20		6		14					9				24	60
1079+44		6		14					9				24	60
1080+28		6		14					9				24	60
1080+69		6		14					9				24	60
1081+34		6		14	</									

ENTRANCE SCHEDULE											
STATION	SIDE	TYPE	WIDTH	MATERIAL	AREA	INCIDENTAL HMA SURFACE	BITUMINOUS TACK COAT	AGGREGATE SURFACE COURSE TYPE B	HMA SURFACE REMOVAL 1 1/2"	PCC SURF REMOVAL BUTT JT.	*HMA SURFACE REMOVAL BUTT JT.
			FOOT		SQ FT	TON	POUND	TON	SQ YD	SQ YD	SQ YD
1084+94	RT	PE	23	HMA	330	3.90	16.5				36.7
1085+75	RT	PE	25	HMA	340	4.02	17				37.8
71+76	RT	CE	22	HMA	175	2.07	8.8				19.4
72+60	RT	CE	22	HMA	481	5.69	24.1		53.4		
72+68	LT	PE/MBTO	24	HMA	153	1.81	7.7		17		
74+08	LT	FE	23	HMA	292	3.45	14.6		32.4		
74+31	LT	MBTO	23	HMA	240	3.36	12		26.7		
74+31	RT	PE	30	HMA	570	6.74	28.5		63.3		
77+61	RT	CE	20	PCC	961	11.36	48.1			106.8	
81+87	LT	MBTO	61	HMA	360	5.04	18		40		
81+87	RT	PE	19	HMA	171	2.02	8.6		19		
82+88	LT	PE	20	HMA	280	3.31	14		31.1		
87+07	LT	MBTO	59	HMA	295	4.13	14.8		32.8		
87+07	RT	PE	26	HMA	462	5.46	23.1		51.3		
89+83	LT	PE/MBTO	18	HMA	504	5.96	25.2		56		
90+55	LT	MBTO	90	HMA	540	7.56	27		60		
90+55	RT	PE	23	HMA	413	4.88	20.7		45.9		
93+40	RT	CE	24	HMA	995	11.76	49.8		110.6		
94+14	LT	FE		AGG				5.00			
100+72	RT	CE	12	HMA	486	5.75	24.3		54		
103+29	LT	FE		AGG				5.00			
106+07	RT	PE	24	HMA	520	6.15	26		57.8		
106+36	LT	MBTO	64	HMA	448	6.27	22.4		49.8		
107+41	RT	CE	31	HMA	709	8.38	35.5		78.8		
109+16	RT	CE	28	HMA	1029	12.17	51.5		114.3		
109+64	LT	PE/MBTO	18	HMA	744	8.80	37.2		82.7		
115+50	RT	CE	22	HMA	865	10.23	43.3		96.1		
115+50	LT	MBTO	64	HMA	512	7.17	25.6		56.9		
118+40	LT	CE	19	HMA	516	6.10	25.8		57.3		
122+94	RT	CE	24	PCC	633	7.48	31.7			70.3	
132+82	LT	CE	35	PCC	1105	13.06	55.3			122.8	
142+66	RT	FE		AGG				5.00			
151+77	RT	CE	39	PCC	710	8.39	35.5			78.9	
152+95	RT	CE	35	PCC	640	7.57	32			71.1	
159+58	RT	CE	44	HMA	655	7.74	32.8				72.8
161+63	LT	FE	17	AGG				5.00			
172+53	RT	FE	15	AGG				5.00			
173+95	LT	PE	21	PCC	756	8.94	37.8				84
182+07	RT	CE	21	HMA	483	5.71	24.2				53.7
182+95	LT	PE		AGG				5.00			
184+35	LT	PE		AGG				5.00			
185+71	LT	PE	NO WORK	PCC							
192+99	LT	PE		AGG				5.00			
215+00	LT	FE		GRASS				5.00			
215+00	RT	FE		GRASS				5.00			
221+16	RT	PE	20	HMA	477	5.64	35.8		53		
229+45	RT	CE	38	HMA	1065	12.59	79.9		118.3		
236+27	RT	CE	31	HMA	1103	13.04	82.7		122.6		
240+80	LT	FE	33	HMA	836	9.88	62.7		92.9		
242+32	RT	FE	17	HMA	182	2.15	13.7		20.2		
270+05	LT	CE/MBTO	31	HMA	1152	13.62	86.4		128		
270+05	RT	CE	25	HMA	696	8.23	52.2		77.3		
275+86	LT	CE	19	PCC	1588	18.77	119.1		176.4		
278+85	LT	CE	NO WORK	PCC							
TOTALS						306	1452	50	2076	450	304

*TO BE USED FOR ENTRANCES BEYOND THE 8'/10' SHOULDERS

PAVEMENT MARKINGS

LOCATION	POLYUREA TYPE 1					PREF PLAS LETTERS & SYMBOLS* SQ FT	THERMOPLASTIC								RAISED REFL PAVT MARK EACH	TEMPORARY PAVEMENT MARKING					SHORT TERM (3 APP) FOOT
	4"		6"	8"*	24"		4"		6"	8"	12"		24"	LETTERS & SYMBOLS SQ FT		4"	6"	8"	12"	LETTERS & SYMBOLS SQ FT	
	YELLOW FOOT	WHITE FOOT	YELLOW FOOT	WHITE FOOT	WHITE FOOT		YELLOW FOOT	WHITE FOOT	YELLOW FOOT	WHITE FOOT	YELLOW FOOT	WHITE FOOT	WHITE FOOT	LETTERS & SYMBOLS SQ FT		(2 APPLICATIONS)					
US 6																					
1038+37 - 1054+50																					
CENTERLINE/MEDIAN	3079																				
EDGE LINE		2368																			
TURN LANE				317		46.8															160
1054+50 - 1061+45																					
MEDIAN	1168																				
EDGE LINE		843																			
TURN LANE				148		31.2															105
1061+45 - 1073+59																					
MEDIAN	2211																				
EDGE LINE		2388																			
TURN LANE				891		93.6															340
LEFT TURN MOVEMENT	40																				
1073+59 - 1081+23																					
MEDIAN	1522																				
EDGE LINE		1230																			
1081+23 - 1084+43																					
CENTERLINE			80																		48
EDGE LINE		537																			
NO PASSING ZONE	320																				
1084+43 - 1087+87.75 BK																					
CENTERLINE			90												4		180				103.5
EDGE LINE		690																			
NO PASSING ZONE	345															690					
70+43 AH - 72+20																					
CENTERLINE			50												2		100				53.1
EDGE LINE		354																			
NO PASSING ZONE	177															354					
72+20 - 103+46																					
CENTERLINE			780												40		1560				937.8
EDGE LINE		6252																			
103+46 - 111+93																					
CENTERLINE			210												11		420				254.1
EDGE LINE		1694																			
NO PASSING ZONE	847															1694					
111+93 - 124+41																					
EDGE LINE		2496																			
DOUBLE NO PASSING ZONE	2496														16		4992				374.4
124+41 - 129+60																					
CENTERLINE			130												7		260				155.7
EDGE LINE		1038																			
NO PASSING ZONE	519															1038					
129+60 - 131+37																					
CENTERLINE			50												2		100				53.1
EDGE LINE		354																			
131+37 - 138+72																					
CENTERLINE			180												9		360				220.5
EDGE LINE		1470																			
NO PASSING ZONE	735															1470					
138+72 - 147+76																					
EDGE LINE		1808																			
DOUBLE NO PASSING ZONE	1808														11		3616				271.2
147+76 - 156+80																					
CENTERLINE			220												12		440				271.2
EDGE LINE		1808																			
NO PASSING ZONE	904															1808					
156+80 - 162+25 BK																					
CENTERLINE			140												6		280				163.5
EDGE LINE		1090																			
171+72.10 AH - 174+35																					
CENTERLINE			60												4		120				78.9
EDGE LINE		526																			
174+35 - 183+82																					
CENTERLINE			240												12		480				284.1
EDGE LINE		1894																			
NO PASSING ZONE	947															1894					
183+82 - 184+97																					
CENTERLINE			30												1		60				34.5
EDGE LINE		230																			

*NOTE: PREFORMED PLASTIC LETTERS & SYMBOLS AND 8" LINES TO BE GROOVED

FILE NAME =	USER NAME = duncanbd	DESIGNED -	REVISED -	STATE OF ILLINOIS DEPARTMENT OF TRANSPORTATION	SCHEDULES	F.A.P. RTE.	SECTION	COUNTY	TOTAL SHEETS	SHEET NO.	
pw:\IL\084EBID\INTEG\illinois.gov\PI\DOT\Documents\DOT Offices\District 3\Projects\0366\DRAWING\0366\050-shr-schedule.dgn		CHECKED -	REVISED -			623	(31,34)RS	LASALLE	29	14	
Default	PLOT SCALE = 100.0000' / in.	DATE -	REVISED -			CONTRACT NO. 66D50					
	PLOT DATE = 3/16/2016					SCALE:	SHEET 4	OF 5	SHEETS	STA.	TO STA.

PAVEMENT MARKINGS																									
LOCATION	POLYUREA TYPE 1					PREF PLAS LETTERS & SYMBOLS* SQ FT	THERMOPLASTIC							RAISED REFL PAVT MARK EACH	TEMPORARY PAVEMENT MARKING					SHORT TERM (3 APP) FOOT					
	4"		6"		8"*		24"	4"		6"		8"	12"		24"	LETTERS & SYMBOLS SQ FT	(2 APPLICATIONS)								
	YELLOW	WHITE	YELLOW	WHITE	WHITE		YELLOW	WHITE	YELLOW	WHITE	YELLOW	WHITE	WHITE		FOOT		FOOT	FOOT	FOOT		FOOT	FOOT	FOOT	FOOT	FOOT
	FOOT	FOOT	FOOT	FOOT	FOOT		FOOT	FOOT	FOOT	FOOT	FOOT	FOOT	FOOT		FOOT		FOOT	FOOT	FOOT		FOOT	FOOT	FOOT	FOOT	FOOT
184+97 - 194+49																									
CENTERLINE			240																						
EDGE LINE	1904																				285.6				
NO PASSING ZONE	952																								
194+49 - 201+64																									
CENTERLINE		1430																							
DOUBLE NO PASSING ZONE	1430																				214.5				
TURN LANE				46																					
201+64 TO 205+00																									
CENTERLINE			80																		100.8				
EDGE LINE		460																							
NO PASSING ZONE	336																								
TURN LANE				147		31.2															42.3				
STOP BAR					23																				
205+00 TO 223+47																									
CENTERLINE			460																		554.1				
EDGE LINE		3694																							
NO PASSING ZONE	1847																								
223+47 TO 229+45																									
MEDIAN							2086				233										611.1				
EDGE LINE								1175																	
TURN LANE									294					46.8					588		93.6	213.0			
229+45 TO 236+27																									
MEDIAN							2022				265										532.8				
EDGE LINE								1346																	
TURN LANE									544					93.6					860		187.2	939.0			
236+27 TO 242+75																									
MEDIAN							1160														348.0				
EDGE LINE								1133																	
TURN LANE									492					93.6					984		187.2	930.0			
242+75 TO 249+40																									
CENTERLINE									20																
EDGE LINE										1205															
NO PASSING ZONE								49																	
MEDIAN								2126				184													
TURN LANE											339			46.8					678		93.6	486.3			
STOP BAR																									
249+40 TO 252+00 BK																									
CENTERLINE									60																
EDGE LINE										520															
NO PASSING ZONE								260																	
266+39.71 AH TO 279+80																									
CENTERLINE																									
EDGE LINE																									
NO PASSING ZONE								7																	
SHOULDER DIAGONALS													90								200				
TOTALS	21683	36558	3040	1549	23	202.8	7710	8059	410	1669	682	90	0	280.8	393	42106	6740	3404	1564	624.0	10310				

*NOTE: PREFORMED PLASTIC LETTERS & SYMBOLS AND 8" LINES TO BE GROOVED

US RTE 6	LITTLE VERMILION RIVER E OF BLACKSTONE ST IN LASALLE TO ILL 178	LASALLE COUNTY			
GPS POINT NUMBER OR INDEX NUMBER	DESCRIPTION	EXISTING MONUMENT TYPE	PROPOSED MONUMENT TYPE	MONUMENT RECORD TO BE RECORDED	RESPONSIBILITY
006003	S QTR COR SEC 6-33-2E OF THE 3RD PM	PK NAIL	TYPE 1	YES	1

LISTED MONUMENT HAS BEEN RECORDED BY GPS. PRE CONSTRUCTION TIES BY THE R.E. ARE NOT REQUIRED.
 THE R.E. MUST TIE AND BRING TO THE ATTENTION OF THE PLATS AND PLANS MANAGER ANY ADDITIONAL UNLISTED MONUMENTS FOUND.
 UPON PAVING COMPLETION, THE R.E. WILL DIRECT THE PLATS AND PLANS MANAGER TO STAKE THE LOCATION FOR TYPE 1 MONUMENT CORING.
 PLATS AND PLANS WILL PREPARE AND RECORD THE REQUIRED MONUMENT RECORD.

RESPONSIBILITY:
 1) RESIDENT TO RE-ESTABLISH MONUMENT (PAY ITEM REQUIRED. PERMANENT SURVEY MARKER, TYPE 1)
 2) PLATS AND PLANS TO RE-ESTABLISH MONUMENT

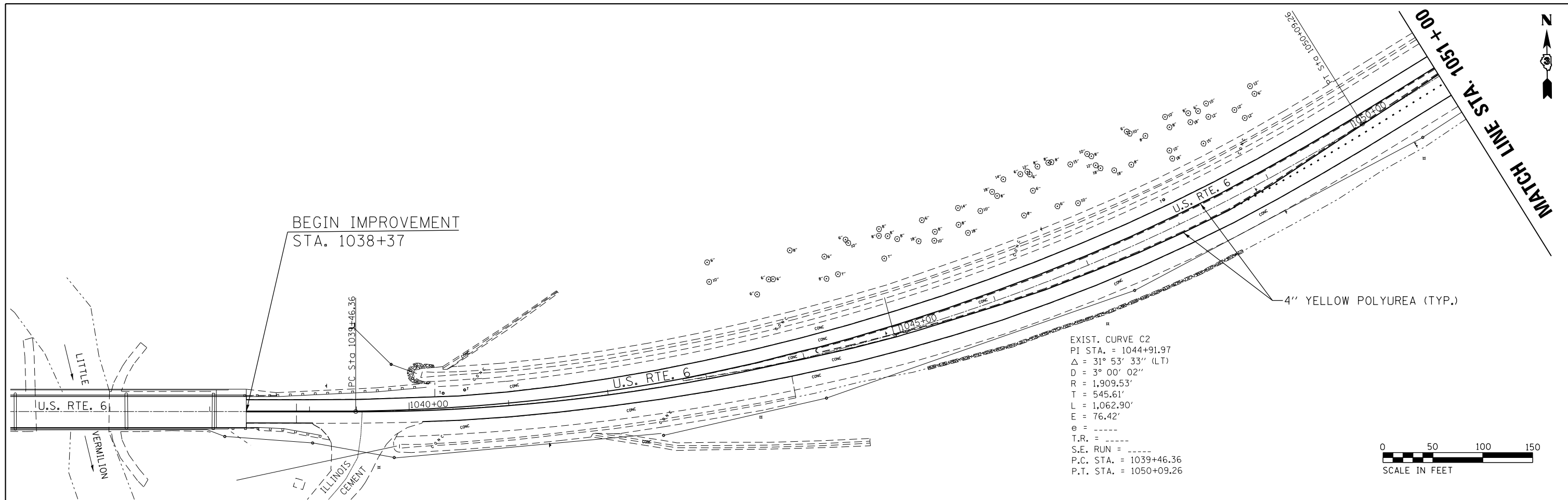

EXIST. CURVE C2
 PI STA. = 1044+91.97
 $\Delta = 31^\circ 53' 33''$ (LT)
 $D = 3^\circ 00' 02''$
 $R = 1,909.53'$
 $T = 545.61'$
 $L = 1,062.90'$
 $E = 76.42'$
 $e = \text{---}$
 $T.R. = \text{---}$
 $S.E. \text{ RUN} = \text{---}$
 $P.C. \text{ STA.} = 1039+46.36$
 $P.T. \text{ STA.} = 1050+09.26$

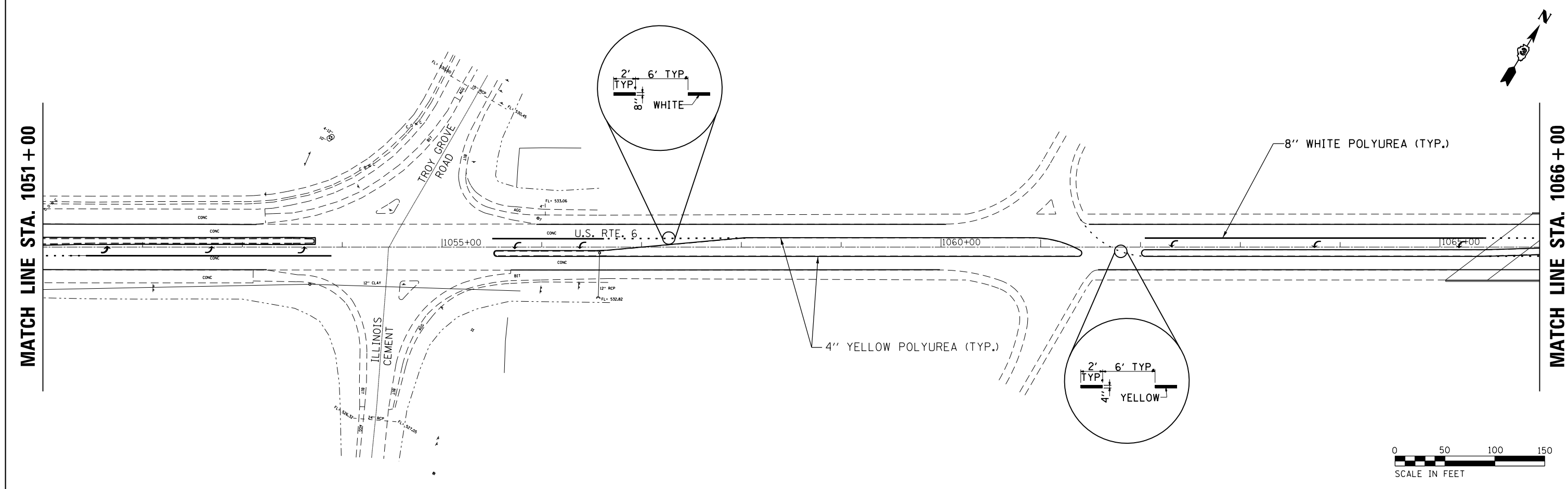

2' TYP. 6' TYP. 4" YELLOW



FILE NAME =	USER NAME = duncanbd	DESIGNED -	REVISED -
p:\1\084EBIDINTEG.illinois.gov\PIWIDOT\Documents\DOT Offices\District 3\Projects\03660\Drawings\0366050-shr-plan.dgn		DRAWN -	REVISED -
	PLOT SCALE = 100.0000' / in.	CHECKED -	REVISED -
	PLOT DATE = 3/16/2016	DATE -	REVISED -

**STATE OF ILLINOIS
 DEPARTMENT OF TRANSPORTATION**

PLAN VIEW

SCALE: 1:50 SHEET NO. 1 OF 10 SHEETS STA. 1036+00 TO STA. 1066+00

F.A.P. RTE.	SECTION	COUNTY	TOTAL SHEETS	SHEET NO.
623	(31,34)RS	LASALLE	29	16
CONTRACT NO. 66D50				
ILLINOIS FED. AID PROJECT				

MATCH LINE STA. 1066+00

MATCH LINE STA. 1081+00

SN 050-0195
NO WORK

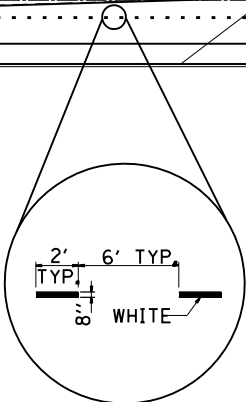
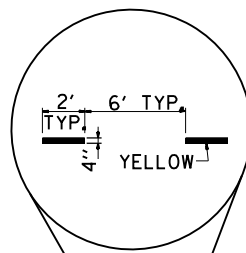

8" WHITE POLYUREA (TYP.)

4" YELLOW POLYUREA (TYP.)



MATCH LINE STA. 1081+00

MATCH LINE STA. 78+00

BEGIN RESURFACING
STA. 1084+43.3

SN 050-2587
STA. 1086+93

EQUATION:
POT Sta. 1087+87.75 BK =
POT Sta. 70+43.00 AH

END OF CONCRETE

+94
PE

+75
PE

+76
PE

+60
PE

+68
PE/MBTO

+08
FE

+31
MBTO

+31
PE

+61
CE

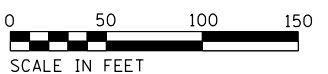

FILE NAME =	USER NAME = duncanbd	DESIGNED -	REVISED -
p:\1\1084EBIDINTEG.illinois.gov\PI\DOT\Documents\DOT Offices\District 3\Projects\0366050\B366050-shr-plan.dgn		CHECKED -	REVISED -
		DATE -	REVISED -

STATE OF ILLINOIS
DEPARTMENT OF TRANSPORTATION

PLAN VIEW

SCALE: 1:50 SHEET 2 OF 10 SHEETS STA. 1066+00 TO STA. 78+00

F.A.P. RTE.	SECTION	COUNTY	TOTAL SHEETS	SHEET NO.
623	(31,34)RS	LASALLE	29	17
CONTRACT NO. 66D50				
ILLINOIS FED. AID PROJECT				

MATCH LINE STA. 78+00

MATCH LINE STA. 93+00

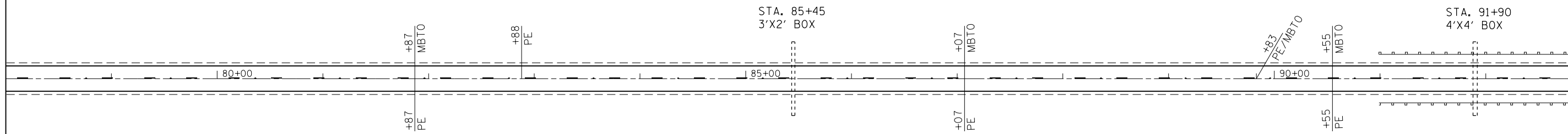

MATCH LINE STA. 93+00

MATCH LINE STA. 108+00

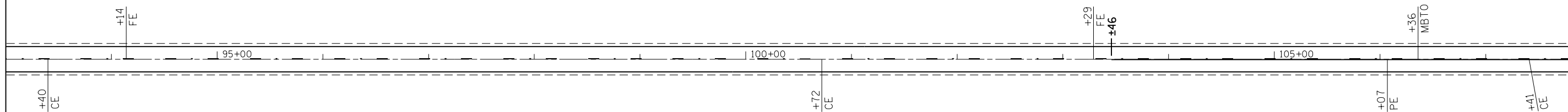

FILE NAME =	USER NAME = duncanbd	DESIGNED -	REVISED -
p:\11\084EBIDINTEG.illinois.gov\PIWIDOT\Documents\IDOT Offices\District 3\Projects\0366050\Drawings\B366050-sh1-plan.dgn		CHECKED -	REVISED -
		DATE -	REVISED -

STATE OF ILLINOIS
DEPARTMENT OF TRANSPORTATION

PLAN VIEW

SCALE: 1:50 SHEET 3 OF 10 SHEETS STA. 78+00 TO STA. 108+00

F.A.P. RTE.	SECTION	COUNTY	TOTAL SHEETS	SHEET NO.
623	(31,34)RS	LASALLE	29	18
CONTRACT NO. 66D50				
ILLINOIS FED. AID PROJECT				

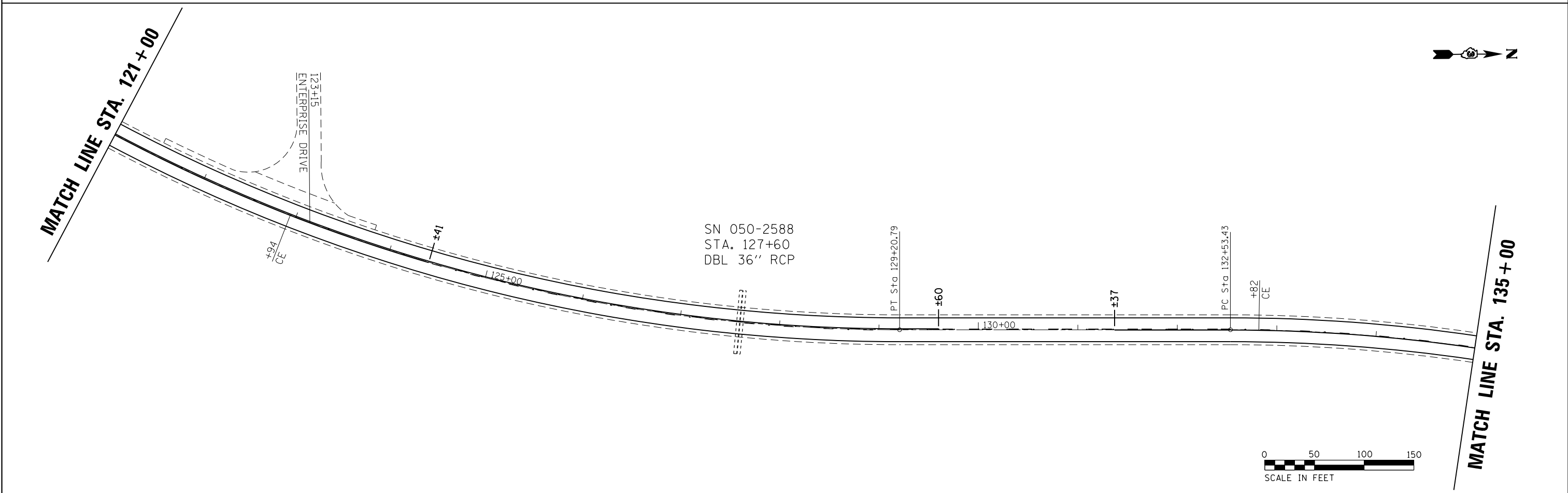
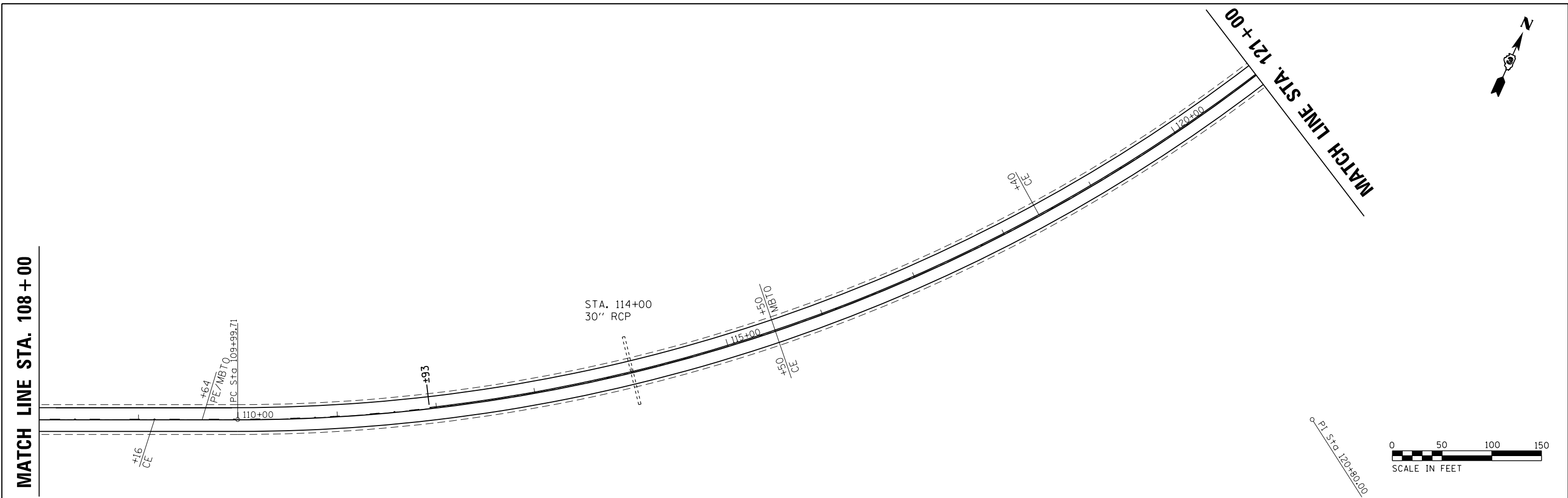

FILE NAME =	USER NAME = duncanbd	DESIGNED -	REVISED -	STATE OF ILLINOIS DEPARTMENT OF TRANSPORTATION	PLAN VIEW			F.A.P. RTE.	SECTION	COUNTY	TOTAL SHEETS	SHEET NO.
p:\11\084EBIDINTEG.illinois.gov\PI\DOT\Documents\DOT Offices\District 3\Projects\036620\DRAWING\B366050-shr-plan.dgn		CHECKED -	REVISED -		SCALE: 1:50	SHEET 4 OF 10 SHEETS	STA. 108+00 TO STA. 135+00	623	(31,34)RS	LASALLE	29	19
		DATE -	REVISED -		CONTRACT NO. 66D50							
					ILLINOIS FED. AID PROJECT							

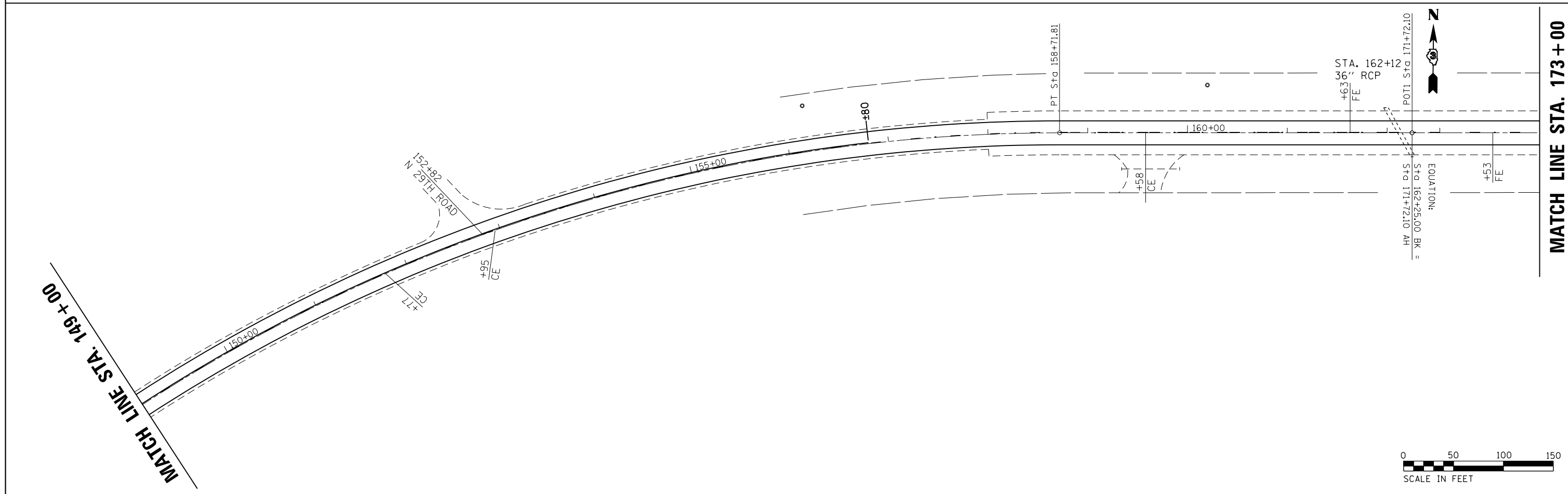
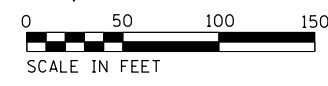
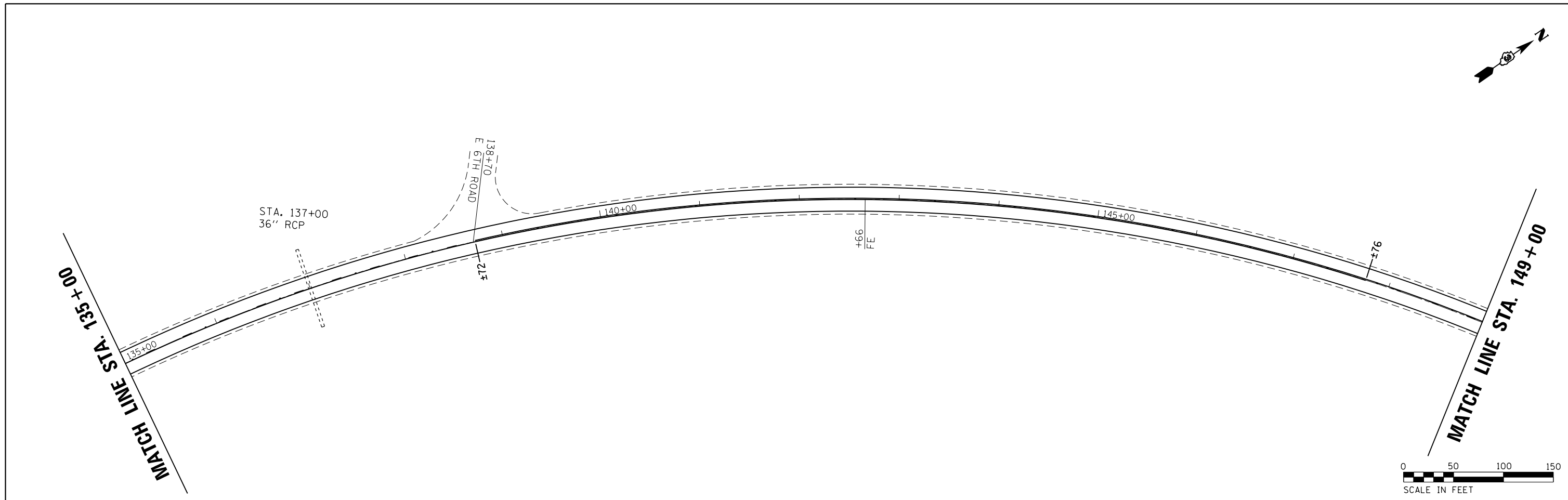

FILE NAME =	USER NAME = duncanbd	DESIGNED -	REVISED -	STATE OF ILLINOIS DEPARTMENT OF TRANSPORTATION	PLAN VIEW			F.A.P. RTE. =	SECTION	COUNTY	TOTAL SHEETS	SHEET NO.
p:\1\084EBIDINTEG.illinois.gov\PIDOT\Documents\DOT Offices\District 3\Projects\0366050\Drawings\B366050-sh1-plan.dgn		CHECKED -	REVISED -		SCALE: 1:50	SHEET 5 OF 10 SHEETS	STA. 135+00 TO STA. 173+00	623	(31,34)RS	LASALLE	29	20
		DATE -	REVISED -		CONTRACT NO. 66D50							
					ILLINOIS FED. AID PROJECT							

MATCH LINE STA. 173+00

SN 050-0115
STA. 176+40

APPROXIMATE LOCATION OF PROPOSED
PERMANENT SURVEY MARKER

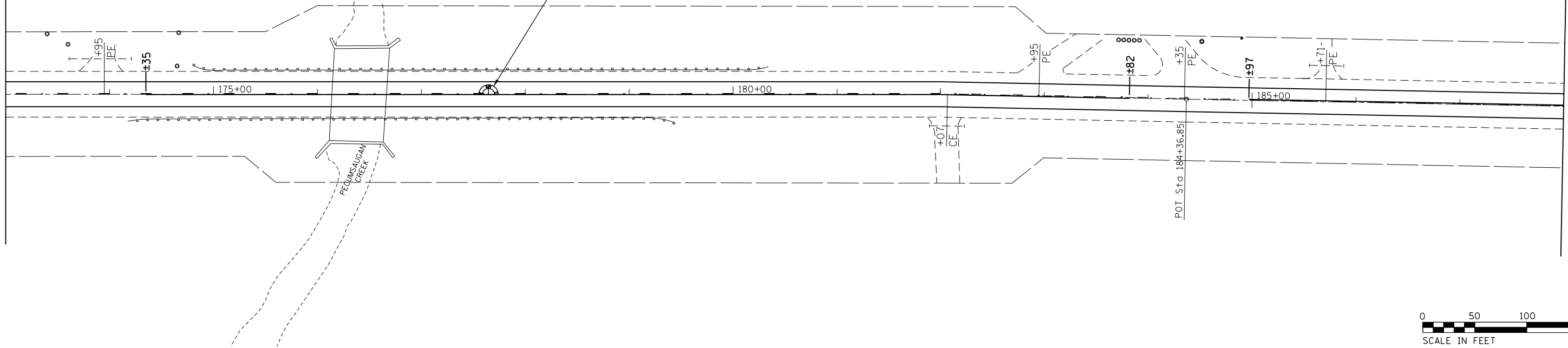

MATCH LINE STA. 188+00

MATCH LINE STA. 188+00

STA. 190+68
3'X2' BOX

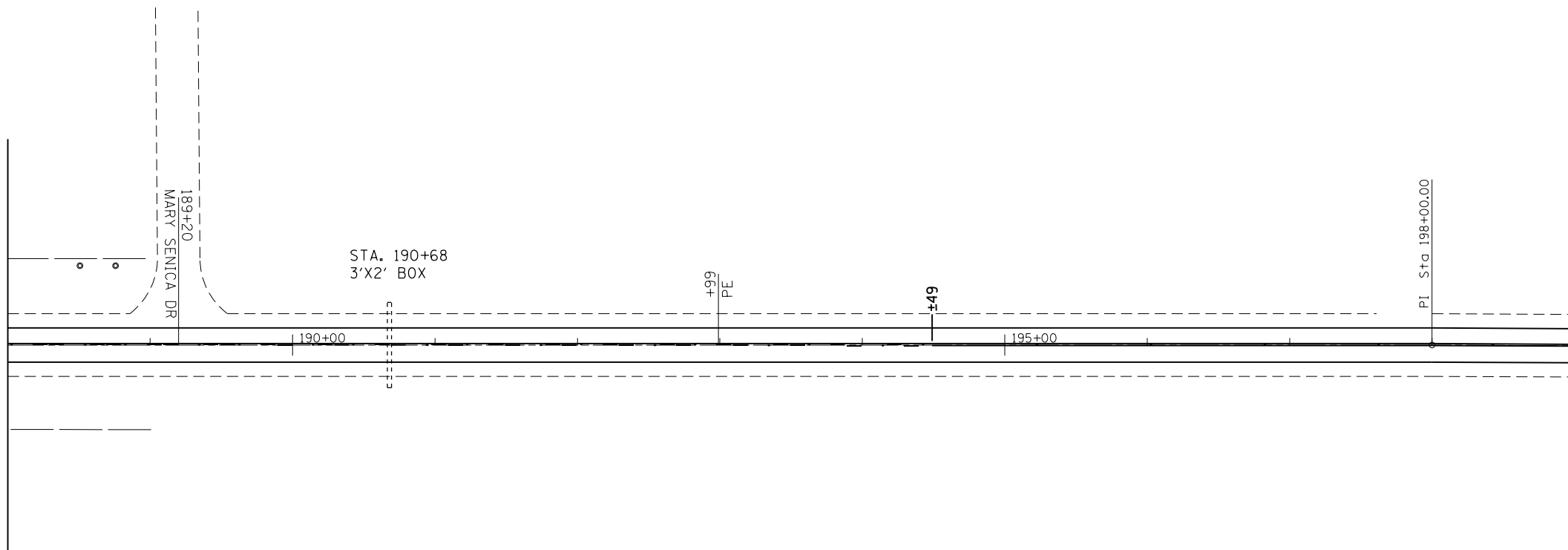

MATCH LINE STA. 199+00

FILE NAME =	USER NAME = duncanbd	DESIGNED -	REVISED -
p:\IL\084EBID\INTEG\illinois.gov\PI\DOT\Documents\DOT Offices\District 3\Projects\0366050\DRAWING\DOT Data\B366050-shr-plan.dgn		CHECKED -	REVISED -
		DATE -	REVISED -

STATE OF ILLINOIS
DEPARTMENT OF TRANSPORTATION

PLAN VIEW

SCALE: 1:50 SHEET 6 OF 10 SHEETS STA. 173+00 TO STA. 199+00

F.A.P. RTE.	SECTION	COUNTY	TOTAL SHEETS	SHEET NO.
623	(31,34)RS	LASALLE	29	21
CONTRACT NO. 66D50				
ILLINOIS FED. AID PROJECT				

MATCH LINE STA. 199+00

MATCH LINE STA. 209+00

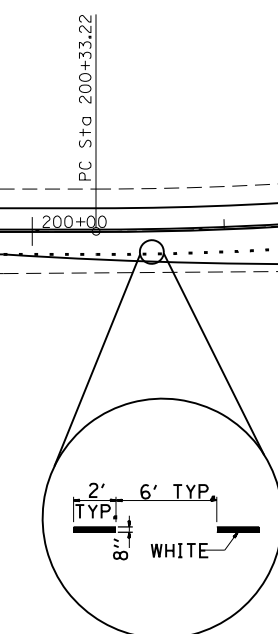

8" WHITE POLYUREA (TYP.)

STA. 210+20
36" RCP

203+88
E. 709TH RD.
204+05
CH 28



MATCH LINE STA. 209+00

MATCH LINE STA. 223+00

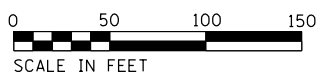

FILE NAME =	USER NAME = duncanbd	DESIGNED -	REVISED -
p:\1\084EBIDINTEG.illinois.gov\PIWIDOT\Documents\IDOT Offices\District 3\Projects\0366050\Drawings\B366050-shr-plan.dgn		CHECKED -	REVISED -
Default	PLOT SCALE = 100.0000' / in.	DATE -	REVISED -
	PLOT DATE = 3/16/2016		

**STATE OF ILLINOIS
DEPARTMENT OF TRANSPORTATION**

PLAN VIEW
SCALE: 1:50 SHEET 7 OF 10 SHEETS STA. 199+00 TO STA. 223+00

F.A.P. RTE.	SECTION	COUNTY	TOTAL SHEETS	SHEET NO.
623	(31,34)RS	LASALLE	29	22
CONTRACT NO. 66D50				
ILLINOIS FED. AID PROJECT				

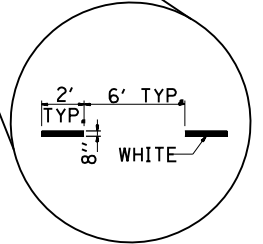
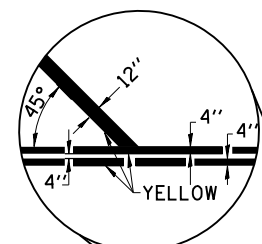

STA. 223+47
 SWITCH FROM POLYUREA PAVEMENT MARKING
 TO THERMOPLASTIC PAVEMENT MARKING

MATCH LINE STA. 236+50

MATCH LINE STA. 223+00

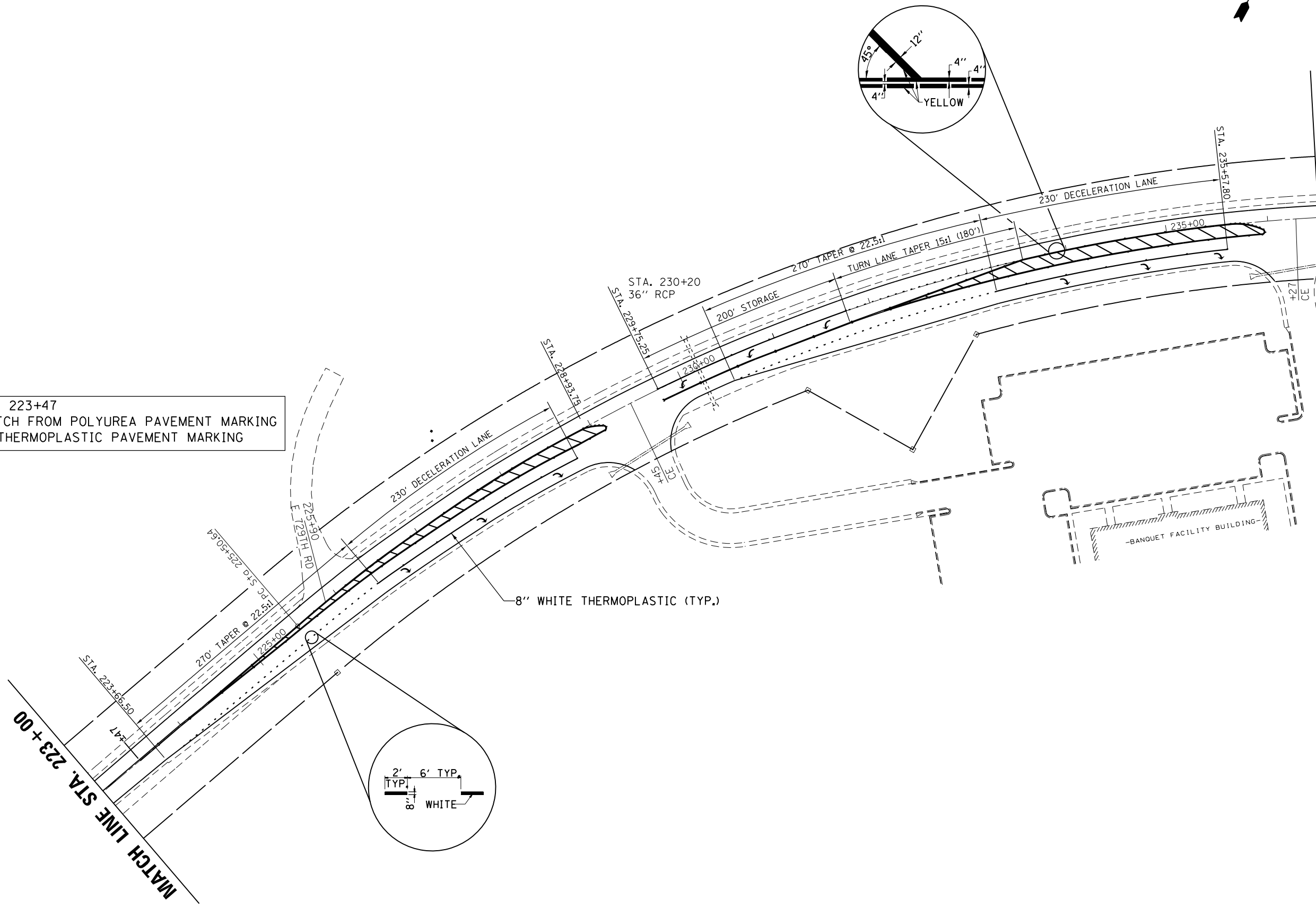

8" WHITE THERMOPLASTIC (TYP.)

**STATE OF ILLINOIS
 DEPARTMENT OF TRANSPORTATION**

PLAN VIEW

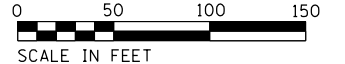

FILE NAME =	USER NAME = duncanbd	DESIGNED -	REVISED -	STATE OF ILLINOIS DEPARTMENT OF TRANSPORTATION	PLAN VIEW			F.A.P. RTE.	SECTION	COUNTY	TOTAL SHEETS	SHEET NO.
p:\11\084EBIDINTEG.illinois.gov\PI\DOT\Documents\DOT Offices\District 3\Projects\03660\Drawings\B366050-shr-plan.dgn	PLLOT SCALE = 100.0000' / in.	CHECKED -	REVISED -					623	(31,34)RS	LASALLE	29	23
Default	PLLOT DATE = 3/16/2016	DATE -	REVISED -		CONTRACT NO. 66D50			ILLINOIS FED. AID PROJECT				
					SCALE: 1:50	SHEET 8 OF 10 SHEETS	STA. 223+00 TO STA. 236+50					

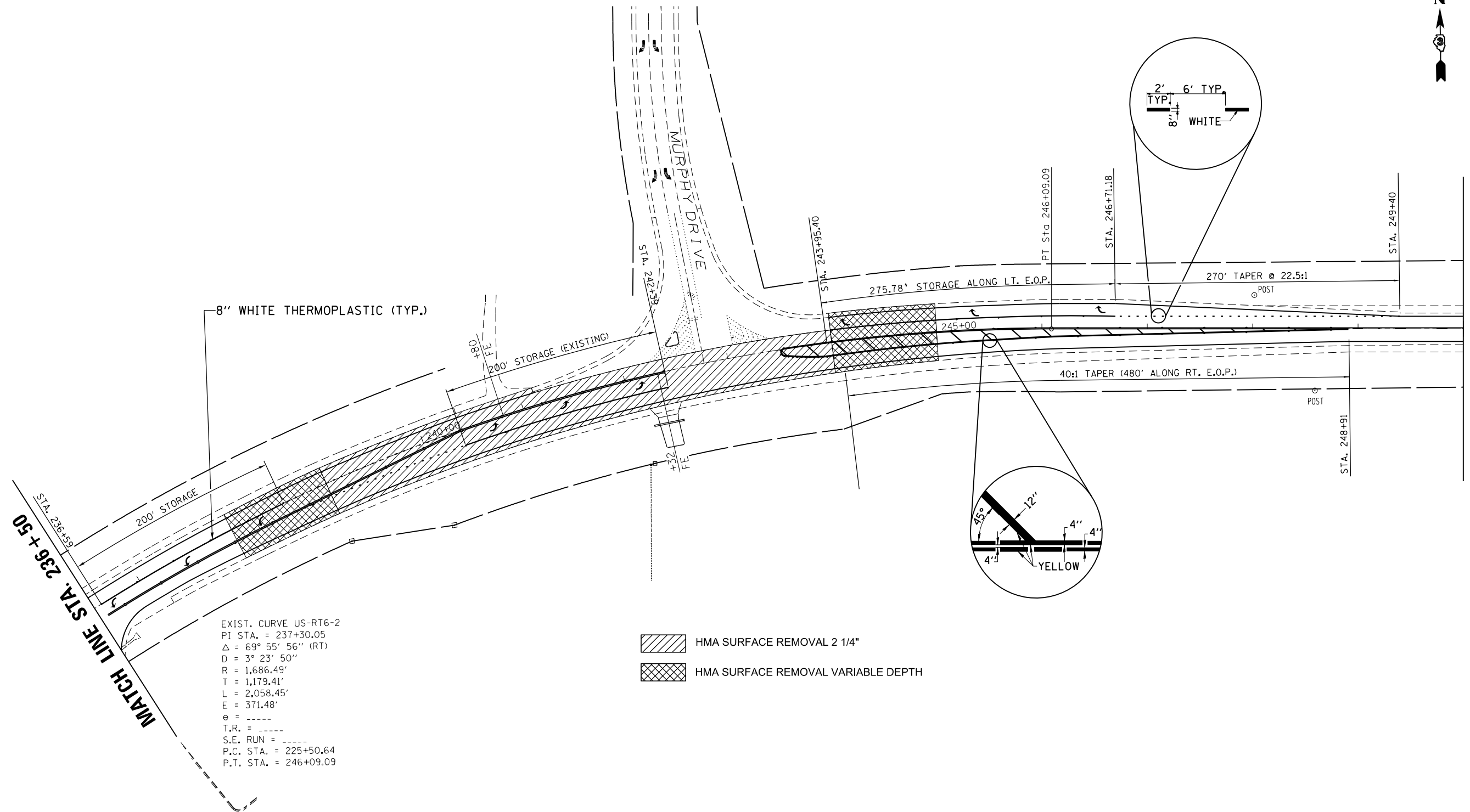

FILE NAME =	USER NAME = duncanbd	DESIGNED -	REVISED -
p:\11\084EBIDINTEG.illinois.gov\PIWIDOT\Documents\DOT Offices\District 3\Projects\0366050\Drawings\0366050-shr-plan.dgn		CHECKED -	REVISED -
Default	PLOT DATE = 3/16/2016	DATE -	REVISED -

**STATE OF ILLINOIS
DEPARTMENT OF TRANSPORTATION**

PLAN VIEW

SCALE: 1:50 SHEET 9 OF 10 SHEETS STA. 236+50 TO STA. 250+00

F.A.P. RTE.	SECTION	COUNTY	TOTAL SHEETS	SHEET NO.
623	(31,34)RS	LASALLE	29	24
CONTRACT NO. 66D50				
ILLINOIS FED. AID PROJECT				

MATCH LINE STA. 250 + 00

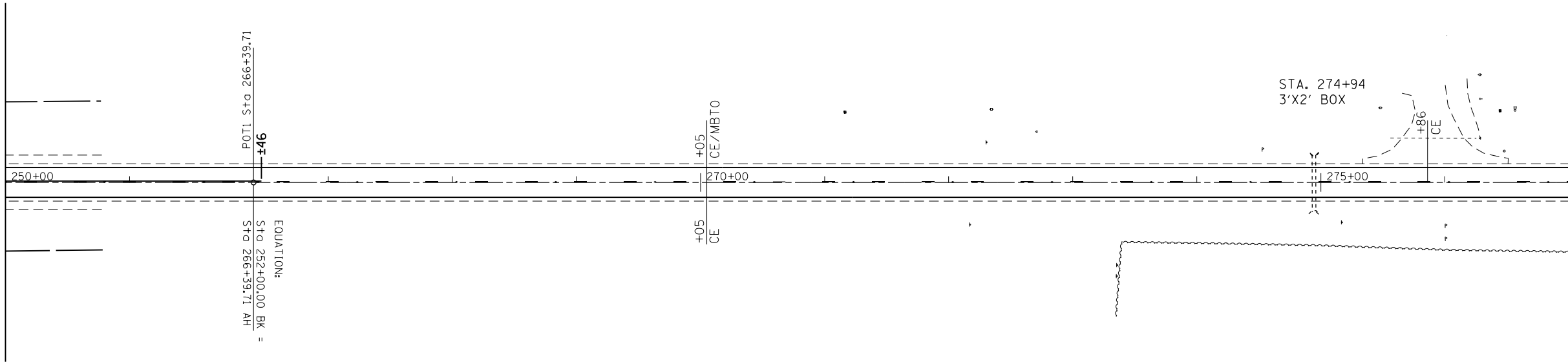

MATCH LINE STA. 277 + 00

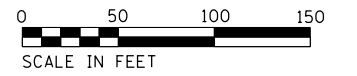

MATCH LINE STA. 277 + 00

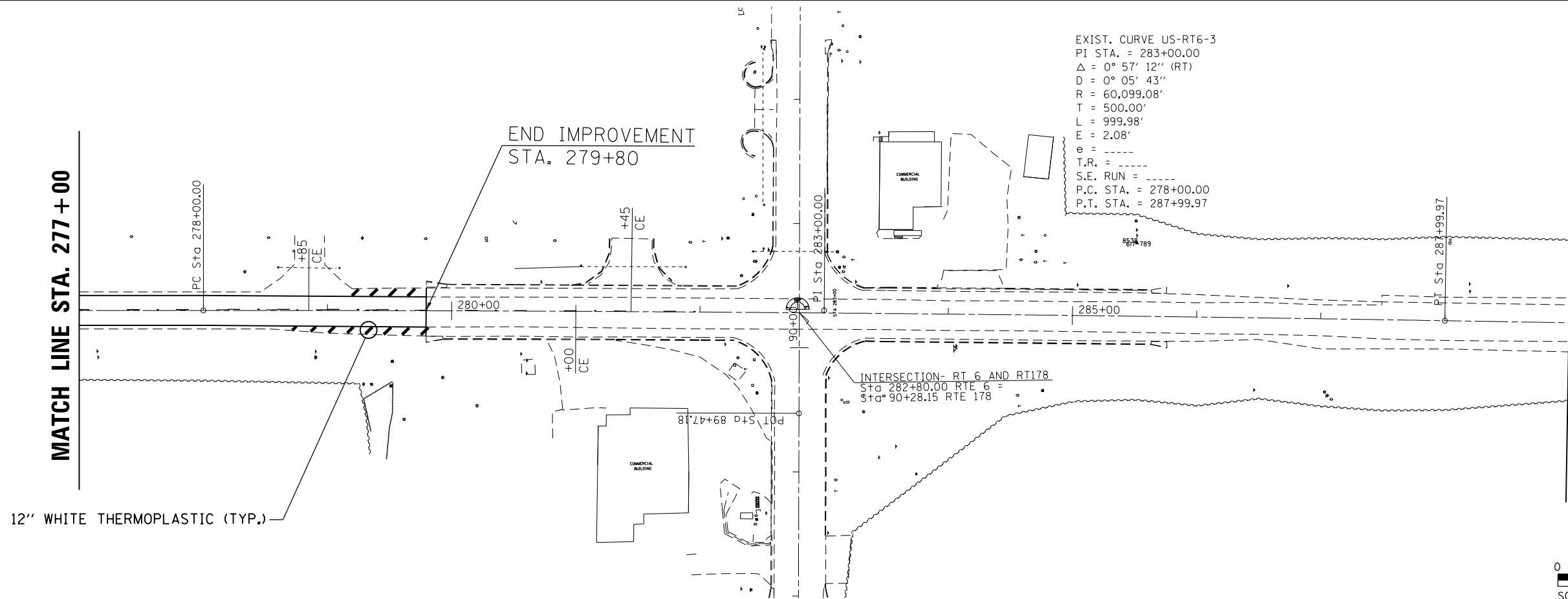

MATCH LINE STA. 289 + 00

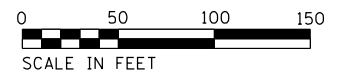

FILE NAME =	USER NAME = duncanbd	DESIGNED -	REVISED -
p:\1\084EBIDINTEG.illinois.gov\PI\DOT\Documents\DOT Offices\District 3\Projects\0366050\B366050-shr-plan.dgn		REVISED -	REVISED -
	PLOT SCALE = 100.0000' / in.	CHECKED -	REVISED -
	PLOT DATE = 3/16/2016	DATE -	REVISED -

STATE OF ILLINOIS
DEPARTMENT OF TRANSPORTATION

PLAN VIEW

SCALE: 1:50 SHEET 10 OF 10 SHEETS STA. 250+00 TO STA. 289+00

F.A.P. RTE.	SECTION	COUNTY	TOTAL SHEETS	SHEET NO.
623	(31,34)RS	LASALLE	29	25
CONTRACT NO. 66D50				
ILLINOIS FED. AID PROJECT				

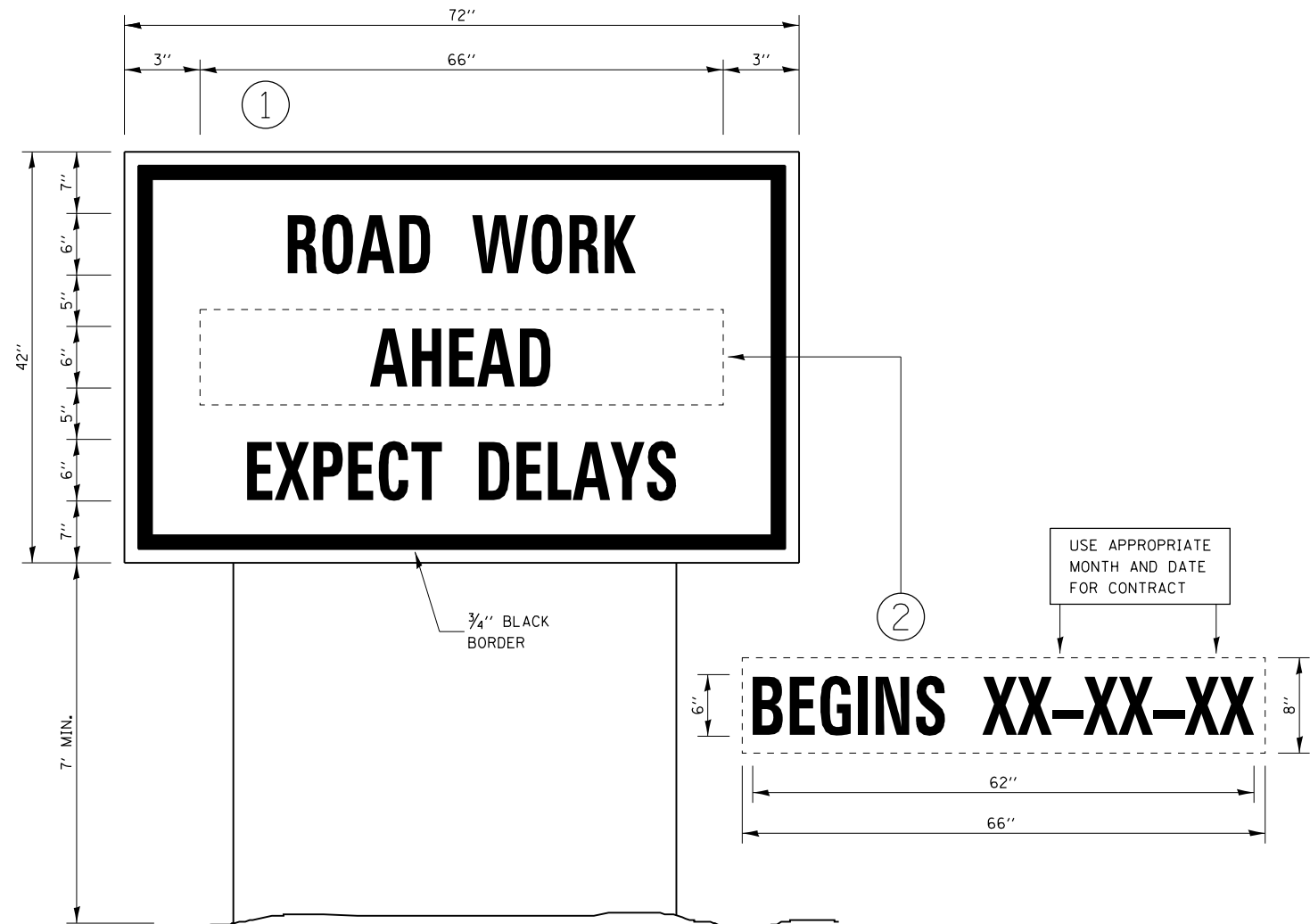

TEMPORARY INFORMATION SIGNING

NOTES:

1. USE 6" D BLACK LETTERING ON FLOURESENT ORANGE BACKGROUND.
2. ERECT SIGNS AT LOCATIONS IN ADVANCE OF THE "ROAD CONSTRUCTION AHEAD" SIGNS AS DIRECTED BY THE ENGINEER.
3. ERECT SIGN ① WITH INSTALLED PANEL ② A MINIMUM OF ONE WEEK PRIOR TO THE START OF THE LANE CLOSURE.
4. REMOVE PANEL ② ON THAT DATE.
5. SEE SPECIAL PROVISION "TEMPORARY INFORMATION SIGNING" FOR ADDITIONAL INFORMATION.
6. WILL BE PAID FOR PER SQ FT AS "TEMPORARY INFORMATION SIGNING". EACH SIGN = 21 SQ FT AND THE DATE PANEL ② WILL NOT BE MEASURED SEPARATELY FOR PAYMENT.

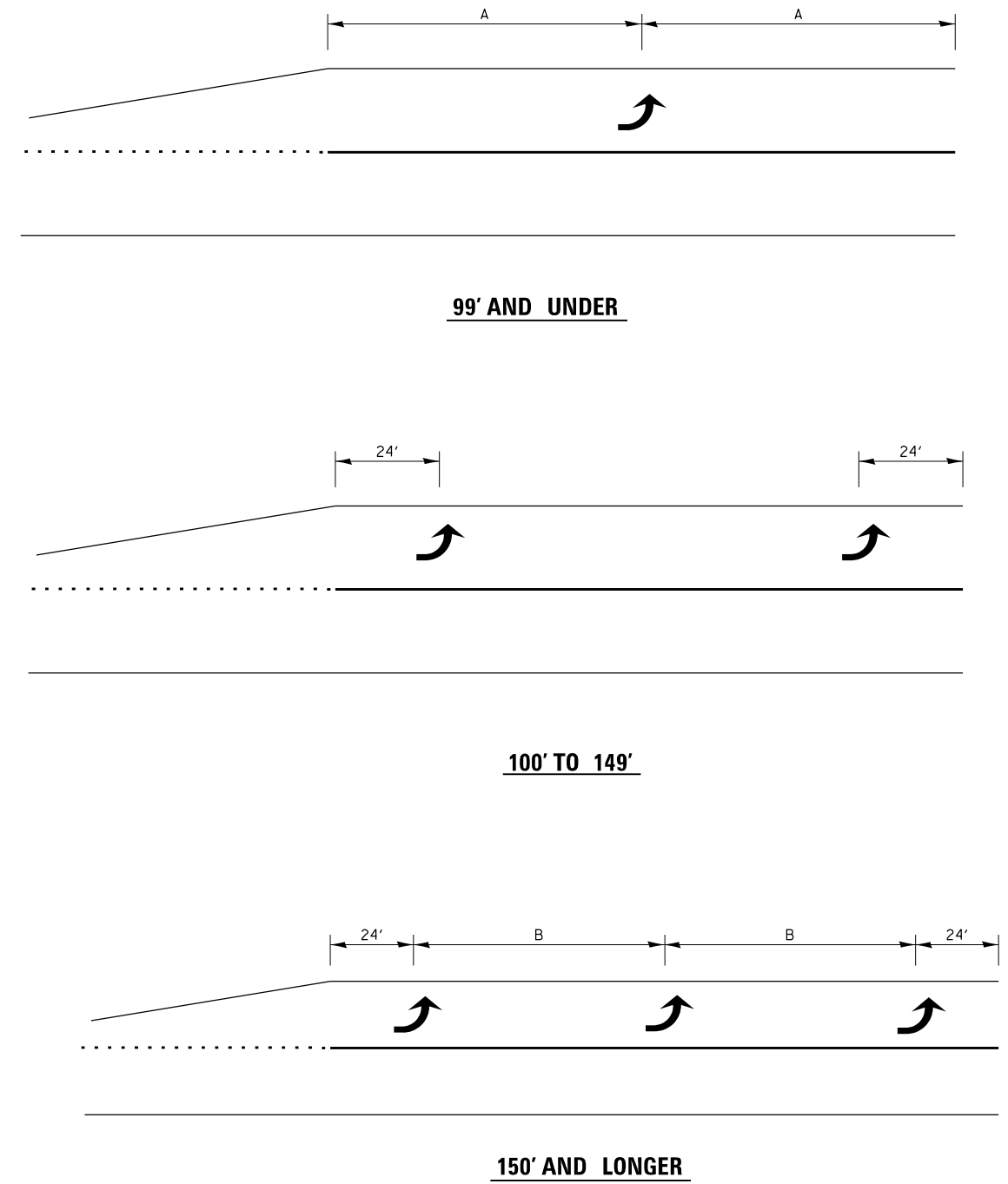

TYPICAL PLACEMENT OF ARROWS IN TURN LANES

FILE NAME =	USER NAME = duncanbd	DESIGNED -	REVISED -	STATE OF ILLINOIS DEPARTMENT OF TRANSPORTATION	DETAILS		F.A.P. RTE.	SECTION	COUNTY	TOTAL SHEETS	SHEET NO.	
p:\11\084EBIDINTEG.illinois.gov\PWIDOT\Documents\IDOT Offices\District 3\Projects\0366\DRAWING\B366050-shr-details.dgn		CHECKED -	REVISED -		SCALE:	SHEET NO. 1 OF 4 SHEETS	STA.	TO STA.	623	(31,34)RS	LASALLE	29 26
		PLOT SCALE = 100.0000' / in.	REVISED -					CONTRACT NO. 66D50				
		PLOT DATE = 3/16/2016	REVISED -		ILLINOIS FED. AID PROJECT							

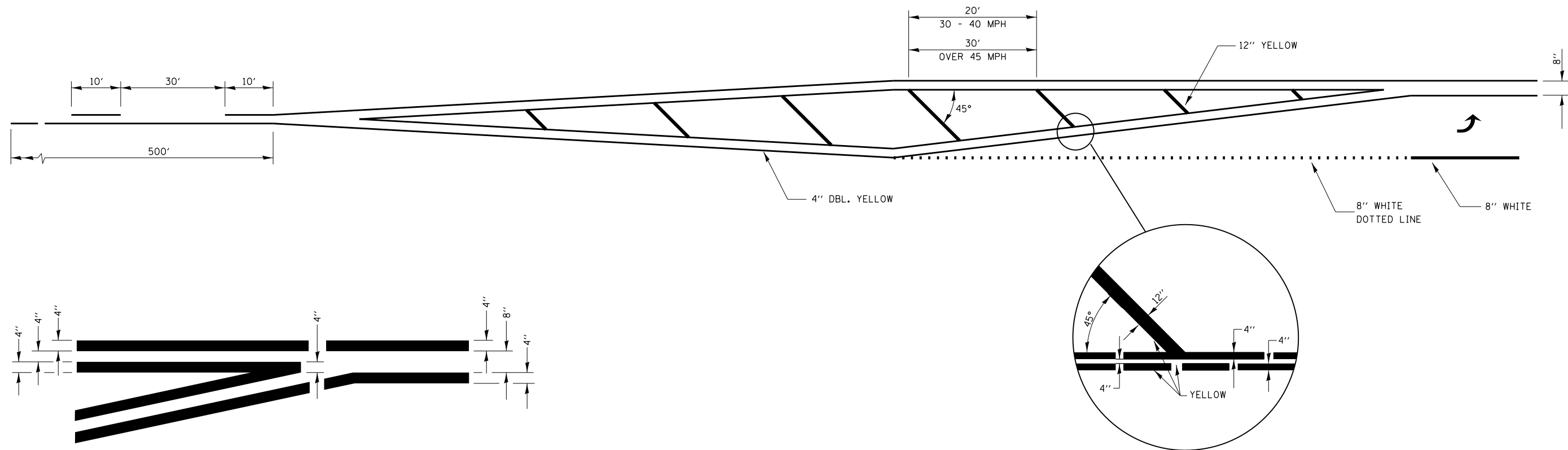

**LEFT TURN LANE
TYPICAL APPLICATION**

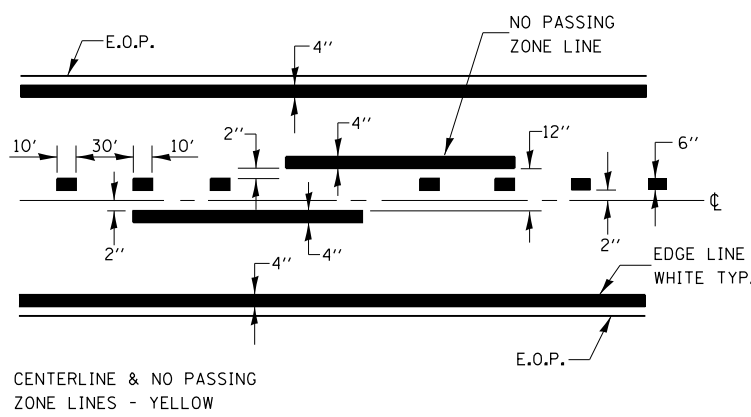

PAVEMENT MARKING

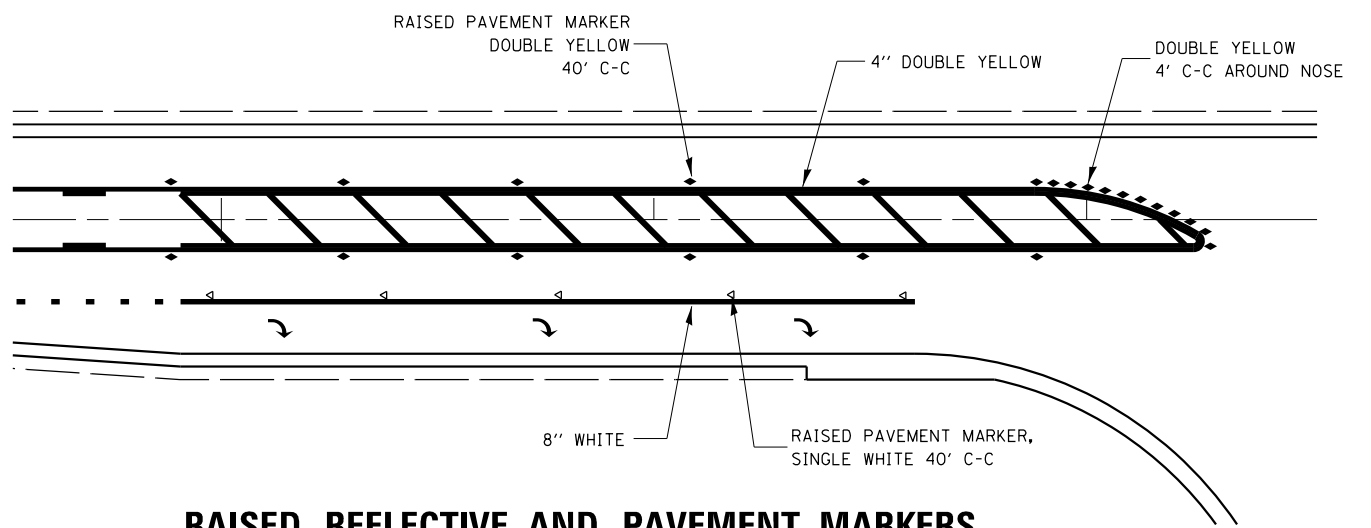

**RAISED REFLECTIVE AND PAVEMENT MARKERS
RIGHT TURN LANE**

FILE NAME =	USER NAME = duncanbd	DESIGNED -	REVISED -
p:\1\084EBIDINTEG.illinois.gov\PIWIDOT\Documents\IDOT Offices\District 3\Projects\0366050\B366050-shd-details.dgn		DRAWN	REVISED -
	PLOT SCALE = 100.0000' / in.	CHECKED -	REVISED -
	PLOT DATE = 3/16/2016	DATE -	REVISED -

**STATE OF ILLINOIS
DEPARTMENT OF TRANSPORTATION**

DETAILS			
SCALE:	SHEET NO. 2 OF 4 SHEETS	STA.	TO STA.

F.A.P. RTE.	SECTION	COUNTY	TOTAL SHEETS	SHEET NO.
623	(31,34)RS	LASALLE	29	27
CONTRACT NO. 66D50				
ILLINOIS FED. AID PROJECT				

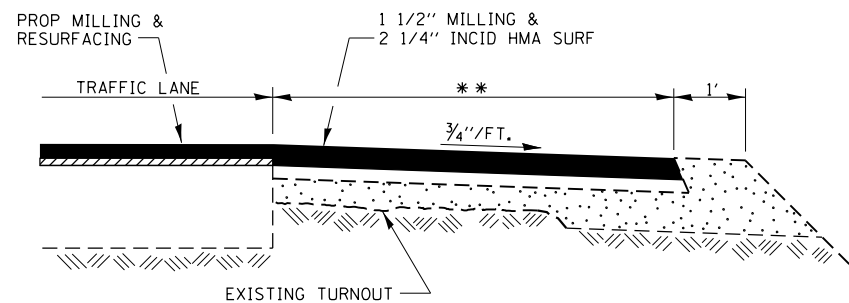
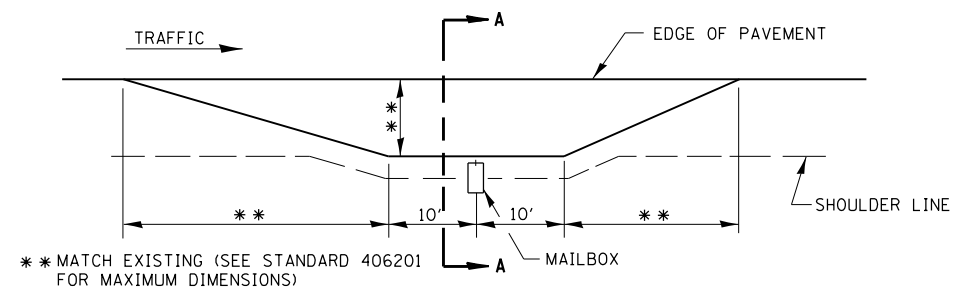

SECTION A-A
RURAL MAILBOX TURNOUT DETAILS

THE COST OF REMOVAL AT EXISTING HMA OR PCC LOCATIONS SHALL BE PAID FOR PER SQ YD BY THE APPROPRIATE PAY ITEM. REMOVAL AT THE EXISTING AGG LOCATIONS SHALL BE INCIDENTAL TO THE HMA.

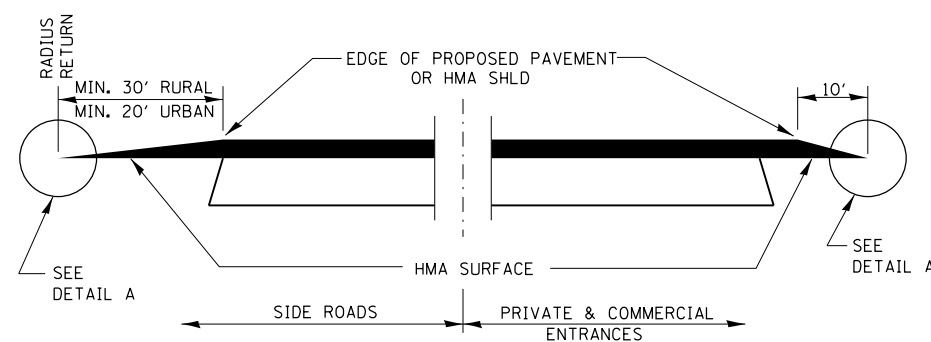

SECTION A-A
DETAILS AT ENTRANCES & SIDE ROADS

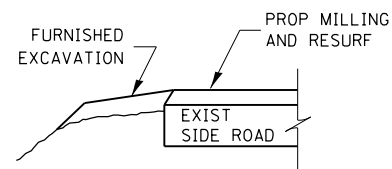

SECTION B-B

THE COST OF REMOVAL AT EXISTING HMA OR PCC LOCATIONS SHALL BE PAID FOR PER SQ YD BY THE APPROPRIATE PAY ITEM. REMOVAL AT THE EXISTING AGG LOCATIONS SHALL BE INCIDENTAL TO THE HMA. A-3 LOCATIONS SHALL BE FEATHER TAPERED.

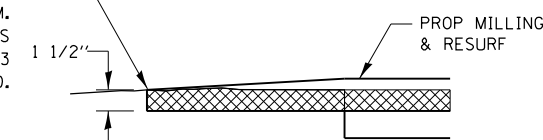

DETAIL A

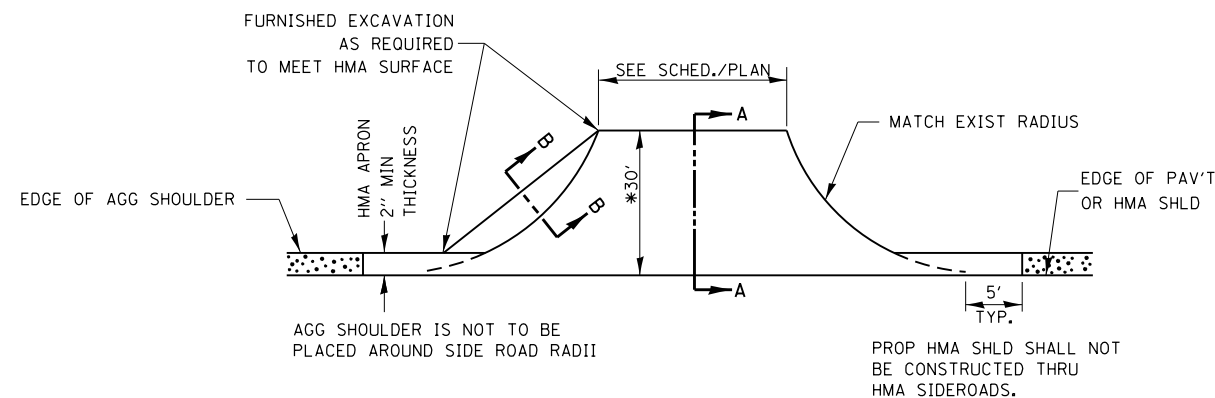

PLAN AT SIDE ROADS
*OR AS DIRECTED BY THE ENGINEER

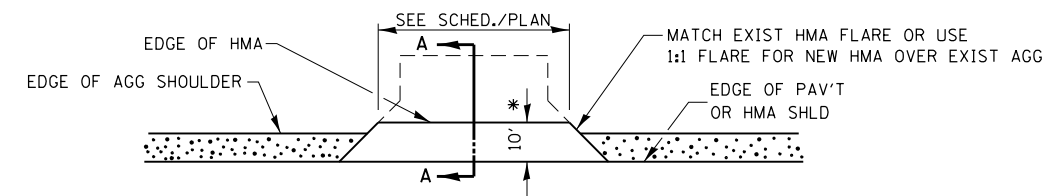

PLAN AT PRIVATE & COMMERCIAL ENTRANCES
(DO NOT RESURFACE FIELD ENTRANCES)
*OR AS DIRECTED BY THE ENGINEER

FILE NAME =	USER NAME = duncanbd	DESIGNED -	REVISED -
p:\11\084EBIDINTEG.illinois.gov\PI\DOT\Documents\DOT Offices\District 3\Projects\0366050\B366050-shd-details.dgn		CHECKED -	REVISED -
		DATE -	REVISED -

STATE OF ILLINOIS
DEPARTMENT OF TRANSPORTATION

DETAILS

SCALE: SHEET NO. 3 OF 4 SHEETS STA. TO STA.

F.A.P. RTE.	SECTION	COUNTY	TOTAL SHEETS	SHEET NO.
623	(31,34)RS	LASALLE	29	28
CONTRACT NO. 66D50				
ILLINOIS FED. AID PROJECT				

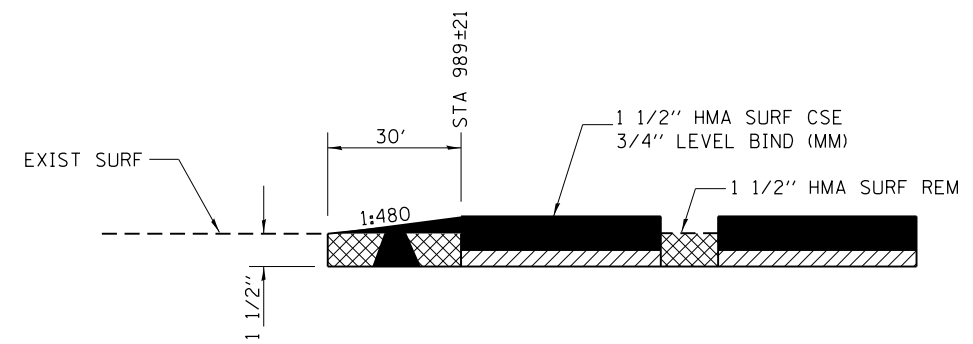

HMA SURF CSE BEGINNING & ENDING TAPER DETAIL

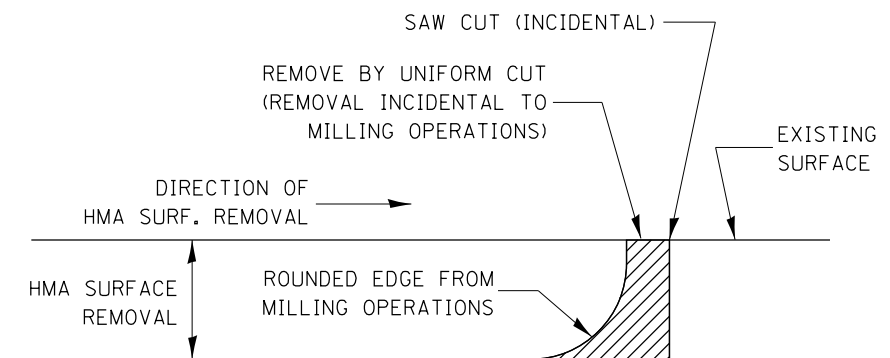

NOTE:
 WHEN MILLING OPERATIONS PRODUCE A ROUNDED EDGE,
 THEN A SAW CUT SHALL BE USED TO MANUFACTURE
 A PERPENDICULAR EDGE AS SHOWN IN THE DETAIL.
 THE ENGINEER SHALL BE THE SOLE JUDGE
 CONCERNING THE USE OF THIS DETAIL

HMA DETAIL AT BUTT JOINTS

FILE NAME =	USER NAME = duncanbd	DESIGNED -	REVISED -	STATE OF ILLINOIS DEPARTMENT OF TRANSPORTATION	DETAILS		F.A.P. RTE.	SECTION	COUNTY	TOTAL SHEETS	SHEET NO.	
p:\11\084EBIDINTEG.illinois.gov\PIWIDOT\Documents\IDOT Offices\District 3\Projects\0366050\Drawings\0366050-shd-details.dgn		CHECKED -	REVISED -		SCALE:	SHEET NO. 4 OF 4 SHEETS	STA.	623	(31,34)RS	LASALLE	29	29
		PLOT SCALE = 100.0000' / in.	REVISED -				TO STA.	CONTRACT NO. 66D50		ILLINOIS FED. AID PROJECT		
		PLOT DATE = 3/16/2016	REVISED -									