

DEPARTMENT OF TRANSPORTATION

DIVISION OF HIGHWAYS

**PROPOSED
HIGHWAY PLANS**

F.A.I. ROUTE 80 (I-80)

SECTION (32,47-4)RA-3

PAVEMENT PATCHING AND CURB RAMP (ADA) REPAIRS

GRUNDY COUNTY

C-93-040-16

F.A.I. RTE.	SECTION	COUNTY	TOTAL SHEETS	SHEET NO.
80	(32,47-4)RA-3	GRUNDY	7	1
		ILLINOIS	CONTRACT NO. 66F28	

1. COVER SHEET
2. GENERAL NOTES
3. SUMMARY OF QUANTITIES
4. TYPICALS
5. SCHEDULES
6. WESTBOUND THREE RIVERS REST AREA - SITE PLAN
7. CLASS B PATCHING DETAILS

STANDARDS

- 000001-06 STANDARD SYMBOLS, ABBREVIATIONS AND PATTERNS
- 001001-02 AREAS OF REINFORCEMENT BARS
- 001006 DECIMAL OF AN INCH AND OF A FOOT
- 420701-03 PAVEMENT WELDED WIRE REINFORCEMENT
- 424001-08 PERPENDICULAR CURB RAMPS FOR SIDEWALKS
- 424006-02 DIAGONAL CURB RAMPS FOR SIDEWALKS
- 424011-02 CORNER PARALLEL CURB RAMPS FOR SIDEWALKS
- 424016-02 MID-BLOCK CURB RAMPS FOR SIDEWALKS
- 424021-03 DEPRESSED CORNER FOR SIDEWALKS
- 606001-06 CONCRETE CURB TYPE B AND COMBINATION CONCRETE CURB AND GUTTER
- 701006-05 OFF-ROAD OPERATIONS 2L, 2W, 15' (4.5 m) TO 24" (600 mm) FROM PAVEMENT EDGE
- 701101-05 OFF-ROAD OPERATIONS, MULTILANE, 15' (4.5 m) TO 24" (600 mm) FROM PAVEMENT EDGE
- 701201-04 LANE CLOSURE, 2L, 2W, DAY ONLY, FOR SPEEDS ≤ 45 MPH
- 701301-04 LANE CLOSURE, 2L, 2W, SHORT TIME OPERATIONS
- 701801-06 SIDEWALK, CORNER OR CROSSWALK CLOSURE
- 701901-05 TRAFFIC CONTROL DEVICES
- 701451-03 RAMP CLOSURE FREEWAY/EXPRESSWAY

PROJECT LOCATION

WESTBOUND THREE RIVERS REST AREA
APPROXIMATELY 3.32 MILES WEST
OF MINOOKA.

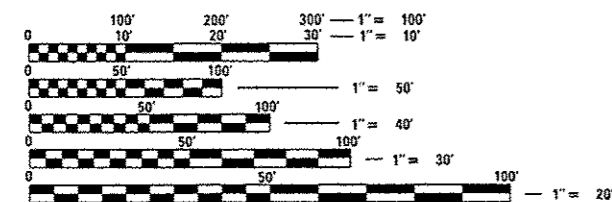
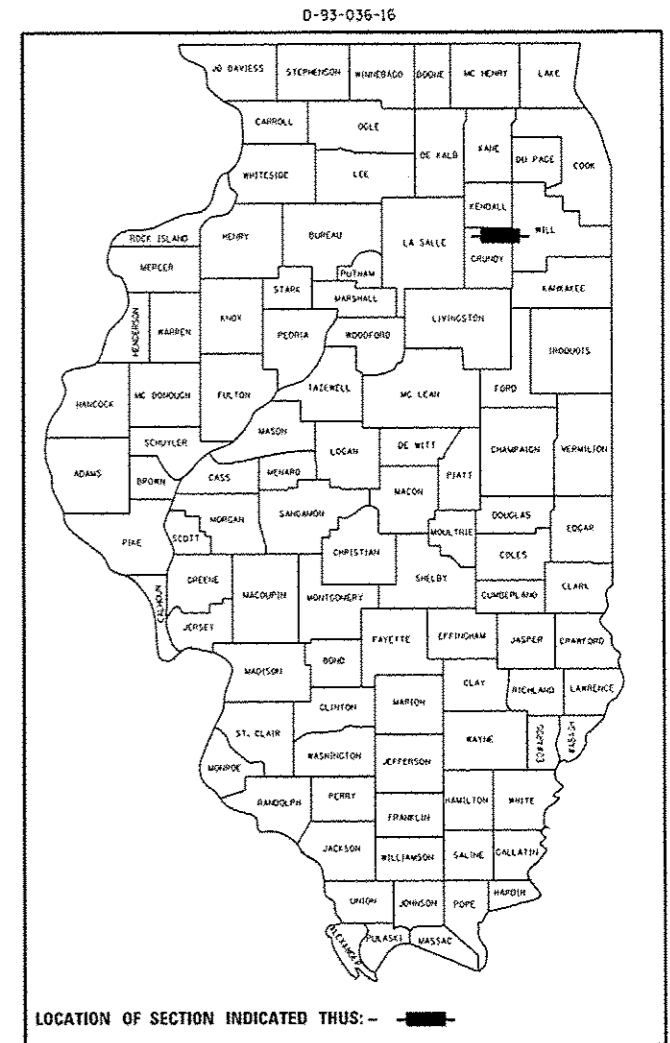

FULL SIZE PLANS HAVE BEEN PREPARED USING STANDARD ENGINEERING SCALES. REDUCED SIZED PLANS WILL NOT CONFORM TO STANDARD SCALES. IN MAKING MEASUREMENTS ON REDUCED PLANS, THE ABOVE SCALES MAY BE USED.

J.U.L.I.E.
JOINT UTILITY LOCATION INFORMATION FOR EXCAVATION
1-800-892-0123
OR 811

PROJECT ENGINEER: JOE KANNEL P.E.
UNIT CHIEF: RON WOODSHANK

CONTRACT NO. 66F28

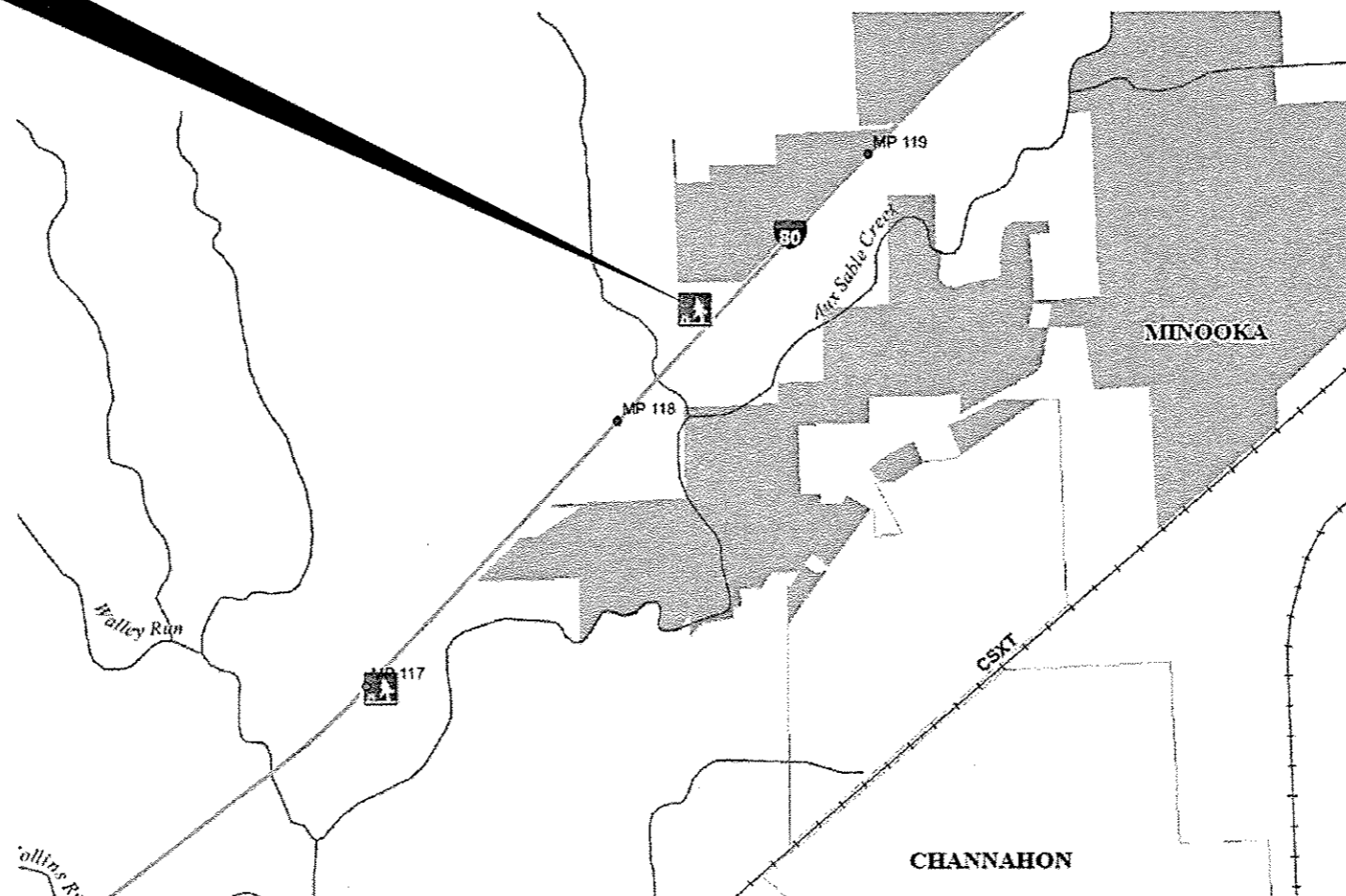

RURAL INTERSTATE
FAI 80 (I-80)
WB REST AREA
2015

ADT	1250
P. V.	64.40%
S. U.	5.60%
M. U.	30.00%

STATE OF ILLINOIS
DEPARTMENT OF TRANSPORTATION
DIVISION OF HIGHWAYS

SUBMITTED March 24 2016
Paul Loette, P.E.
REGIONAL ENGINEER

May 6 2016
Maureen M. Addis, P.E.
ENGINEER OF DESIGN AND ENVIRONMENT

May 6 2016
Cher C. Sample, P.E.
DIRECTOR OF HIGHWAYS, CHIEF ENGINEER

PRINTED BY THE AUTHORITY
OF THE STATE OF ILLINOIS

GENERAL NOTES

PLAN DIMENSIONS AND DETAILS RELATIVE TO EXISTING PLANS ARE SUBJECT TO NOMINAL CONSTRUCTION VARIATIONS. THE CONTRACTOR SHALL FIELD VERIFY EXISTING DIMENSIONS AND DETAILS AFFECTING NEW CONSTRUCTION AND MAKE NECESSARY APPROVED ADJUSTMENTS PRIOR TO CONSTRUCTION OR ORDERING OF MATERIALS. SUCH VARIATIONS SHALL NOT BE CAUSE FOR ADDITIONAL COMPENSATION FOR A CHANGE IN SCOPE OF WORK; HOWEVER, THE CONTRACTOR WILL BE PAID FOR THE QUANTITY ACTUALLY FURNISHED AT THE UNIT PRICE BID FOR THE WORK.

FOR STABILIZATION, ALL TYPE III BARRICADES WILL REQUIRE A MINIMUM OF FOUR SAND BAGS PER BARRICADE.

ALL EXCAVATED MATERIAL, WHICH INCLUDES DIGGING OR GRADING OF ANY SOIL OR FILL MATERIAL, WITH THE EXCEPTION OF AGGREGATE FILLS, MUST BE INCORPORATED WITHIN THE IDOT RIGHT OF WAY DUE TO ENVIRONMENTAL DOCUMENTATION REQUIREMENTS.

SHORT TERM PAVEMENT MARKING SHALL BE USED TO OUTLINE EXIT AND ENTRANCE RAMPS FOR THE PRIME COAT APPLICATION AND EACH RESURFACING LIFT.

DETECTABLE WARNING SURFACES SHALL EXTEND 2.0 FT MINIMUM IN THE DIRECTION OF PEDESTRIAN TRAVEL. AT CURB RAMPS AND BLENDED TRANSITIONS, DETECTABLE WARNING SURFACES SHALL EXTEND THE FULL WIDTH OF THE RAMP RUN (EXCLUDING ANY FLARES) OR BLENDED TRANSITIONS. SOME DETECTABLE WARNING PRODUCTS REQUIRE A CONCRETE BORDER FOR PROPER INSTALLATION. THE CONCRETE BORDER SHALL NOT EXCEED 2 INCHES.

ABANDONED UNDERGROUND UTILITIES THAT CONFLICT WITH CONSTRUCTION SHALL BE DISPOSED OF OUTSIDE THE LIMITS OF THE RIGHT OF WAY ACCORDING TO ARTICLE 202.03 OF THE STANDARD SPECIFICATIONS AND AS DIRECTED BY THE ENGINEER. THIS WORK WILL NOT BE PAID FOR SEPARATELY, BUT WILL BE INCLUDED IN THE COST OF EARTH EXCAVATION.

ANY REFERENCE TO A STANDARD IN THESE PLANS SHALL BE INTERPRETED TO MEAN THE EDITION AS INDICATED BY THE SUBNUMBER SHOWN IN THE LIST OF STANDARDS OR THE COPY INCLUDED IN THESE PLANS.

THE CONTRACTOR'S ATTENTION IS DIRECTED TO THE PRESENCE OF DEPARTMENT-OWNED UNDERGROUND ELECTRICAL CABLE WITHIN THE LIMITS OF THE PROPOSED IMPROVEMENT. THE CONTRACTOR SHALL REQUEST THE ILLINOIS DEPARTMENT OF TRANSPORTATION IN OTTAWA (815-434-8417) TO LOCATE THE UNDERGROUND FACILITIES, PROVIDING A MINIMUM OF 72 HOURS NOTICE. THE DEPARTMENT IS NOT A MEMBER OF THE JOINT UTILITY LOCATING INFORMATION FOR EXCAVATORS (JULIE) SYSTEM.

ALL DAMAGE TO DEPARTMENT OWNED UNDERGROUND FACILITIES, CAUSED BY THE CONTRACTOR SHALL BE REPAIRED TO THE SATISFACTION OF THE DEPARTMENT AT THE CONTRACTOR'S EXPENSE. THIS SHALL INCLUDE ALL TEMPORARY REPAIRS REQUIRED TO KEEP THE FACILITY OPERATIONAL WHILE MATERIAL IS BEING OBTAINED TO MAKE PERMANENT REPAIRS. SPLICING OF ELECTRIC CABLE WILL NOT BE ALLOWED. ELECTRIC CABLE SHALL BE REPLACED FROM POLE TO POLE OR CONTROLLER.

THE CONTRACTOR SHALL CONTACT JULIE AT LEAST 48 HOURS PRIOR TO EXCAVATION TO DETERMINE WHICH UTILITIES ARE IN THE AREA.

COMMITMENTS

STATE OF ILLINOIS
DEPARTMENT OF TRANSPORTATION
DISTRICT THREE
AS BUILT INFORMATION

SUPERVISING CONSTRUCTION FIELD ENGINEER

RESIDENT ENGINEER / TECHNICIAN

START & END DATES
OF CONSTRUCTION:

INSPECTORS:

DATE:

March 24, 2016

PREPARED BY:

D. Beoni

DISTRICT STUDIES & PLANS ENGINEER

EXAMINED BY:

[Signature]

DISTRICT CONSTRUCTION ENGINEER

[Signature]

DISTRICT MATERIALS ENGINEER

[Signature]

DISTRICT OPERATIONS ENGINEER

STATE OF ILLINOIS
DEPARTMENT OF TRANSPORTATION

GENERAL NOTES

FILE NAME :	USER NAME :	DESIGNED -	REVISED -	STATE OF ILLINOIS DEPARTMENT OF TRANSPORTATION	GENERAL NOTES	F.A.I. RTE.	SECTION	COUNTY	TOTAL SHEETS	SHEET NO.	
p:\11084EBIDINTEC\Illinois.gov\PWIDOT\Documents\IDOT Offices\District 3\Projects\0366F	woodharkel	DRAWN	REVISED			80	132.47-4RA-3	GRUNDY	7	2	
		CHECKED -	REVISED -			CONTRACT NO. 66F28					
		DATE -	REVISED -			ILLINOIS FED. AID PROJECT					
Default				SCALE:	SHEET 1 OF 1 SHEETS	STA.	TO STA.				

CODE NO.	ITEM	UNIT	TOTAL QUANTITY	CONSTR. CODE
				RARR
				100% STATE
				ROADWAY
				0021
				RURAL
20200100	EARTH EXCAVATION	CU YD	20	20
42400300	PORTLAND CEMENT CONCRETE SIDEWALK 6 INCH	SQ FT	3131	3131
42400800	DETECTABLE WARNINGS	SQ FT	40	40
44000500	COMBINATION CURB AND GUTTER REMOVAL	FOOT	127	127
44000600	SIDEWALK REMOVAL	SQ FT	3131	3131
44200050	WELDED WIRE REINFORCEMENT	SQ YD	320	320
44200982	CLASS B PATCHES, TYPE II, 11 INCH	SQ YD	10	10
44200988	CLASS B PATCHES, TYPE IV, 11 INCH	SQ YD	320	320
44201299	DOWEL BARS 1 1/2"	EACH	104	104
44213200	SAW CUTS	FOOT	631	631
60607400	COMBINATION CONCRETE CURB AND GUTTER, TYPE B-9.24	FOOT	127	127
67100100	MOBILIZATION	LSUM	1	1
70100820	TRAFFIC CONTROL AND PROTECTION, STANDARD 701451	LSUM	1	1
70106800	CHANGEABLE MESSAGE SIGN	CAL MO	0.5	0.5

14

FILE NAME :	USER NAME :	DESIGNED :	REVISED :	STATE OF ILLINOIS DEPARTMENT OF TRANSPORTATION	SUMMARY OF QUANTITIES	F.A.I. RTE.	SECTION	COUNTY	TOTAL SHEETS	SHEET NO.	
p:\11084EBID\INTEG\Illinois.gov\PW100T\Do	Documents\100T Offices\District 3\Projects\036	DRAWN	REVISED			80	132-47-41RA-3	GRUNDY	7	3	
Default	PLOT SCALE = 100.0000 1/2 in.	CHECKED	REVISED			CONTRACT NO. 66F28		ILLINOIS FED. AID PROJECT			
	PLOT DATE = 3/23/2016	DATE	REVISED			SCALE:	SHEET 1 OF 1 SHEETS	STA.	TO STA.		

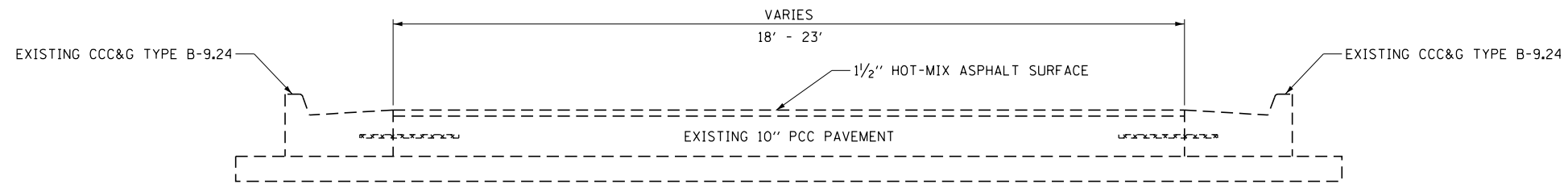

TYPICAL SECTION 1
CAR LOT DRIVE LANE

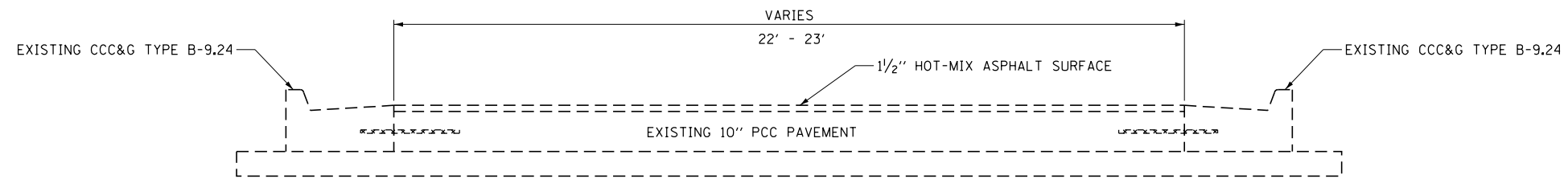

TYPICAL SECTION 2
CAR LOT DRIVE LANE

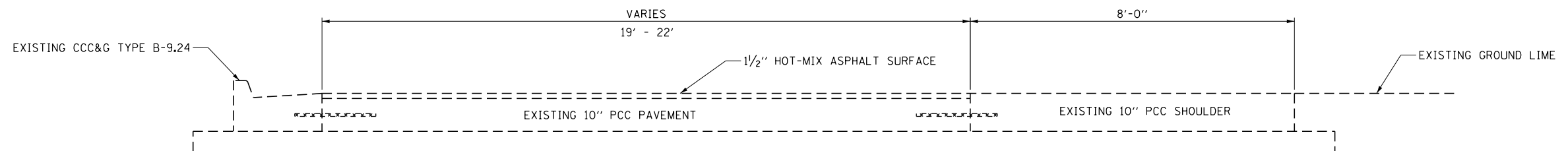

TYPICAL SECTION 3
CAR LOT DRIVE LANE

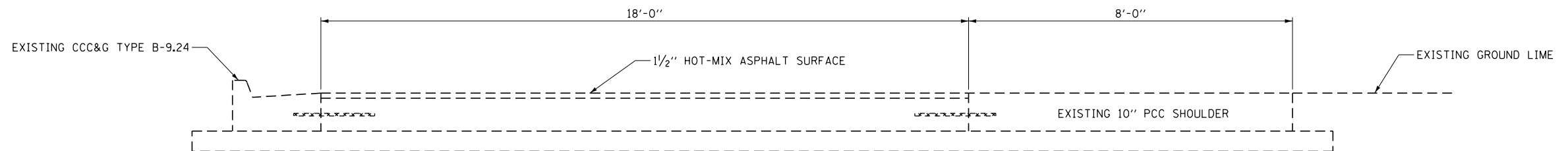

TYPICAL SECTION 4
CAR LOT DRIVE LANE

FILE NAME =	USER NAME = woodshankr1	DESIGNED - ECP	REVISED -	STATE OF ILLINOIS DEPARTMENT OF TRANSPORTATION	TYPICALS		F.A.I. R.T.E.	SECTION	COUNTY	TOTAL SHEETS	SHEET NO.
pw:\IL\084EBIDINTEG.illinois.gov\PIWIDOT\Documents\DOT Offices\District 3\Projects\0366\Drawings\B366\B366-Details.dgn	DRAWN -	CHECKED - RLW	REVISED -				80	(32,47-4)RA-3	GRUNDY	7	4
Default	PLOT SCALE = 100.0000' / in.	DATE - 2/10/16	REVISED -		SCALE: SHEET 1 OF 1 SHEETS STA. TO STA.		CONTRACT NO. 66F28				
	PLOT DATE = 3/23/2016	DATE - 2/10/16	REVISED -		ILLINOIS FED. AID PROJECT						

ADA RAMP SCHEDULE

LOCATION	EARTH EXCAVATION	SIDEWALK REMOVAL	PCC SIDEWALK 6"	DETECTABLE WARNINGS	COMBINATION CURB AND GUTTER REMOVAL	COMBINATION CONCRETE CURB AND GUTTER, TY B9.24
	CU YD	SQ FT	SQ FT	SQ FT	FOOT	FOOT
NE CAR LOT	5	1196	1196	30	92	92
NW CAR LOT	15	1935	1935	10	35	35
TOTAL	20	3131	3131	40	127	127

PATCHING SCHEDULE

LOCATION	CAR LOT DRIVE LANE				
	CLASS B		DOWEL BARS	SAW CUTS	WELDED WIRE REINF.
	TYPE II 11"	TYPE IV 11"	1 1/2"		
	SQ YD	SQ YD	EACH	FOOT	SQ YD
PATCH NO. 1		99	38	203	99
PATCH NO. 2		221	38	365	221
PATCH NO. 3	10		28	63	
TOTAL	10	320	104	631	320

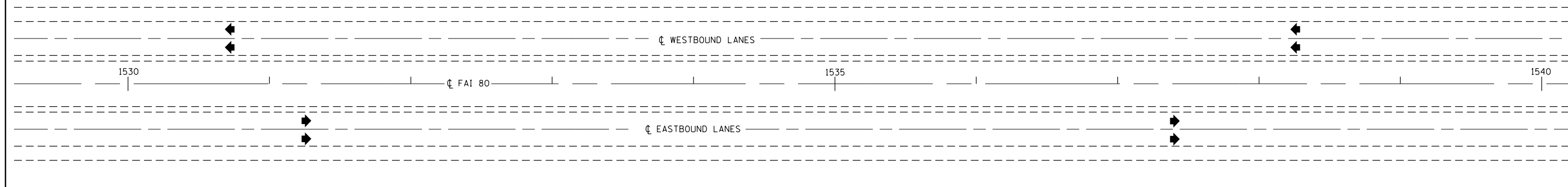
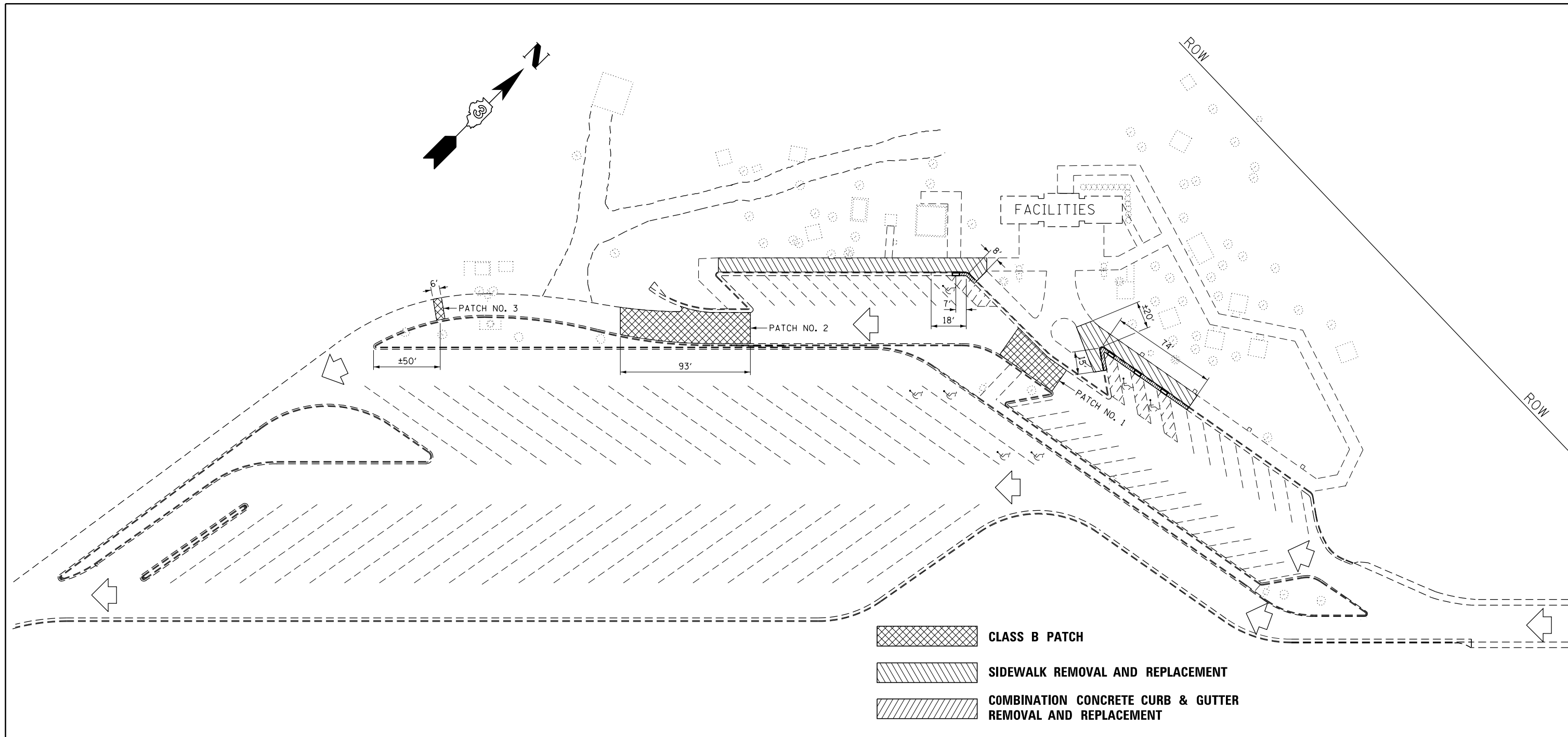

PLAN
WESTBOUND THREE RIVERS REST AREA

FILE NAME =	USER NAME = woodshankr1	DESIGNED - ECP	REVISED -	STATE OF ILLINOIS DEPARTMENT OF TRANSPORTATION	WESTBOUND THREE RIVERS REST AREA SITE PLAN	F.A.I. RTE. =	SECTION	COUNTY	TOTAL SHEETS	SHEET NO.	
pw:\IL\084EBIDINTEG.illinois.gov\PI\DOT\Documents\DOT Offices\District 3\Projects\0366\FBI\0366-FBI-Details.dgn	PLotted Date = 3/23/2016	CHECKED - RLW	REVISED -			80	(32,47-4)RA-3	GRUNDY	7	6	
Default	DATE - 2/10/16	REVISED -	REVISED -			CONTRACT NO. 66F28		ILLINOIS FED. AID PROJECT			
		SCALE:	SHEET 1 OF 1 SHEETS			STA.	TO STA.				

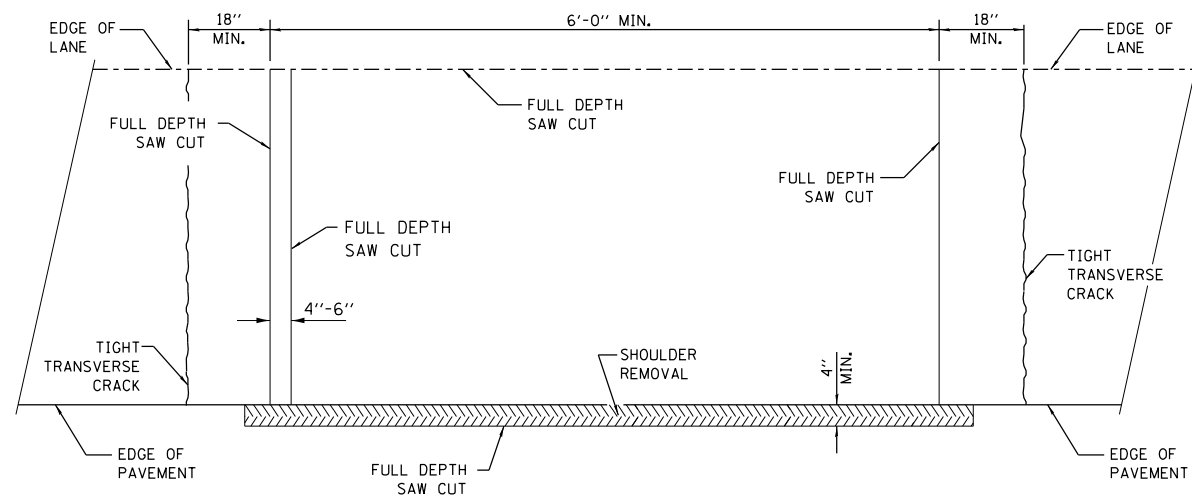

(PCC SHOULDER)

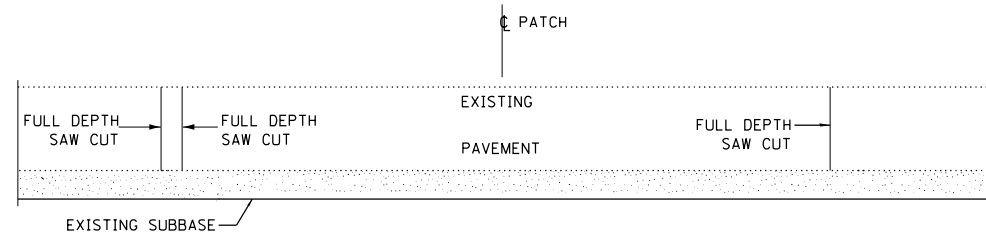

WITHOUT HMA SURFACE

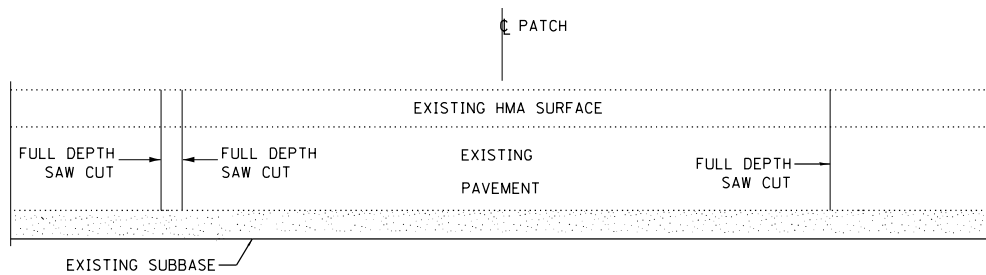

WITH HMA SURFACE

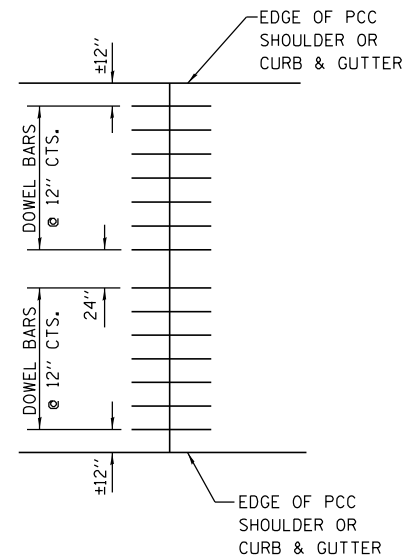

VARIED WIDTH LANES

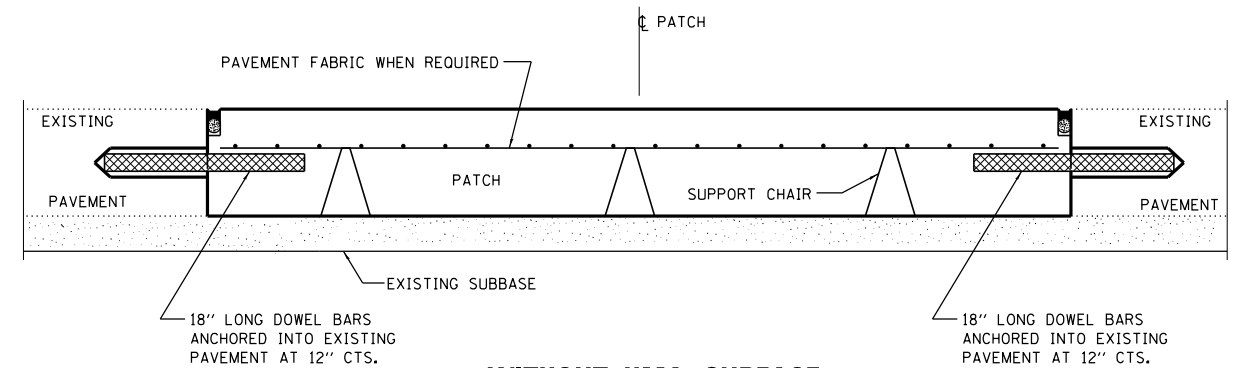

WITHOUT HMA SURFACE

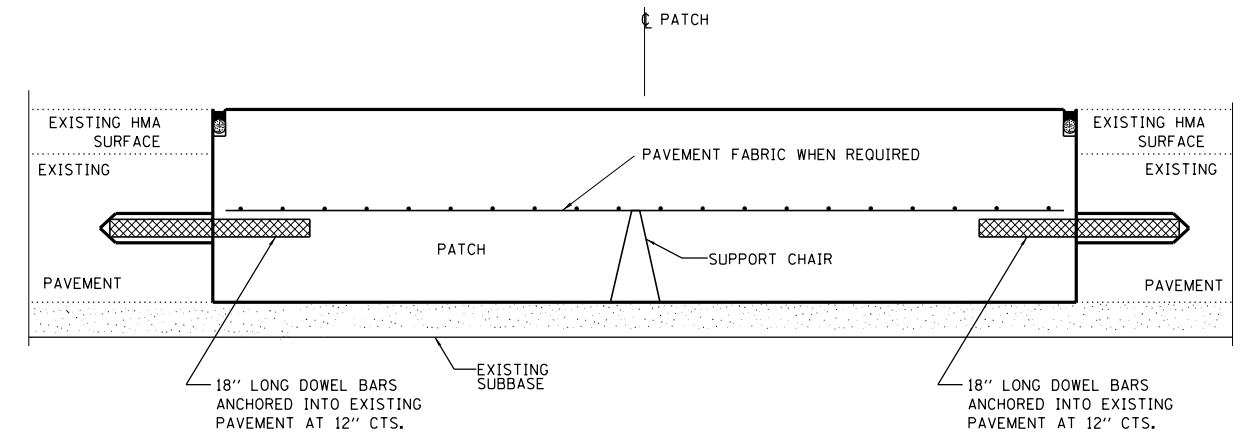

WITH HMA SURFACE

DOWEL BAR TABLE		
PAVEMENT THICKNESS	DOWEL BAR DIAMETER	HOLE DIAMETER
8" OR GREATER	1 1/2"	1 5/8"
7" THRU 7 5/8"	1 1/4"	1 3/8"
LESS THAN 7"	1"	1 1/8"

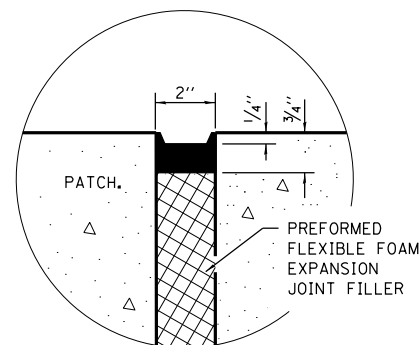

SEALING DETAIL

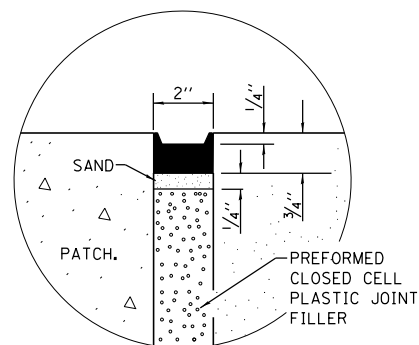

SEALING DETAIL

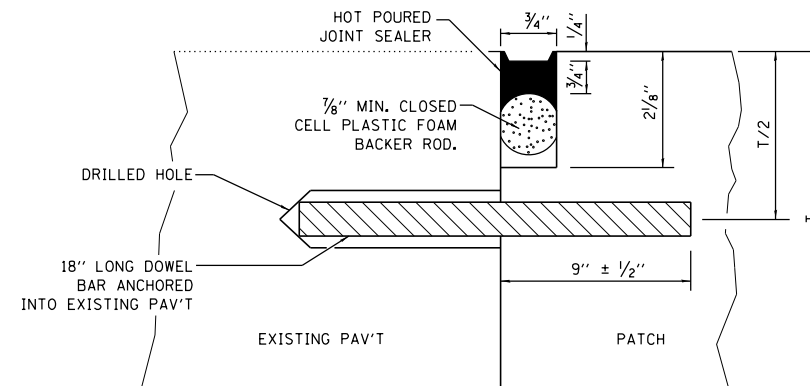

TRANSVERSE JOINT

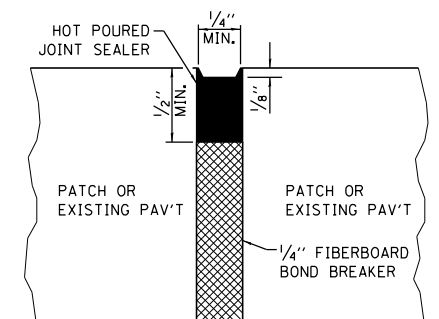

CENTERLINE JOINT

FILE NAME =	USER NAME = woodshankr1	DESIGNED - ECP	REVISED -
p:\1\084EBIDINTEG.illinois.gov\PI\DOT\Documents\DOT Offices\District 3\Projects\0366\Drawings\0366F03\0366F03-Details.dgn		CHECKED - RLW	REVISED -
Default	PLOT DATE = 3/23/2016	DATE - 2/10/16	REVISED -

**STATE OF ILLINOIS
DEPARTMENT OF TRANSPORTATION**

CLASS B PATCHING DETAILS

SCALE: SHEET 1 OF 1 SHEETS STA. TO STA.

F.A.I. RTE.	SECTION	COUNTY	TOTAL SHEETS	SHEET NO.
80	(32,47-4)RA-3	GRUNDY	7	7
CONTRACT NO. 66F28				
ILLINOIS FED. AID PROJECT				