

STATE OF ILLINOIS
DEPARTMENT OF TRANSPORTATION
DIVISION OF HIGHWAYS

**PROPOSED
HIGHWAY PLANS**

FAP ROUTE 789 (IL143)
SECTION 125-BR-I

SCOUR MITIGATION
MADISON COUNTY

C-98-015-16

FOR INDEX OF SHEETS, SEE SHEET NO. 2

F.A.P. RTE.	SECTION	COUNTY	TOTAL SHEETS	SHEET NO.
789	125-BR-I	MADISON	5	1
ILLINOIS			CONTRACT NO. 76J41	

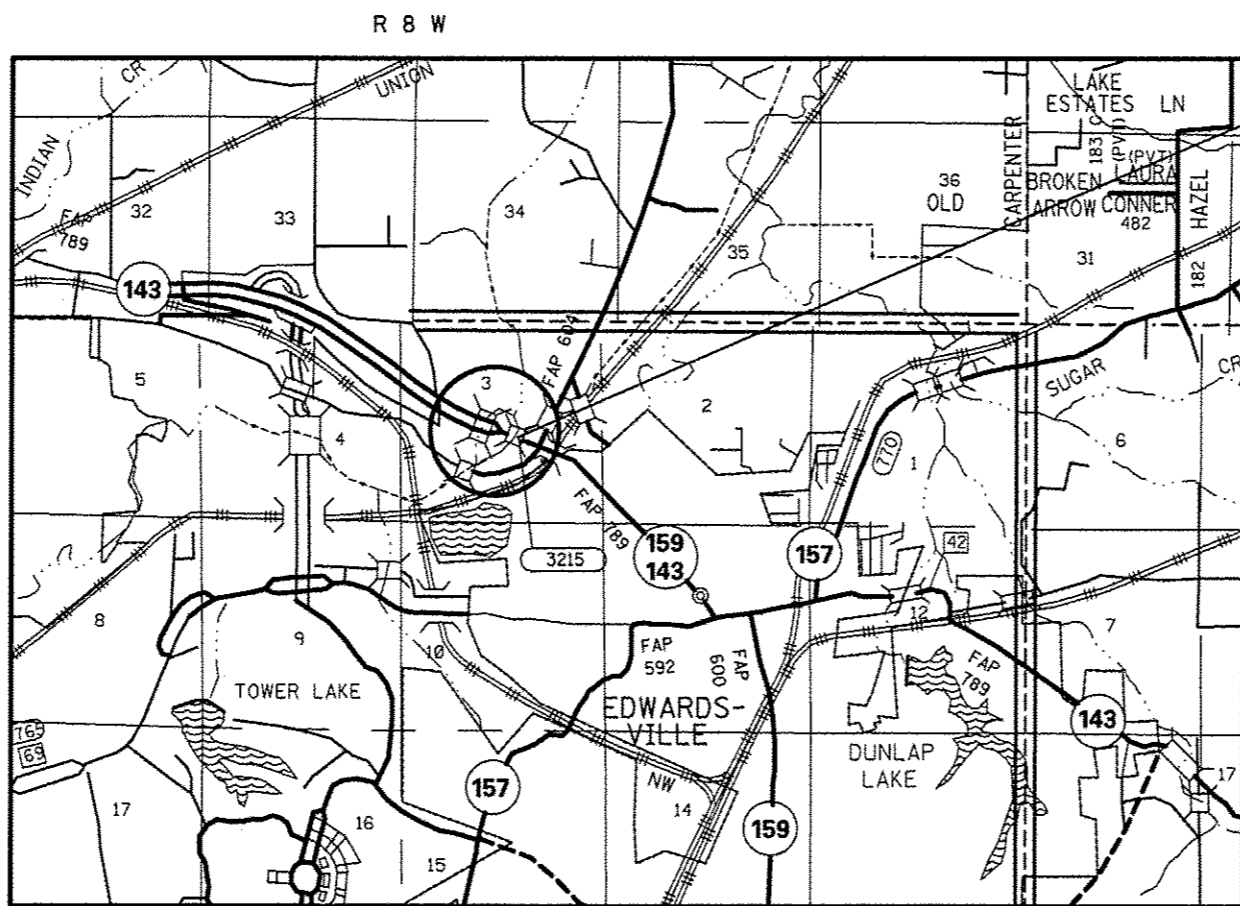

PROJECT LOCATION
STATION 118+27.12
200' BK TO BK OF ABUTMENT
3 SPAN STRUCTURE CONSISTING OF
A CONCRETE DECK SUPPORTED BY
CONTINUOUS STEEL PLATE BEAM GIRDERS
CARRIES IL 143 OVER CAHOKIA CREEK
SN 060-0083
LATITUDE - 38.82437993
LONGITUDE - -89.97461017



T 4 N

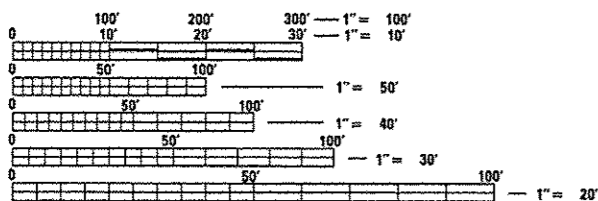

FULL SIZE PLANS HAVE BEEN PREPARED USING STANDARD ENGINEERING SCALES. REDUCED SIZED PLANS WILL NOT CONFORM TO STANDARD SCALES. IN MAKING MEASUREMENTS ON REDUCED PLANS, THE ABOVE SCALES MAY BE USED.

J.U.L.I.E.
JOINT UTILITY LOCATION INFORMATION FOR EXCAVATION
1-800-892-0123
OR 811

PROJECT ENGINEER: HERVE' GELIN (618)346-3179
PROJECT MANAGER: BILLIE OWEN (618)346-3329

CONTRACT NO. 76J41

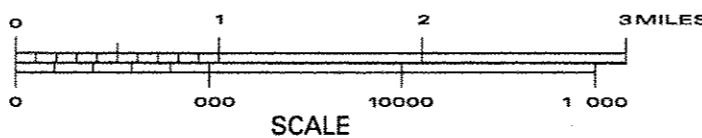

GROSS LENGTH = 200 FT. = 0.038 MILE
NET LENGTH = 200 FT. = 0.038 MILE

STATE OF ILLINOIS
DEPARTMENT OF TRANSPORTATION
DIVISION OF HIGHWAYS

SUBMITTED *March 24 20 16*

Jeffrey Z. Kan REGIONAL ENGINEER

Maureen M. Addis P.E. ENGINEER OF DESIGN AND ENVIRONMENT

Emad Osman P.E. DIRECTOR OF HIGHWAYS, CHIEF ENGINEER

PRINTED BY THE AUTHORITY
OF THE STATE OF ILLINOIS

ILLINOIS DEPARTMENT OF TRANSPORTATION
SUMMARY OF QUANTITIES

CONSTR. CODE
100% STATE
BRIDGE
0014
060-0083

CODE NO.	ITEM	UNIT	TOTAL QUANTITY	
28100109	STONE RIPRAP, CLASS A5	SQ YD	480	480
28200200	FILTER FABRIC	SQ YD	275	275
* 66900200	NON-SPECIAL WASTE DISPOSAL	CU YD	20	20
* 66900450	SPECIAL WASTE PLANS AND REPORTS	LSUM	1	1
* 66900530	SOIL DISPOSAL ANALYSIS	EACH	1	1
67100100	MOBILIZATION	LSUM	1	1
70100450	TRAFFIC CONTROL AND PROTECTION, STANDARD 701201	LSUM	1	1

** Specialty Items*

FILE NAME =	USER NAME = mawm	DESIGNED -	REVISED -	STATE OF ILLINOIS DEPARTMENT OF TRANSPORTATION	SUMMARY OF QUANTITIES	F.A.P. RTE.	SECTION	COUNTY	TOTAL SHEETS	SHEET NO.	
p:\11804EB\INTEG.illinois.gov\PW\DOT\Documents\DOT Offices\District 8\Projects\0876-DR\Drawings\640\sheet\0876J41-sht-pln.dwg	PLLOT SCALE = 100.0000' / 1" =	CHECKED -	REVISED -			789	125-0R-1	MADISON	5	3	
PLLOT DATE = 3/23/2016	DATE -	REVISED -				SCALE: NA		SHEET 1 OF 1 SHEETS		STA. TO STA.	CONTRACT NO. 76J41
						ILLINOIS FED. AID PROJECT					

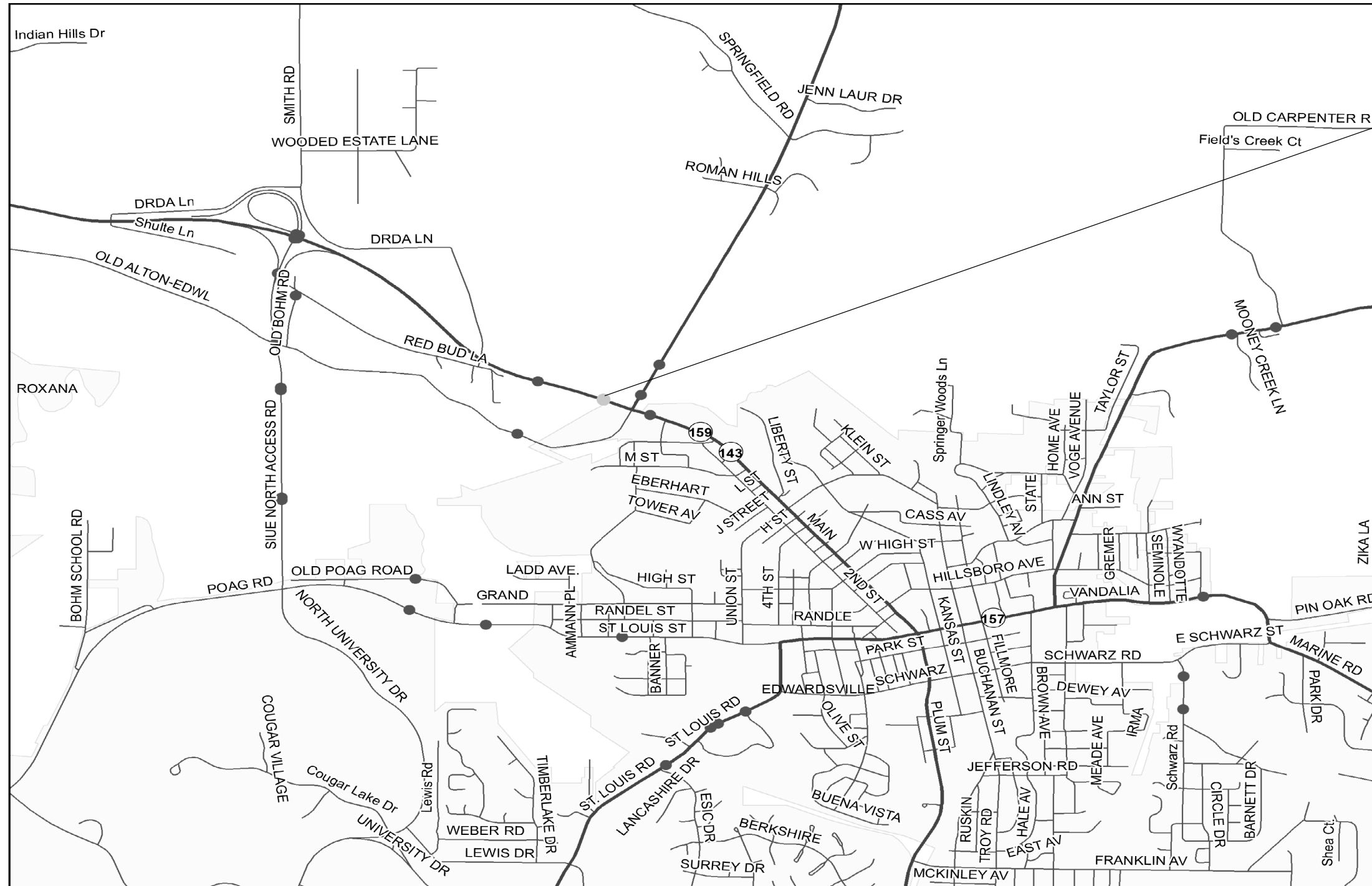

S.N. 014-0024 - STA. 118+27.12
 IL 143 OVER CAHOKIA CREEK
 NORTHWEST OF IL 159-EDWARDSVILLE TOWNSHIP
 COUNTY
 LATITUDE - 38.82437993
 LONGITUDE - -89.97461017



FILE NAME =	USER NAME = manntm	DESIGNED -	REVISED -
p:\11\084EBID\INTEG\illinois.gov\PIWIDOT\Documents\IDOT Offices\District 8\Projects\0876\DRAWING\DATA\LEADSheets\0876J41-sht-plan.dwg		REVISIONS	REVISIONS
	PLOT SCALE = 100.0000' / 1in.	CHECKED -	REVISED -
\$MODELNAME\$	PLOT DATE = 3/23/2016	DATE -	REVISED -

**STATE OF ILLINOIS
 DEPARTMENT OF TRANSPORTATION**

DETAIL LOCATION MAP

SCALE: SHEET 1 OF 1 SHEETS STA. TO STA.

F.A.P. RTE.	SECTION	COUNTY	TOTAL SHEETS	SHEET NO.
789	12-BR-1	MADISON	5	4
CONTRACT NO. 76J41				
ILLINOIS FED. AID PROJECT				

Existing Structure: S.N. 060-0083 consists of a three span continuous steel superstructure supported on concrete open abutments founded on precast concrete piles and multiple column piers with spread footings founded on timber piles.

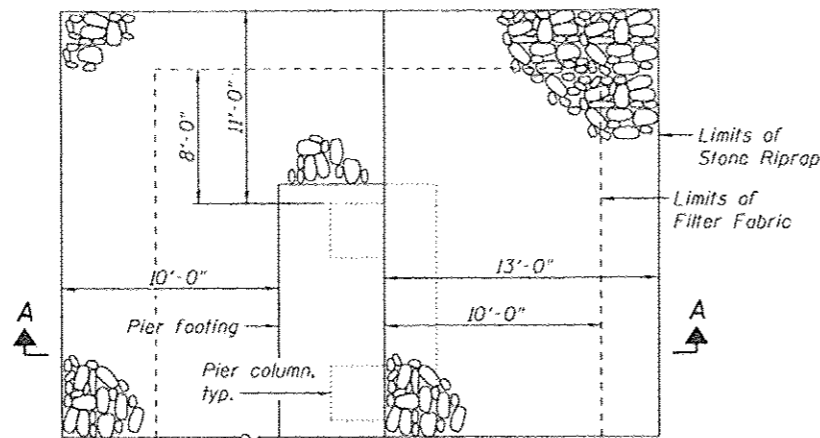

RIPRAP PROTECTION AT PIER

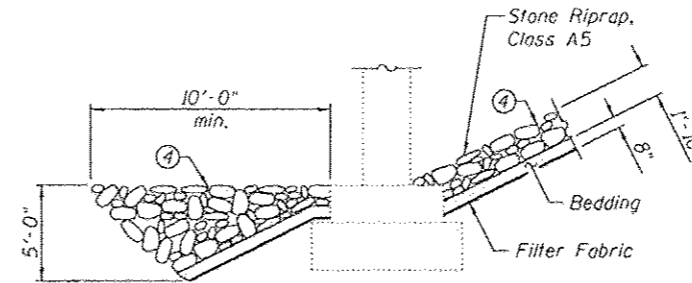

SECTION A-A

- Notes:
- ① The Contractor shall field verify existing dimensions, details, and conditions affecting new construction and make necessary approved adjustments prior to construction or ordering of materials. Such variations shall not be cause for additional compensation for a change in scope of the work, however, the Contractor will be paid for the quantity actually furnished based upon the unit price bid for the work.
 - ② Layout of the scour mitigation system may be varied to suit ground conditions in the field as directed by the Engineer.
 - ③ USGS Stream Gage 05587900 located at the upstream face. Adjust riprap layout as required to avoid existing stream gage instrumentation and associated service lines.
 - ④ Grade streambed and channel bank so that the top of the Stone Riprap approximately matches the existing ground line as directed by the Engineer. The cost of removing and disposing of existing riprap, brick, block, rubble, soil, or other materials to meet this requirement is included in the cost of Stone Riprap, Class A5.
 - ⑤ Contractor to locate existing underground utilities. Where existing underground utilities conflict with riprap placement, the Contractor shall adjust the layout as directed by the Engineer.
 - ⑥ Elevation view shown as of February 3, 2014. Actual conditions may vary.
 - ⑦ Estimated quantities. Actual quantities to be determined in the field.
 - ⑧ Adjust riprap layout as required to avoid existing sheet pile grade control structure.

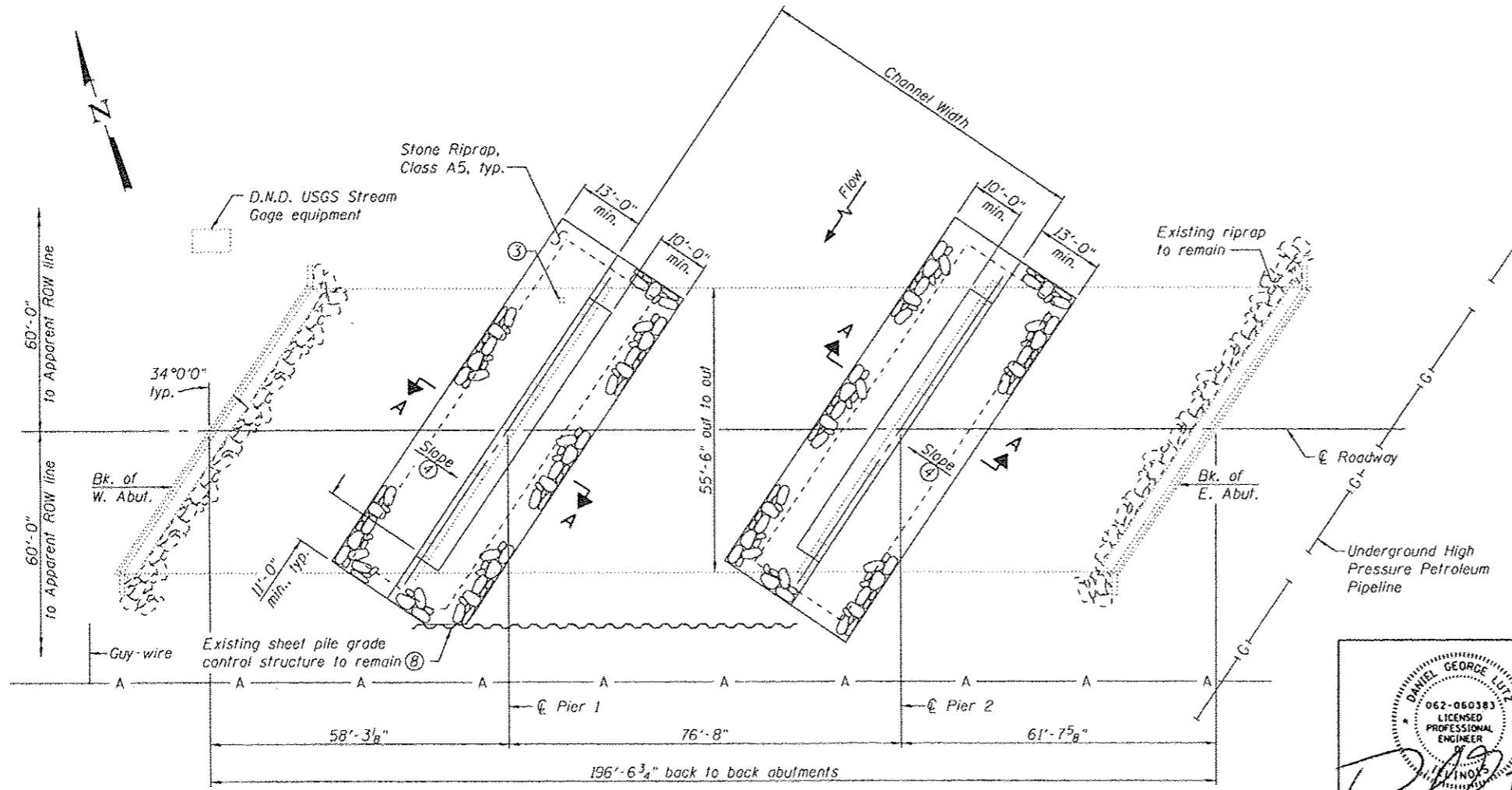

PLAN

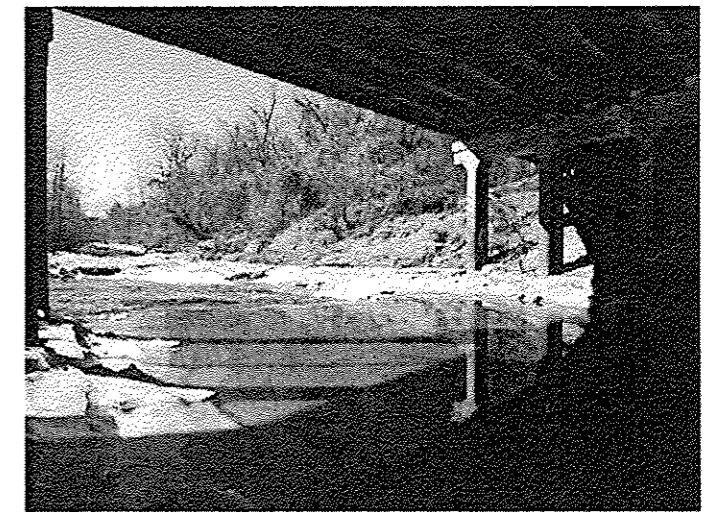

ELEVATION VIEW ⑥
(Looking South)

TOTAL BILL OF MATERIAL ⑦

CODE NO.	ITEM	UNIT	TOTAL
28100109	Stone Riprap, Class A5	Sq. Yd.	480
28200200	Filter Fabric	Sq. Yd.	275

DATE: 03/21/2016
 EXPIRATION: 11/31/2017

IL ROUTE 143 OVER CAHOKIA CREEK
STRUCTURE NO. 060-0083

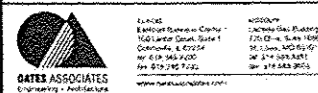

USER NAME	DESIGNED	REVISIONS
MAG	MAG	1
JAD	JAD	2
MAG	MAG	3
JAD	JAD	4

STATE OF ILLINOIS
DEPARTMENT OF TRANSPORTATION

GENERAL PLAN AND ELEVATION
LOCATION 1

SHEET NO. 1 OF 1 SHEETS

F.A.P. RTE.	SECTION	COUNTY	TOTAL SHEETS	SHEET NO.
789	125-BR-1	MADISON	5	5

CONTRACT NO. 76J41
ILLINOIS FED. AID PROJECT