

ROUTE	SECTION	COUNTY	TOTAL SHEETS	SHEET NO.
FAS 806	14-00117-00-RS	LAWRENCE	13	1
CONTRACT NO. 95789		ILLINOIS	PROJECT RS-0806(110)	

STATE OF ILLINOIS
DEPARTMENT OF TRANSPORTATION
PLANS FOR
PROPOSED LOCAL AGENCY IMPROVEMENT – STR FUNDS
FEDERAL-AID SECONDARY PROJECT
FAS ROUTE 806 SECTION 14-00117-00-RS
LAWRENCE COUNTY PROJ. RS-0806(110) JOB NO. C-97-027-16

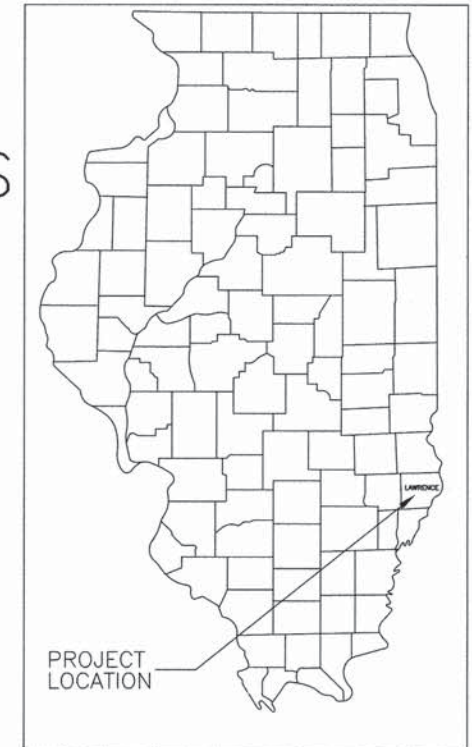

Joint Utility Locating Information for Excavators
JULIE 1-800-892-0123

INDEX OF SHEETS

SHEET	ITEM
1	COVER SHEET
2	SUMMARY OF QUANTITIES
3	TYPICAL SECTIONS
4-5	QUANTITIES
6-7	DETAILS
8	INTERSECTION DETAIL
9	DRAINAGE STRUCTURES / STORM SEWER
10-12	PLAN AND PROFILE / STORM SEWER
13	TRAFFIC CONTROL PLAN

- STANDARD DRAWINGS
- STANDARD 000001-06
 - STANDARD 280001-07
 - STANDARD 406201-01
 - STANDARD 442201-03
 - STANDARD 542301-03
 - STANDARD 542601-03
 - STANDARD 542606-02
 - STANDARD 602301-04
 - STANDARD 602401-03
 - STANDARD 602601-04
 - STANDARD 602701-02
 - STANDARD 604001-04
 - STANDARD 604036-03
 - STANDARD 604051-04
 - STANDARD 604086-03
 - STANDARD 606001-06
 - STANDARD 606301-04
 - STANDARD 701001-02
 - STANDARD 701006-05
 - STANDARD 701011-04
 - STANDARD 701201-04
 - STANDARD 701301-04
 - STANDARD 701306-03
 - STANDARD 701311-03
 - STANDARD 701336-06
 - STANDARD 701901-05
 - STANDARD 720001-01
 - STANDARD 720006-04
 - STANDARD 728001-01
 - STANDARD 780001-05
 - STANDARD BLR 21-9
 - STANDARD BLR 22-7

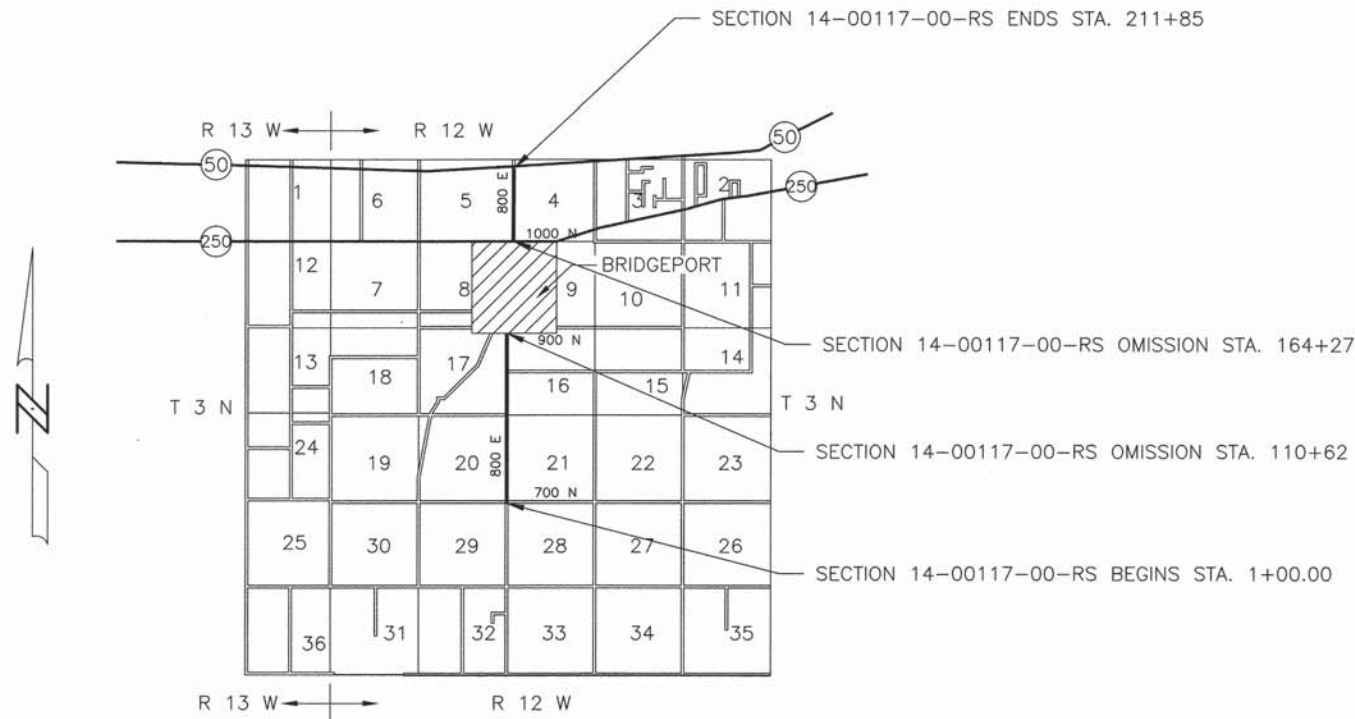

STA. 1+00 TO 109+62
MAJOR COLLECTOR
ADT = 1900
DESIGN SPEED = 50 MPH

STA. 164+27 TO 211+85
MINOR ARTERIAL
ADT = 2400
DESIGN SPEED = 50 MPH

NET LENGTH SECTION 14-00117-00-RS = 15,720.00 Ft. = 2.977 Mi.



Roger A. Charlton
Ill. Reg. Prof. Eng. #29195
4-4-16
Lic. Expires 11/30/17

CHARLESTON ENGINEERING, INC.
CONSULTING ENGINEERS
105 NORTH KITCHELL
P.O. BOX 397
CLINEY, ILLINOIS 62450
(618) 392-0735
ILLINOIS DEPARTMENT OF PROFESSIONAL REGULATION REGISTRATION #184.003513

APPROVED 4-4-2016
[Signature]
COUNTY ENGINEER

STATE OF ILLINOIS
DEPARTMENT OF TRANSPORTATION

PASSED 4-6-16
[Signature]
DISTRICT SEVEN ENGINEER OF
LOCAL ROADS AND STREETS

Releasing For
Bid Based on
Limited Review 4-6-16
[Signature]
REGION FOUR ENGINEER

ROUTE	SECTION	COUNTY	TOTAL SHEETS	SHEET NO.
FAS 806	14-00117-00-RS	LAWRENCE	13	2
CONTRACT NO. 95789		ILLINOIS	PROJECT RS-0806(110)	

GENERAL NOTES

1. THIS SECTION CONSISTS OF THE CONSTRUCTION OF A 22 FOOT WIDE HOT MIX ASPHALT SURFACE COURSE, MIXTURE "C", N70, ALONG WITH THE REQUIRED BASE COURSE REPAIR AND CONSTRUCTION OF AGGREGATE SHOULDERS. THIS PROJECT SHALL BE BUILT IN ACCORDANCE WITH THE PLANS, SPECIAL PROVISIONS, AND "STANDARD SPECIFICATIONS FOR ROAD AND BRIDGE CONSTRUCTION" ADOPTED APRIL 1, 2016.

2. THE UNIT WEIGHT OF SURFACE COURSE USED TO ESTIMATE PLAN QUANTITY IS 115 LB/SQ YD/IN.

3. PAY ITEM "BITUMINOUS MATERIALS (TACK COAT)" INCLUDES QUANTITY FOR TACK COAT THAT SHALL BE APPLIED TO THE ENTIRE FACE OF THE NOTCHED LONGITUDINAL WEDGE JOINT AS DESCRIBED IN ARTICLE 406.06 OF THE STANDARD SPECIFICATIONS.

4. NO OPEN STORM SEWER OR CULVERT TRENCHES SHALL BE LEFT OPEN OVERNIGHT.

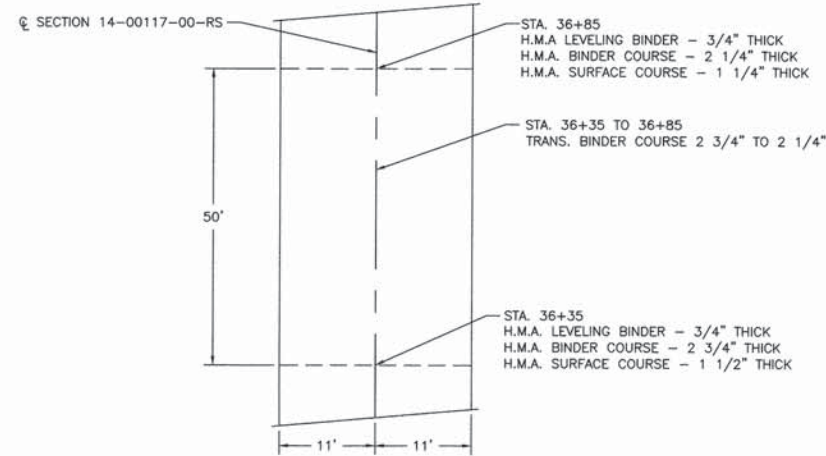

TYPICAL SECTION TRANSITION DETAIL

STA. 36+35 TO 36+85

SUMMARY OF QUANTITIES			
CODE NO.	ITEM	UNIT	QUANTITY
X6024242	INLETS, SPECIAL, NO. 1	EACH	1
X7010216	TRAFFIC CONTROL AND PROTECTION, (SPECIAL)	L SUM	1
X7240205	REMOVE SIGN COMPLETE	EACH	3
X7240600	REMOVE AND RE-ERECT EXISTING SIGN	EACH	1
X0322916	PROPOSED STORM SEWER CONNECTION TO EXISTING STORM SEWER	EACH	1
X0323389	STORM SEWER CONNECTION	EACH	12
X2500900	SEEDING, CLASS 1 (SPECIAL)	ACRE	0.30
Z0001110	GAS VALVE TO BE ADJUSTED	EACH	3
20200500	EARTH EXCAVATION (WIDENING)	CU YD	130
20800150	TRENCH BACKFILL	CU YD	286.9
28000250	TEMPORARY EROSION CONTROL SEEDING	POUND	50
28000500	INLET AND PIPE PROTECTION	EACH	18
28100805	STONE DUMPED RIPRAP, CLASS A3	TON	10
35101400	AGGREGATE BASE COURSE, TYPE B	TON	35
35600732	HOT-MIX ASPHALT BASE COURSE WIDENING, 14"	SQ YD	305
40200800	AGGREGATE SURFACE COURSE, TYPE B	TON	537.3
40201000	AGGREGATE FOR TEMPORARY ACCESS	TON	36.8
40600275	BITUMINOUS MATERIALS (PRIME COAT)	POUND	4,260
40600290	BITUMINOUS MATERIALS (TACK COAT)	POUND	13,600
40600635	LEVELING BINDER (MACHINE METHOD), N70	TON	4,235
40600982	HOT-MIX ASPHALT SURFACE REMOVAL - BUTT JOINT	SQ YD	1,190
40600990	TEMPORARY RAMP	SQ YD	3,466
40603085	HOT-MIX ASPHALT BINDER COURSE, IL-19.0, N70	TON	5,900
40603315	HOT-MIX ASPHALT SURFACE COURSE, MIX "C", N70	TON	3,605
42300200	PORTLAND CEMENT CONCRETE DRIVEWAY PAVEMENT, 6 INCH	SQ YD	69.5
44000100	PAVEMENT REMOVAL	SQ YD	27.0
44000152	HOT-MIX ASPHALT SURFACE REMOVAL, 3/4"	SQ YD	8.0
44000200	DRIVEWAY PAVEMENT REMOVAL	SQ YD	69.5
44201835	CLASS D PATCHES, TYPE I, 16 INCH	SQ YD	22
44201839	CLASS D PATCHES, TYPE II, 16 INCH	SQ YD	274
44201843	CLASS D PATCHES, TYPE III, 16 INCH	SQ YD	233
44201845	CLASS D PATCHES, TYPE IV, 16 INCH	SQ YD	736
44201863	CLASS D PATCHES, TYPE II, 18 INCH	SQ YD	38
44300100	AREA REFLECTIVE CRACK CONTROL TREATMENT	SQ YD	103
44300200	STRIP REFLECTIVE CRACK CONTROL TREATMENT	FOOT	1,030
48102100	AGGREGATE WEDGE SHOULDER, TYPE B	TON	3,900
50100300	REMOVAL OF EXISTING STRUCTURES NO. 1	EACH	1
50100400	REMOVAL OF EXISTING STRUCTURES NO. 2	EACH	1
50100500	REMOVAL OF EXISTING STRUCTURES NO. 3	EACH	1
50100600	REMOVAL OF EXISTING STRUCTURES NO. 4	EACH	1
50104400	CONCRETE HEADWALL REMOVAL	EACH	16
50105220	PIPE CULVERT REMOVAL	FOOT	2,074
54213657	PRECAST REINFORCED CONCRETE FLARED END SECTIONS 12"	EACH	6
54213660	PRECAST REINFORCED CONCRETE FLARED END SECTIONS 15"	EACH	4
542C0217	PIPE CULVERTS, CLASS C, TYPE 1 12"	FOOT	1,014
542C0220	PIPE CULVERTS, CLASS C, TYPE 1 15"	FOOT	440
542C0223	PIPE CULVERTS, CLASS C, TYPE 1 18"	FOOT	462
542C0226	PIPE CULVERTS, CLASS C, TYPE 1 21"	FOOT	46
542C0229	PIPE CULVERTS, CLASS C, TYPE 1 24"	FOOT	152
542C0253	PIPE CULVERTS, CLASS C, TYPE 1 48"	FOOT	20
54210184	PIPE ELBOW, 15"	EACH	1
54216180	REINFORCED CONCRETE PIPE TEE, 12" PIPE WITH 12" RISER	EACH	2
54216555	REINFORCED CONCRETE PIPE TEE, 15" PIPE WITH 15" RISER	EACH	1
54248510	CONCRETE COLLAR	CU YD	0.50
550A0050	STORM SEWERS, CLASS A, TYPE 1 12"	FOOT	1,099
550A0070	STORM SEWERS, CLASS A, TYPE 1 15"	FOOT	911
55100500	STORM SEWER REMOVAL 12"	FOOT	1,130
55100700	STORM SEWER REMOVAL 15"	FOOT	701
56109210	WATER VALVES TO BE ADJUSTED	EACH	1
59300100	CONTROLLED LOW-STRENGTH MATERIAL	CU YD	135.3
60100905	PIPE DRAINS 4"	FOOT	72
60218300	MANHOLES, TYPE A, 4'-DIAMETER, TYPE 1 FRAME, OPEN LID	EACH	2
60219000	MANHOLES, TYPE A, 4'-DIAMETER, TYPE 8 GRATE	EACH	1
60236200	INLETS, TYPE A, TYPE 8 GRATE	EACH	10
60236800	INLETS, TYPE A, TYPE 11 FRAME AND GRATE	EACH	2
60605000	COMBINATION CONCRETE CURB AND GUTTER, TYPE B-6.24	FOOT	165.0
60608600	COMBINATION CONCRETE CURB AND GUTTER, TYPE M-6.06	FOOT	12.0
60610400	COMBINATION CONCRETE CURB AND GUTTER, TYPE M-6.24	FOOT	22.0
60625600	ISLAND PAVEMENT (6')	SQ YD	4.5
67100100	MOBILIZATION	L SUM	1
70100450	TRAFFIC CONTROL AND PROTECTION, STANDARD 701201	L SUM	1
70100460	TRAFFIC CONTROL AND PROTECTION, STANDARD 701306	L SUM	1
70100600	TRAFFIC CONTROL AND PROTECTION, STANDARD 701336	L SUM	1
70103815	TRAFFIC CONTROL SURVEILLANCE	CAL DA	6
70300100	SHORT-TERM PAVEMENT MARKING	FOOT	4,720
70300150	SHORT TERM PAVEMENT MARKING REMOVAL	SQ FT	1,560
72000100	SIGN PANEL - TYPE 1	SQ FT	109.2
72800100	TELESCOPING STEEL SIGN SUPPORT	FOOT	291.5
78000200	THERMOPLASTIC PAVEMENT MARKING - LINE 4"	FOOT	49,700
78000600	THERMOPLASTIC PAVEMENT MARKING - LINE 12"	FOOT	40
78000650	THERMOPLASTIC PAVEMENT MARKING - LINE 24"	FOOT	44
78300100	PAVEMENT MARKING REMOVAL	SQ FT	354

▲ SPECIALTY ITEMS

EXCAVATION AND EMBANKMENT

ITEM	CU. YD.
EXCAVATION	
EARTH EXCAVATION WIDENING	130
TOTAL	130
OTHER SOURCES OF EARTH	
FROM CULVERTS	138
FROM STORM SEWER	122
TOTAL	260
EMBANKMENT	
CH 8 & RT. 250 INTERSECT.	60
TOTAL	60

BACKFILL QUANTITIES

ITEM	CU. YD.
C.L.S.M.	
STORM SEWERS, CLASS A	46.6
ENTRANCES, BIT. AND CONC.	69.7
A.R. CULVERT STA. 2+12	14.0
R1-CONCRETE HEADWALL REMOVAL	4.0
R6-REM. OF EX. STR. NO. 4	1.0
TOTAL	135.3
TRENCH BACKFILL	
STORM SEWERS, CLASS A	146.1
DRAINAGE STRUCTURE REMOVAL	3.0
ENTRANCES, BIT. AND CONC.	137.8
TOTAL	286.9

TEMPORARY RAMP

ITEM	SQ. YD.
MAINLINE BUTT JOINT LOCATIONS	252
RT. 250 INTERSECTION	610
H.M.A. AND P.C.C. ENTRANCES AND SIDEROADS	2604
TOTAL	3466

PAVEMENT REMOVAL

ITEM	SQ. YD.
A.R. CULVERT STA. 2+12	20
RT. 250 INTERSECTION	7
TOTAL	27

ROUTE	SECTION	COUNTY	TOTAL SHEETS	SHEET NO.
FAS 806	14-00117-00-RS	LAWRENCE	13	3
CONTRACT NO. 95789		ILLINOIS	PROJECT RS-0806(110)	

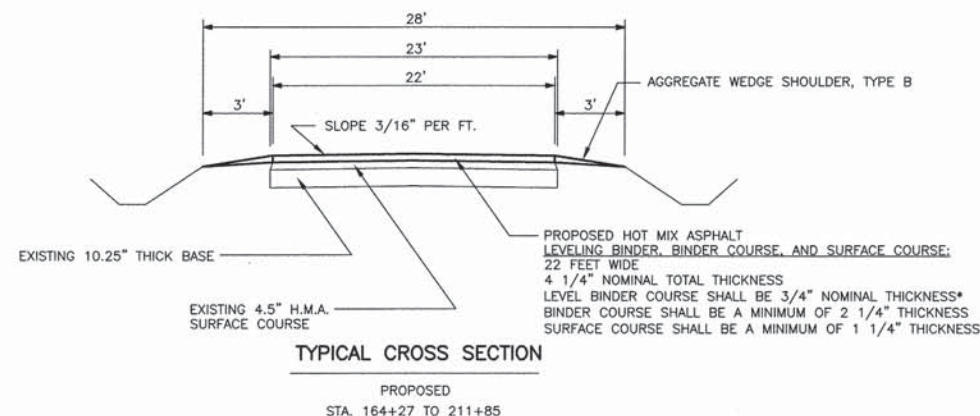
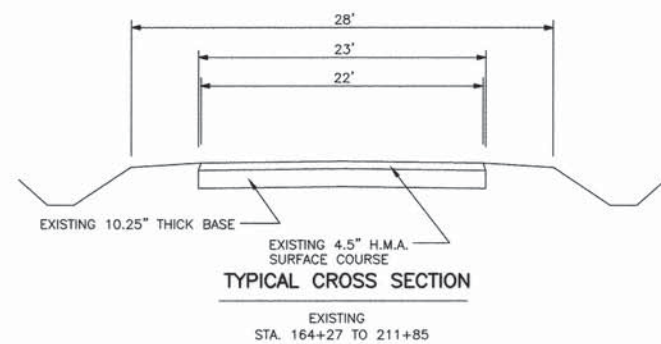
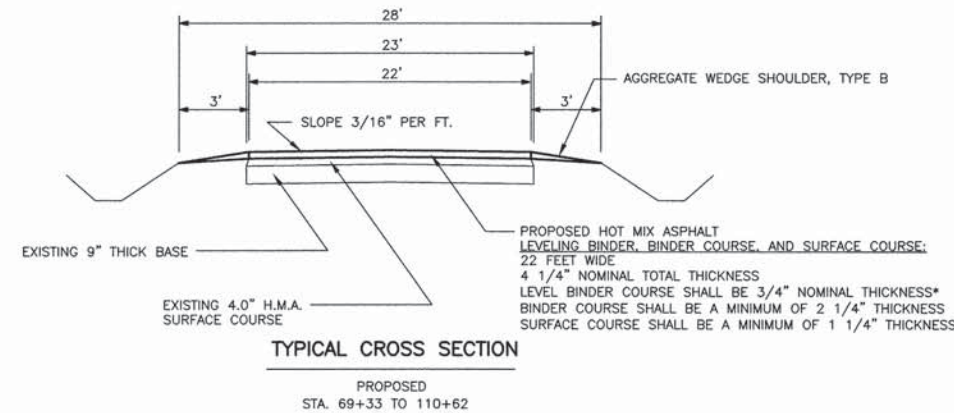
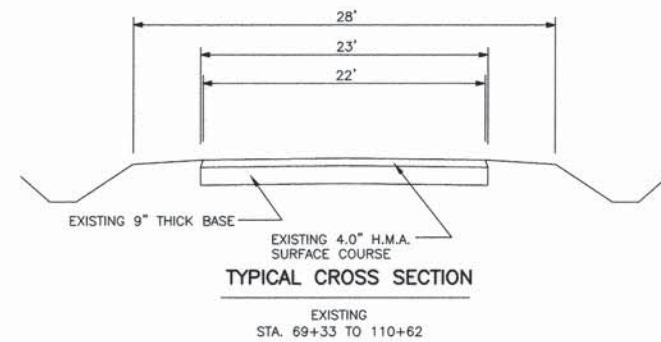
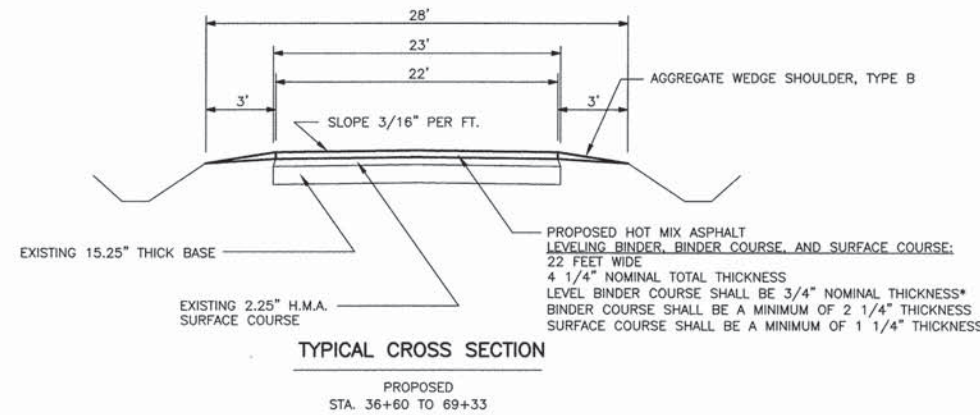
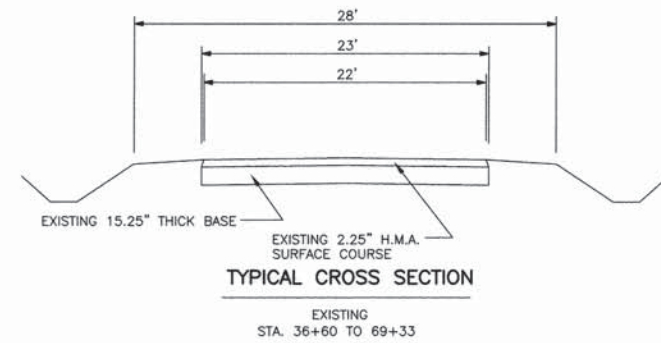
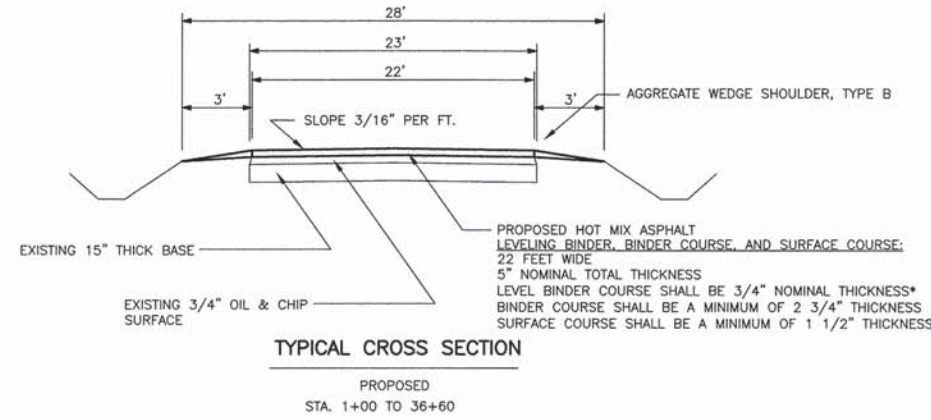
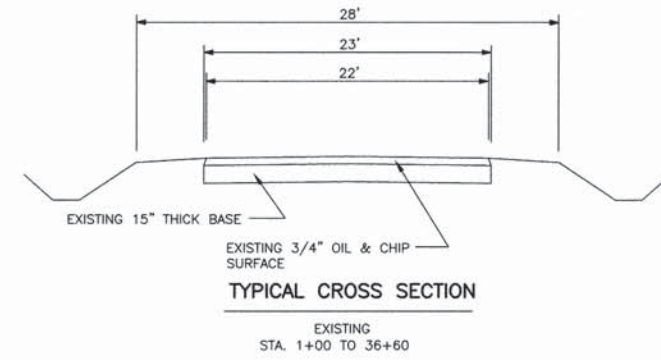

HOT MIX ASPHALT

SURFACE COURSE
APPLICATION: HOT-MIX ASPHALT SURFACE COURSE, MIXTURE "C" N70
PG GRADE: PG 64-22
DESIGN AIR VOIDS: 4.0% @ Ndesign 70
MIXTURE COMPOSITION: IL-9.5
FRICTION AGGREGATE: MIXTURE C

BINDER COURSE
APPLICATION: HOT-MIX ASPHALT BINDER COURSE, IL-19.0, N70
PG GRADE: PG 64-22
DESIGN AIR VOIDS: 4.0% @ Ndesign 70
MIXTURE COMPOSITION: IL-19.0
FRICTION AGGREGATE: N/A

LEVELING BINDER
APPLICATION: LEVELING BINDER (MACHINE METHOD) N70
PG GRADE: PG 64-22
DESIGN AIR VOIDS: 4.0% @ Ndesign 70
MIXTURE COMPOSITION: IL-9.5
FRICTION AGGREGATE: N/A

CLASS D PATCHES
APPLICATION: HOT-MIX ASPHALT BINDER COURSE, IL-19.0, N70
PG GRADE: PG 64-22
DESIGN AIR VOIDS: 4.0% @ Ndesign 70
MIXTURE COMPOSITION: IL-19.0
FRICTION AGGREGATE: N/A

H.M.A. BASE COURSE WIDENING
HOT-MIX ASPHALT BASE COURSE WIDENING, 14"
PG GRADE: PG 64-22
DESIGN AIR VOIDS: 4.0% @ Ndesign 70
MIXTURE COMPOSITION: IL-19.0
FRICTION AGGREGATE: N/A

PAVEMENT DESIGN

DESIGN PERIOD: 20 YEARS
80,000 POUND DESIGN
ROAD CLASSIFICATION: MINOR ARTERIAL
A.D.T. YEAR 2015: 2400
S.D.T. YEAR 2025: 2800

PROPOSED PAVEMENT STRUCTURE MATERIALS:

STA. 1+00 TO 36+60
1 1/2" H.M.A. SURFACE COURSE
2 3/4" H.M.A. BINDER COURSE
3/4" H.M.A. LEVELING BINDER
5" TOTAL H.M.A. OVERLAY

STA. 36+60 TO 110+62
STA. 164+27 TO 211+85
1 1/4" H.M.A. SURFACE COURSE
2 1/4" H.M.A. BINDER COURSE
3/4" H.M.A. LEVELING BINDER
4 1/4" TOTAL H.M.A. OVERLAY

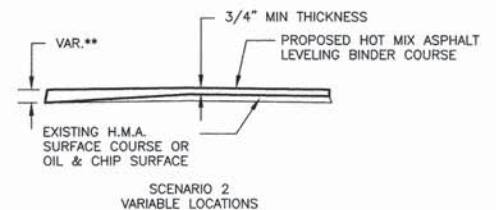
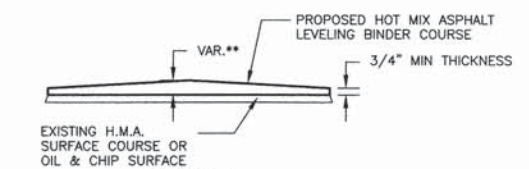

**TO ACHIEVE CORRECT CROSS-SLOPE, PROVIDE ADDITIONAL DEPTH OF LEVELING BINDER FOR CROSS-SECTIONS THAT ARE NOT UNIFORM IN EXISTING SLOPE. THE PROPOSED TOP SURFACE OF THE LEVELING BINDER SHALL BE BUILT ACCORDING TO THE SLOPES AS SHOWN ON THE PROPOSED TYPICAL SECTIONS. LEVELING BINDER SHALL BE A MINIMUM OF 3/4" NOMINAL THICKNESS AT ALL AREAS ALONG CROSS SECTION. QUANTITIES FOR THE ABOVE ARE INCLUDED IN ITEM "LEVELING BINDER (MACHINE METHOD), N70." SEE SHEET THIS SHEET FOR TYPICAL SECTIONS.

***TYPICAL SECTION - LEVELING BINDER**

STA. 1+00 TO 211+85

ENTRANCE SCHEDULE												
STATION	LOCATION	TYPE	HMA- TONS	AGG.- TONS	PCC DW PAVT 6"- SQ YD *	WIDTH AT EP	DEPTH FROM EP	RADIUS	TR. BACKFILL CU YD	C.L.S.M. CU YD	TEMP. AGG. TONS	
2+28	LT	SIDE ROAD		26.9		75	36	20/36				
2+28	RT	SIDE ROAD	33.9			75	46	35/46				
5+37	LT	PE	3.4	6.8		28	4	4' FLARE	1.7			
15+35	LT	FE		2.6		22	4	4' FLARE				
23+64	RT	PE	6.7	16.4		54	4	4' FLARE	4.8			
27+39	LT	PE	3.1	6.1		26	4	4' FLARE	1.9			
28+91	LT	PE	5.2	11.7		42	4	4' FLARE	4.6			
28+94	RT	PE	4.2	8.1		34	4	4' FLARE	3.3			
30+33	RT	PE	2.8	5.0		23	4	4' FLARE	1.7			
32+49	RT	PE	4.2	7.8		34	4	4' FLARE	1.8			
34+63	LT	PE	3.4	6.4		28	4	4' FLARE	1.9			
35+72	LT	FE		3.0		26	4	4' FLARE				
40+17	LT	PE	2.9	5.5		28	4	4' FLARE	1.1			
40+30	RT	PE	3.3	6.5		32	4	4' FLARE	2.7			
42+32	LT	FE		2.0		20	4	4' FLARE				
48+53	LT	FE		2.2		22	4	4' FLARE				
49+28	LT	PE	3.1	6.5		30	4	4' FLARE	3.3			
51+11	RT	FE		2.0		20	4	4' FLARE				
55+06	RT	PE	3.1	6.4		30	4	4' FLARE	4.2			
55+48	LT	SIDE ROAD	51.4			130	52	45/60				
57+77	RT	FE		3.2		32	4	4' FLARE				
58+83	RT	PE	2.2	4.7		22	4	4' FLARE	2.4			
60+91	RT	PE	2.9	5.6		28	4	4' FLARE	1.7			
62+16	RT	PE	2.7	4.9		26	4	4' FLARE	1.2			
64+61	RT	FE		2.0		20	4	4' FLARE				
65+91	RT	PE	3.8	7.1		36	4	4' FLARE	1.8			
69+86	RT	PE	9.6	16.2		90	4	4' FLARE				
70+87	RT	PE	2.9	4.0		28	4	4' FLARE				
71+38	LT	FE		11.6		48	20	20/20	3.4			
75+17	RT	PE	4.0	8.4		38	4	4' FLARE	1.9			
75+87	RT	FE		2.2		22	4	4' FLARE				
77+15	LT	FE		2.2		22	4	4' FLARE				
82+41	LT	SIDE ROAD		12.7		62	20	23/23	3.5			
82+41	RT	SIDE ROAD	51.5			136	50	60/54				
85+00	LT	PE	7.2			30	19	EX. FLARE				
86+81	LT	PE	7.2			32	19	EX. FLARE				
87+07	RT	PE	2.9	5.5		28	4	4' FLARE	0.9			
88+04	RT	PE	2.4	4.7		24	4	4' FLARE	2.8			
88+23	LT	PE	3.8	5.6		36	4	4' FLARE				
89+70	RT	PE	3.1	5.8		30	4	4' FLARE	2.6			
90+30	LT	PE	3.1	6.3		30	4	4' FLARE	3.7			
92+70	LT	PE	3.3	4.8		32	4	4' FLARE				
94+53	LT	PE	7.2			26	19	EX. FLARE	3.1	1.8		
98+62	LT	PE	4.8	10.3		46	4	4' FLARE	2.3			
99+37	LT	PE	2.9	5.7		28	4	4' FLARE	0.7			
100+02	LT	PE	3.8	7.9		36	4	4' FLARE	0.7			
100+83	LT	PE	3.1	4.4		30	4	4' FLARE				
101+47	LT	PE	4.4	6.7		42	4	4' FLARE				
103+58	LT	PE	2.9	4.0		28	4	4' FLARE				
105+24	LT	PE	7.2			30	19	EX. FLARE				
107+96	RT	PE	3.3	6.8		32	4	4' FLARE	2.4			
108+42	LT	PE	2.2	2.8		22	4	4' FLARE				
109+00	LT	PE	3.8	5.6		36	4	4' FLARE				
109+39	RT	SIDE ROAD	14.7			74	16	24/33	5.8	3.3		
165+70	RT	PE	13.0		18.5			25/25	8.5	3.8		
165+88	LT	PE	6.1		10.0	26	19	EX. FLARE	*	2.0		
167+75	LT	PE	3.5	5.2		34	4	4' FLARE	*			
168+75	LT	PE	3.5	5.2		34	4	4' FLARE	*			
169+83	RT	COMMERCIAL	29.9			95	19	46/40	7.1	4.7		
170+43	LT	PE	4.0	6.0		38	4	4' FLARE	*			
171+08	RT	PE	10.8			50	19	36/18	*	3.1		
171+78	LT	PE	2.7	3.6		26	4	4' FLARE	*			
172+67	LT	PE	2.2	4.4		22	4	4' FLARE	3.3			
174+48	RT	PE	5.1			26	19	40/25	*	1.4		
174+58	LT	PE	5.5	8.7		52	4	4' FLARE	*			
176+45	LT	PE	3.8	5.6		36	4	4' FLARE	*			
177+55	LT	PE	5.7	9.1		54	4	4' FLARE	*			
177+76	RT	FE		5.8		40	4	4' FLARE	1.2			
178+66	LT	PE	2.7	3.6		26	4	4' FLARE	*			
179+63	LT	PE	6.1	9.9		58	4	4' FLARE	*			
180+53	LT	PE	2.0	2.4		20	4	4' FLARE	*			
181+18	LT	PE	2.7	4.9		26	4	4' FLARE	2.6			
182+40	LT	PE	2.2	4.1		22	4	4' FLARE	0.7			
182+64	LT	PE	2.2	4.1		22	4	4' FLARE	0.7			
183+74	LT	PE	2.7	5.1		26	4	4' FLARE	1.2			
184+43	LT	FE	2.4	4.7		24	4	4' FLARE	1.3			
185+86	LT	PE	2.4	4.9		24	4	4' FLARE	0.9			
186+13	LT	FE	2.4	4.6		24	4	4' FLARE	0.8			
186+81	LT	PE	2.4	4.8		24	25	4' FLARE	1.1			
187+14	LT	PE	1.6	2.9		16	4	4' FLARE	1.0			
187+78	LT	PE	2.7	5.3		26	4	4' FLARE	1.4			
188+28	LT	PE	2.7	4.9		26	4	4' FLARE	1.2			

ENTRANCE SCHEDULE (CONTINUED)												
STATION	LOCATION	TYPE	HMA- TONS	AGG.- TONS	PCC DW PAVT 6"- SQ YD	WIDTH AT EP	DEPTH FROM EP	RADIUS	TR. BACKFILL CU YD	C.L.S.M. CU YD	TEMP. AGG. TONS	
188+88	LT	PE	2.0	3.8		20	4	4' FLARE	1.9			
189+84	LT	PE	3.1	6.9		30	4	4' FLARE	4.5			
191+06	RT	SIDE ROAD		22.0		100	25	18/44	8.4			
191+16	LT	SIDE ROAD		21.0		74	26	20/28	5.3			
192+83	RT	PE	4.4	8.8		42	4	4' FLARE	2.9			
194+70	RT	PE	2.4	5.3		24	4	4' FLARE	4.2			
195+38	RT	PE	3.3	6.4		32	4	4' FLARE	4.8			
196+76	RT	PE	4.8	11.0		46	4	4' FLARE	6.7			
197+23	LT	FE		6.0		38	4	4' FLARE	2.0			
198+26	RT	PE	3.3	7.5		32	4	4' FLARE	5.5			
199+18	RT	PE	3.5	7.5		34	4	4' FLARE	4.4			
200+23	RT	PE	9.9			30	19	EX. FLARE		3.7	2.0	
202+35	RT	SIDE ROAD	30.7			50	4	4' FLARE		12.5	3.9	
203+50	RT	PE	8.5			38	19	EX. FLARE		4.3	1.9	
208+03	RT	PE	3.3	7.7		32	4	4' FLARE	4.8			
210+70	RT	PE	24.2		41.0	106	19	EX. FLARE		24.7	8.9	
TOTAL			540.0	537.3	69.5				137.8	69.7	36.8	

* THE STATIONS AND QUANTITIES FOR ITEM "DRIVEWAY PAVEMENT REMOVAL" ARE THE SAME AS FOR "PCC DW PAVT 6."

ROUTE	SECTION	COUNTY	TOTAL SHEETS	SHEET NO.
FAS 806	14-00117-00-RS	LAWRENCE	13	4
CONTRACT NO. 95789		ILLINOIS	PROJECT RS-0806(110)	

SUMMARY OF HOT MIX ASPHALT	
OPERATION	QUANTITY
3/4 INCH NOMINAL LEVELING BINDER	4235
2 1/4 INCH BINDER COURSE	4290
2 3/4 INCH BINDER COURSE	1610
TOTAL BINDER COURSE	5900
1 1/4 INCH SURFACE COURSE	2180
1 1/2 INCH SURFACE COURSE	750
SIDEROADS AND PRIVATE ENTRANCES	540
MAILBOX TURNOUTS	135
TOTAL SURFACE COURSE	3605

SCHEDULE OF THERMOPLASTIC PAVEMENT MARKING - 4 INCH			
TYPE OF LINE	LENGTH		
CENTERLINE STRIPE (YELLOW)	1,090		
NPZ STRIPE (YELLOW)	17,560		
		18,650	TOTAL YELLOW
EDGE LINE (WHITE)	31,050		
		31,050	TOTAL WHITE
PROJECT TOTAL = 49,700 FOOT			

SCHEDULE OF NO PASSING ZONE PAVEMENT MARKINGS			
SOUTH BOUND - NO PASSING ZONE PAVEMENT MARKINGS		NORTH BOUND - NO PASSING ZONE PAVEMENT MARKINGS	
STATION TO STATION	LOCATION	LENGTH	
3+60 20+00	SOUTH BOUND	1640	18+00 35+90 NORTH BOUND 1790
37+70 55+60	SOUTH BOUND	1790	51+85 78+35 NORTH BOUND 2650
71+50 97+70	SOUTH BOUND	2620	87+65 98+00 NORTH BOUND 1035
107+20 110+62	SOUTH BOUND	345	164+25 189+20 NORTH BOUND 2495
176+55 208+50	SOUTH BOUND	3195	TOTAL 7,970 FOOT
TOTAL 9,590 FOOT			

PAVEMENT MARKING REMOVAL			
STATION	LOCATION	LENGTH	REMARKS
69+33 TO 109+30	CL STRIPING	330.0	
164+48	(STOP BAR)	24.0	
TOTAL 354.0 SQ. FT.			

CONCRETE HEADWALL REMOVAL			
STATION	LOCATION	EACH	REMARKS
40+17	LT	2	
51+11	RT	1	
55+06	RT	1	
164+55	RT	1	
167+52	LT	1	
169+54	LT	1	
189+84	LT	2	
192+77	RT	1	
197+01	RT	1	
198+26	RT	2	
200+27	RT	2	
202+17	RT	1	
TOTAL		16	EACH

SCHEDULE OF SIGNS AND SUPPORTS					
STATION	LOCATION	SIGN TO INSTALL	SIGN PANEL - TYPE 1 - SQ. FT.	TELE. ST. SIGN SUPPORT - FT.	
34+00	RT	R5-1102 (24 X 24)	4.0	17.0	
18+00	LT	W14-3 (NORTH BOUND)	6.0	17.0	
20+00	RT	W14-3 (SOUTH BOUND)	6.0	17.0	
51+85	LT	W14-3 (N.B.)	6.0	17.0	
55+60	RT	W14-3 (S.B.)	6.0	17.0	
87+65	LT	W14-3 (N.B.)	6.0	17.0	
97+70	RT	W14-3 (S.B.)	6.0	17.0	
109+42	LT	R5-1102 (24 X 24)	4.0	17.0	
110+62	RT	W14-3 (S.B.)	6.0	17.0	
164+25	LT	W14-3 (N.B.)	6.0	17.0	
164+36	RT	R1-1 (36 X 36)	9.0	16.0	
164+36	RT	R1-3P	0.8	-	
164+37	LT	R1-1 (36 X 36)	9.0	17.5	
164+37	LT	R1-3P	0.8	-	
164+48	LT	R1-1 (36 X 36)	9.0	16.0	
164+48	LT	R1-3P	0.8	-	
164+53	RT	REM. & RE-ERECT EX. SIGN (ST SIGN)	-	5.0	
164+56	LT	R1-1 (36 X 36)	9.0	16.0	
164+56	LT	R1-3P	0.8	-	
165+00	RT	R5-1102 (24 X 24)	4.0	17.0	
208+50	RT	W14-3 (S.B.)	6.0	17.0	
211+85	LT	R5-1102 (24 X 24)	4.0	17.0	

ROUTE	SECTION	COUNTY	TOTAL SHEETS	SHEET NO.
FAS 806	14-00117-00-RS	LAWRENCE	13	5
CONTRACT NO. 95789		ILLINOIS	PROJECT RS-0806(110)	

CLASS C PIPE CULVERT SCHEDULE
CORRUGATED ALUMINUM ALLOY PIPE

PIPE CULVERTS, CLASS C, TYPE 1 12"

STATION	OFFSET	REPL. LENGTH	REM. LENGTH
34+63	LT	20 FOOT	20 FOOT
35+72	LT	26 FOOT	26 FOOT
40+17	LT	50 FOOT	41 FOOT
40+30	RT	20 FOOT	20 FOOT
42+32	LT	20 FOOT	20 FOOT
62+16	RT	20 FOOT	20 FOOT
64+61	RT	20 FOOT	20 FOOT
65+91	LT	18 FOOT	18 FOOT
71+42	LT	32 FOOT	32 FOOT
75+17	RT	30 FOOT	30 FOOT
75+87	RT	22 FOOT	22 FOOT
82+41	LT	32 FOOT	31 FOOT
87+07	RT	20 FOOT	20 FOOT
89+76	RT	36 FOOT	36 FOOT
98+62	LT	40 FOOT	40 FOOT
100+01	LT	32 FOOT	32 FOOT
169+83	RT	56 FOOT	52 FOOT
172+67	LT	22 FOOT	22 FOOT
177+73	RT	36 FOOT	36 FOOT
181+18	LT	22 FOOT	22 FOOT
182+40	LT	20 FOOT	20 FOOT
182+64	LT	20 FOOT	20 FOOT
183+74	LT	20 FOOT	20 FOOT
184+43	LT	20 FOOT	20 FOOT
185+86	LT	20 FOOT	20 FOOT
186+13	LT	20 FOOT	20 FOOT
186+81	LT	20 FOOT	20 FOOT
187+14	LT	20 FOOT	20 FOOT
187+78	LT	20 FOOT	20 FOOT
188+28	LT	20 FOOT	20 FOOT
188+88	LT	20 FOOT	20 FOOT
189+84	LT	48 FOOT	32 FOOT
191+16	LT	44 FOOT	41 FOOT
195+25	RT	56 FOOT	56 FOOT
199+18	RT	30 FOOT	30 FOOT
200+27	RT	42 FOOT	37 FOOT
TOTAL		1014 FOOT	976 FOOT

PIPE CULVERTS, CLASS C, TYPE 1 15"

STATION	OFFSET	REPL. LENGTH	REM. LENGTH
27+39	LT	24 FOOT	23 FOOT
30+34	RT	20 FOOT	20 FOOT
32+49	RT	20 FOOT	19 FOOT
49+28	LT	30 FOOT	30 FOOT
60+91	RT	20 FOOT	20 FOOT
77+15	LT	22 FOOT	22 FOOT
88+04	RT	22 FOOT	22 FOOT
99+37	LT	24 FOOT	23 FOOT
107+96	RT	22 FOOT	21 FOOT
165+70	RT	48 FOOT	48 FOOT
171+77	LT	-	45 FOOT
191+06	RT	48 FOOT	46 FOOT
192+77	RT	46 FOOT	41 FOOT
194+70	RT	24 FOOT	24 FOOT
197+23	LT	26 FOOT	26 FOOT
198+26	RT	44 FOOT	32 FOOT
TOTAL		440 FOOT	462 FOOT

PIPE CULVERTS, CLASS C, TYPE 1 18"

STATION	OFFSET	REPL. LENGTH	REM. LENGTH
2+12	AR	52 FOOT	52 FOOT
28+91	LT	42 FOOT	42 FOOT
28+94	RT	38 FOOT	37 FOOT
48+53	LT	22 FOOT	21 FOOT
51+11	RT	28 FOOT	20 FOOT
55+06	RT	32 FOOT	25 FOOT
57+77	RT	32 FOOT	31 FOOT
58+83	RT	20 FOOT	20 FOOT
90+30	LT	28 FOOT	27 FOOT
109+39	RT	32 FOOT	30 FOOT
196+79	RT	52 FOOT	43 FOOT
202+38	RT	54 FOOT	43 FOOT
203+50	RT	30 FOOT	30 FOOT
TOTAL		462 FOOT	421 FOOT

PIPE CULVERTS, CLASS C, TYPE 1 21"

STATION	OFFSET	REPL. LENGTH	REM. LENGTH
5+37	LT	22 FOOT	21 FOOT
15+35	LT	24 FOOT	24 FOOT
TOTAL		46 FOOT	45 FOOT

PIPE CULVERTS, CLASS C, TYPE 1 24"

STATION	OFFSET	REPL. LENGTH	REM. LENGTH
23+64	RT	40 FOOT	40 FOOT
94+53	LT	26 FOOT	25 FOOT
210+70	RT	86 FOOT	85 FOOT
TOTAL		152 FOOT	150 FOOT

PIPE CULVERTS, CLASS C, TYPE 1 48"

STATION	OFFSET	REPL. LENGTH	REM. LENGTH
208+02	RT	20 FOOT	20 FOOT
TOTAL		20 FOOT	20 FOOT

MAILBOX TURNOUT SCHEDULE

STATION	LOCATION	TONS H.M.A.
5+23	LT	3.3
23+52	LT	3.3
28+72	LT	3.3
32+73	LT	3.3
34+47	LT	3.3
49+46	LT	2.8
54+88	LT	2.8
58+97	RT	2.8
61+11	RT	2.8
65+70	RT	2.8
70+42	RT	2.8
83+27	RT	2.8
86+74	RT	2.8
87+30	RT	2.8
87+87	RT	2.8
90+47	RT	2.8
92+89	RT	2.8
94+87	RT	2.8
99+93	RT	2.8
101+57	RT	2.8
108+42	RT	2.8
167+71	RT	2.8
168+77	RT	2.8
170+43	RT	2.8
171+41	RT	2.8
172+46	RT	2.8
176+04	RT	2.8
177+52	RT	2.8
179+96	RT	2.8
182+70	RT	2.8
184+65	RT	2.8
185+57	RT	2.8
187+34	RT	2.8
188+96	RT	2.8
189+61	RT	2.8
190+56	RT	2.8
191+31	RT	2.8
192+57	RT	2.8
195+19	RT	2.8
196+58	RT	2.8
198+07	RT	2.8
199+04	RT	2.8
200+09	RT	2.8
202+12	RT	2.8
207+76	RT	2.8
209+26	RT	2.8
210+15	RT	2.8
TOTAL		135 TON

SCHEDULE OF CLASS D PAVEMENT PATCHES

TYPE I, 16 INCH

STATION TO STATION	LOCATION	WIDTH	SQ YDS
11+49 11+54	LT	4'	3
33+13 33+31	LT	2'	4
164+45 164+49	RT	3'	2*
169+11 169+16	LT	2'	2
172+72 172+83	LT	3'	4
176+41 176+51	LT	3'	4
196+06 196+12	RT	4'	3
TOTAL			22 SQ. YD.

TYPE II, 16 INCH

STATION TO STATION	LOCATION	WIDTH	SQ YDS
8+50 8+88	RT	2.5'	11
13+65 13+77	RT	3.5'	5
14+78 15+02	LT	4'	11
16+99 17+08	RT	4.5'	5
25+42 25+56	LT	3.5'	6
32+85 33+13	LT	4.5'	14
33+31 33+45	LT	4'	7
33+90 33+99	RT	5'	5
36+43 36+56	RT	5.5'	8
164+38 164+41	RT	15'	5*
166+36 166+45	LT	4.5'	5
170+41 170+69	RT	4'	13
171+07 171+22	LT & RT	8'	14
171+26 171+40	LT	3'	5
171+55 171+75	LT & RT	4.5'	10
171+79 172+06	LT & RT	4.5'	14
172+51 172+66	LT	3'	5
173+38 173+66	LT	4'	13
177+62 177+92	RT	3.5'	12
177+68 177+92	LT	5'	14
179+27 179+43	RT	3'	6
180+62 180+86	LT	3'	8
182+78 183+06	LT & RT	3.5'	11
188+92 189+10	LT	3'	6
191+41 191+59	RT	6'	12
195+82 195+98	RT	5.5'	10
197+00 197+17	RT	6.5'	13
198+53 198+86	RT	3.5'	13
204+67 204+75	LT	5'	5
204+98 205+14	RT	4'	8
TOTAL			274 SQ. YD.

TYPE III, 16 INCH

STATION TO STATION	LOCATION	WIDTH	SQ YDS
2+09 2+15	AR	5'	20
5+97 6+34	LT	5'	21
12+68 13+12	RT	4'	20
26+14 26+39	RT	6'	17
27+72 28+16	RT	4'	20
167+00 167+51	RT	4'	21
169+45 169+93	LT & RT	3'	16
180+48 180+90	LT	4.5'	21
181+69 181+96	LT & RT	6'	18
197+30 197+69	RT	5'	22
199+90 200+23	RT	6'	22
202+54 202+80	RT	5'	15
TOTAL			233 SQ. YD.

TYPE IV, 16 INCH

STATION TO STATION	LOCATION	WIDTH	SQ YDS
2+88 3+37	RT	6'	33
8+46 8+99	LT	6'	36
11+70 12+15	LT	5.5'	28
35+68 36+12	RT	6'	30
164+31 164+91	LT	10'	67
167+82 168+40	LT	6'	39
169+97 170+83	LT & RT	8'	72
173+98 175+01	LT & RT	8'	86
176+44 177+32	RT	4'	35
198+92 199+56	LT	4.5'	32
200+84 202+93	LT & RT	6'	145
207+20 207+94	LT & RT	5'	36
209+78 210+15	LT	11'	46
209+78 210+15	RT	6'	25
210+84 211+42	LT	4'	26
TOTAL			736 SQ. YD.

TYPE II, 18 INCH

STATION TO STATION	LOCATION	WIDTH	SQ YDS
51+62 51+82	RT	5'	12
51+69 51+87	LT	6'	12
62+36 62+64	RT	4.5'	14
TOTAL			38 SQ. YD.

*PLACE PATCHES AT THESE LOCATIONS AS SOON AS C.L.S.M. HAS OBTAINED COMPRESSIVE STRENGTH TO MINIMIZE PARTIAL LANE CLOSURE. SEE SHEET 8 FOR MORE DETAIL.

SCHEDULE OF AREA CRACK CONTROL

STATION TO STATION	LOCATION	WIDTH	SQ YDS
54+35 54+91	RT	4'	25
191+97 192+73	LT	4'	34
200+12 200+68	LT	5'	32
206+02 206+38	RT	3'	12
TOTAL			103 SQ. YD.

SCHEDULE OF STRIP CRACK CONTROL

STATION TO STATION	LOCATION	LENGTH
52+39 52+39	AR	15'
61+39 61+79	RT	40'
168+62 168+99	RT	37'
175+05 175+17	LT	12'
178+63 179+07	RT	44'
180+56 180+63	LT	7'
180+85 181+70	LT	85'
192+96 192+96	AR	22'
197+74 197+99	RT	25'
198+08 198+93	LT	85'
200+46 202+20	RT	174'
202+70 202+94	LT	24'
203+26 203+87	CL	61'
206+49 209+05	RT	256'
207+93 208+05	LT	12'
208+31 208+58	CL	27'
209+19 209+74	RT	55'
210+70 211+19	RT	49'
TOTAL		1030'

ROUTE	SECTION	COUNTY	TOTAL SHEETS	SHEET NO.
FAS 806	14-00117-00-RS	LAWRENCE	13	6
CONTRACT NO. 95789		ILLINOIS	PROJECT RS-0806(110)	

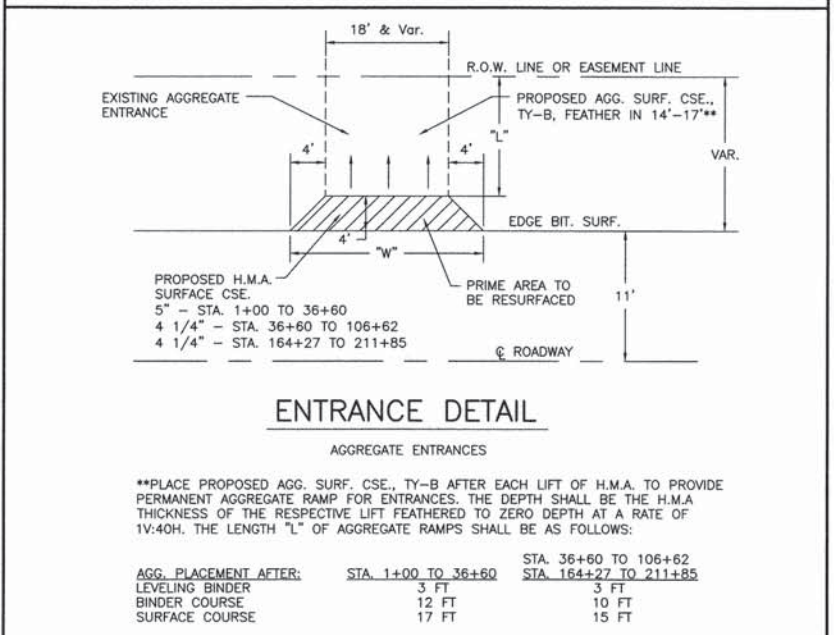
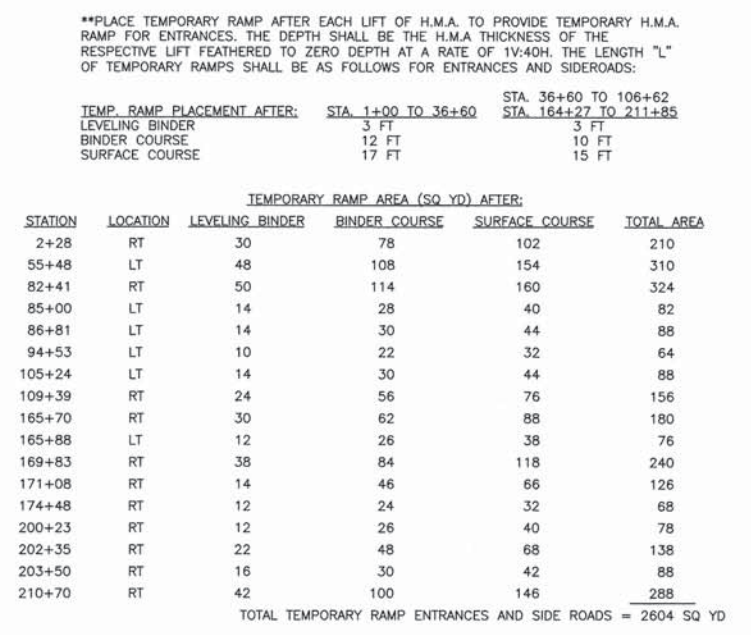
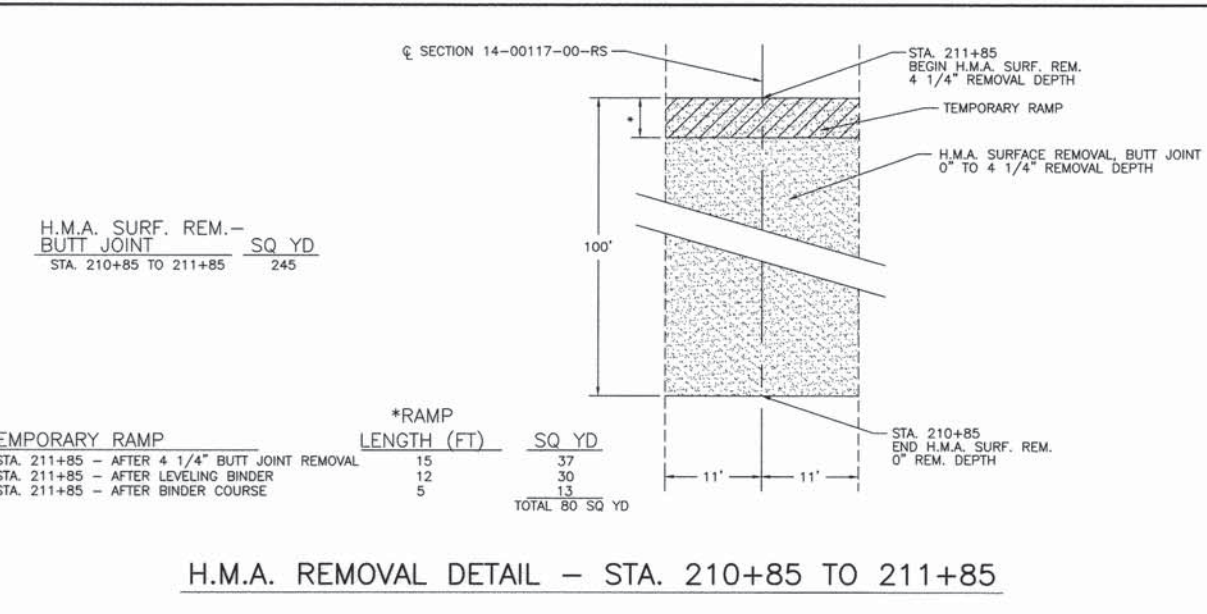
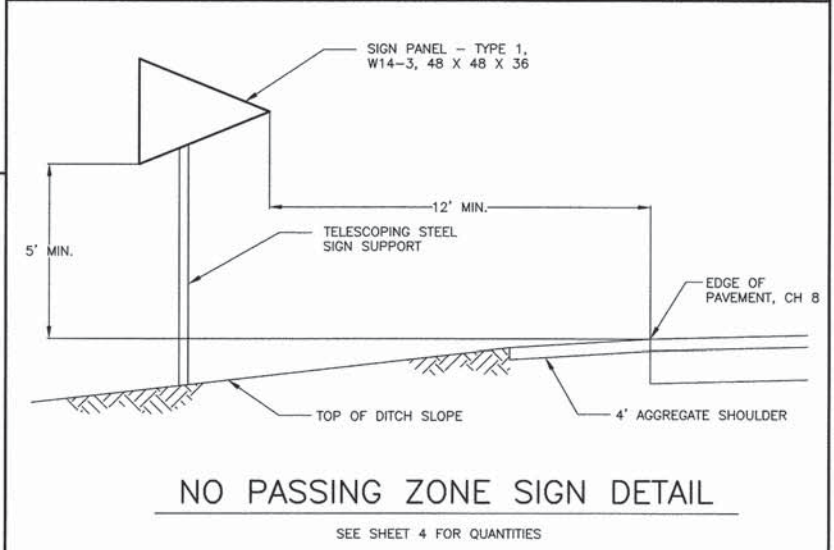
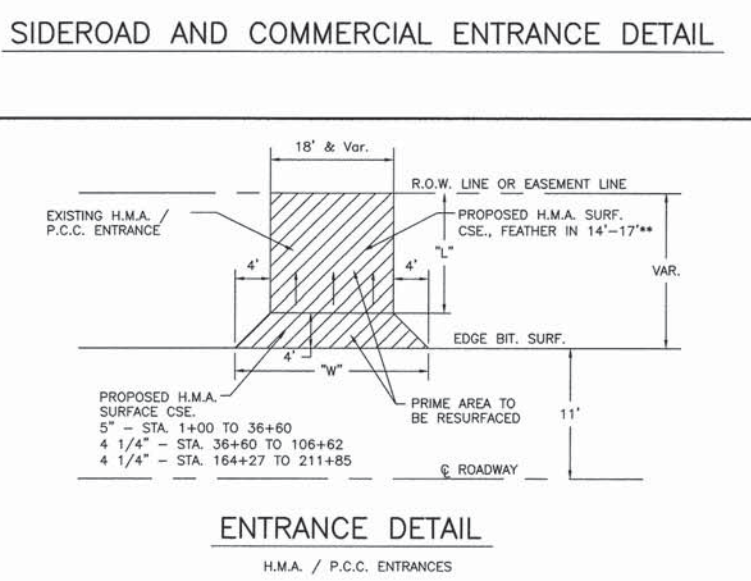
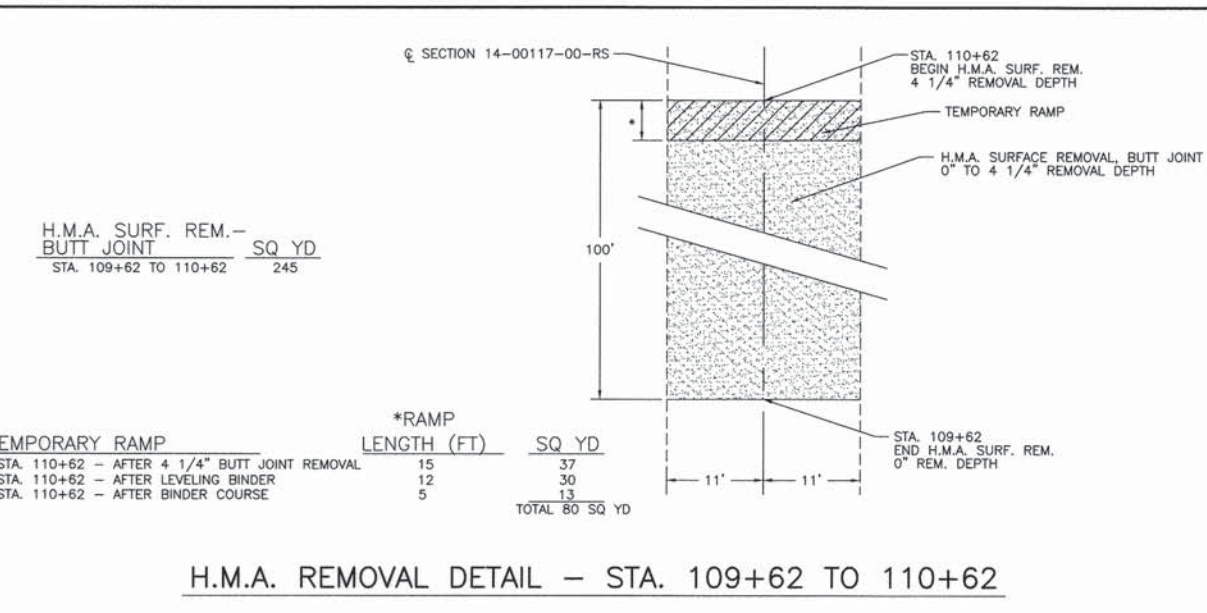
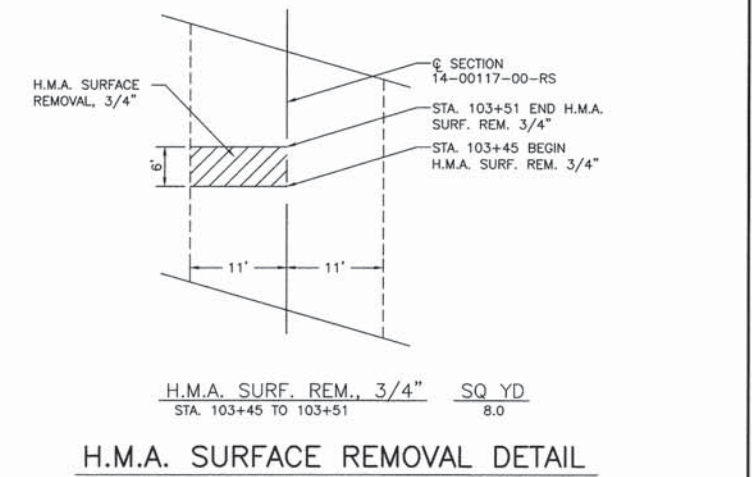
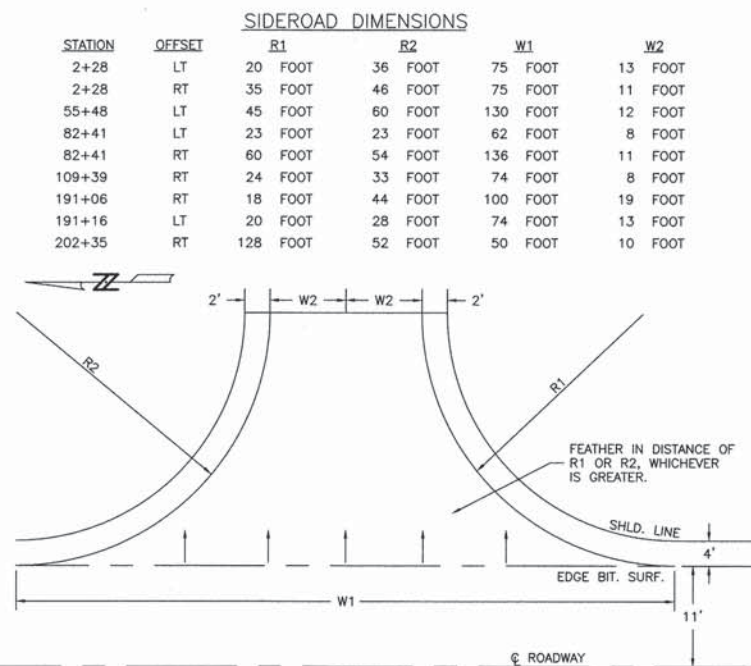
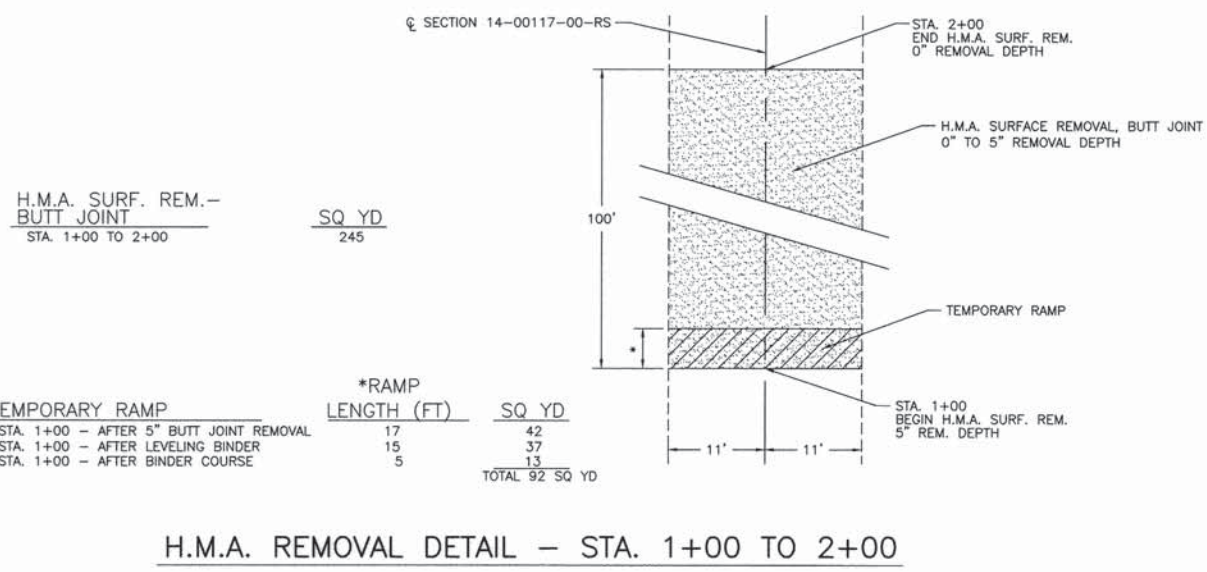

ROUTE	SECTION	COUNTY	TOTAL SHEETS	SHEET NO.
FAS 806	14-00117-00-RS	LAWRENCE	13	7
CONTRACT NO. 95789		ILLINOIS	PROJECT RS-0806(110)	

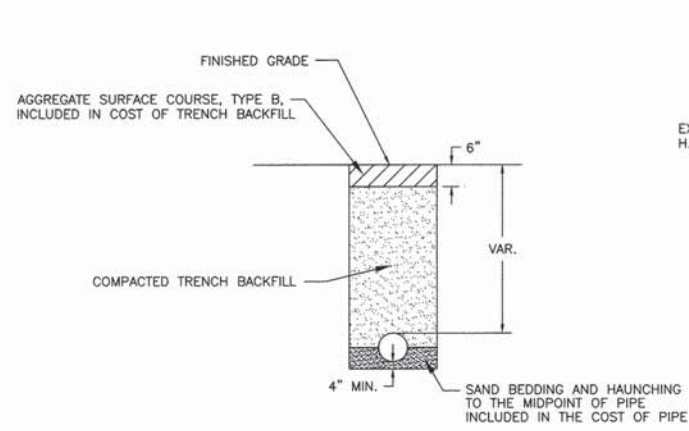

TRENCH DETAIL
THROUGH AGGREGATE SURFACES

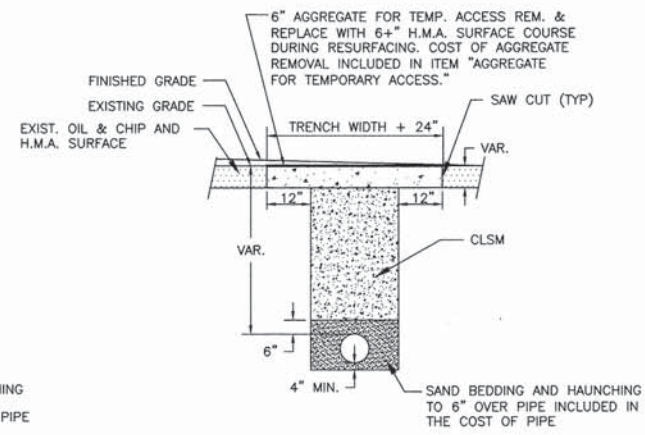

TRENCH DETAIL
THROUGH BITUMINOUS SURFACES

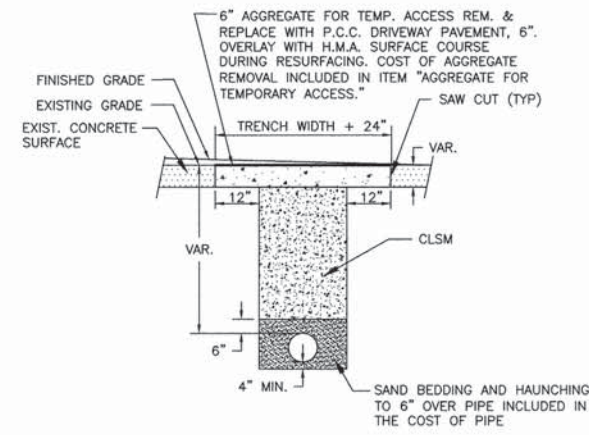

TRENCH DETAIL
THROUGH CONCRETE SURFACES

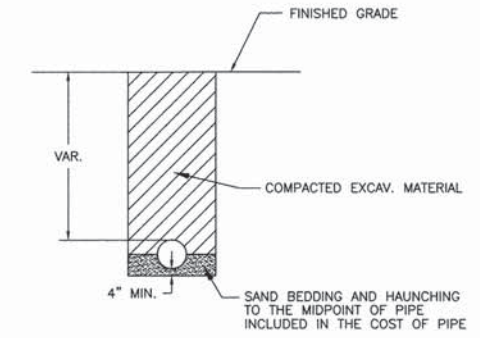

TRENCH DETAIL
THROUGH GRASS SURFACES

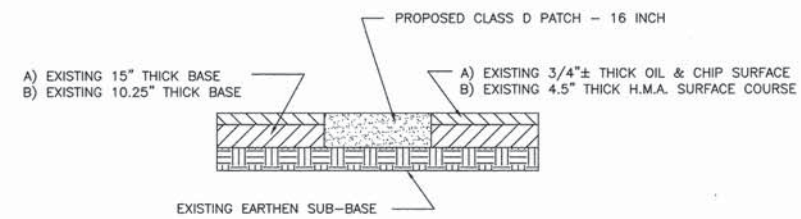

**STA. 1+00 TO 36+60 &
STA. 164+27 TO 211+85**
A) STA. 1+00 TO 36+00
B) STA. 164+27 TO 211+85

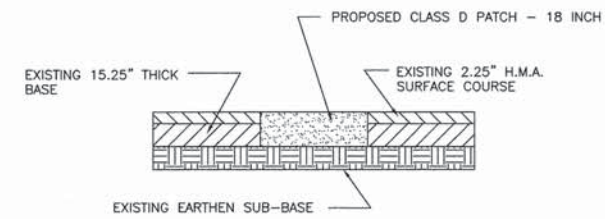

STA. 36+60 TO 69+33

PATCHING DETAIL

ROUTE	SECTION	COUNTY	TOTAL SHEETS	SHEET NO.
FAS 806	14-00117-00-RS	LAWRENCE	13	8
CONTRACT NO. 95789		ILLINOIS	PROJECT RS-0806(110)	

PAVEMENT REMOVAL	SQ YD
RT. STA. 164+39	5.0
RT. STA. 164+47	2.0
TOTAL	7.0 SQ YD
H.M.A. SURF. REM., BUTT JOINT	SQ YD
STA. 164+27 TO 165+62	455
TEMPORARY RAMP	SQ YD
STA. 164+27 (L=4' AFTER H.M.A. SURF. REM. BT. JT)	102
STA. 164+27 (L=10' AFTER LEVELING BINDER)	210
STA. 164+27 (L=15' AFTER BINDER COURSE)	300
TOTAL	610 SQ YD

ISLAND PAVEMENT (6")	SQ YD
LT. STA. 164+32 TO 164+44	4.5
GAS VALVE TO BE ADJUSTED	EACH
LT. STA. 164+40	1
LT. STA. 164+49	1
LT. STA. 164+58	1
TOTAL	3 EACH

REM. & RE-ERECT EXIST. SIGN	EACH
RT. STA. 164+53 (STREET SIGN)	1

WATER VALVES TO BE ADJUSTED	EACH
RT. STA. 164+57	1

REMOVE SIGN COMPLETE	EACH
LT. STA. 164+33	1
RT. STA. 164+36	1
LT. STA. 164+45	1
TOTAL	3 EACH

COMB. CONC. C&G, TYPE B-6.24	FOOT
LT. STA. 164+34 TO 164+95**	95.0
RT. STA. 164+38 TO 164+74**	70.0
TOTAL	165.0 FOOT

EARTH EXCAVATION WIDENING	CU YD
LT. & RT. STA. 164+26 TO 165+33	130

COMB. CONC. C&G, TYPE M-6.06	FOOT
LT. STA. 164+32 TO 164+44	12.0

H.M.A. BASE CSE. WIDENING, 14"	SQ YD
LT. & RT. STA. 164+27 TO 165+33	305

COMB. CONC. C&G, TYPE M-6.24	FOOT
LT. STA. 164+32 TO 164+44	22.0

AGG. BASE COURSE, TYPE B	TON
LT. STA. 164+32 TO 164+44 (ISLAND)	5.0
LT. STA. 164+32 TO 164+97 (C&G)*	12.0
RT. STA. 164+36 TO 164+75 (C&G)*	18.0
TOTAL	35.0 TONS

THERMOPLASTIC PAVEMENT MARKING - LINE 12"	FOOT
LT. STA. 164+32 TO 164+44	40.0

THERMOPLASTIC PAVEMENT MARKING - LINE 24"	FOOT
LT. STA. 164+36	11.0
LT. STA. 164+36 TO 164+51	23.0
RT. STA. 164+33	10.0
TOTAL	44.0 FOOT

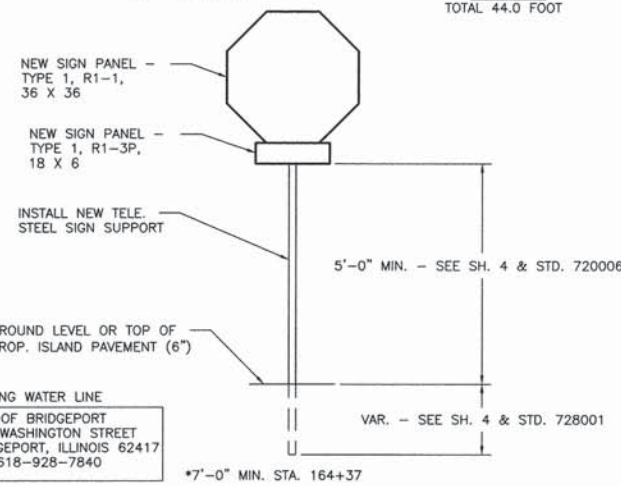
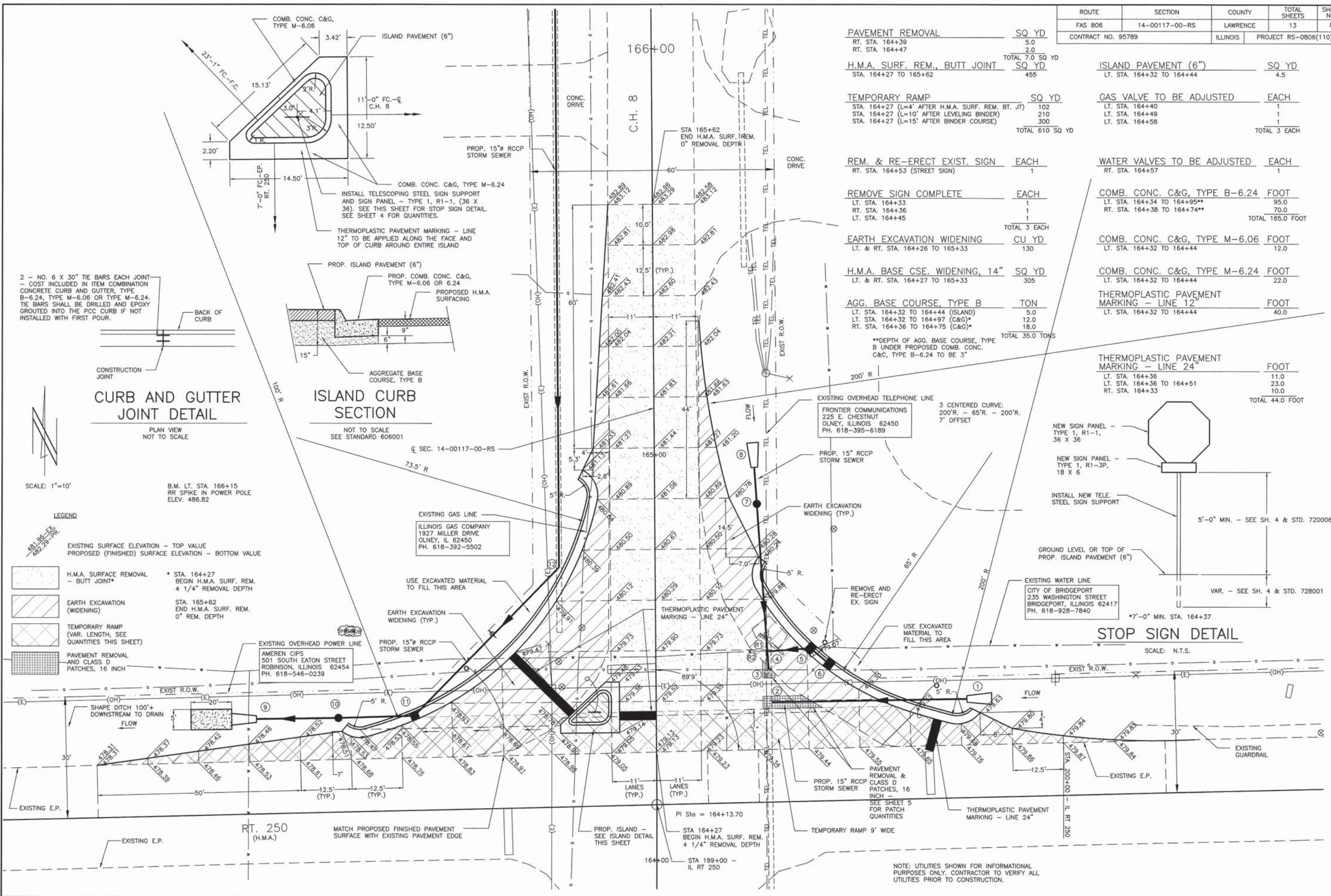

SCALE: 1"=10'

B.M. LT. STA. 166+15
RR SPIKE IN POWER POLE
ELEV. 486.82

- LEGEND**
- EXISTING SURFACE ELEVATION - TOP VALUE
PROPOSED (FINISHED) SURFACE ELEVATION - BOTTOM VALUE
 - H.M.A. SURFACE REMOVAL - BUTT JOINT*
 - EARTH EXCAVATION (WIDENING)
 - TEMPORARY RAMP (VAR. LENGTH, SEE QUANTITIES THIS SHEET)
 - PAVEMENT REMOVAL AND CLASS D PATCHES, 16 INCH
 - * STA. 164+27 BEGIN H.M.A. SURF. REM. 4 1/4" REMOVAL DEPTH
 - STA. 165+62 END H.M.A. SURF. REM. 0" REM. DEPTH

NOTE: UTILITIES SHOWN FOR INFORMATIONAL PURPOSES ONLY. CONTRACTOR TO VERIFY ALL UTILITIES PRIOR TO CONSTRUCTION.

ROUTE	SECTION	COUNTY	TOTAL SHEETS	SHEET NO.
FAS 806	14-00117-00-RS	LAWRENCE	13	9
CONTRACT NO. 95789		ILLINOIS	PROJECT RS-0806(110)	

STORM SEWERS - CLASS A				
LOCATION	TY-1,12"	TY-1,15"	TR.B'FILL	C.L.S.M.
1 TO 2		48		10.4
3 TO 7		40		10.4
4 TO 5		10		3.9
5 TO 6		8		2.4
7 TO 8		8		
9 TO 11		38		4.5
11 TO 12		50		3.5
12 TO 13		174		3.1
13 TO 14		31	3.6	
14 TO 15		10	8.3	
15 TO 16		62	9.9	
16 TO 17		82		
17 TO 18		42	27.0	
18 TO 19				
20 TO 21	41			6.1
21 TO 22	332			2.3
23 TO 24	98			
24 TO 25	2		6.3	
24 TO 26	110		2.5	
26 TO 27	108		7.8	
27 TO 28	168		24.4	
29 TO 30	176		28.6	
30 TO 31	3		21.3	
30 TO 32	61		6.4	
TOTALS	1099	911	146.1	46.6

DRAINAGE STRUCTURES							
NO.	DIST.	STA.	ITEM	GR.	INV.	INV. U.S.	INV. D.S.
1	74' RT.	164+40	P.R.C.F.E.S. 15"	-	-	477.89	-
2	28' RT.	164+39	PROPOSED STORM SEWER CONNECTION TO EXISTING STORM SEWER	-	476.11	-	-
3	28' RT.	164+47	CONCRETE COLLAR	-	476.19	-	-
4	28' RT.	164+52	REINFORCED CONCRETE PIPE TEE, 15" PIPE WITH 15" RISER	-	476.34	-	-
5	38' RT.	164+53	INLETS, TYPE A, TYPE 11 FRAME AND GRATE	478.95	-	476.53	476.43
6	43' RT.	164+49	INLETS, TYPE A, TYPE 11 FRAME AND GRATE	478.95	-	-	476.57
7	25' RT.	164+88	INLETS, TYPE A, TYPE 8 GRATE	480.25	-	477.58	477.48
8	24' RT.	165+01	P.R.C.F.E.S. 15"	-	-	478.00	-
9	104' LT.	164+35	P.R.C.F.E.S. 15"	-	-	-	475.17
10	78' LT.	164+36	INLETS, TYPE A, TYPE 8 GRATE	478.15	475.75	-	-
11	58' LT.	164+36	INLETS, SPECIAL, NO. 1	478.43	476.16	-	-
12	24' LT.	164+72	PIPE ELBOW, 15"	-	477.64	-	-
13	24' LT.	166+46	MANHOLES, TY-A, 4'-DIAMETER, TY-8 GR	484.25	-	482.19	482.09
14	23' LT.	168+58	INLETS, TYPE A, TYPE 8 GRATE	490.95	-	487.36	487.26
15	23' LT.	168+90	INLETS, TYPE A, TYPE 8 GRATE	491.25	-	488.15	488.05
16	23' LT.	170+02	MANHOLES, TYPE A, 4'-DIAMETER, TYPE 1 FRAME, OPEN LID	493.97	-	490.77	490.67
17	23' LT.	170+66	INLETS, TYPE A, TYPE 8 GRATE	494.44	-	492.29	492.19
18	23' LT.	171+49	INLETS, TYPE A, TYPE 8 GRATE	495.89	-	494.24	494.14
19	23' LT.	171+98	P.R.C.F.E.S. 15"	-	-	496.16	-
20	21' RT.	170+82	P.R.C.F.E.S. 12"	-	-	-	495.00
21	21' RT.	171+29	INLETS, TYPE A, TYPE 8 GRATE	496.60	-	495.38	495.28
22	21' RT.	174+67	P.R.C.F.E.S. 12"	-	-	502.35	-
23	23' LT.	173+50	P.R.C.F.E.S. 12"	-	-	-	500.35
24	24' LT.	174+54	REINFORCED CONCRETE PIPE TEE, 12" PIPE WITH 12" RISER	-	500.89	-	-
25	26' LT.	174+54	INLETS, TYPE A, TYPE 8 GRATE	503.95	-	500.93 ***	500.91
26	24' LT.	175+65	MANHOLES, TYPE A, 4'-DIAMETER, TYPE 1 FRAME, OPEN LID	505.65	-	501.56	501.46
27	25' LT.	176+76	INLETS, TYPE A, TYPE 8 GRATE	506.75	-	502.22	502.12
28	25' LT.	178+50	P.R.C.F.E.S. 12"	-	-	503.12	-
29	26' LT.	178+55	P.R.C.F.E.S. 12"	-	-	-	503.15
30	25' LT.	180+36	REINFORCED CONCRETE PIPE TEE, 12" PIPE WITH 12" RISER	-	504.24	-	-
31	22' LT.	180+36	INLETS, TYPE A, TYPE 8 GRATE	506.55	-	-	504.26
32	25' LT.	181+03	P.R.C.F.E.S. 12"	-	-	504.64	-

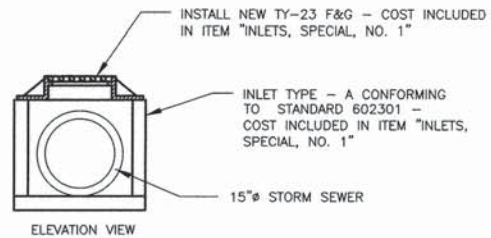
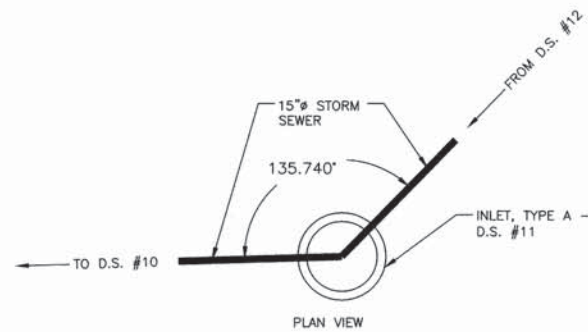

INLETS, SPECIAL, NO. 1
LT. STA. 164+36

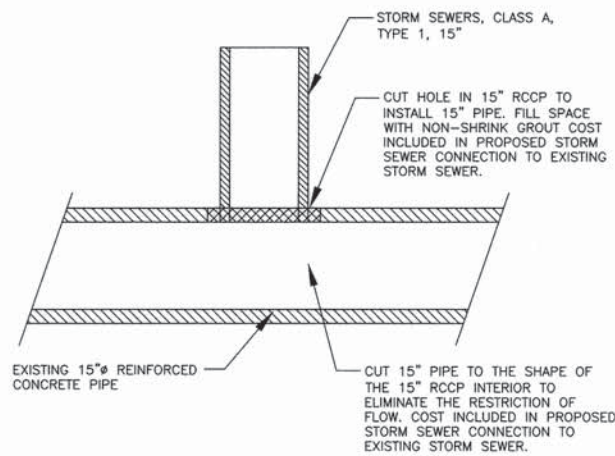

PROPOSED STORM SEWER CONNECTION TO EXISTING STORM SEWER DETAIL

PLAN VIEW
RT. STA. 164+39

DRAINAGE STRUCTURE REMOVAL							
NO.	DIST.	STA.	ITEM	TR.B'FILL	C.L.S.M.	FOOT	EACH
R1	28' RT.	164+55	CONCRETE HEADWALL REMOVAL	-	4.0	-	1.0
R2	28' RT.	164+48	STORM SEWER REMOVAL 15"	-	-	8.0	-
R3	22' LT.	166+69	REMOVAL OF EXISTING STRUCTURES NO. 1	1.0	-	-	1.0
R4	23' LT.	170+66	REMOVAL OF EXISTING STRUCTURES NO. 2	1.0	-	-	1.0
R5	21' RT.	171+29	REMOVAL OF EXISTING STRUCTURES NO. 3	1.0	-	-	1.0
R6	26' LT.	174+54	REMOVAL OF EXISTING STRUCTURES NO. 4	-	1.0	-	1.0
TOTAL				3.0	5.0		

*PIPE ELBOW, 15" - PLAN DEFLECTION ANGLE FROM D.S. #13 TO D.S. #11 IS 45'

**PIPE DRAINS 4"

(QUANTITY INCLUDED IN CONCRETE HEADWALL REMOVAL - SEE SHEET 4)
(QUANTITY INCLUDED IN STORM SEWER REMOVAL 15" - SEE SHEET 10)

NOTE: SEE SHEETS 8, 10-12 FOR DRAINAGE STRUCTURES ON PLAN SHEETS

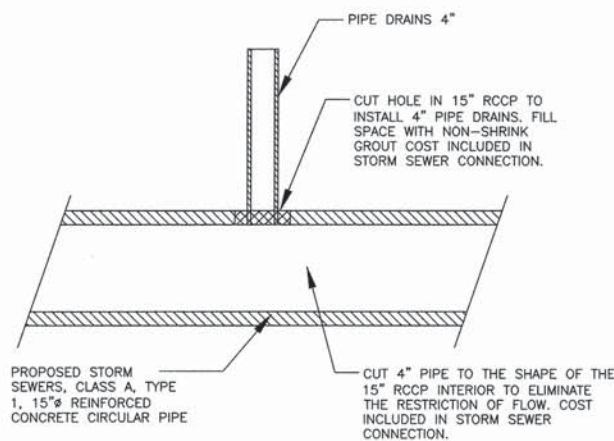

STORM SEWER CONNECTION DETAIL

PLAN VIEW
SEE SHEETS 11-13 FOR LOCATIONS

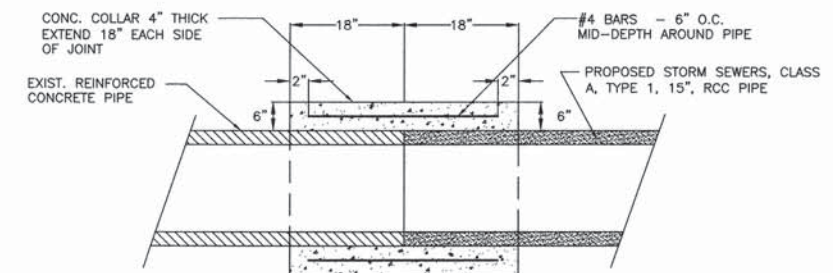

CONCRETE COLLAR DETAIL

RT. STA. 164+47

ROUTE	SECTION	COUNTY	TOTAL SHEETS	SHEET NO.
F.A.S. 806	14-00117-00-RS	LAWRENCE	13	10
CONTRACT NO. 95789		ILLINOIS	PROJECT RS-0806(110)	

SCALES:
 1" = 20' HOR
 1" = 5' VER

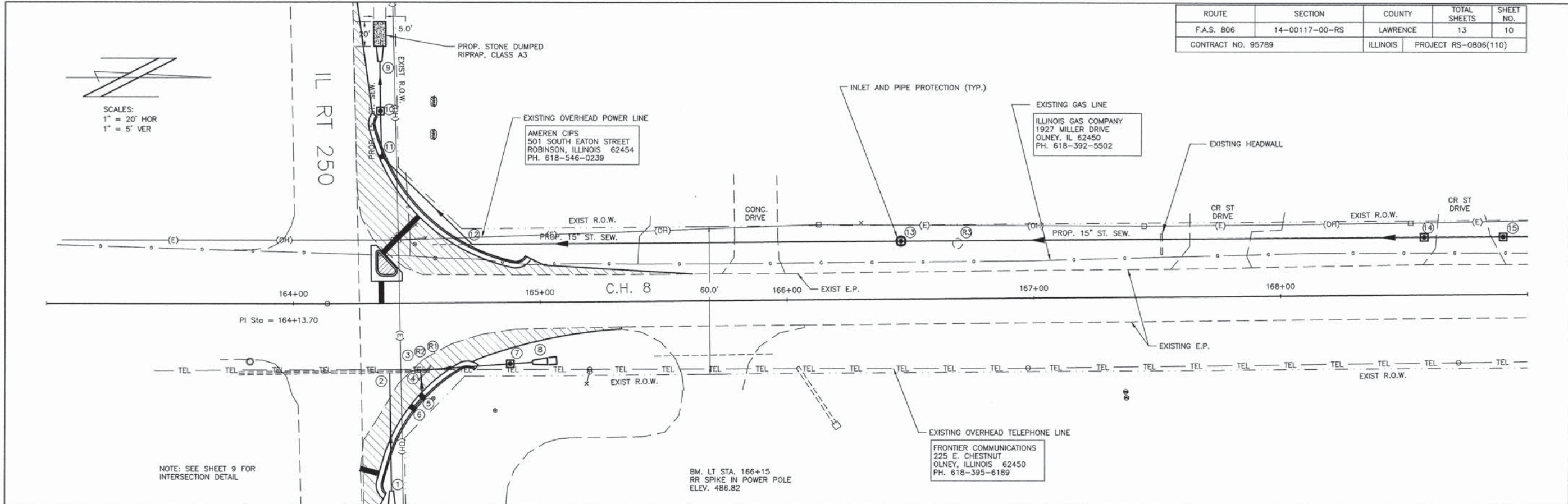

STATION	DESCRIPTION	UNIT	AMOUNT	STATION	DESCRIPTION	UNIT	AMOUNT
505	STORM SEWER REMOVAL 15"	FOOT	8	505	STONE DUMPED RIPRAP, CLASS A3	TON	10
	RT. STA. 164+48 (D.S. REMOVAL #R2)		444		LT. STA. 164+35		6.0
	LT. STA. 164+56 TO 169+00		TOTAL 452 EACH				6.0
500	INLET AND PIPE PROTECTION	EACH	12	500	SEEDING, CLASS 1 (SPECIAL)	ACRE	0.11
	LT. STA. 164+36 (D.S. #10)		1		STA. 164+26 TO 169+00		1.0
	RT. STA. 164+40 (D.S. #1)		1				1.0
	RT. STA. 164+88 (D.S. #7)		1				TOTAL 2.0 EACH
	RT. STA. 165+03 (D.S. #8)		1				
495	LT. STA. 166+46 (D.S. #13)		1				
	LT. STA. 168+58 (D.S. #14)		1				
	LT. STA. 168+90 (D.S. #15)		TOTAL 7 EACH				

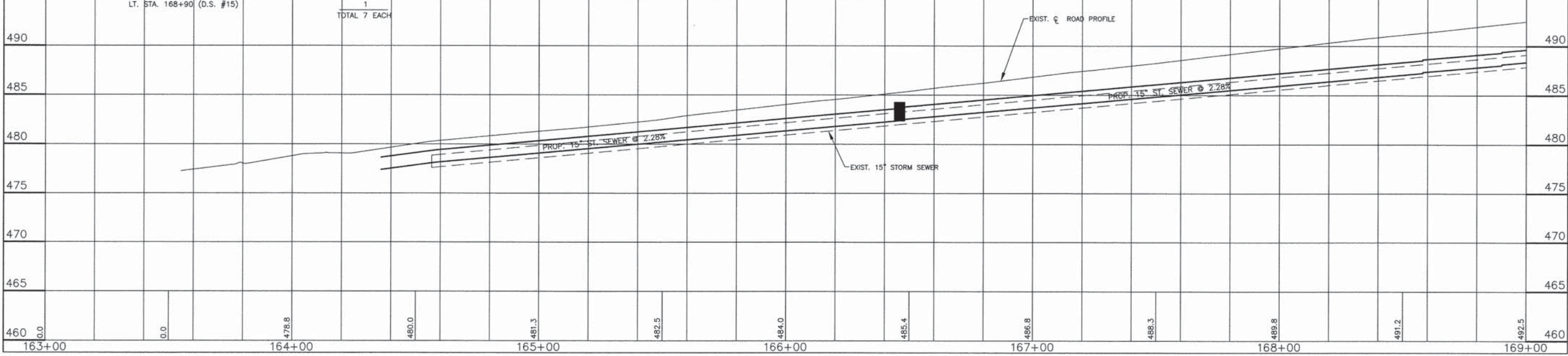

ROUTE	SECTION	COUNTY	TOTAL SHEETS	SHEET NO.
F.A.S. 806	14-00117-00-RS	LAWRENCE	13	11
CONTRACT NO. 95789		ILLINOIS	PROJECT RS-0806(110)	

 SCALES:
 1" = 20' HOR
 1" = 5' VER

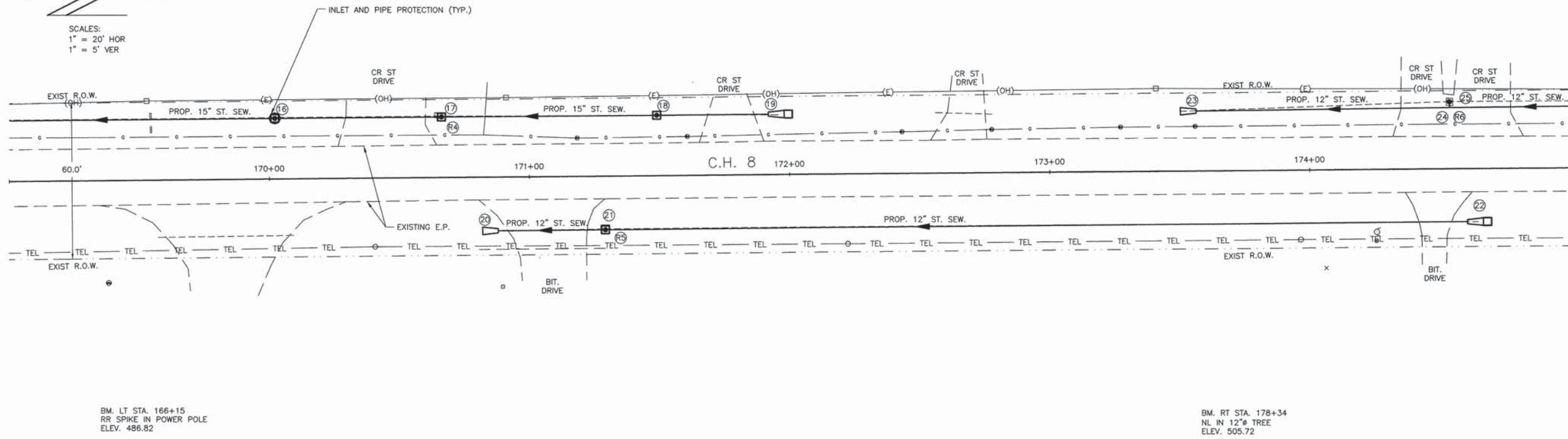

STATION	DESCRIPTION	UNIT	AMOUNT	STATION	DESCRIPTION	UNIT	AMOUNT	STATION	
515	STORM SEWER REMOVAL 12"	FOOT		515	PIPE DRAINS 4"	FOOT		515	
	LT. STA. 170+88 TO 174+65		377		LT. STA. 169+12		6.0		
	LT. STA. 173+50 TO 175+00		150		LT. STA. 170+12		6.0		
	TOTAL 527 FOOT				RT. STA. 172+48		6.0		
510	STORM SEWER REMOVAL 15"	FOOT			LT. STA. 174+16		6.0	510	
	LT. STA. 169+00 TO 171+49		249		TOTAL 24.0 FOOT				
505	INLET AND PIPE PROTECTION	EACH		505	STORM SEWER CONNECTION	EACH		505	
	LT. STA. 170+02 (D.S. #16)		1		LT. STA. 169+12		1.0		
	LT. STA. 170+66 (D.S. #17)		1		LT. STA. 170+12		1.0		
	LT. STA. 171+49 (D.S. #18)		1		RT. STA. 172+48		1.0		
	LT. STA. 171+98 (D.S. #19)		1		LT. STA. 174+16		1.0		
	RT. STA. 171+29 (D.S. #21)		1		TOTAL 4.0 EACH				
	RT. STA. 174+67 (D.S. #22)		1						
	TOTAL 6 EACH								
500				500	PROP. 12" ST. SEWER @ 0.52%			500	
495				495	PROP. 12" ST. SEWER @ 2.07%			495	
490				490	EXIST. 12" STORM SEWER			490	
485				485				485	
480				480				480	
475				475				475	
470				470				470	
169+00	492.5			170+00	494.9			171+00	497.2
	493.7				496.1				498.3
					497.2				499.5
					498.3				500.7
					499.5				501.7
					500.7				503.0
					501.7				503.6
					503.0				504.3
					503.6				505.0
					504.3				505.0

ROUTE	SECTION	COUNTY	TOTAL SHEETS	SHEET NO.
FAS 806	14-00117-00-RS	LAWRENCE	13	13
CONTRACT NO. 95789		ILLINOIS	PROJECT RS-0806(110)	

LEGEND

- ▼ G20-1100 - NO PASSING ZONES NOT STRIPED NEXT 2 MILES
- ◆ G20-1100 - NO PASSING ZONES NOT STRIPED NEXT 1 MILES
- ROAD CONSTRUCTION AHEAD
- ▲ ROAD CONSTRUCTION AHEAD WITH W1-6 SIGN POINTING NORTH
- ROAD CONSTRUCTION AHEAD WITH W1-6 SIGN POINTING SOUTH
- ① ROAD CONSTRUCTION AHEAD 1 MILE
- ② ROAD CONSTRUCTION AHEAD 2 MILES
- ③ ROAD CONSTRUCTION AHEAD 5 1/2 MILES

SECTION 14-00117-00-RS ENDS STA. 211+85.00

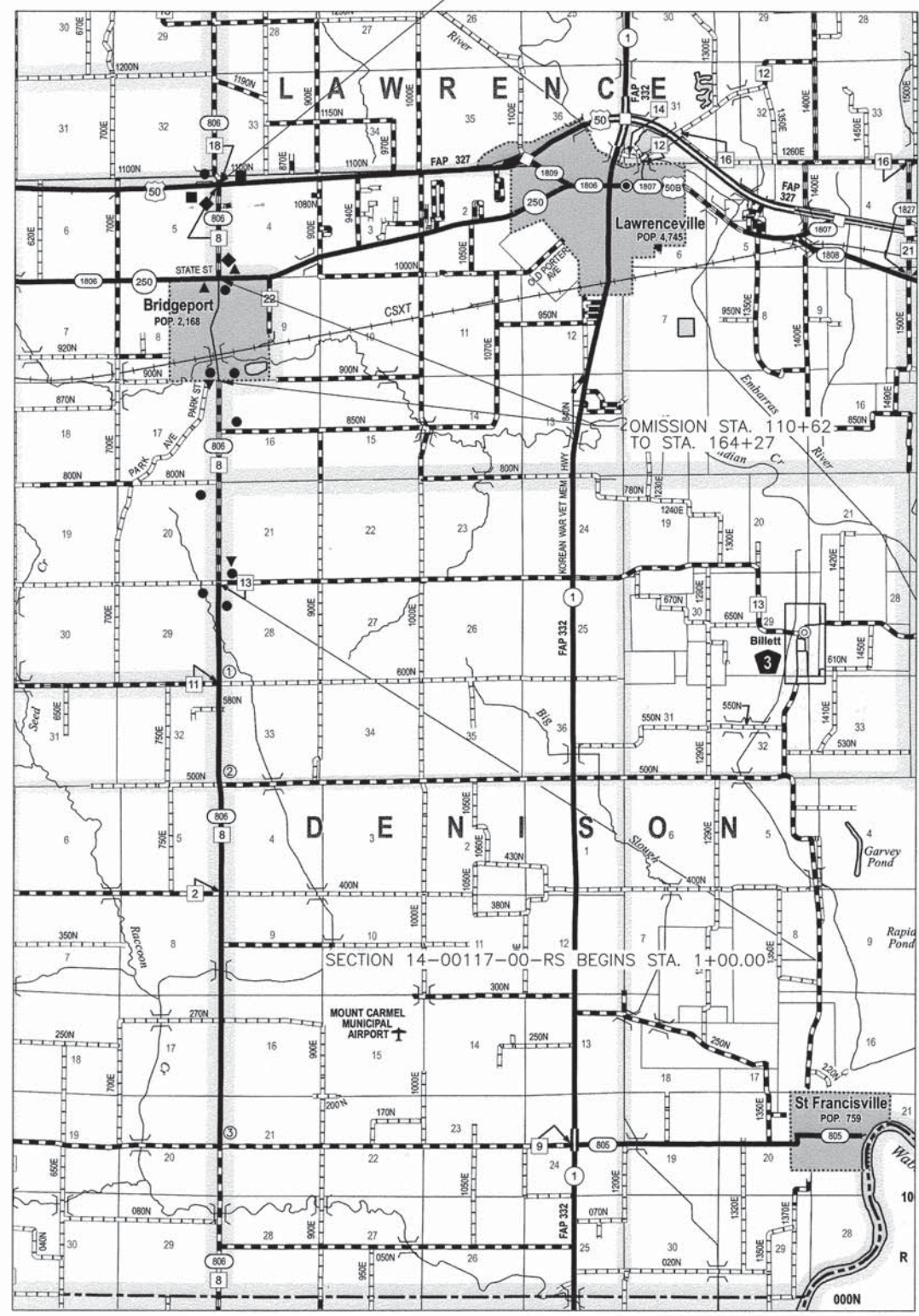

TRAFFIC CONTROL PLAN