

INDEX OF SHEETS

SHEET NO. DESCRIPTION

1	COVER SHEET
2	INDEX OF SHEETS, GENERAL NOTES, AND SUMMARY OF QUANTITIES
3	PROPOSED PAVING PLAN

GENERAL NOTES

- BEFORE STARTING ANY EXCAVATION, THE CONTRACTOR SHALL CALL "C.U.A.N" (CHICAGO UTILITY ALERT NETWORK) AT (312) 744-700 FOR FIELD LOCATIONS OF BURIED ELECTRIC, TELEPHONE AND GAS FACILITIES. 48-HOUR NOTIFICATION IS REQUIRED.
- THE CONTRACTOR WILL NOT BE ALLOWED TO SET UP A YARD OR FIELD OFFICE ON STATE PROPERTY WITHOUT WRITTEN PERMISSION FROM THE DEPARTMENT.
- ALL DAMAGE TO EXISTING PAVEMENT AND APPURTENANCES SHALL BE REPLACED AT THE CONTRACTOR'S EXPENSE.
- IT SHALL BE THE CONTRACTOR'S RESPONSIBILITY TO VERIFY ALL DIMENSIONS AND CONDITIONS IN THE FIELD PRIOR TO CONSTRUCTION AND ORDERING OF MATERIALS.
- DO NOT SCALE PLANS FOR CONSTRUCTION DIMENSIONS.
- THE CONTRACTOR SHALL COORDINATE CONSTRUCTION ACTIVITIES WITH UTILITY COMPANIES AND THE CITY OF CHICAGO

SP	CODE NO.	ITEM	UNIT	TOTAL QUANTITY	URBAN 0005 100% STATE
	35101582	AGGREGATE BASE COURSE, TYPE B, 2"	SQ YD	7,608	7,608
	35800100	PREPARATION OF BASE	SQ YD	7,608	7,608
	35800200	AGGREGATE BASE REPAIR	TON	40	40
	40600275	BITUMINOUS MATERIALS (PRIME COAT)	POUND	17,118	17,118
	40600290	BITUMINOUS MATERIALS (TACK COAT)	POUND	1,712	1,712
	35501300	HOT-MIX ASPHALT BASE COURSE, 4"	SQ YD	7,608	7,608
	40603340	HOT-MIX ASPHALT SURFACE COURSE, MIX "D", N70	TON	852	852
	67100100	MOBILIZATION	LSUM	1	1

HOT-MIX ASPHALT REQUIREMENTS

MIXTURE TYPE	AIR VOIDS @ NDES	QUALITY MANAGEMENT PROGRAM (QMP)
HMA SURFACE COURSE, "MIX D", N70 (IL 9.5mm) 2"	4% @ 70 GYR	OCP
HMA BASE COURSE (HMA BINDER IL-19.0) 4"	4% @ 70 GYR	OCP

QMP DESIGNATIONS: QUALITY CONTROL FOR PERFORMANCE (OCP)

NOTES:

- THE UNIT WEIGHT USED TO CALCULATE ALL HMA MIXTURE QUANTITIES IS 112 LBS/SOYD/IN.
- FOR NON-POLYMERIZED HMA THE "AC TYPE" SHALL BE "PG 64 -22" UNLESS MODIFIED BY DISTRICT ONE SPECIAL PROVISIONS.
- FOR USE OF RECYCLED MATERIALS SEE DISTRICT ONE SPECIAL PROVISIONS.
- QUALITY MANAGEMENT PROGRAM (QMP) IDENTIFIES THE PARTICULAR QUALITY CONTROL SPECIFICATION THAT APPLIES TO THE HMA MIXTURE.
- THE DENSITY FOR THE MIXES ON THE HMA REQUIREMENTS TABLE WILL BE ASSIGNED 100% PAY FACTOR, AND BE TESTED RANDOMLY AT THE FREQUENCY REQUIRED IN THE HMA-QUALITY CONTROL FOR PERFORMANCE SPECIAL PROVISION, AND SHALL MEET MINIMUM QA/QC REQUIREMENTS IN ACCORDANCE WITH ART. 1030 OF THE STANDARD SPECIFICATIONS

FILE NAME = ...290MaintenanceYard-shr-index.dgn	USER NAME = ehmadn	DESIGNED - DRAWN - CRV	REVISED - REVISED -	STATE OF ILLINOIS DEPARTMENT OF TRANSPORTATION	I-290 MAINTENANCE YARD (RESURFACING) INDEX OF SHEETS, GENERAL NOTES, SUMMARY OF QUANTITIES		F.A.I. RTE. 290	SECTION 2015-55RS	COUNTY COOK	TOTAL SHEETS 3	SHEET NO. 2	
PLOT SCALE = 20.0000' / 1"	CHECKED -	REVISED -	REVISED -		SCALE:	SHEET OF SHEETS	STA. TO STA.	ILLINOIS FED. AID PROJECT CONTRACT NO. 62B21				
PLOT DATE = 3/23/2016	DATE - 1/25/2016	REVISED -	REVISED -									

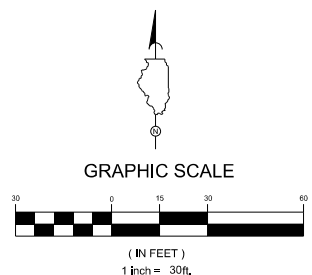

LEGEND AND ABBREVIATIONS:

- — — — — PROPERTY LINE
- - - - - LIMITS OF WORK
- [Pattern: Dotted] CONCRETE PAVEMENT AND BASE (N.I.C.)
- [Pattern: Stippled] CONCRETE WALK AND BASE (N.I.C.)
- [Pattern: Dotted with dots] 2" HMA SURFACE COURSE, MIX D, N70
4" HMA BASE COURSE
2" AGGREGATE BASE COURSE, TYPE "B"
- [Pattern: Solid Grey] NEW BUILDING (N.I.C.)
- [Pattern: Dashed] CONCRETE CURB AND GUTTER (N.I.C.)
- [Pattern: Solid Grey with line] CONCRETE BARRIER CURB (N.I.C.)
- [Pattern: Dashed with line] DEPRESSED CURB (N.I.C.)

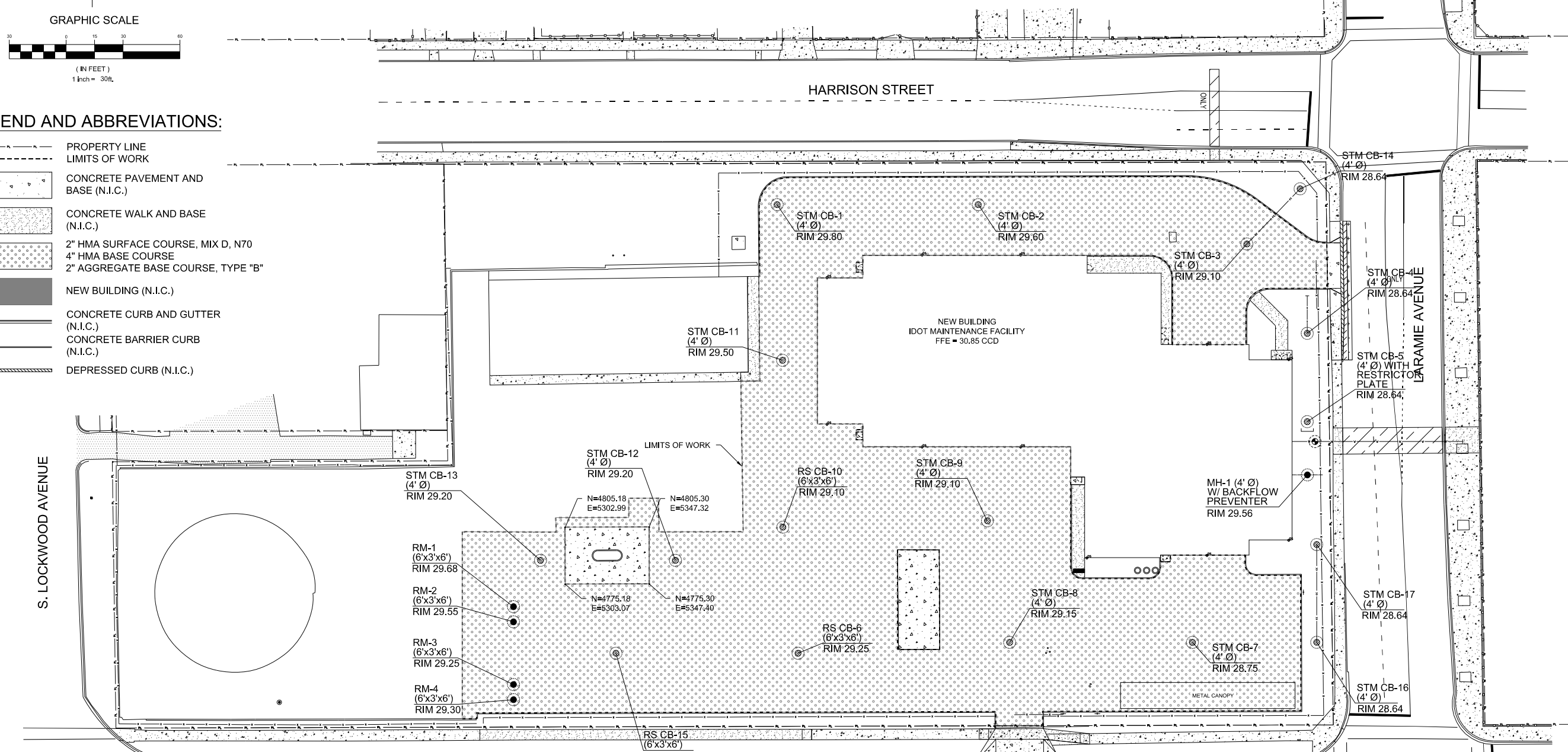

PAVEMENT DETAIL

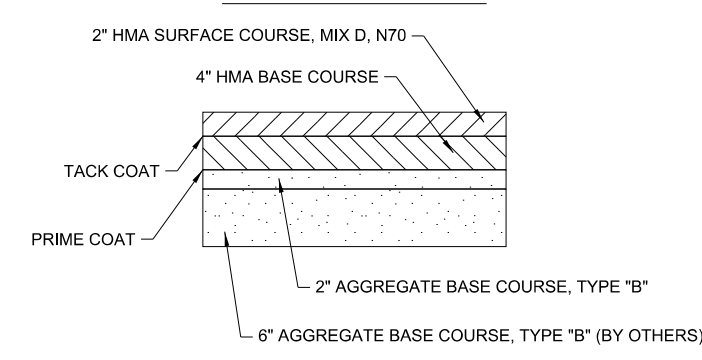

FILE NAME = ... \290MaintenanceYard\sh-paving.dgn	USER NAME = ahmadn	DESIGNED - _____	REVISED - _____
Default	PLOT SCALE = 60.0000' / in.	DRAWN - CRV	REVISED - _____
	PLOT DATE = 3/23/2016	CHECKED - _____	REVISED - _____
		DATE - 1/25/2016	REVISED - _____

**STATE OF ILLINOIS
DEPARTMENT OF TRANSPORTATION**

**I-290 MAINTENANCE YARD (RESURFACING)
PROPOSED PAVING PLAN**

1" = 30' SHEET 3 OF 3 SHEETS STA. _____ TO STA. _____

F.A.I. RTE.	SECTION	COUNTY	TOTAL SHEETS	SHEET NO.
290	2015-55RS	COOK	3	3
CONTRACT NO. 62B21				
ILLINOIS FED. AID PROJECT				