

CONSTRUCTION PLANS

PAVEMENT MARKING OF RUNWAY 3-21

LOGAN COUNTY BOARD
LOGAN COUNTY AIRPORT (AAA)
LINCOLN, LOGAN COUNTY, ILLINOIS

SBG PROJECT NO.: 3-17-SBGP-111
IDA PROJECT NO.: AAA-4362

VICINITY MAP

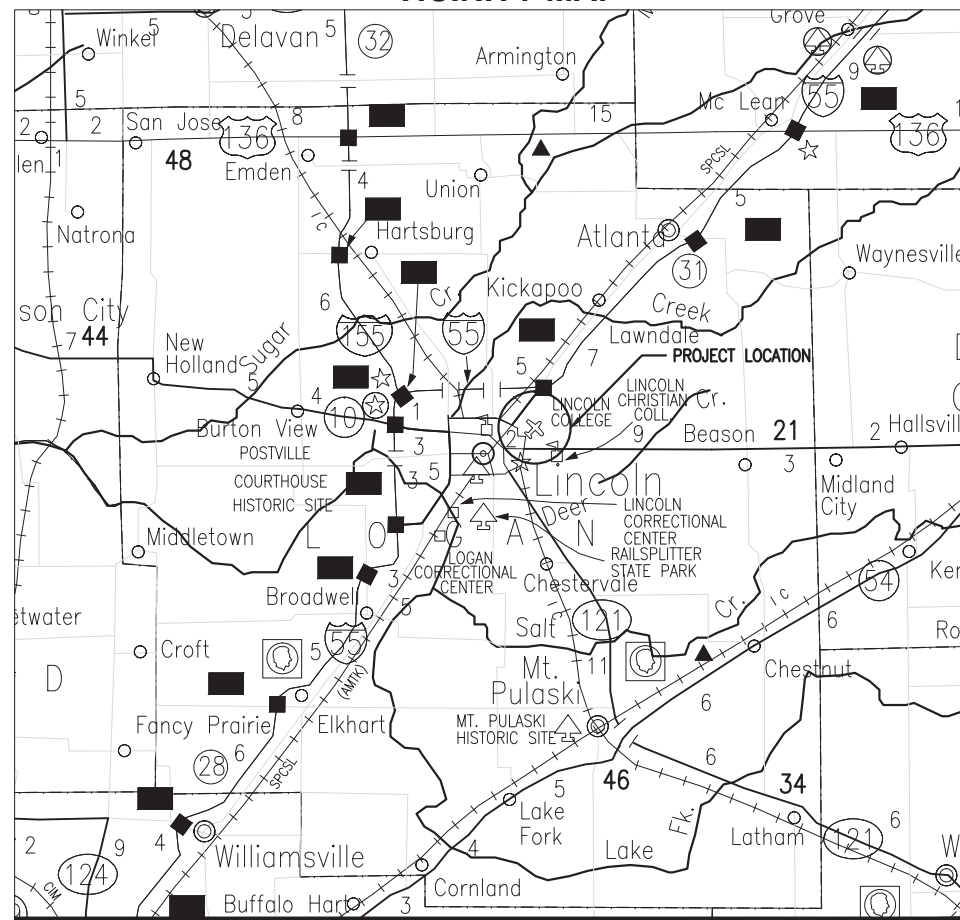

LOCATION MAP

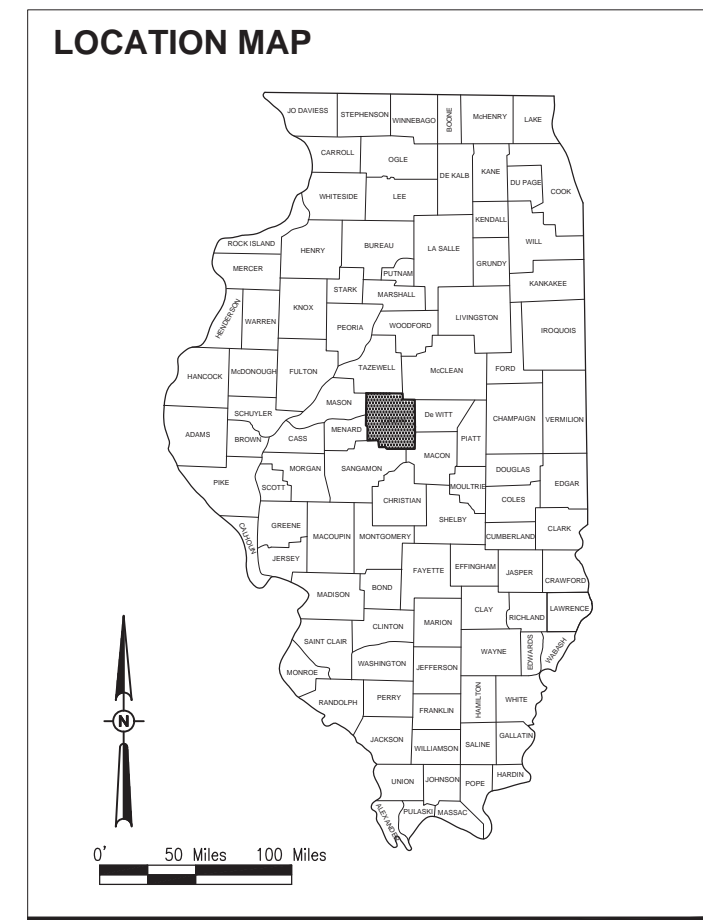

NOTICE TO CONTRACTORS AND BIDDERS

THESE CONSTRUCTION PLANS RELY UPON THE SPECIAL PROVISIONS AND THE SPECIFICATIONS TO PROVIDE FOR A COMPLETE DESCRIPTION OF THE WORK AND CONSTRUCTION REQUIREMENTS. THE PLANS SHALL ONLY BE USED IN COMBINATION WITH ALL CONTRACT DOCUMENTS.

I:\11\005\16A0018\16A0018D\CAD\AIRPORTS\SHEET\G-001-CVR

No.	Issue/Description	Sheets Changed	Date	By



Robert A. Waller, P.E. Lic. Exp. 11/30/2017
Civil Engineer

Robert A. Waller

April 15, 2016



HANSON
HANSON PROFESSIONAL SERVICES INC.
1525 South Sixth Street
Springfield, Illinois 62703-2886
Telephone: 217.788.2450
Fax: 217.788.2503

Logan County Airport

LOGAN COUNTY BOARD
County Courthouse
Lincoln, Illinois 62656
Telephone: 217.732.6400

Gene Rohlf 4/15/16

Gene Rohlf, Airport Committee Chairman Date



Offices Nationwide
www.hanson-inc.com

Hanson Professional Services Inc.
1525 S. 6th Street
Springfield, IL 62703
phone: 217-788-2450
fax: 217-788-2503

Illinois Licensed
Professional Service Corporation
#184-001084

LOGAN COUNTY AIRPORT

1351 AIRPORT RD
LINCOLN, IL 62656

SUMMARY OF QUANTITIES

ITEM NO.	DESCRIPTION	UNIT	TOTAL QUANTITY	AS-BUILT QUANTITY
AR150520	MOBILIZATION	L.S.	1	
AR620520	PAVEMENT MARKING-WATERBORNE	S.F.	16,188	
AR620525	PAVEMENT MARKING-BLACK BORDER	S.F.	4,482	
AR620900	PAVEMENT MARKING REMOVAL	S.F.	10,787	
AR800472	REM. & REP. BLASTPAD MARKING	L.S.	1	

INDEX TO SHEETS

SHEET NUMBER	SHEET TITLE
1	COVER SHEET
2	SUMMARY OF QUANTITIES AND INDEX TO SHEETS
3	PROPOSED SAFETY PLAN
4	PROP SAFETY PLAN NOTES
5	PROPOSED REMOVAL MARKING PLAN STA. 0+00 TO 21+00
6	PROPOSED REMOVAL MARKING PLAN STA. 21+00 TO 42+25
7	PROPOSED MARKING PLAN STA. 0+00 TO 21+00
8	PROPOSED MARKING PLAN STA. 21+00 TO 42+25

PAVEMENT MARKING
OF RUNWAY 3-21

SBG PROJECT NO.:
3-17-SBGP-111

IDA No.: AAA-4362

Contract No. LO031

NO.	DATE	DESCRIPTION		
		DES	DWN	REV

ISSUE: APRIL 15, 2016

PROJECT NO: 16A0018D

CAD FILE: G-002-FLP-2.DWG

DESIGN BY: KDM 1/19/2015

DRAWN BY: KDM 2/12/16

REVIEWED BY: RAW 3/12/16

SHEET TITLE

SUMMARY OF
QUANTITIES AND
INDEX TO SHEETS

CRITICAL POINT DATA					
POINT NO.	DESCRIPTION	LATITUDE	LONGITUDE	GROUND ELEV. (MSL)	HEIGHT (AGL)
1	CONST. EQUIP.	40° 09' 36.58"	89° 20' 01.12"	594.8'	15'
2	CONST. EQUIP.	40° 09' 34.53"	89° 20' 03.01"	594.1'	15'
3	CONST. EQUIP.	40° 09' 33.19"	89° 20' 14.19"	594.4'	15'

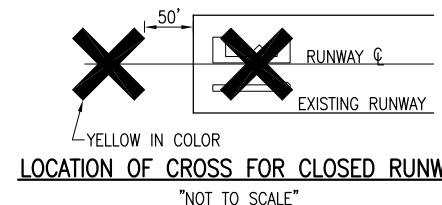

NOTE:

COST OF CONSTRUCTING, PLACING, MAINTAINING AND REMOVING CROSSES WILL BE CONSIDERED INCIDENTAL TO THE CONTRACT AND NO ADDITIONAL COMPENSATION WILL BE ALLOWED. THE CROSSES WILL BE YELLOW IN COLOR AND SHALL BE MADE OF A SUITABLE MATERIAL AS APPROVED BY THE AIRPORT MANAGER. THE CROSSES WILL BE PLACED EITHER OVER THE NUMERALS OR OFF THE RUNWAY END AS SHOWN ABOVE AND SECURED IN A MANNER APPROVED BY THE MANAGER. THE PROPOSED CROSSES WILL BE PLACED EACH DAY THE RUNWAY IS CLOSED AND REMOVED WHEN THE RUNWAY IS RE-OPENED. THE CONTRACTOR WILL BE RESPONSIBLE FOR THE PLACEMENT AND REMOVAL OF THE CROSSES. NO ADDITIONAL COMPENSATION WILL BE ALLOWED.

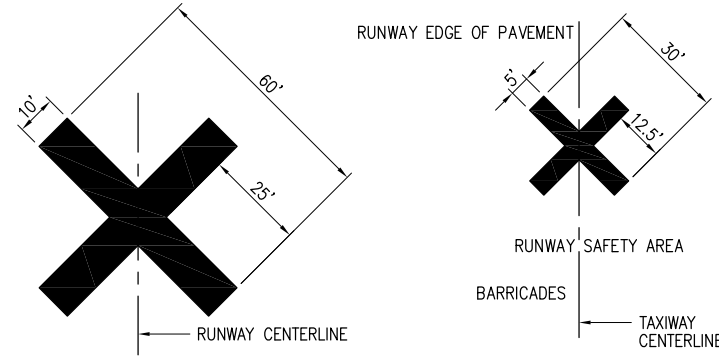

1. TEMPORARY "CLOSED RUNWAY" AND "CLOSED TAXIWAY" MARKINGS SHALL BE "AVIATION YELLOW"
2. TEMPORARY "CLOSED RUNWAY" MARKINGS SHALL BE CONSTRUCTED OF PLYWOOD, DOUBLE-LAYERED SNOW FENCE OR APPROVED FABRIC AND SHALL BE SECURED TO PAVEMENT BY SANDBAGS OR OTHER APPROVED METHOD.
3. TEMPORARY "CLOSED RUNWAY" MARKINGS SHALL BE PLACED OVER THE RUNWAY DESIGNATION NUMBERS UNLESS OTHERWISE DIRECTED BY THE ENGINEER. THE TEMPORARY "CLOSED RUNWAY" MARKINGS FOR THE SOD STRIP WILL BE PLACED ON THE SOD STRIP AT THE RUNWAY END INDICATORS.
4. TEMPORARY "CLOSED TAXIWAY" MARKINGS SHALL BE CONSTRUCTED USING TEMPORARY PAINT SUCH AS SEYMOUR TEMPORARY MARKER, PART NO. 20-636, OR AN EQUIVALENT PAINT EASILY REMOVED WITH WATER WITHOUT DEFACING THE PAVEMENT.
5. TEMPORARY "CLOSED TAXIWAY" MARKINGS SHALL BE PLACED WHEN THE RUNWAY IS OPEN AND THE TAXIWAY IS CLOSED MORE THAN 72 HOURS. THE "CLOSED TAXIWAY" MARKINGS SHALL BE PLACED AS SHOWN ON THIS SHEET. TEMPORARY TAXIWAY CLOSURE MARKING IS NOT ANTICIPATED AS PART OF THIS PROJECT
6. THE PROPOSED CROSSES WILL BE PLACED EACH DAY THE RUNWAY OR TAXIWAY IS CLOSED AND REMOVED WHEN THE RUNWAY OR TAXIWAY IS RE-OPENED. THE CONTRACTOR WILL BE RESPONSIBLE FOR THE PLACEMENT AND REMOVAL OF THE CROSSES. "CLOSED RUNWAY" AND "CLOSED TAXIWAY" MARKINGS SHALL NOT BE A PAY ITEM AND SHALL BE INCIDENTAL TO OTHER CONTRACT BID ITEMS.

TEMPORARY CLOSURE CROSS DETAIL
NOT TO SCALE

LEGEND

- EXISTING IMPROVEMENTS
- PROPOSED IMPROVEMENTS
- EXISTING BUILDINGS
- PROPOSED HAUL ROUTE AND EQUIPMENT PARKING AREA
- PROPOSED BENCHMARK
- PROPOSED BARRICADES FOR RWY 3-21 CLOSURE
- PROPOSED BARRICADES FOR SODSTRIP 14-32 CLOSURE

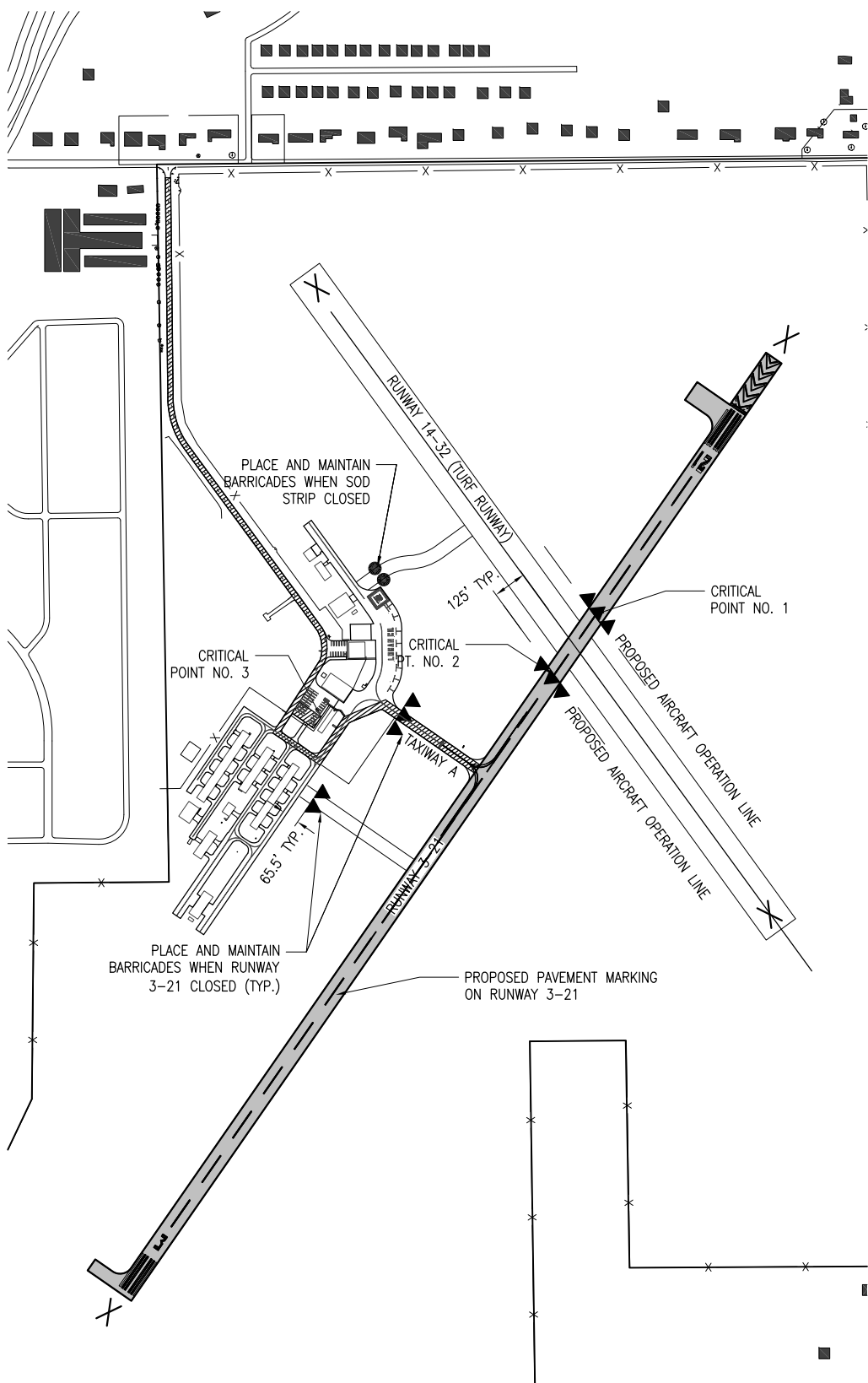

UTILITY NOTE

THE LOCATION, SIZE, AND TYPE OF MATERIAL OF EXISTING UNDERGROUND AND/OR ABOVEGROUND UTILITIES INDICATED ON THE PLANS ARE NOT REPRESENTED AS BEING ACCURATE, SUFFICIENT OR COMPLETE. NEITHER THE OWNER NOR THE ENGINEER ASSUMES ANY RESPONSIBILITY WHATSOEVER IN RESPECT TO THE ACCURACY, COMPLETENESS, OR SUFFICIENCY OF THE INFORMATION. THERE IS NO GUARANTEE, EITHER EXPRESSED OR IMPLIED, THAT THE LOCATIONS, SIZE AND TYPE OF MATERIAL OF EXISTING UNDERGROUND UTILITIES INDICATED ARE REPRESENTATIVE OF THOSE TO BE ENCOUNTERED IN THE CONSTRUCTION. IT SHALL BE THE CONTRACTOR'S RESPONSIBILITY TO DETERMINE THE ACTUAL LOCATION OF ALL SUCH FACILITIES, INCLUDING SERVICE CONNECTIONS TO UNDERGROUND UTILITIES. PRIOR TO CONSTRUCTION, THE CONTRACTOR SHALL NOTIFY THE UTILITY COMPANIES OF HIS OPERATIONAL PLANS AND SHALL OBTAIN FROM THE RESPECTIVE UTILITY COMPANIES DETAILED INFORMATION AND ASSISTANCE RELATIVE TO THE LOCATION OF THEIR FACILITIES AND THE WORKING SCHEDULE OF THE COMPANIES FOR REMOVAL OR ADJUSTMENT WHERE REQUIRED. IN THE EVENT AN UNEXPECTED UTILITY INTERFERENCE IS ENCOUNTERED DURING CONSTRUCTION, THE CONTRACTOR SHALL IMMEDIATELY NOTIFY THE UTILITY COMPANY OF JURISDICTION. THE OWNER'S REPRESENTATIVE AND/OR THE RESIDENT ENGINEER SHALL ALSO BE IMMEDIATELY NOTIFIED. ANY DAMAGE TO SUCH MAINS AND SERVICES SHALL BE RESTORED TO SERVICE AT ONCE AND PAID FOR BY THE CONTRACTOR AT NO ADDITIONAL COST TO THE CONTRACT. ALL UTILITY CABLES AND LINES SHALL BE LOCATED BY THE RESPECTIVE UTILITY. **CONTACT JULIE (JOINT UTILITY LOCATION INFORMATION FOR EXCAVATORS) FOR UTILITY INFORMATION, PHONE: 1-800-892-0123.** CONTACT THE FAA (FEDERAL AVIATION ADMINISTRATION) FOR ASSISTANCE IN LOCATING FAA CABLES AND UTILITIES. LOCATION OF FAA POWER, CONTROL, AND COMMUNICATION CABLES SHALL BE COORDINATED WITH AND/OR LOCATED BY THE FAA. ALSO CONTACT AIRPORT DIRECTOR/MANAGER AND AIRPORT PERSONNEL FOR ASSISTANCE IN LOCATING UNDERGROUND AIRPORT CABLES AND/OR UTILITIES. ALSO COORDINATE WORK WITH ALL ABOVEGROUND UTILITIES.

J.U.L.I.E. INFORMATION

COUNTY.....LOGAN
CITY.....LINCOLN
TOWNSHIP.....EAST LINCOLN
SECTION NO.....29
ADDRESS.....LOGAN COUNTY AIRPORT
RR#4, AIRPORT ROAD
LINCOLN, ILLINOIS 62656

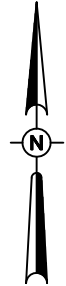

0' 100' 200' 400'
HALF SIZE SCALE: 1"= 400'
FULL SIZE SCALE: 1"= 200'

PAVEMENT MARKING OF RUNWAY 3-21

SBG PROJECT NO.:
3-17-SBGP-111

IDA No.: AAA-4362

Contract No. LO031

NO.	DATE	DESCRIPTION		
		DES	DWN	REV

ISSUE: APRIL 15, 2016
PROJECT NO: 16A0018D
CAD FILE: G-004-SFY.DWG
DESIGN BY: JRH 12/11/2014
DRAWN BY: JRH 12/11/2014
REVIEWED BY: RAW 3/12/2016

SHEET TITLE

PROPOSED SAFETY PLAN

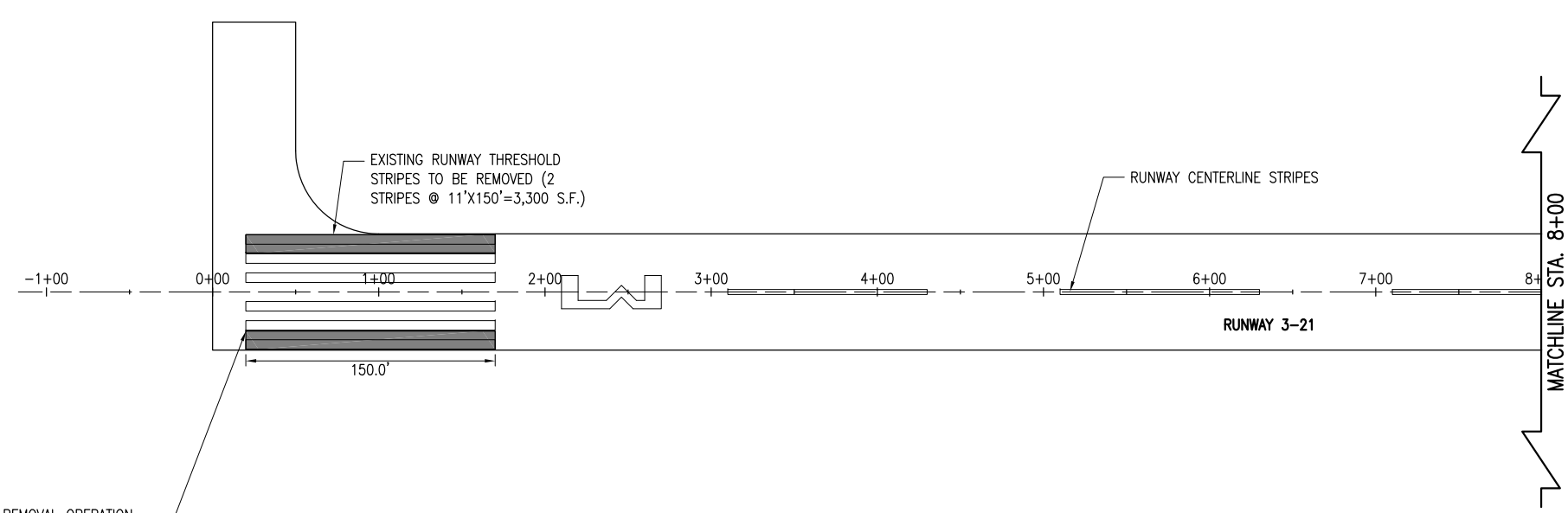

MARKING REMOVAL OPERATION
TO BE TAKEN TO WITHIN 6" OF
THE EXISTING THRESHOLD STRIPE.

PROPOSED MARKING REMOVAL QUANTITIES			
RUNWAY 3-21			
DESCRIPTION	UNIT AREA	NO. REQUIRED	TOTAL AREA
NUMBERS 21	2,520	1	2,520
THRESHOLD STRIPES (COMPLETE)	1,650	4	6,600
THRESHOLD STRIPES (PARTIAL) RWY END 21	177.5	2	355
RUNWAY CENTERLINE STRIPES (PARTIAL)	VARIABLE	11	1,020
TOTAL RUNWAY MARKING REMOVAL			10,495
TAXIWAY "A"			
DESCRIPTION	UNIT AREA	NO. REQUIRED	TOTAL AREA
TAXIWAY CENTERLINE RADII	126	2	252
TAXIWAY CENTERLINE (PARTIAL)	20	2	40
TOTAL TAXIWAY MARKING REMOVAL			292
TOTAL MARKING REMOVAL			10,787

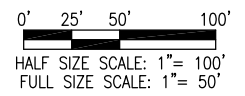
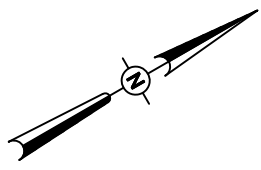

LEGEND	
	EXISTING PAVEMENT
	EXISTING MARKING
	PROPOSED MARKING REMOVAL

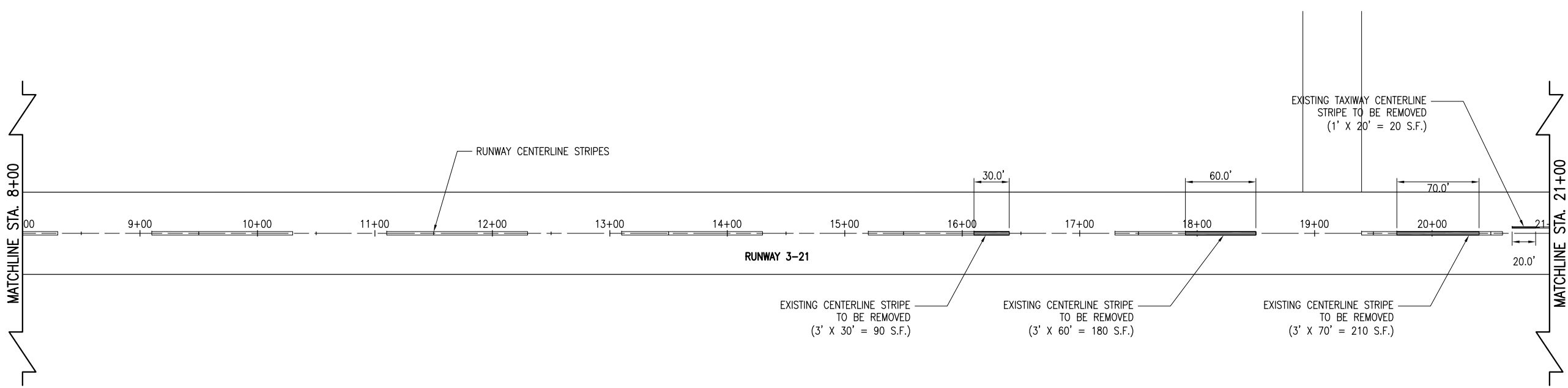

PAVEMENT MARKING
OF RUNWAY 3-21

SBG PROJECT NO.:
3-17-SBGP-111

IDA No.: AAA-4362

Contract No. LO031

NO.	DATE	DESCRIPTION		
		DES	DWN	REV

ISSUE: APRIL 15, 2016
PROJECT NO: 16A0018D
CAD FILE: C-152-EMRK.DWG
DESIGN BY: JRH 12/11/2014
DRAWN BY: KDM 2/12/2016
REVIEWED BY: RAW 3/12/2016

SHEET TITLE

PROPOSED MARKING
REMOVAL PLANS
STA. 0+00 TO 21+00

APR 15, 2016 5:08 PM HARR01115
I:\16\JOBS\16A0018D\CAD\AIRPORT\TSHEETS\C-152-EMRK

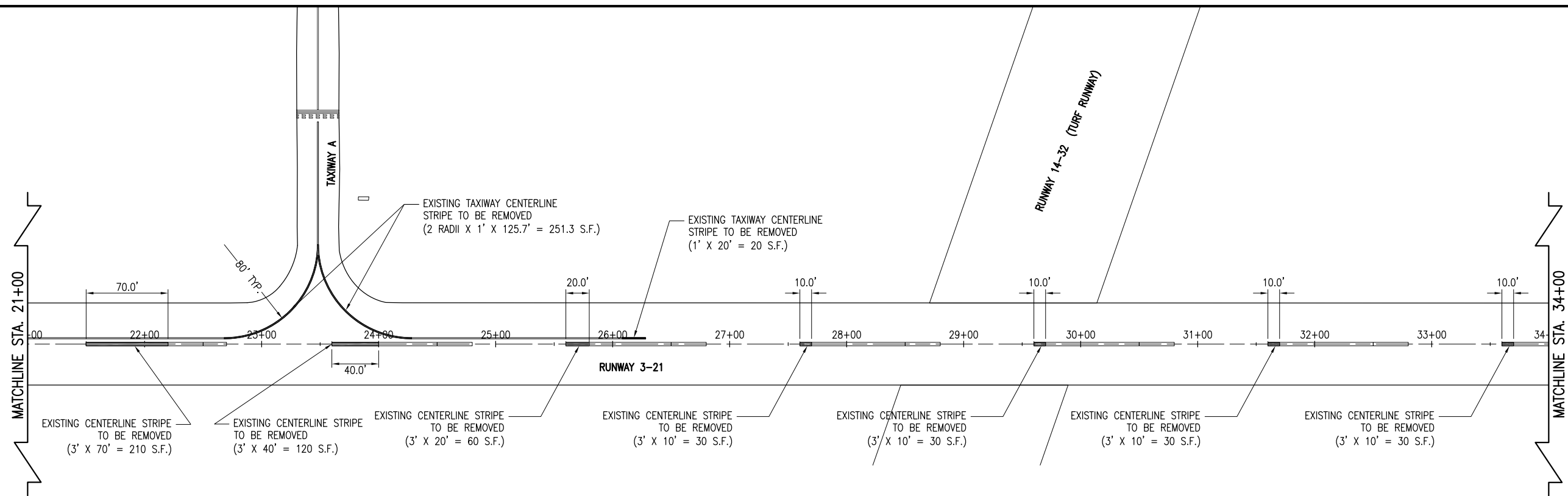

LEGEND

- EXISTING PAVEMENT
- EXISTING MARKING
- PROPOSED MARKING REMOVAL

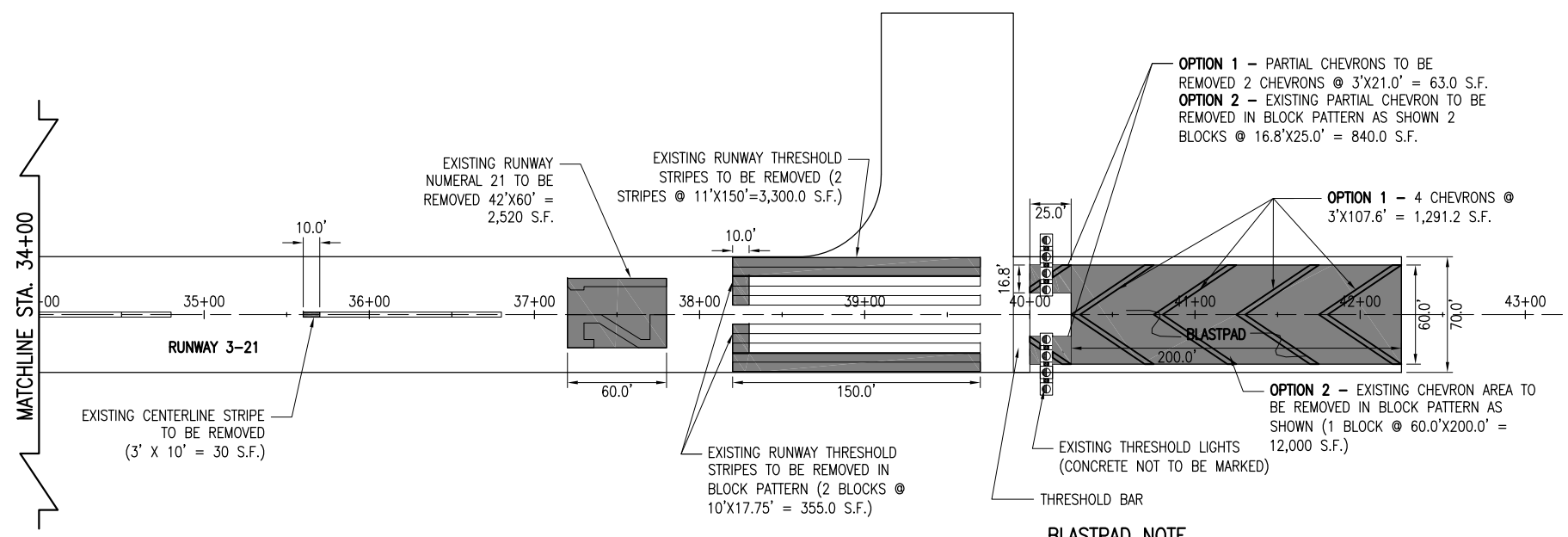
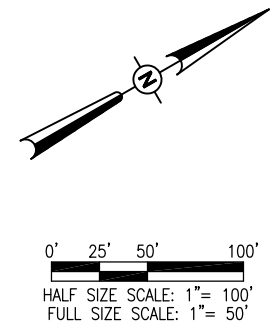

REMOVE & REPLACE BLASTPAD MARKING NOTE

ACCORDING TO THE CURRENT ADVISORY CIRCULAR AC NO. 150/5340-1L, THE EXISTING MARKING MUST BE REMOVED IN A BLOCK PATTERN. THE CONTRACTOR WILL BE GIVEN 2 OPTIONS TO ACCOMPLISH THIS WORK FOR THE BLASTPAD AREA. ALL OTHER MARKING REMOVAL AREAS WILL BE DONE AS SHOWN.

OPTION 1 - REMOVE ALL OF THE YELLOW MARKING FROM THE BLASTPAD PAVEMENT IN ACCORDANCE WITH THE STANDARD SPECIFICATIONS AND TO THE SATISFACTION OF THE RESIDENT ENGINEER/RESIDENT TECHNICIAN. AFTER CLEANUP AND ADEQUATE DRYING OF THE PAVEMENT, THE CONTRACTOR WILL PAINT THE ENTIRE BLAST PAD AREA (APPROXIMATELY 225' X 70') WITH ONE COAT OF BLACK PAINT. THE CONTRACTOR WILL PAINT THE CHEVRONS (2 COATS) AS SHOWN AND OUTLINE WITH AN ADDITIONAL COAT OF BLACK PAINT 6" IN WIDTH. THE FINAL COAT OF YELLOW WILL HAVE BEADS APPLIED IN ACCORDANCE TO THE STANDARD SPECIFICATIONS. NO BEADS WILL BE APPLIED TO THE YELLOW PAINT PRIOR TO THE BLACK PAINT BEING SUFFICIENTLY DRY.

OPTION 2 - REMOVE THE PAINT IN THE BLOCK AREA (200' X 60') AND THE TWO PARTIAL CHEVRONS BLOCK AREAS (16.8' X 25' EACH) AS SHOWN ON THIS SHEET AND IN ACCORDANCE WITH THE STANDARD SPECIFICATIONS. THE CONTRACTOR WILL USE CONSISTENT EFFORT ACROSS THE ENTIRE AREAS DESIGNATED FOR REMOVAL SO AFTER THE MARKING REMOVAL HAS BEEN COMPLETED THE REMOVAL AREAS WILL HAVE A UNIFORM APPEARANCE AND THE REMOVED MARKING CANNOT BE DISCERNED. AFTER CLEANUP AND SUFFICIENT DRYING OF THE PAVEMENT THE CONTRACTOR WILL PAINT THE CHEVRONS AND 6" BLACK BORDERS USING 2 COATS OF EACH PAINT. THE FINAL COAT OF YELLOW WILL HAVE BEADS APPLIED IN ACCORDANCE TO THE STANDARD SPECIFICATIONS.

THIS ITEM OF WORK WILL INCLUDE ALL MARKING REMOVAL, MARKING, AND BLACK BORDER INSTALLATION AS WELL AS ALL CLEANUP AND OTHER INCIDENTALS TO COMPLETE THE CHEVRON INSTALLATION AS SHOWN.

THE PROPOSED REMOVAL AND RE-INSTALLATION OF THE BLASTPAD MARKING WILL BE PAID FOR UNDER PAY ITEM:
AR800472 "REM. & REP. BLASTPAD MARKING" _____ PER L.S.

BLASTPAD NOTE

ALL MARKING REMOVAL, MARKING AND BLACK BORDER BEYOND THE WHITE THRESHOLD BAR TO THE NORTH WILL BE CONSIDERED THE BLASTPAD AND WILL BE PAID FOR UNDER PAY ITEM AR800472.

PAVEMENT MARKING OF RUNWAY 3-21

SBG PROJECT NO.: 3-17-SBGP-111

IDA No.: AAA-4362

Contract No. LO031

NO.	DATE	DESCRIPTION		
		DES	DWN	REV

ISSUE: APRIL 15, 2016
PROJECT NO: 16A0018D
CAD FILE: C-152-EMRK.DWG
DESIGN BY: JRH 12/11/2014
DRAWN BY: KDM 2/12/2016
REVIEWED BY: RAW 3/12/2016

SHEET TITLE

PROPOSED MARKING REMOVAL PLANS STA. 21+00 TO 42+25

MARKING NOTES

1. ALL PROPOSED MARKING WILL BE LOCATED AS SHOWN ON THE PROPOSED MARKING PLAN SHEETS.
2. ALL RUNWAY MARKING WILL BE SOLID AND WHITE IN COLOR.
3. ALL TAXIWAY AND BLASTPAD MARKING WILL BE SOLID AND YELLOW IN COLOR.
4. ALL YELLOW & WHITE PROPOSED MARKING WILL HAVE A REFLECTIVE MEDIA APPLIED IN ACCORDANCE WITH THE SPECIFICATIONS.
5. ALL PROPOSED MARKING WILL BE OUTLINED WITH A 6" WIDE (BLACK) OUTLINE STRIPE.
6. CUT-OFF SHEETS WILL BE REQUIRED TO INSURE STRAIGHT EDGES.
7. IF THE CONTRACTOR ELECTS TO "BLOCK PAINT" THE BLACK PAINT AND THEM PAINT EITHER YELLOW OR WHITE OVER THE BLACK PAINT; ONLY THE VISIBLE BLACK PAINT WILL BE ELIGIBLE FOR PAYMENT.
8. ALL PROPOSED MARKING ITEMS WILL BE PAID FOR AS FOLLOWS (THIS DOES NOT INCLUDE THE BLASTPAD AREA):
AR620520 "PAVEMENT MARKING-WATERBORNE" _____ PER SQ. FT.
9. ALL PROPOSED BLACK MARKING ITEMS WILL BE PAID FOR AS FOLLOWS (THIS DOES NOT INCLUDE THE BLASTPAD AREA):
AR620525 "PAVEMENT MARKING-BLACK BORDER" _____ PER SQ. FT.

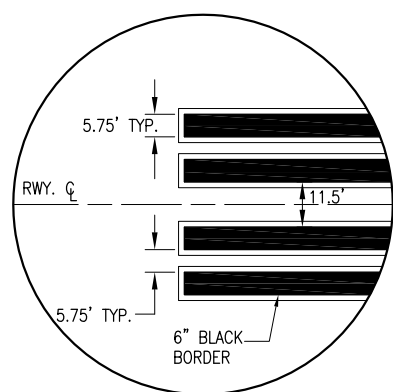
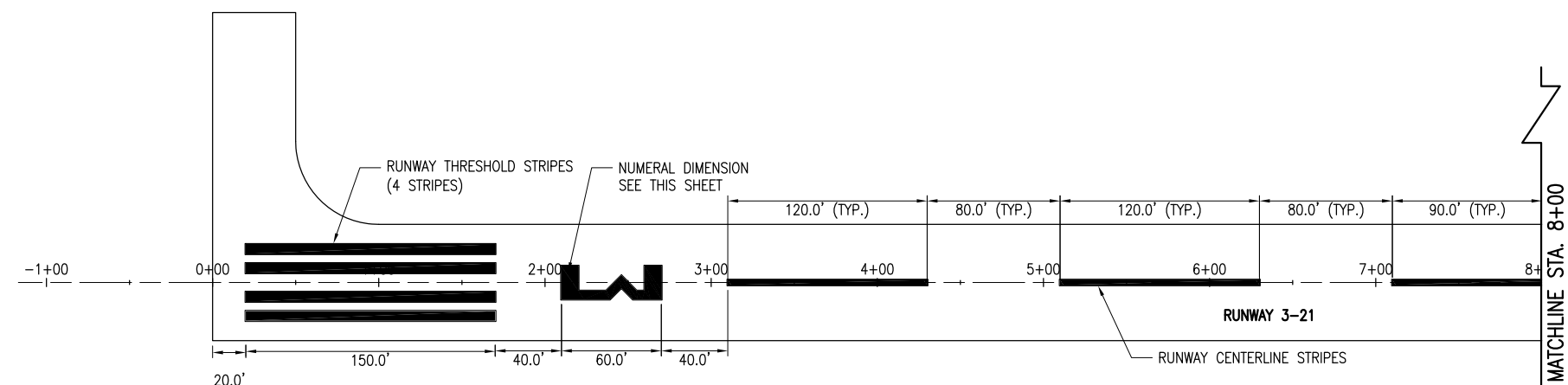

PROPOSED THRESHOLD BAR DETAIL
"NOT TO SCALE"

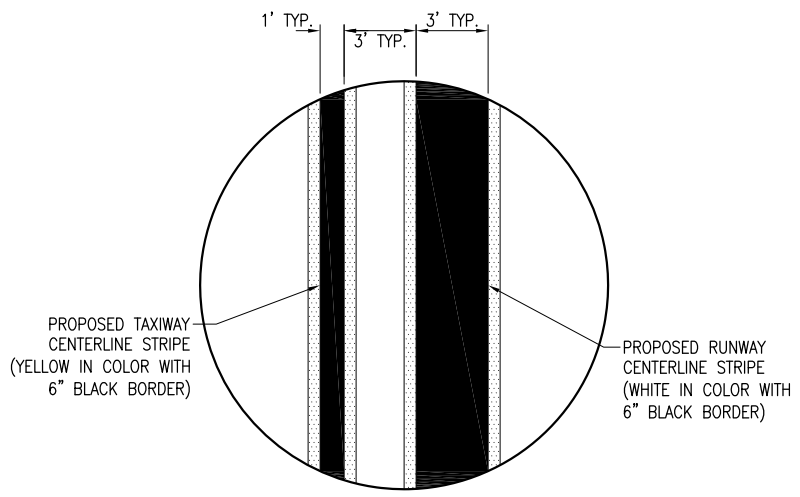

TAXIWAY CENTERLINE LEAD-IN DETAIL
"NOT TO SCALE"

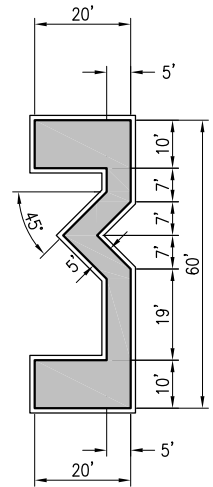

WHITE = 634 S.F.
BLACK = 102 S.F.

PROPOSED NUMERAL DETAIL FOR RUNWAY END 3
"NOT TO SCALE"

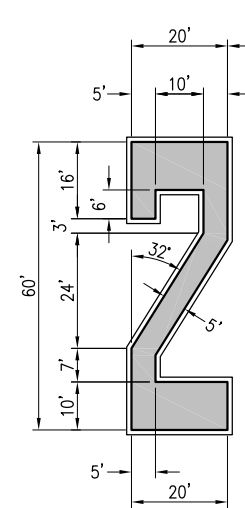

WHITE = 652 S.F.
BLACK = 106 S.F.

PROPOSED NUMERAL DETAIL FOR RUNWAY END 21
"NOT TO SCALE"

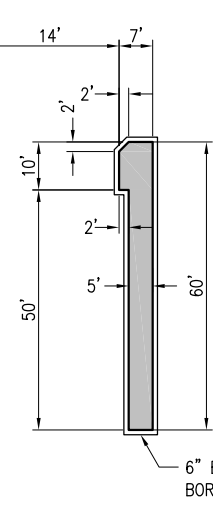

WHITE = 318 S.F.
BLACK = 68 S.F.

LEGEND

	EXISTING PAVEMENT
	EXISTING MARKING
	PROPOSED MARKING

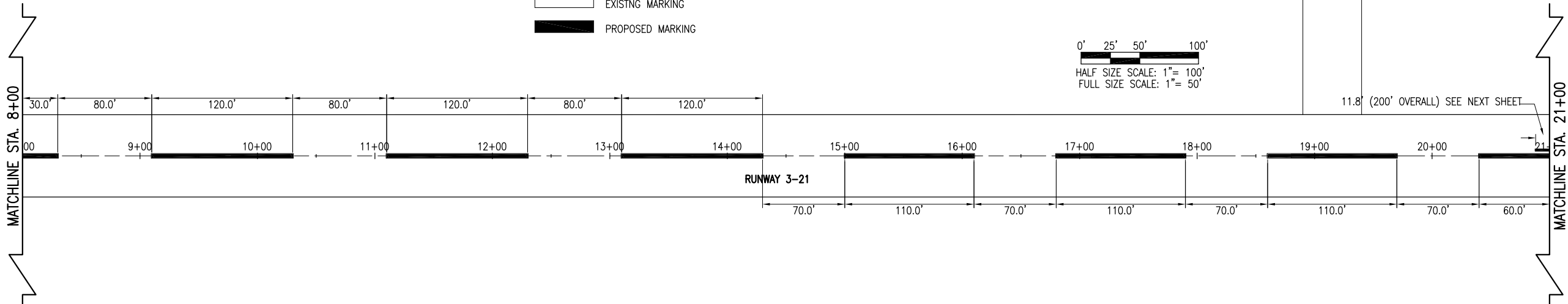
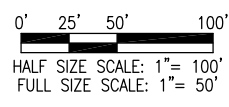
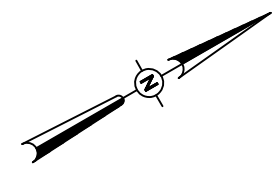

APR 15, 2016 5:08 PM HARR01115
I:\16\JOBS\16A001\81\6A0018D\CAD\AIRPORT\TSHEETC-151-MRK

PAVEMENT MARKING OF RUNWAY 3-21

SBG PROJECT NO.:
3-17-SBGP-111

IDA No.: AAA-4362

Contract No. LO031

NO.	DATE	DESCRIPTION		
		DES	DWN	REV

ISSUE: APRIL 15, 2016
PROJECT NO: 16A0018D
CAD FILE: C-151-MRK.DWG
DESIGN BY: JRH 12/11/2014
DRAWN BY: KDM 02/12/2016
REVIEWED BY: RAW 03/12/2016

PROPOSED MARKING PLAN STA. 0+00 TO 21+00

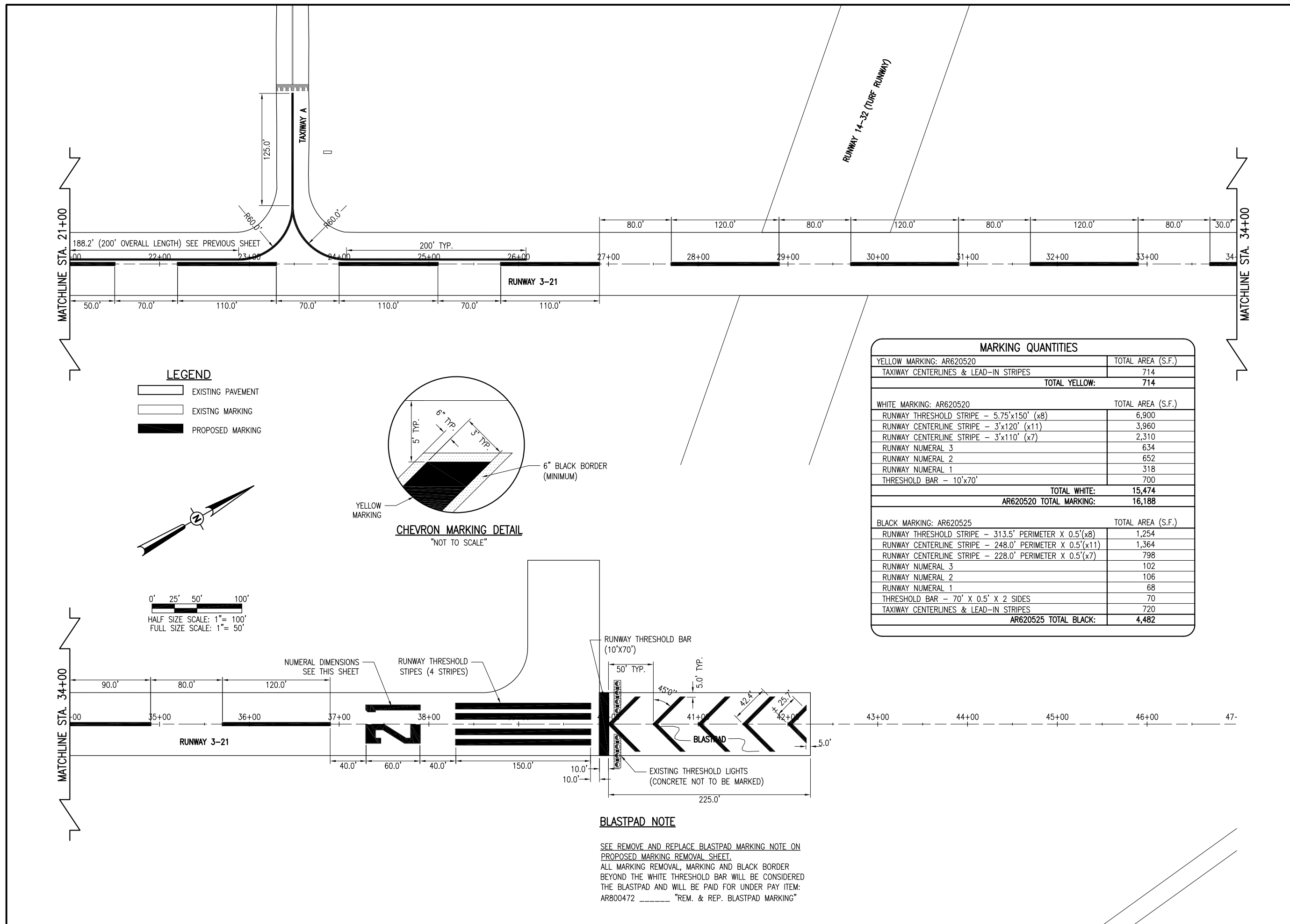

LEGEND

- EXISTING PAVEMENT
- EXISTING MARKING
- PROPOSED MARKING

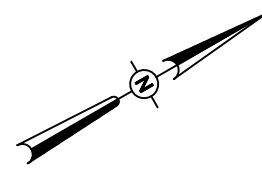

0' 25' 50' 100'
HALF SIZE SCALE: 1"= 100'
FULL SIZE SCALE: 1"= 50'

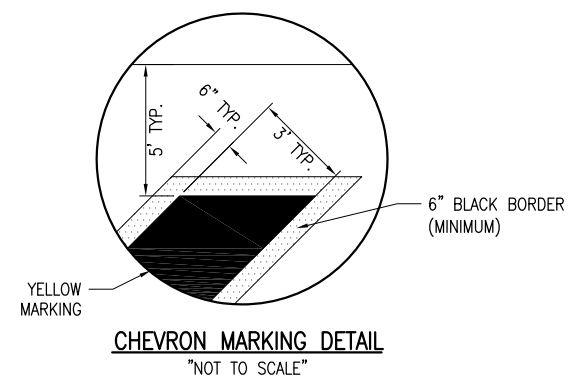

MARKING QUANTITIES	
YELLOW MARKING: AR620520	TOTAL AREA (S.F.)
TAXIWAY CENTERLINES & LEAD-IN STRIPES	714
TOTAL YELLOW:	714
WHITE MARKING: AR620520	TOTAL AREA (S.F.)
RUNWAY THRESHOLD STRIPE - 5.75'x150' (x8)	6,900
RUNWAY CENTERLINE STRIPE - 3'x120' (x11)	3,960
RUNWAY CENTERLINE STRIPE - 3'x110' (x7)	2,310
RUNWAY NUMERAL 3	634
RUNWAY NUMERAL 2	652
RUNWAY NUMERAL 1	318
THRESHOLD BAR - 10'x70'	700
TOTAL WHITE:	15,474
AR620520 TOTAL MARKING:	16,188
BLACK MARKING: AR620525	TOTAL AREA (S.F.)
RUNWAY THRESHOLD STRIPE - 313.5' PERIMETER X 0.5'(x8)	1,254
RUNWAY CENTERLINE STRIPE - 248.0' PERIMETER X 0.5'(x11)	1,364
RUNWAY CENTERLINE STRIPE - 228.0' PERIMETER X 0.5'(x7)	798
RUNWAY NUMERAL 3	102
RUNWAY NUMERAL 2	106
RUNWAY NUMERAL 1	68
THRESHOLD BAR - 70' X 0.5' X 2 SIDES	70
TAXIWAY CENTERLINES & LEAD-IN STRIPES	720
AR620525 TOTAL BLACK:	4,482

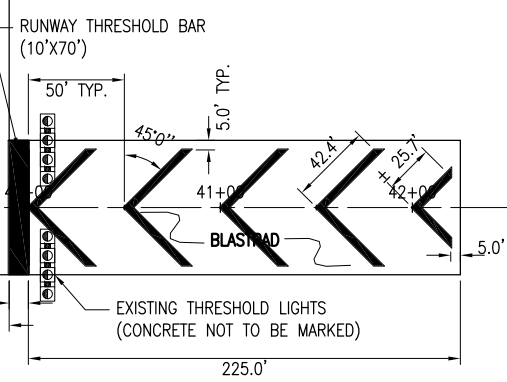

BLASTPAD NOTE
SEE REMOVE AND REPLACE BLASTPAD MARKING NOTE ON PROPOSED MARKING REMOVAL SHEET.
ALL MARKING REMOVAL, MARKING AND BLACK BORDER BEYOND THE WHITE THRESHOLD BAR WILL BE CONSIDERED THE BLASTPAD AND WILL BE PAID FOR UNDER PAY ITEM: AR800472 "REM. & REP. BLASTPAD MARKING"

PAVEMENT MARKING OF RUNWAY 3-21

SBG PROJECT NO.: 3-17-SBGP-111

IDA No.: AAA-4362

Contract No. LO031

NO.	DATE	DESCRIPTION		
		DES	DWN	REV

ISSUE: APRIL 15, 2016
PROJECT NO: 16A0018D
CAD FILE: C-151-MRK.DWG
DESIGN BY: JRH 12/11/2014
DRAWN BY: KDM 02/15/2016
REVIEWED BY: RAW 03/12/2016

SHEET TITLE

PROPOSED MARKING PLAN STA. 21+00 TO 42+25