

**EJM ENGINEERING, INC.**  
 411 South Wells Street Suite 800  
 Chicago, Illinois 60607

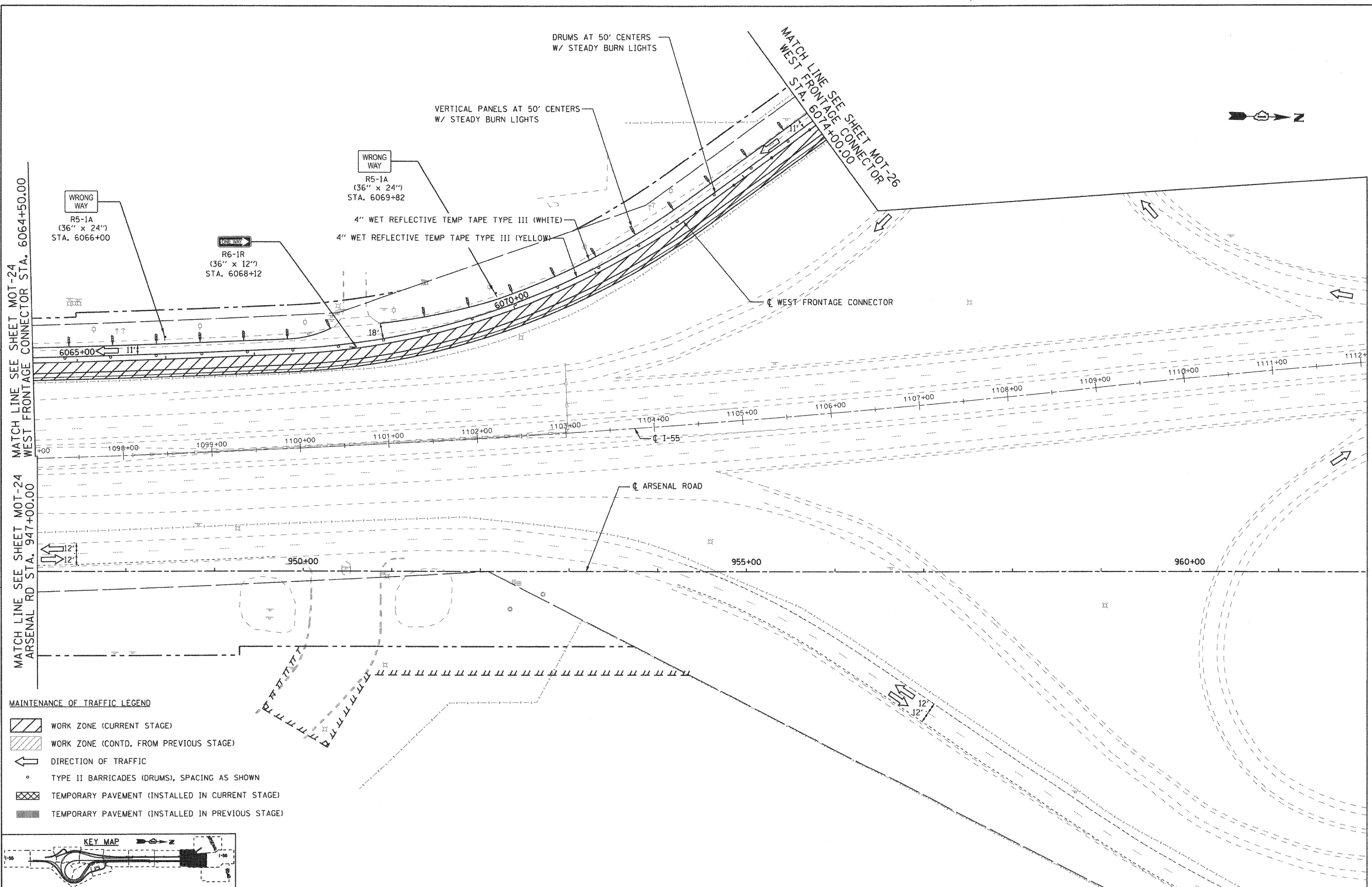

MATCH LINE SEE SHEET MOT-24 WEST FRONTAGE CONNECTOR STA. 6064+50.00  
 MATCH LINE SEE SHEET MOT-24 ARSENAL RD STA. 947+00.00



- MAINTENANCE OF TRAFFIC LEGEND**
- WORK ZONE (CURRENT STAGE)
  - WORK ZONE (CONTD. FROM PREVIOUS STAGE)
  - DIRECTION OF TRAFFIC
  - TYPE II BARRICADES (DRUMS), SPACING AS SHOWN
  - TEMPORARY PAVEMENT (INSTALLED IN CURRENT STAGE)
  - TEMPORARY PAVEMENT (INSTALLED IN PREVIOUS STAGE)

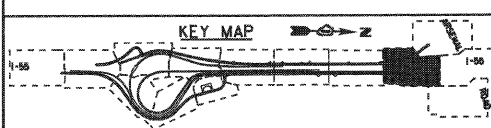

FILE NAME = ...D160C31-SHT-STAGING211.dgn

USER NAME = gra1	DESIGNED - GR	REVISED -
PLOT SCALE = 1/8"=1'-0"	DRAWN - GR	REVISED -
PLOT DATE = 12/16/2009	CHECKED - RY	REVISED -
	DATE - 12/18/2009	REVISED -

**STATE OF ILLINOIS  
 DEPARTMENT OF TRANSPORTATION**

**MAINTENANCE OF TRAFFIC  
 STAGE 2**

SCALE: 1"=50' SHEET NO. 7 OF 8 SHEETS STA. TO STA.

F.A. RTE.	SECTION	COUNTY	TOTAL SHEETS	SHEET NO.
55	(99-1&2)-3	WILL	524	111
FED. ROAD DIST. NO. 1 ILLINOIS FED. AID PROJECT			CONTRACT NO. 60C31	