

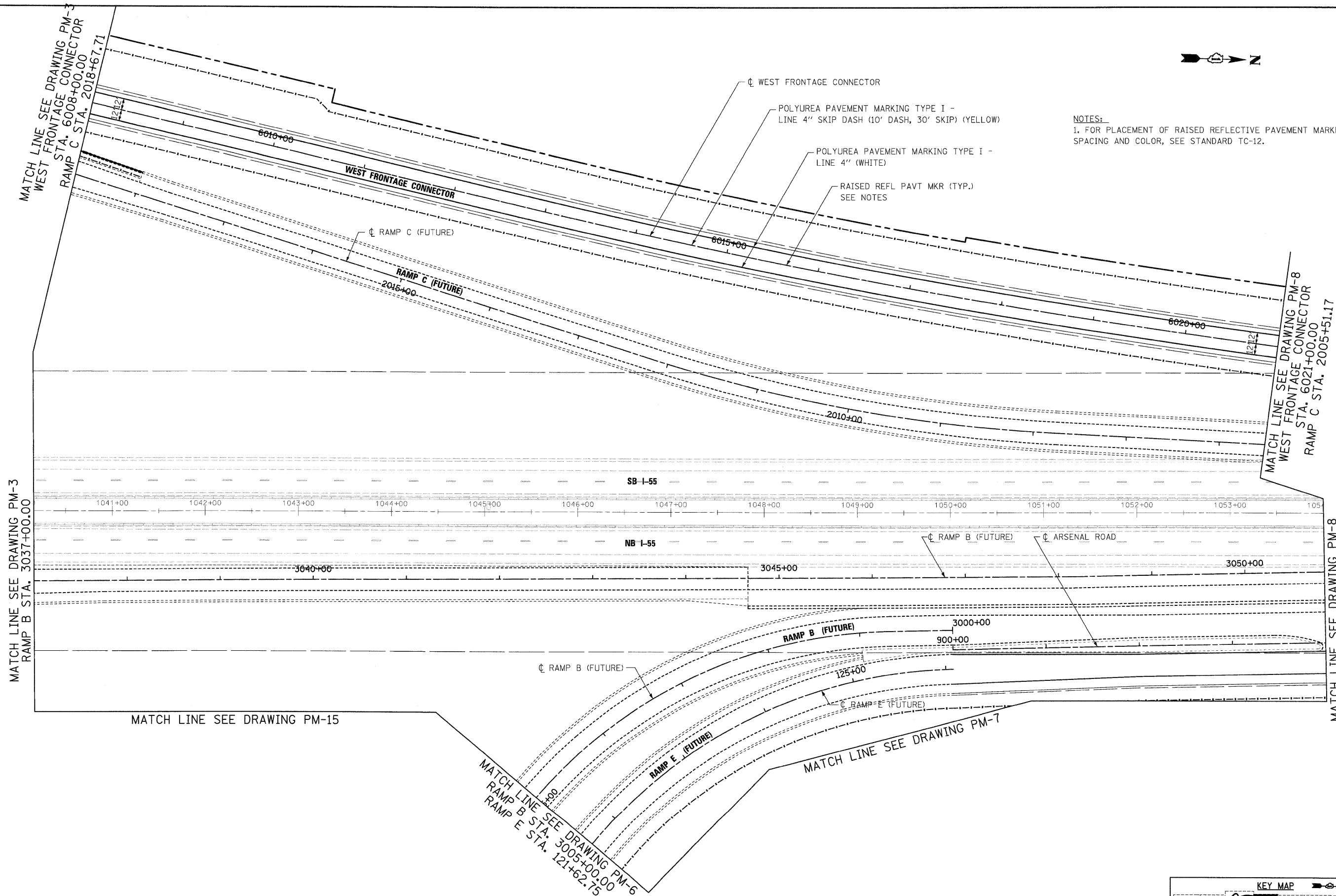

NOTES:  
 1. FOR PLACEMENT OF RAISED REFLECTIVE PAVEMENT MARKERS, SPACING AND COLOR, SEE STANDARD TC-12.



MATCH LINE SEE DRAWING PM-3  
 RAMP B STA. 3037+00.00

MATCH LINE SEE DRAWING PM-3  
 WEST FRONTAGE CONNECTOR  
 STA. 6008+00.00  
 RAMP C STA. 2018+67.71

MATCH LINE SEE DRAWING PM-8  
 WEST FRONTAGE CONNECTOR  
 STA. 6021+00.00  
 RAMP C STA. 2005+51.17

MATCH LINE SEE DRAWING PM-8  
 ARSENAL RD STA. 904+00.00  
 RAMP B STA. 3050+85.37

MATCH LINE SEE DRAWING PM-15

MATCH LINE SEE DRAWING PM-6  
 RAMP B STA. 3005+00.00  
 RAMP E STA. 121+62.75

MATCH LINE SEE DRAWING PM-7

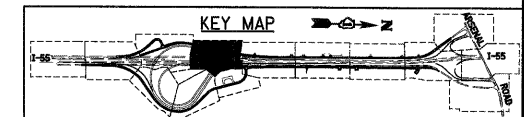

|                                     |                      |                 |           |
|-------------------------------------|----------------------|-----------------|-----------|
| FILE NAME =<br>D162C31-SHT-PM05.dgn | USER NAME = TKluegel | DESIGNED - MJT  | REVISED - |
|                                     |                      | DRAWN - MJT     | REVISED - |
|                                     |                      | CHECKED - DLT   | REVISED - |
|                                     |                      | DATE - 12/18/09 | REVISED - |

STATE OF ILLINOIS  
 DEPARTMENT OF TRANSPORTATION

PAVEMENT MARKING PLAN

SCALE: 1"=50' SHEET NO. 5 OF 15 SHEETS STA. TO STA.

| F.A.I. RTE.                                     | SECTION      | COUNTY | TOTAL SHEETS       | SHEET NO. |
|---|--------------|--------|--------------------|-----------|
| 55  | (99-1&2)AC-3 | WILL   | 524                | 254       |
| FED. ROAD DIST. NO. 1 ILLINOIS FED. AID PROJECT |              |        | CONTRACT NO. 60C31 |           |

FINAL