

Bench Mark:  
 (BMRR) Box cut at top of S.E. wingwall of Grant Creek Bridge on E. Frontage Rd. of I 55, Elev. 520.80  
 Existing Structure:  
 None.

STATE OF ILLINOIS  
 DEPARTMENT OF TRANSPORTATION

**DESIGN STRESSES**  
 FIELD UNITS

$f'_c = 3,500$  psi  
 $f_y = 60,000$  psi (Reinforcement)

**PRECAST UNITS**

$f'_c = 4,500$  psi (pre-cast units)

**DESIGN SPECIFICATIONS**

2002 AASHTO Standard Specifications

**CURVE DATA**

Ramp C  
 PI STA. = 2037+82.40  
 $\Delta = 132^\circ 56' 23.34"$  (LT)  
 $D = 6^\circ 51' 42"$   
 $R = 835.00'$   
 $T = 1917.61'$   
 $L = 1937.40'$   
 $E = 1256.52'$   
 S.E. RUN = 0.06 Ft./Ft.  
 P.C. STA. = 2018+64.79  
 P.T. STA. = 2038+02.19

Full SE from Sta. 2019+76.79 to end of wall.  
 For transition of SE from Sta. 2019+76.79 to beginning of wall see Sheet RW3-2.

Parapet and Anchorage Slab are not part of this Contract

Note "A":  
 The top of levelling pad shall be established at minimum depth of 3.5 ft. below finished grade unless sound bed rock is encountered higher. When sound bed rock is encountered less than 1 foot below finished grade, the minimum embedment depth below the finished grade shall be 1 foot.

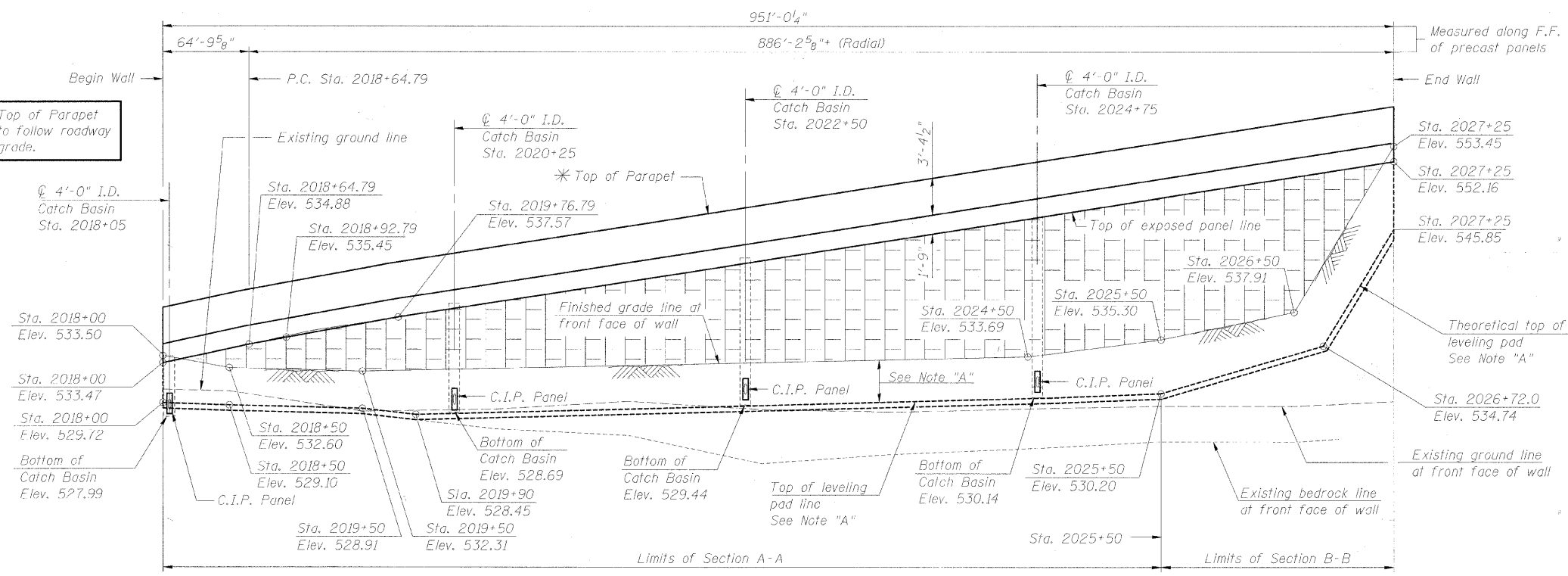

**ELEVATION**  
 (Looking at F.F. of wall)

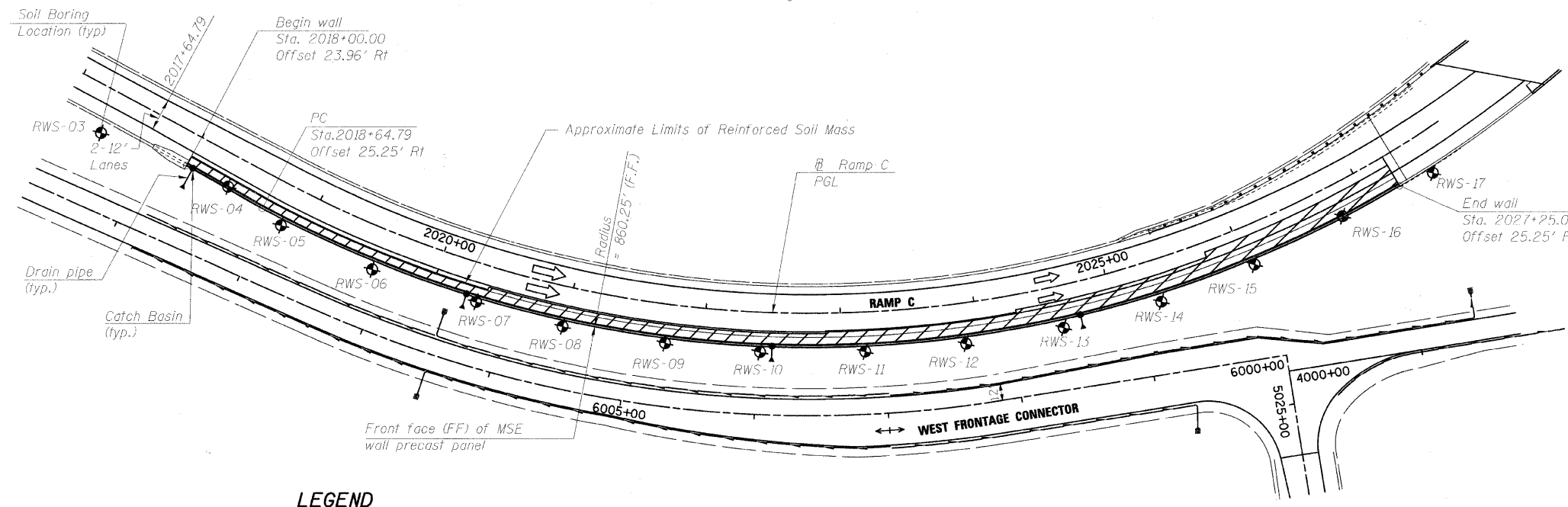

**PLAN**

Note:  
 Wall offsets are measured from the Ramp C to the front face of precast panels.

**APPROVED**  
 FOR STRUCTURAL ADEQUACY ONLY  
 Robert E. Anderson (TJD)  
 ENGINEER OF BRIDGES AND STRUCTURES

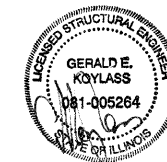

Exp: 11/30/2010

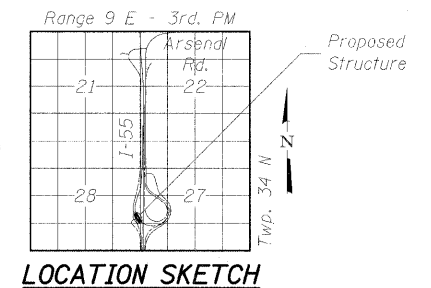

**LOCATION SKETCH**

**GENERAL PLAN & ELEVATION**  
**MSE WALL - RAMP C**  
**F.A.I. RTE. 55 - SEC. (99-1&2) R-6**  
**WILL COUNTY**  
**STATION 2018+00 TO 2027+25**  
**STRUCTURE NO. 099-W028**

DESIGNED	PMH
CHECKED	MJL
DRAWN	RJ
CHECKED	BKB

**LEGEND**

- ⊙ Manhole
- Catch Basin
- ⊕ Soil Boring
- F.F. = Front Face
- B.F. = Back Face
- E.F. = Each Face
- I.I. = Inside Face
- O.F. = Outside Face

**McDonough Associates Inc.**  
 Engineers / Architects  
 130 East Randolph Street  
 Chicago, Illinois 60601  
 (312) 946-8600

SHEET NO. RW3-1 SHEETS RW3-12	F.A.I. RTE.	SECTION	COUNTY	TOTAL SHEETS	SHEET NO.
	55	(99-1&2) AC-3	WILL	524	311
CONTRACT NO. 60C31					
FED. ROAD DIST. NO. 1 ILLINOIS FED. AID PROJECT					