

Bench Mark: BM 7
 (RR spike in E. side of power pole +6.5' tall at the South Edge
 of a pond on the E. side of E. Frontage Rd. between CPT'S 214 & 215. Elev.=556.123
 Existing Structures: None.

STATE OF ILLINOIS
 DEPARTMENT OF TRANSPORTATION

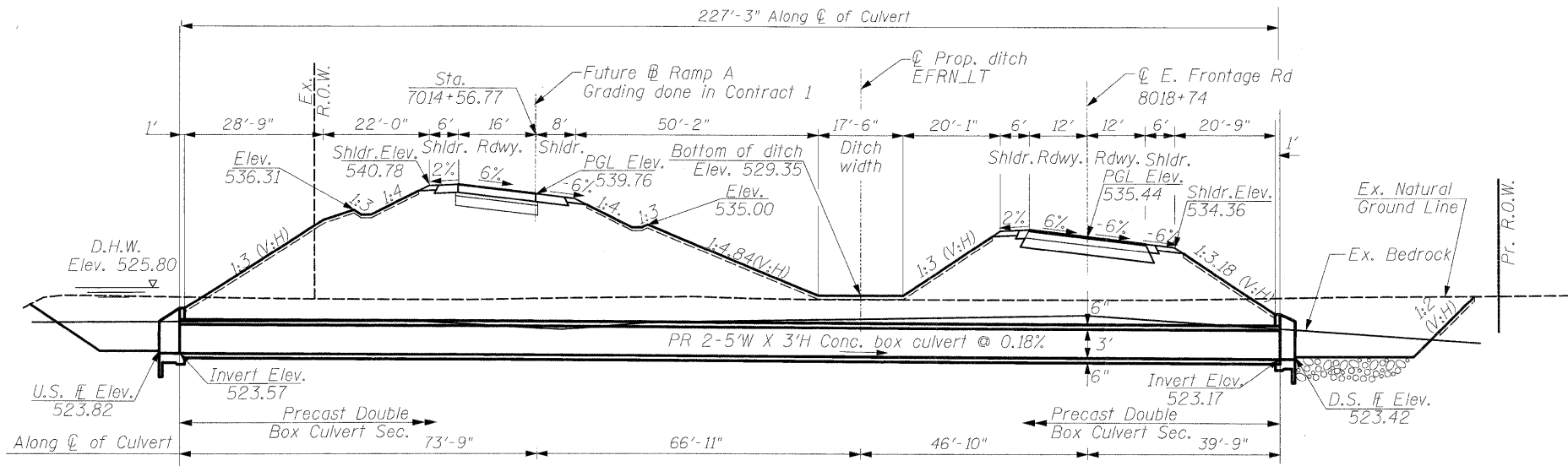

LONGITUDINAL SECTION
 N.T.S.

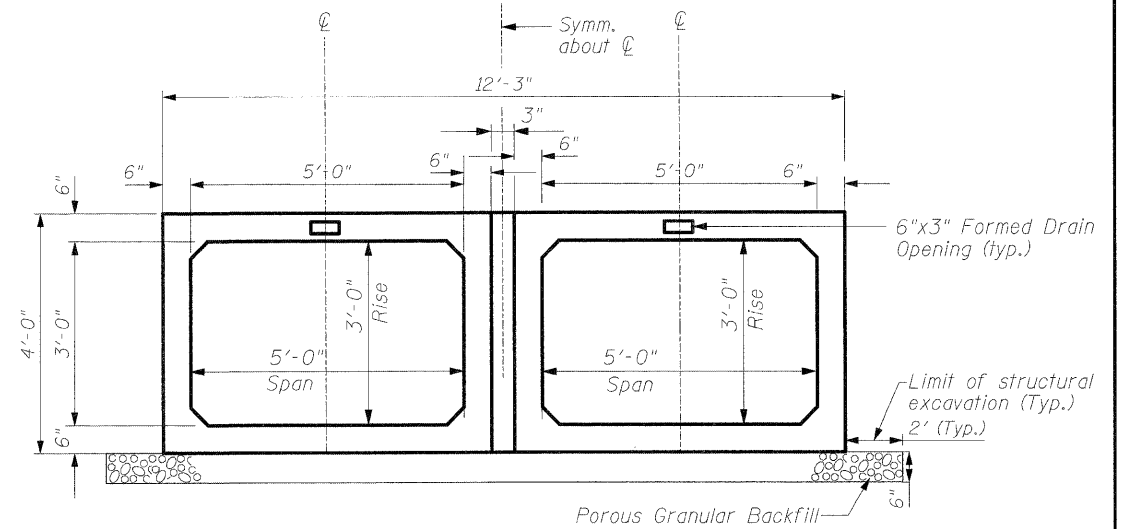

SECTION THRU BARREL
 N.T.S.

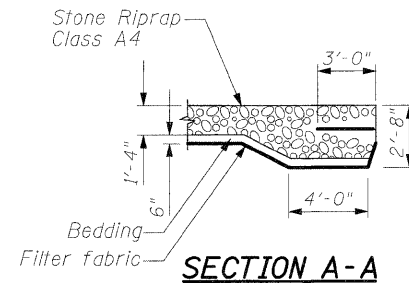

SECTION A-A

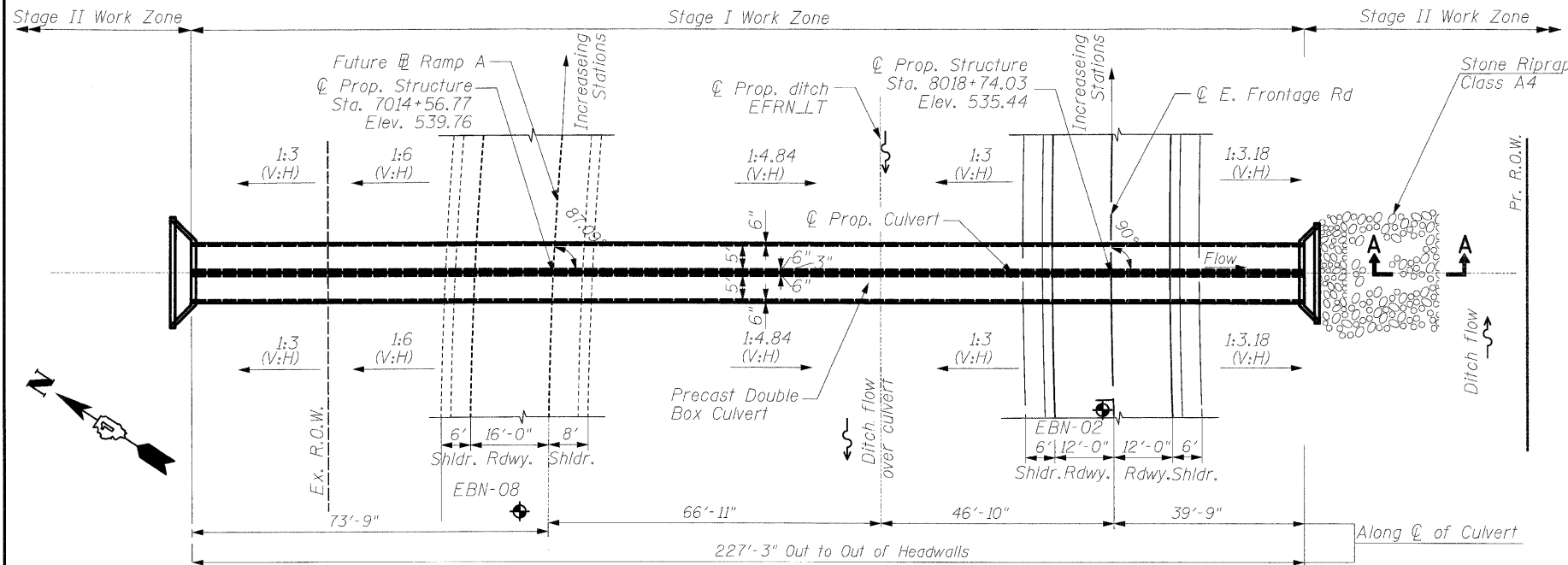

PLAN
 N.T.S.

CURVE DATA

P.I. Station 8015+77.77
 Delta = 36° 00' 38.32" (RT)
 Degree = 5° 21' 17.08"
 Tangent = 347.7740'
 Length = 672.4996'
 Radius = 1,070.00'
 External = 55.0985'
 Long Chord = 661.4854'
 Mid. Ord. = 52.4002'
 P.C. Station 8012+30.00
 P.T. Station 8019+02.50

CURVE DATA

P.I. Station 7015+25.31
 Delta = 61° 20' 36.44" (RT)
 Degree = 6° 51' 42.37"
 Tangent = 495.2296'
 Length = 893.9888'
 Radius = 835.00'
 External = 135.8127'
 Long Chord = 851.8980'
 Mid. Ord. = 116.8131'
 P.C. Station 7010+30.08
 P.T. Station 7019+24.07

DESIGN SPECIFICATIONS

AASHTO 2002

LOADING HS-20-44

Allow 50 lbs/sq. ft. for future wearing surface.

DESIGN STRESSES

FIELD UNITS

Cast-In-Place Units

$f'_c = 3,500$ psi (Concrete)

$f_y = 60,000$ psi (Reinforcement)

Precast Units

$f'_c = 5,000$ psi (Concrete)

$f_y = 65,000$ psi (Welded Wire Fabric)

SEISMIC DATA

Seismic Performance Zone (SPC) = A

Bedrock Acceleration Coeff.(A) = 0.04g

Site Coefficient (S) = 1.0

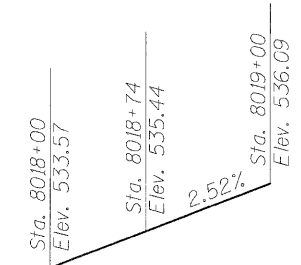

PROFILE GRADE
 (Along E. Frontage Rd.)

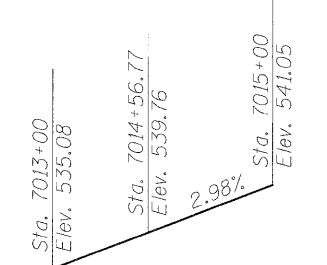

PROFILE GRADE
 (Along Ramp A)

GENERAL PLAN & ELEVATION-RAMP A
 OVER UNNAMED DITCH
 F.A.I. ROUTE 55 - SEC. (99-1&2)AC-3
 WILL COUNTY
 STATION 7014+56.77
 STRUCTURE NO. 099-0523

LEGEND

◆ - Soil Boring Location

WATERWAY INFORMATION

Drainage Area = 0.168 sq. mi. Low Grade Elev. 534.36 @ Sta. 8018+74 E. Frontage Rd.

Flood	Freq. Yr.	Q C.F.S.	Opening Sq.Ft.		Nat. H.W.E.	Head - Ft.		Headwater El.	
			Exist.	Prop.		Exist.	Prop.	Exist.	Prop.
Design	50	83	N/A	16.3	524.63	N/A	1.17	N/A	525.80
Base	100	109	N/A	19.6	524.94	N/A	1.3	N/A	526.24
Overtopping		405							

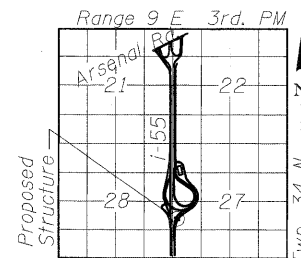

LOCATION SKETCH

SINGH
 SINGH & ASSOCIATES, INC.
 CONSULTING ENGINEERS
 300 W. ADAMS ST.
 CHICAGO, IL 60606
 TEL: (312) 629-0240
 FAX: (312) 629-8449

SHEET NO.
 SHEETS

F.A.I. RTE.	SECTION	COUNTY	TOTAL SHEETS	SHEET NO.
55	(99-1&2)AC-3	WILL	524	327
Sta. 8018+74 (E. Frontage Rd.)			CONTRACT NO. 60C31	
FED. RD. DIST. NO. 1 ILLINOIS FED. AID PROJECT				