

FINAL SURVEY	DATE
SURVEYED	BY
PLOTTED	NO. 500K
NOTE DATE	AREAS CHECKED
NO.	

ORIGINAL SURVEY	DATE
SURVEYED	BY
PLOTTED	NO. 500K
NOTE DATE	AREAS CHECKED
NO.	

**McDonough Associates Inc.**  
 Engineers/Architects  
 100 East Randolph Street, Chicago, Illinois 60601

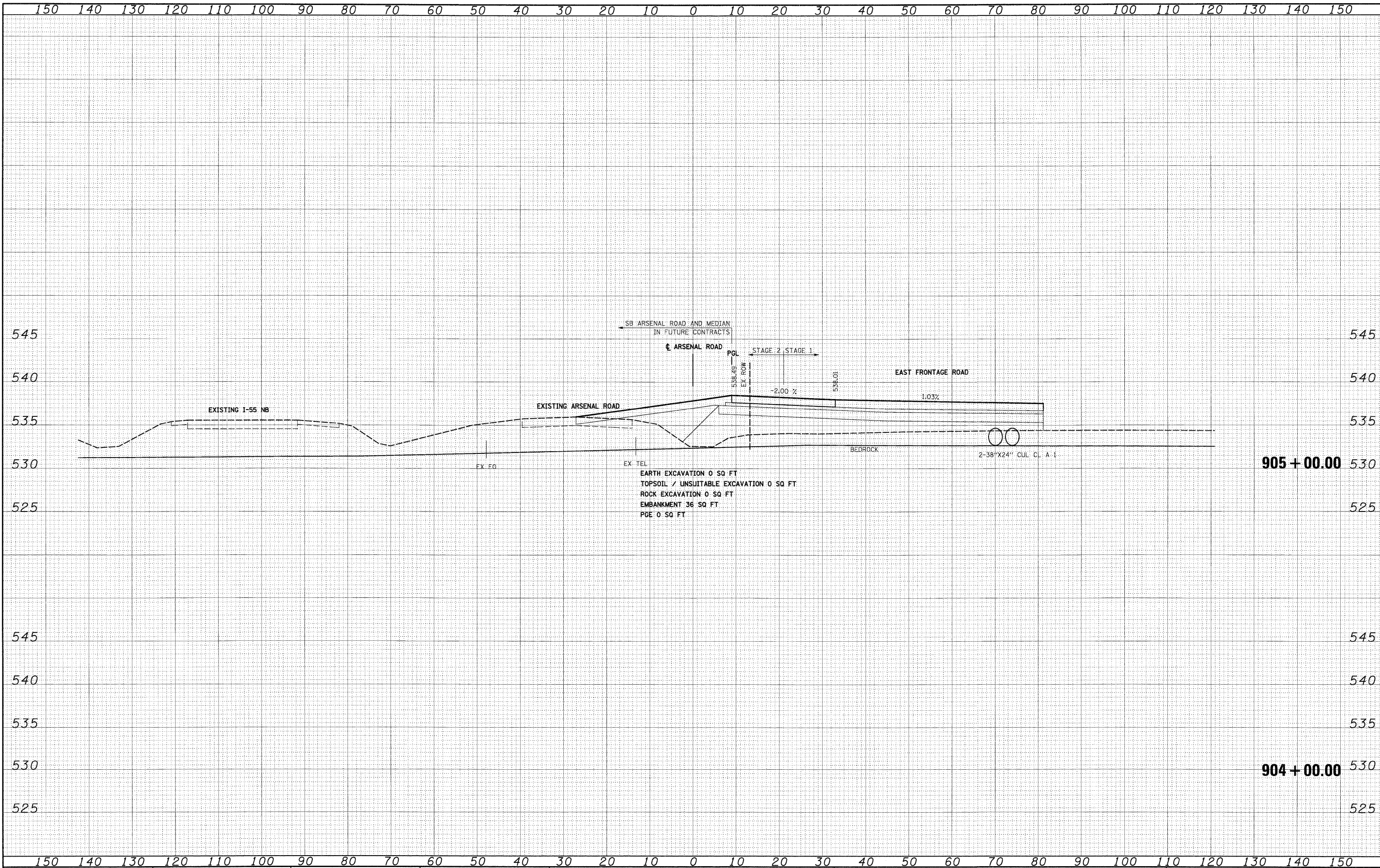

FILE NAME = D:\160C31-SHT-XSSH11.dgn

USER NAME = TKLuegel	DESIGNED - TRK	REVISED -
PLOT SCALE = 1:10	DRAWN - TRK	REVISED -
PLOT DATE = 12/11/2009	CHECKED - DLT	REVISED -
	DATE - 12/18/09	REVISED -

DESIGNED - TRK	REVISED -
DRAWN - TRK	REVISED -
CHECKED - DLT	REVISED -
DATE - 12/18/09	REVISED -

**STATE OF ILLINOIS  
 DEPARTMENT OF TRANSPORTATION**

**STAGE 1 ARSENAL ROAD CROSS SECTIONS**

SCALE: 1"=10'H; 1"=5'V SHEET NO. 1 OF 2 SHEETS STA. 904+00.00 TO STA. 905+00.00

F.A.I. RTE.	SECTION	COUNTY	TOTAL SHEETS	SHEET NO.
55	(99-1&2)AC-3	WILL	524	358
CONTRACT NO. 60C31				
FED. ROAD DIST. NO. 1 ILLINOIS FED. AID PROJECT				

FINAL  
 XT-1