

FINAL SURVEY	BY	DATE
SURVEYED		
PLOTTED		
NOTE BOOK		
AREAS CHECKED		
NO.		

ORIGINAL SURVEY	BY	DATE
SURVEYED		
PLOTTED		
NOTE BOOK		
AREAS CHECKED		
NO.		

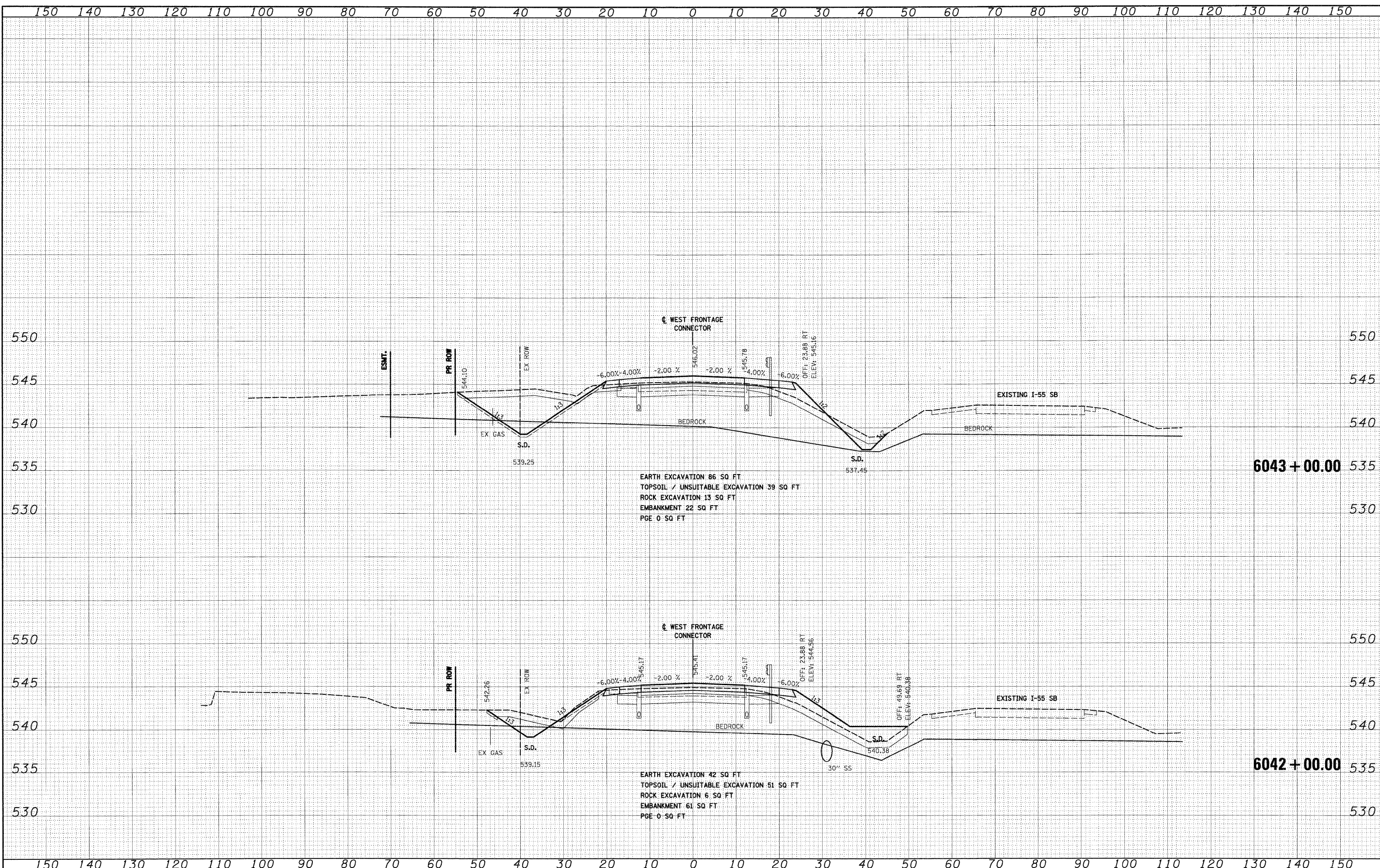

6043+00.00  
 EARTH EXCAVATION 86 SQ FT  
 TOPSOIL / UNSUITABLE EXCAVATION 39 SQ FT  
 ROCK EXCAVATION 13 SQ FT  
 EMBANKMENT 22 SQ FT  
 PGE 0 SQ FT

6042+00.00  
 EARTH EXCAVATION 42 SQ FT  
 TOPSOIL / UNSUITABLE EXCAVATION 51 SQ FT  
 ROCK EXCAVATION 6 SQ FT  
 EMBANKMENT 61 SQ FT  
 PGE 0 SQ FT

FILE NAME = D:\60C31-SHT-XSSH102.dgn	USER NAME = TKluegel	DESIGNED - TRK	REVISED -	<b>STATE OF ILLINOIS DEPARTMENT OF TRANSPORTATION</b>	<b>WEST FRONTAGE ROAD CONNECTOR</b>		F.A.I. RTE. 55	SECTION (99-1&2)AC-3	COUNTY WILL	TOTAL SHEETS 524	SHEET NO. 401	
PLOT SCALE = 1:10		CHECKED - DLT	REVISED -		SCALE: 1"=10'H; 1"=5'V		SHEET NO. 20 OF 34 SHEETS		STA. 6042+00.00 TO STA. 6043+00.00		CONTRACT NO. 60C31	
PLOT DATE = 12/15/2009		DATE - 12/18/09	REVISED -		FED. ROAD DIST. NO. 1		ILLINOIS FED. AID PROJECT					
FINAL												