

FINAL	DATE
SURVEYED	BY
PLOTTED	
NOTE BOOK	
AREAS CHECKED	
NO.	

ORIGINAL	DATE
SURVEYED	BY
PLOTTED	
NOTE BOOK	
AREAS CHECKED	
NO.	

McDonough Associates Inc.
 Engineers, Architects
 700 East Randolph Street, Chicago, Illinois 60601

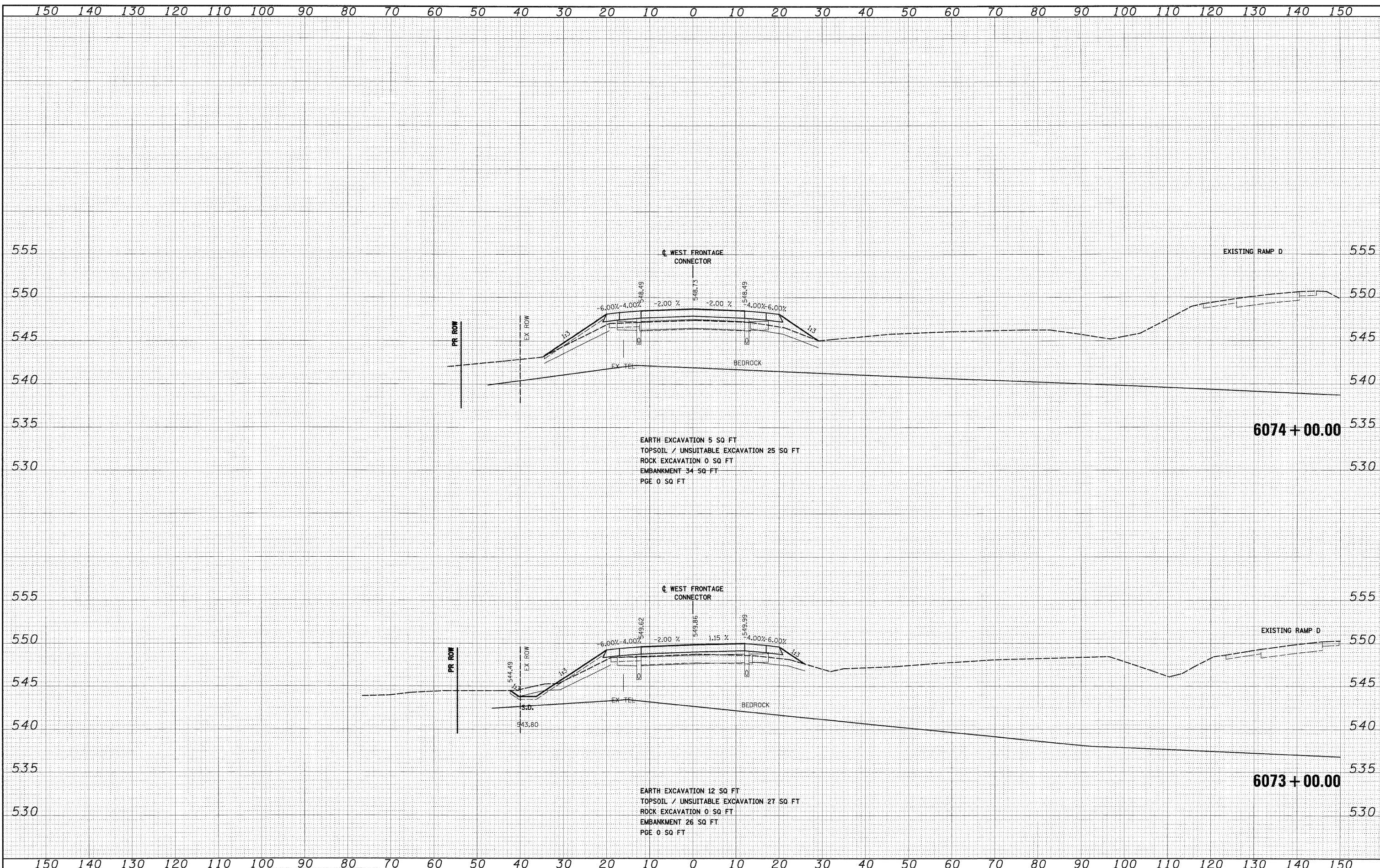

EARTH EXCAVATION 5 SQ FT
 TOPSOIL / UNSUITABLE EXCAVATION 25 SQ FT
 ROCK EXCAVATION 0 SQ FT
 EMBANKMENT 34 SQ FT
 PGE 0 SQ FT

EARTH EXCAVATION 12 SQ FT
 TOPSOIL / UNSUITABLE EXCAVATION 27 SQ FT
 ROCK EXCAVATION 0 SQ FT
 EMBANKMENT 26 SQ FT
 PGE 0 SQ FT

FILE NAME = D:\62C31-SHT-XSSH122.dgn
 USER NAME = TKluegel

DESIGNED - TRK	REVISED -
DRAWN - TRK	REVISED -
CHECKED - DLT	REVISED -
DATE - 12/18/09	REVISED -

DESIGNED - TRK	REVISED -
DRAWN - TRK	REVISED -
CHECKED - DLT	REVISED -
DATE - 12/18/09	REVISED -

**STATE OF ILLINOIS
 DEPARTMENT OF TRANSPORTATION**

WEST FRONTAGE ROAD CONNECTOR

SCALE: 1"=10'H; 1"=5'V SHEET NO. 32 OF 34 SHEETS STA. 6073+00.00 TO STA. 6074+00.00

F.A.I. RTE. 55	SECTION (99-1&2)AC-3	COUNTY WILL	TOTAL SHEETS 524	SHEET NO. 413
FED. ROAD DIST. NO. 1 ILLINOIS FED. AID PROJECT			CONTRACT NO. 60C31	