

FINAL SURVEY	BY	DATE
SURVEYED		
PLOTTED		
NOTE BOOK		
AREAS		
AREAS CHECKED		
NO.		

ORIGINAL SURVEY	BY	DATE
SURVEYED		
PLOTTED		
NOTE BOOK		
AREAS		
AREAS CHECKED		
NO.		

McDonough Associates Inc.  
 Engineers / Architects  
 700 East Randolph Street, Chicago, Illinois 60601

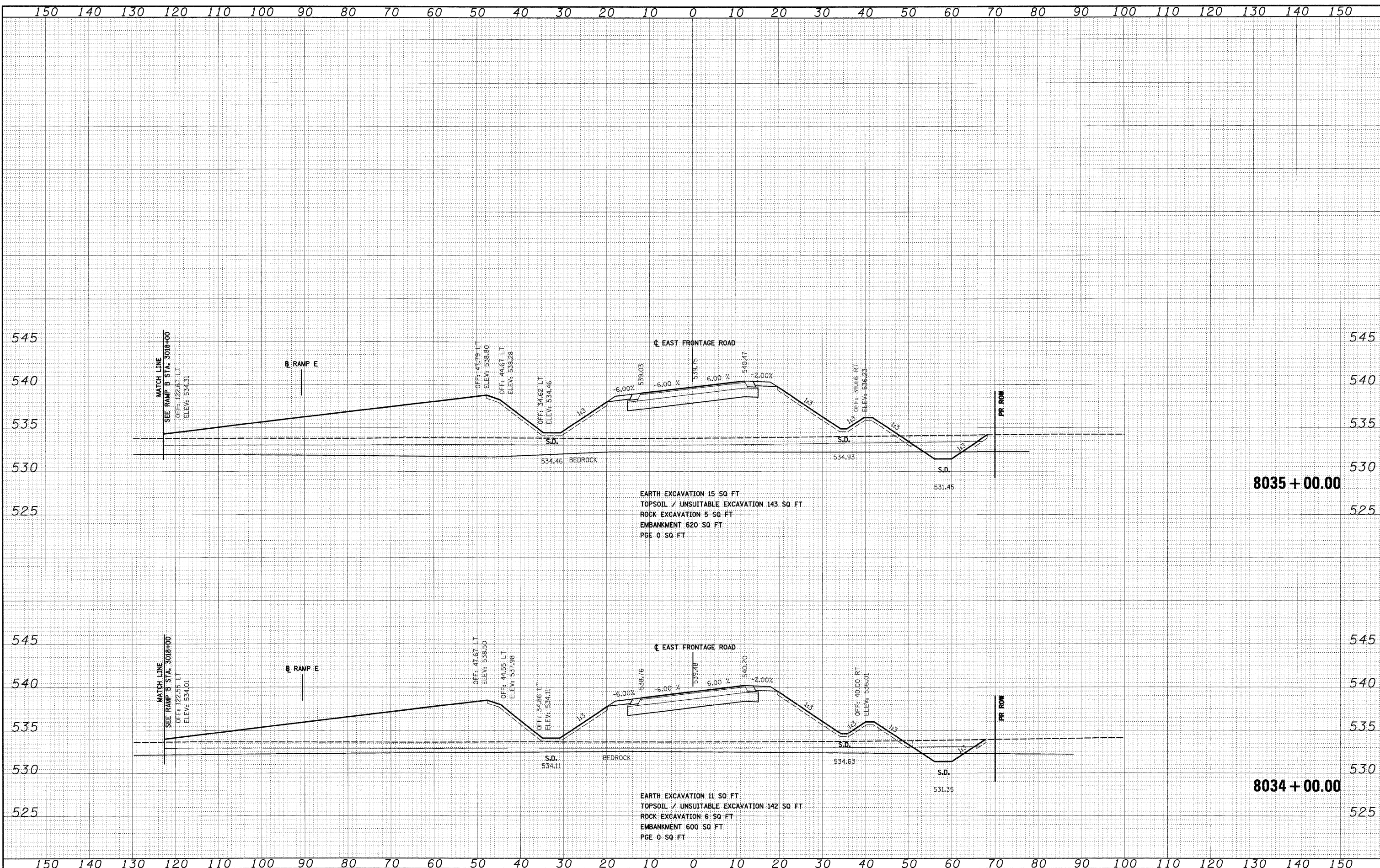

FILE NAME = 0160C31-SHT-XSSH104.dgn  
 USER NAME = TKluegel

DESIGNED - TRK  
 DRAWN - TRK  
 CHECKED - DLT  
 DATE - 12/18/09

REVISED -  
 REVISED -  
 REVISED -  
 REVISED -

**STATE OF ILLINOIS  
 DEPARTMENT OF TRANSPORTATION**

**EAST FRONTAGE ROAD**

SCALE: 1"=10'H; 1/4"=5' V SHEET NO. 17 OF 30 SHEETS STA. 8034+00.00 TO STA. 8035+00.00

F.A.I. RTE.	SECTION	COUNTY	TOTAL SHEETS	SHEET NO.
55	(99-1&2)AC-3	WILL	524	445
CONTRACT NO. 60C31				
FED. ROAD DIST. NO. 1 ILLINOIS FED. AID PROJECT				