

FINAL SURVEY	BY	DATE
PLOTTED		
NOTE BOOK		
AREAS CHECKED		
NO.		

ORIGINAL SURVEY	BY	DATE
PLOTTED		
NOTE BOOK		
AREAS CHECKED		
NO.		

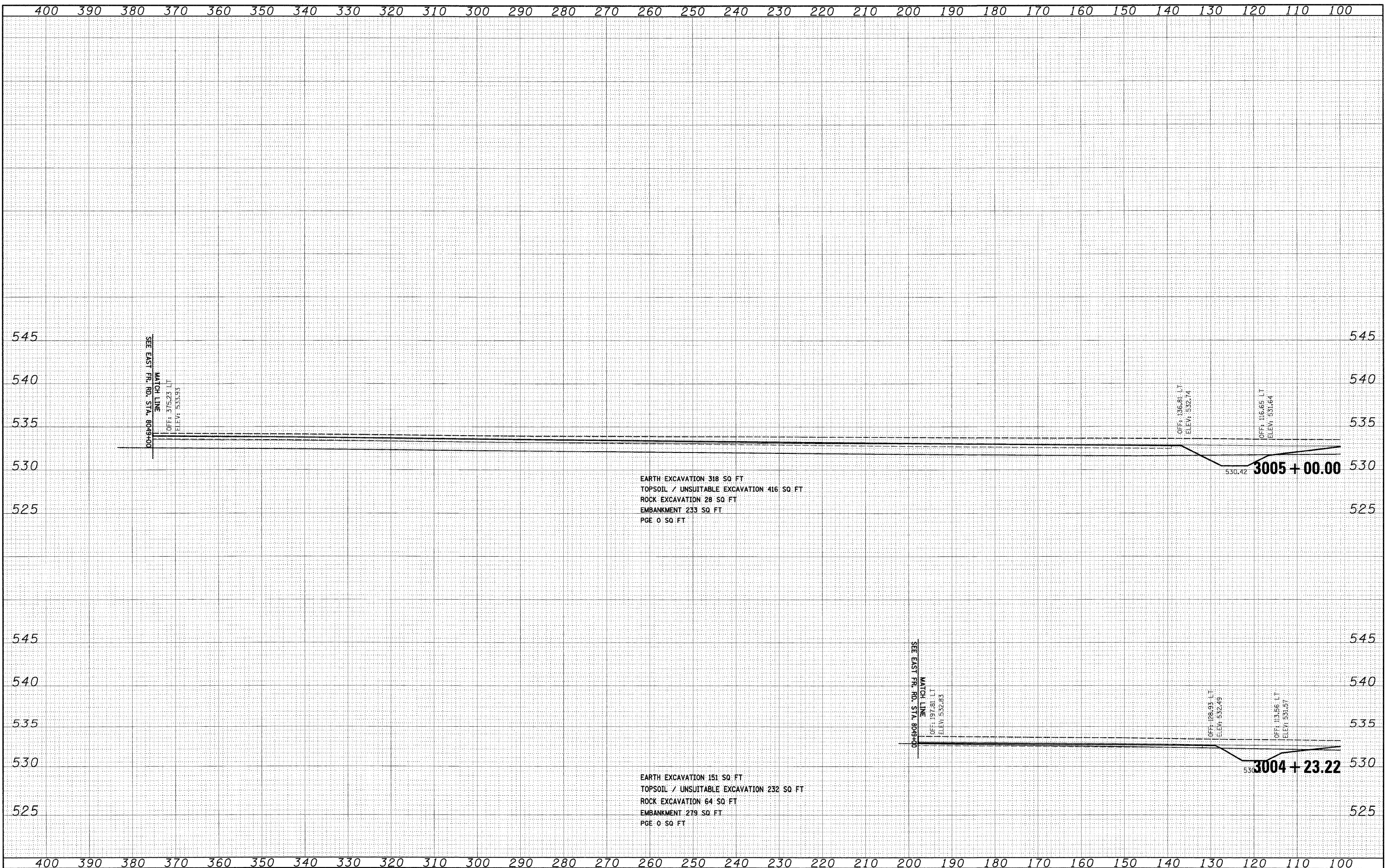

EARTH EXCAVATION 318 SQ FT  
 TOPSOIL / UNSUITABLE EXCAVATION 416 SQ FT  
 ROCK EXCAVATION 28 SQ FT  
 EMBANKMENT 233 SQ FT  
 PGE 0 SQ FT

EARTH EXCAVATION 151 SQ FT  
 TOPSOIL / UNSUITABLE EXCAVATION 232 SQ FT  
 ROCK EXCAVATION 64 SQ FT  
 EMBANKMENT 279 SQ FT  
 PGE 0 SQ FT

SEE EAST FR. RD. STA. 8049+00  
 MATCH LINE  
 OFF: 375.23 LT  
 ELEV: 533.93

SEE EAST FR. RD. STA. 8049+00  
 MATCH LINE  
 OFF: 197.81 LT  
 ELEV: 532.83

OFF: 136.81 LT  
 ELEV: 532.74

OFF: 116.65 LT  
 ELEV: 531.64

OFF: 128.93 LT  
 ELEV: 532.49

OFF: 113.56 LT  
 ELEV: 531.57

FILE NAME =	USER NAME = TKluegel
D162C31-SHT-XSSH105.dgn	DESIGNED - TRK
	DRAWN - TRK
	CHECKED - DLT
	DATE - 12/18/09

DESIGNED - TRK	REVISED -
DRAWN - TRK	REVISED -
CHECKED - DLT	REVISED -
DATE - 12/18/09	REVISED -

STATE OF ILLINOIS  
 DEPARTMENT OF TRANSPORTATION

RAMP B CROSS SECTIONS

SCALE: 1"=10'H; 1"=5' V SHEET NO. 22 OF 36 SHEETS STA. 3004+23.22 TO STA. 3005+00.00

F.A.I. RTE.	SECTION	COUNTY	TOTAL SHEETS	SHEET NO.
55	(99-1&2)AC-3	WILL	524	480
CONTRACT NO. 60C31				
FED. ROAD DIST. NO. 1 ILLINOIS FED. AID PROJECT				